



Electronic Service Manuals

This electronic document is provided as a service to our customers. We do not create the contents of the information contained in this document. Should you have detailed questions pertaining to the information contained in this document, you may contact Michco, or the manufacturer which provided the original information in this electronic deliverable. Michco's only part in this electronic deliverable was the electronic assembly process. By providing this manual on line we are not guaranteeing parts availability.

You may contact Michco through the following methods:

Phone (517) 484-9312 or (800) 331-3339

2011 N. High St. -- Lansing, Michigan -- 48906

Fax: (517) 484-9836

Email: CustServe@Michco.com

Web site: www.Michco.Com

Parts Web site: www.FloorMachineParts.Com

Order Parts on Line at:

www.FloorMachineParts.Com

Directly to Parts & Service:

By Email: **Shop@Michco.com**

By Fax: (517) 702-2041

By Voice: Use numbers above.

Serving the Cleaning Industry Since 1922

Notice: All copyrighted material remains property of original owners, all trademarks are property of respective owners. Manuals are subject to Manufacturer's reproduction limitations. Originals or reproductions were provided by manufacturers through a request. We make no warranty as to the correctness of information provided in this document and you assume all risk. By placing these manuals on line we are not declaring our corporation to be an manufacturer authorized dealer or provider, please check our web site for authorized manufacturers we represent.

OWNERS GUIDE



SV-7830-SP SCAVENGER® SELF-PROPELLED 30" VACUUM SWEEPER



**READ THESE
INSTRUCTIONS BEFORE
SETTING UP AND
OPERATING MACHINE.**

PARKER SWEEPER COMPANY Box 1728 Springfield, Ohio 45501

Plate No. 458

TO THE OWNER

These instructions were written to assist you in assembling and operating your Self-propelled Scavenger. **READ THE INSTRUCTIONS** thoroughly **BEFORE** attempting to assemble and operate the machine, so that you are familiar with the complete procedure and the safety precautions.

RULES FOR SAFE OPERATION



The following safety precautions are suggested to prevent damage to the equipment or injury to the operator or nearby persons.

1. Do not allow anyone to operate the Sweeper without proper instructions.
2. Do not permit children to operate the Sweeper.
3. Do not sweep too close to fire. Ingesting hot ashes will ignite the bag.
4. Stop the engine before reaching into the intake nozzle or discharge chute to dislodge sticks or other debris.
5. Stop the Engine before attempting to make any adjustment or performing any maintenance work on the Sweeper.
6. When working on the engine, always remove the spark plug wire from the engine and attach it to the V shaped clip on the engine head.
7. Do not run the engine in an enclosed area. Exhaust gases contain carbon monoxide, an odorless and deadly poison.
8. Do not fill the fuel tank while the engine is running. Spilling gasoline on a hot engine may cause a fire or an explosion.
9. Do not leave this machine unattended while running.
10. Before using the machine to pick up debris, police the area to be cleaned first, to pick up any large objects like cans, toys, dog bones and chunks of wood. If these pass through the machine, they could damage the impeller, bend the engine crankshaft or put a hole in the bag.
11. Avoid using the machine in dangerous places where steep slopes or loose debris will endanger the safety of the operator or other people.
12. Keep all nuts, bolts and screws tight, to be sure the Sweeper is in safe working condition.
13. Follow the maintenance instructions as outlined in this manual.

ALWAYS GIVE THE FOLLOWING INFORMATION WHEN ORDERING REPAIR PARTS:

- | | |
|-------------------------------|-------------------------|
| 1. PART NUMBER (Not Ref. No.) | 3. DESCRIPTION OF PART |
| 2. QUANTITY NEEDED | 4. MODEL No. SV-7830-SP |

If unable to obtain parts locally, write down above information and send to:

PARKER SWEEPER CO., BOX 1728, SPRINGFIELD, OHIO 45501

Your unit is right hand (R.H.) or left hand (L.H.) as you stand behind it.

IMPORTANT

REPAIR PARTS

SECTION 6
MODEL NO. SV-7830-SP

HANDLE & BAG ASSEMBLY

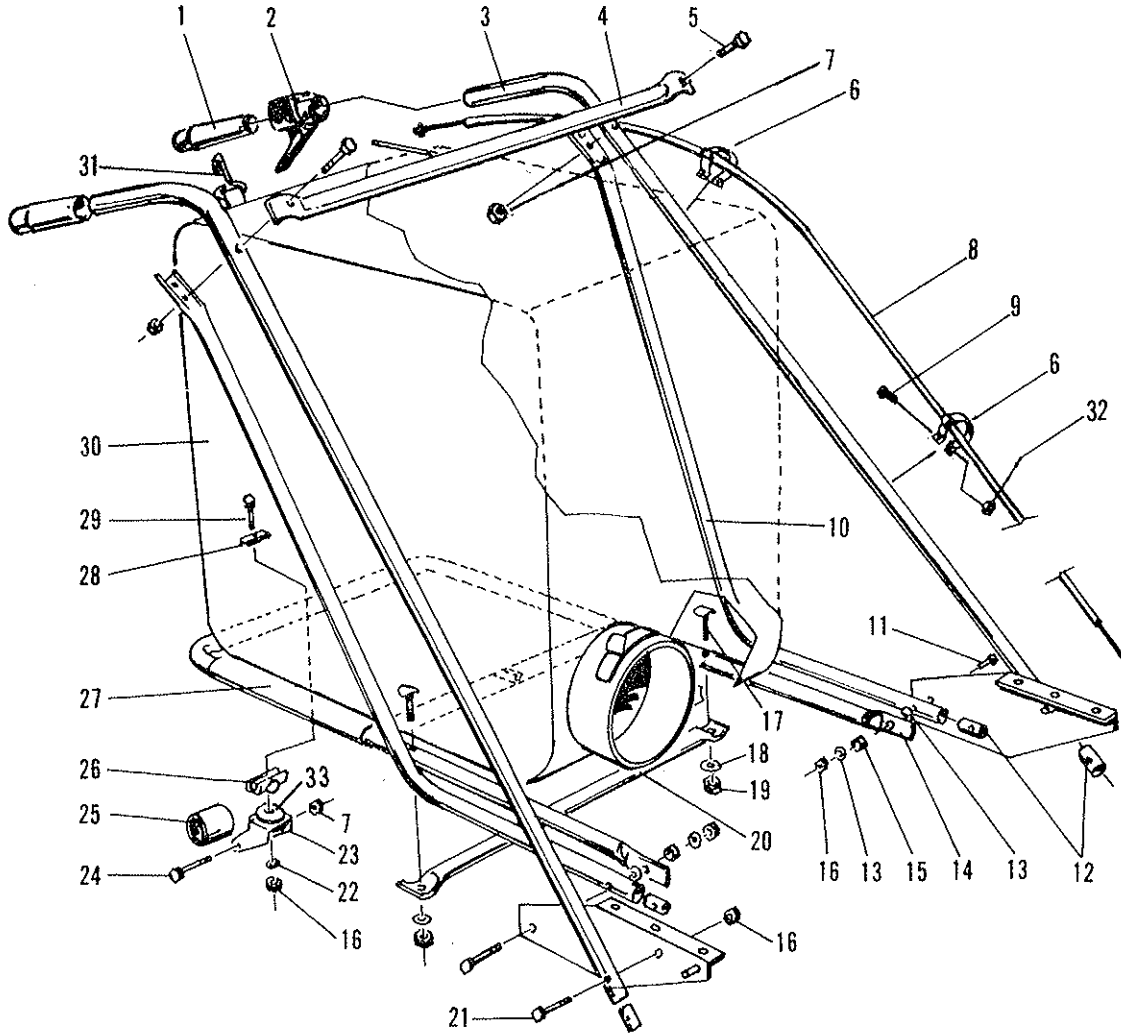

FIGURE 10

PARTS LIST

REF. PART NO. NO.	QTY. PER UNIT	DESCRIPTION	REF. PART NO. NO.	QTY. PER UNIT	DESCRIPTION
1	2	78-64-A Handle Grip	17	2	69-416-20 Bolt 1/4-20 x 1/4 Cont. Hd.
2	1	77-108-A Clutch Lever Assy.	18	2	935-416 Lockwasher 1/4" Spring
3	2	77-98-B Handle	19	2	335-416 Nut 1/4-20 Hex Plain
4	1	77-105-B Cross Brace	20	1	77-114-B Cross Brace
5	2	66-416-20 Bolt 1/4-20 x 1 1/2 Hex. Hd.	21	2	65-516-24 Bolt 5/16-18 x 1/2
6	2	79-35 Cable Clamps	22	1	50-230-A Flat Washer 5/16 SAE
7	3	365-416 Nut 1/4-20 Hex Lock	23	1	76-136 Caster Fork Assy.
8	1	77-110-A Clutch Cable Assy.	24	1	76-202-A Axle
9	2	315-8-10 8-32 x 3/8 Mach. Screw	25	1	76-58-A Roller
10	2	77-99-B Truss Brace	26	1	59-68-B Pivot Block
11	2	65-516-28 Bolt 5/16-18 x 1-1/4 Hex Hd.	27	1	77-115-B Platform Sleeve
12	4	76-178-A Handle Insert	28	1	59-77-A Tube Clamp
13	4	945-516 Flat Washer 5/16	29	1	65-516-32 Bolt 5/16-18 x 2 Hex Hd.
14	1	77-113-B Frame-Bag Platform	30	1	MA-221 Dust Bag Assy.
15	2	54-227-A Spacer	31	2	63-304-A Bag Hook
16	5	365-516 Nut 5/16-18 Hex Lock	32	2	365-8 8-32 Hex Lock Nut
			33	1	78-130 Caster Bearing

REPAIR PARTS

SECTION 6
MODEL NO. SV-7830-SP

CHASSIS ASSEMBLY

CHANGE FROM 2 CHAINS TO 1 CHAIN
AND 2 IDLER GEARS
FIGURE 11

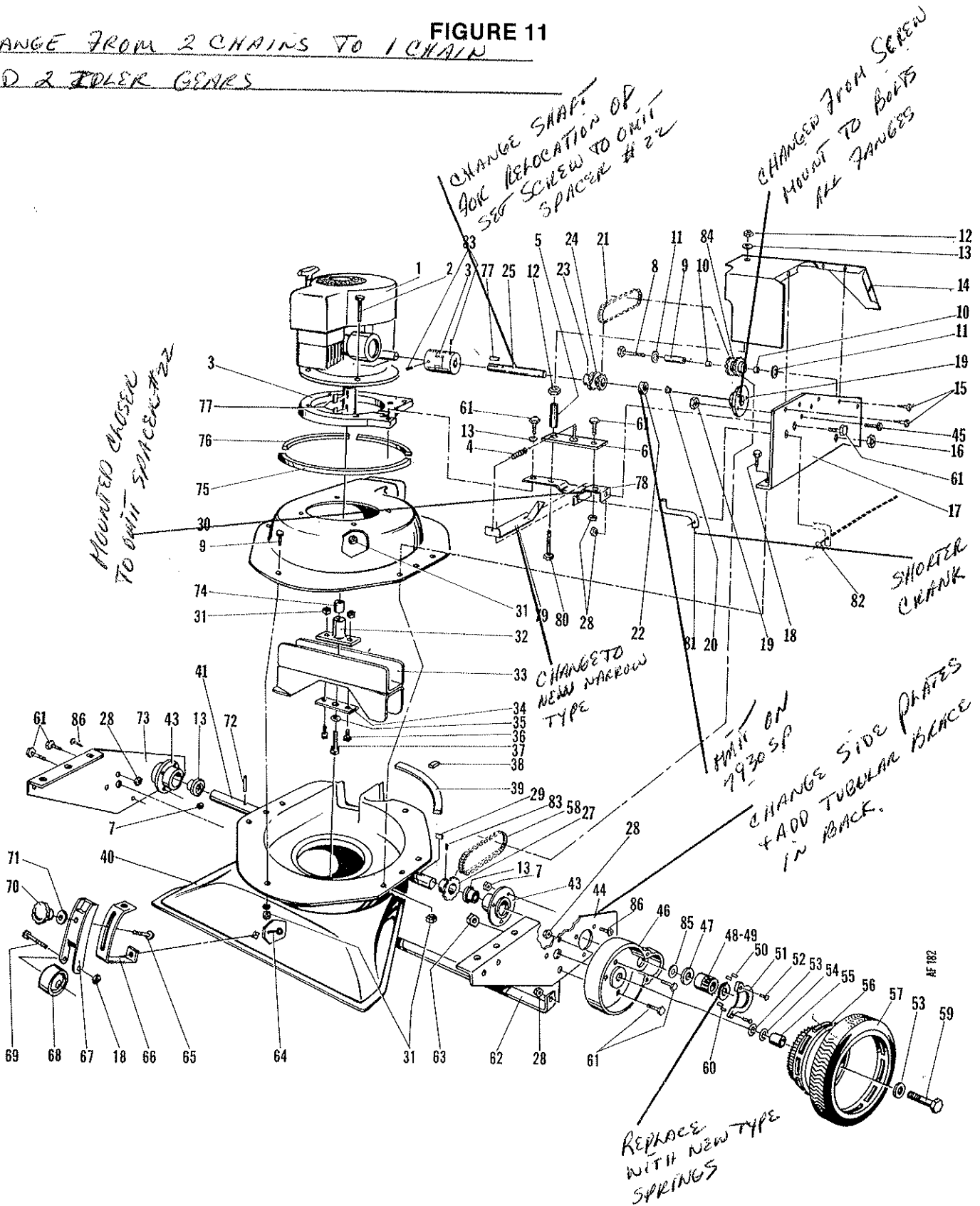

REPAIR PARTS

SECTION 6
MODEL NO. SV-7830-SP

CHASSIS ASSEMBLY

PARTS LIST FOR FIGURE 11

REF. PART NO. NO.	QTY. PER UNIT	DESCRIPTION	REF. PART NO. NO.	QTY. PER UNIT	DESCRIPTION
1 78-156	1	Engine	44 77-88	1	Side Plate, L.H.
2 65-516-32	3	Bolt 5/16 x 2 Hex Hd.	45 515-10-12	3	10-25 x 1/4 Mach. Screw
3 77-#2	1	Adaptor Ring	46 78-69	2	Dust Cover
4 77-19	1	Clutch Spring	47 50-33	2	5/8" Special Washer
5 79-20	1	Special Guard Spacer	48 74-78	1	Pinion, R.H.
6 79-32	1	Retainer Clutch Arm Weldment	49 74-79	1	Pinion, L.H.
7 365-10	9	10-24 Hex Lock Nut	50 74-80	4	Roller-Pinion
8 60-816-44	1	1/2-20 x 2 3/4 Hex Hd. Bolt	51 56-94	2	Pinion Cover
9 78-196	1	Bushing	52 505-416-8	4	1/4-20 x 1/2 Flt. Hd. Screw
10 78-191	2	Bearing	53 58-05	4	1/2" Special Washer
11 946-1016-16	2	Fiber Washer	54 946-1416-20	2	Fiber Washer
12 335-416	2	1/4-20 Plain Hex Nut	55 58-06	2	Sleeve
13 965-416 <i>68-607A</i>	2	1/4-Spring Lock Washer	56 58-14	2	Wheel
14 79-23	1	Guard	57 75-88	2	Tire
15 77-27	4	Self Tapping Screws	58 79-14	1	Lower Chain
16 363-816	1	1/2-20 Hex Lock Nut	59 60-816-56	2	1/2-20 x 3 1/2 Hex Hd. Bolt
17 78-190	1	Upper Side Plate	60 76-37	4	Plastic Tube
18 65-516-16	3	5/16-18 x 1 Hex Head	61 65-416-12	1	1/4-20 x 3/4 Hex Hd. Bolt
19 78-70-M1	1	Bearing Support	62 78-63	1	Side Plate Support
20 79-24	1	Bearing	63 363-816	2	1/2-20 Hex Lock Nut
21 79-14	1	Upper Chain	64 70-516-12	1	5/16-18 x 3/4 Carriage Bolt
22 79-16	1	Clutch Spacer	65 70-516-32	1	5/16-18 x 2 Carriage Bolt
23 67-521	1	Roll Pin	66 66-216	1	Front Roller Support
24 SA-746	1	Clutch Assembly	67 64-167	1	Roller Fork
25 78-199	1	Clutch Shaft	68 64-169	1	Roller
26 78-197	1	Flex Coupling Assy.	69 65-616-48	1	5/16-18 x 3 Hex Head Bolt
27 78-195	1	Drive Sproket Assy.	70 59-47	1	Knob
28 365-416	9	1/4-20 Hex. Lock Nut	71 935-516	1	5/16 Lock Washer
29 63-132	1	Hi Pro Key #606	72 67-521	1	Roll Pin
30 63-280	1	Upper Blower Housing	73 77-87	1	Side Plate, R.H.
31 365-516	14	5/16-18 Hex Lock Nut	74 77-106	1	Fan Spacer
32 77-103	1	Blade Adaptor	75 400-9 1/2	1	Rubber Shim
33 63-287	1	Fan Blade Assy.	76 400-6	2	Rubber Shim
34 63-305	1	Anchor Plate	77 64-43	3	Hi-Pro Key #505
35 935-516	1	5/16 Lock Washer	78 79-31	1	Clutch Arm Support Weldment
36 65-516-20	2	5/16-18 x 1-1/4 Hex Hd. Bolt	79 78-188	1	Clutch Arm
37 60-616-40	1	5/16-24 x 2 1/2 Hex Hd. Bolt	80 65-416-36	1	1/4-20 x 2 1/4 Hex Head Bolt
38 400-1	1	Rubber Shim	81 79-10	1	Clutch Control Rod
39 63-299	1	Rubber Molding	82 79-38	1	Wire Stop
40 67-76	1	Nozzle & Lower Blower	83 564-C-416-6	3	1/4-20 x 5/8 Allen Hd. Set Screw
41 77-96	1	Drive Shaft	84 78-193	1	Sprocket Assembly
42 65-416-10	4	1/4-20 x 5/8 Hex Hd. Bolt	85 945-1016	2	5/8 Flat Washer
43 78-70	2	Bearing Support	86 515-10-10	6	10-24 x 5/8 Machine Screw

HOW TO RE-INSTALL PINIONS

If for some reason you have found it necessary to remove the pinions, you should carefully follow the following instructions.

- (1) To assist you, we suggest using a piece of wood doweling or plastic material $\frac{3}{8}$ " diameter, 2" long as shown. Each pinion is different as indicated by the part number and must be returned to the correct side of the shaft.

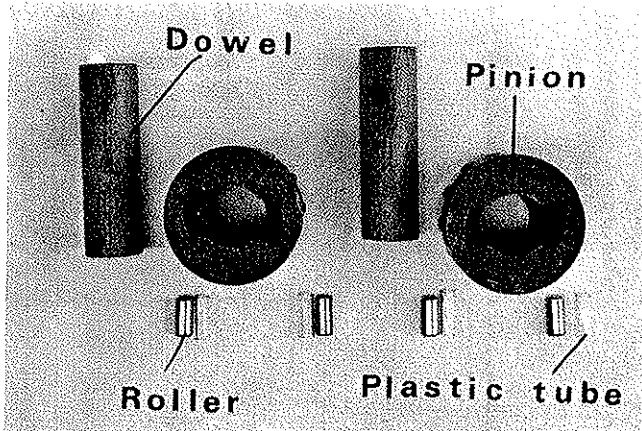

- (4) Pinion with part number **74-79 BL** is to be replaced on the **right side** of the shaft. Part Number **74-78BR** is for the **left side**. Line up the pinion (leaving the dowel in place) with the shaft as shown.

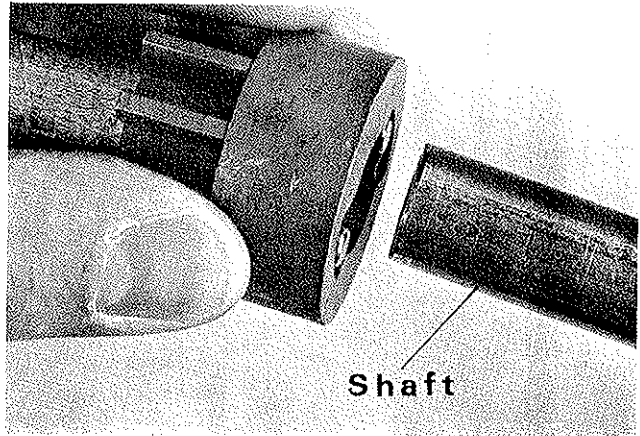

- (2) Insert the wooden dowel into the pinion.
- (3) Identify your pinion part number and insert the metal rollers. Place the plastic tubing in the cavity between the metal roller and the wall of the cavity. You may have to force the plastic tubing into this space but it is resilient and is supposed to fit tightly.

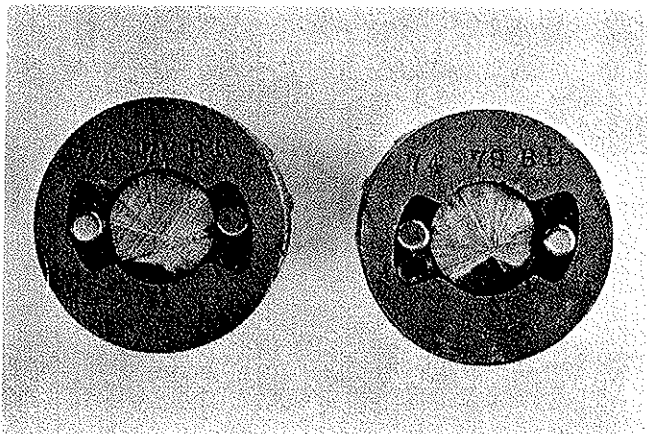

- (5) Push the pinion onto the shaft which will force the dowel to back out of the pinion. This will leave the rollers and plastic tubes in their proper position.

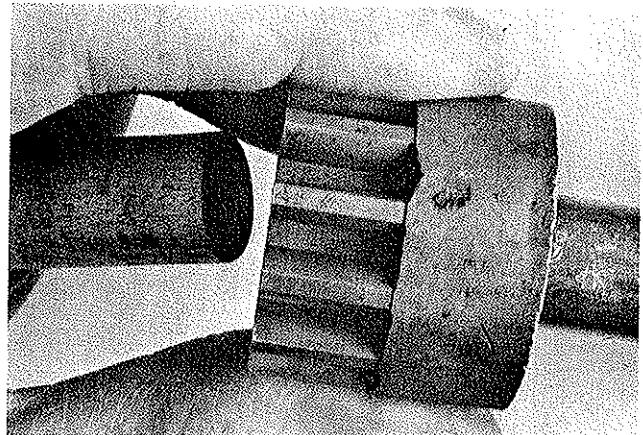

- (6) Apply a coating of grease on the outside of the pinion gear teeth and the wheel gear teeth. Replace the wheel.

Note! The right and left side are determined from the operators position.