



## Electronic Service Manuals

This electronic document is provided as a service to our customers. We do not create the contents of the information contained in this document. Should you have detailed questions pertaining to the information contained in this document, you may contact Michco, or the manufacturer which provided the original information in this electronic deliverable. Michco's only part in this electronic deliverable was the electronic assembly process. By providing this manual on line we are not guaranteeing parts availability.

You may contact Michco through the following methods:

Phone (517) 484-9312 or (800) 331-3339

2011 N. High St. -- Lansing, Michigan -- 48906

Fax: (517) 484-9836

Email: [CustServe@Michco.com](mailto:CustServe@Michco.com)

Web site: [www.Michco.Com](http://www.Michco.Com)

Parts Web site: [www.FloorMachineParts.Com](http://www.FloorMachineParts.Com)

Order Parts on Line at:

**[www.FloorMachineParts.Com](http://www.FloorMachineParts.Com)**

Directly to Parts & Service:

By Email: **[Shop@Michco.com](mailto:Shop@Michco.com)**

By Fax: (517) 702-2041

By Voice: Use numbers above.

**Serving the Cleaning Industry Since 1922**

Notice: All copyrighted material remains property of original owners, all trademarks are property of respective owners. Manuals are subject to Manufacturer's reproduction limitations. Originals or reproductions were provided by manufacturers through a request. We make no warranty as to the correctness of information provided in this document and you assume all risk. By placing these manuals on line we are not declaring our corporation to be an manufacturer authorized dealer or provider, please check our web site for authorized manufacturers we represent.

# Minuteman<sup>®</sup> Parker<sup>®</sup>

## TURF PACKAGE Part No. MA-644-D

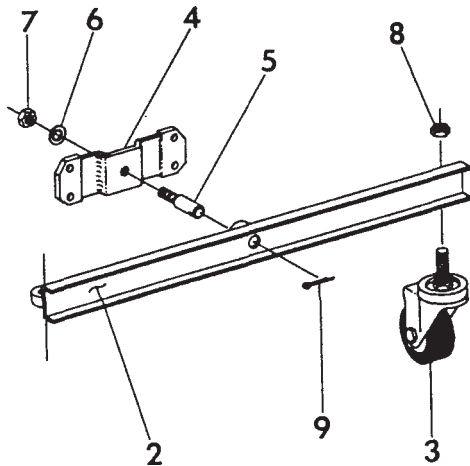

### PARTS LIST

Item	Part No.	Qty.	Description
1	MA-585	1	Dust Bag (not shown)
2	88-53-C	1	Axle Support Weldment
3	64-71-A	2	Caster, Stem Type
4	73-89-B	1	Mount Plate
5	73-94-A	1	Pivot Pin
6	936-816	1	Lockwasher, Int. Tooth 1/2
7	345-816	1	Nut, Hex Jam 1/2 - 20
8	340-1216	2	Nut, Hex Jam 3/4 - 10
9	380-532-20	1	Cotter Pin

\* MA-585 Dust Bag is supplied with 63-304-A Bag Hooks which can be purchased separately.

## ASSEMBLY INSTRUCTIONS

**NOTE:** Numbers in parenthesis refer to those used in AF-792 in these Instructions and AF-782 the exploded view for Parts List.

### ASSEMBLING DUAL CASTER WHEEL ASSEMBLY

- Place a block of wood or a brick under front of Chassis to hold Fan Housing off floor.
- Remove four Bolts and Lockwashers from lower holes in Front Cover of Fan Housing.
- Check to make sure holes in Anti-Wrap Segments inside Fan Housing are still in line with holes in Front Cover.
- Place Dual Caster Wheel Assembly up against Front Cover, align holes in Mounting Bracket (4) with those in Front Cover.
- Assemble two longer Bolts and Lockwashers through lower holes in Mounting Bracket (4), Front Cover and Anti-Wrap Segments.
- Assemble remaining Bolts and Lockwashers through upper holes. **NOTE:** After all assembly is complete the height of the Intake Housing can be adjusted as follows.
- To lower Intake Housing thread stem of Caster (3) farther into mount on Axle Support Weldment (2).
- Thread stem of Caster (3) out of Axle Support Weldment (2) to raise Intake Housing.
- It may be necessary to adjust Intake Housing a few times before finding the proper setting, depending on the material being picked up.
- When desired height is obtained, tighten Jam Nut (8) against top of mount on Axle Support Weldment (2) to lock Caster (3).

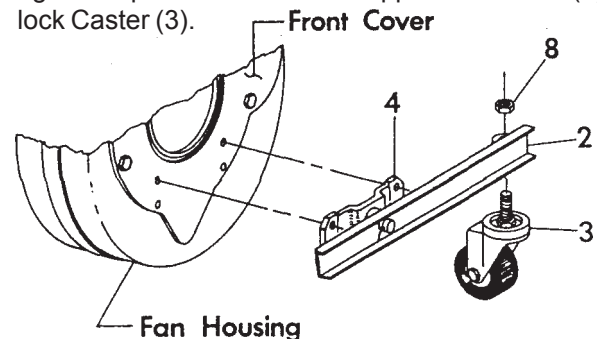

# Minuteman<sup>®</sup> Parker<sup>®</sup>

A Minuteman International Company

**World Headquarters**  
Minuteman International, Inc.  
111 South Rohlwing Road  
Addison, Illinois 60101

Minuteman Canada, Inc.  
2210 Drew Road  
Mississauga, Ontario  
L5S 1B1

(630) 627-6900  
FAX (630) 627-1130

(905) 673-3222  
FAX (905) 673-5161

Complete all other assembly as outlined in main Owner's Guide before attaching Dust Bag.

**NOTE:** See Instruction Sheet packed with Dust Bag to assemble Dust Bag.

000677  
Printed in U.S.A.