



Electronic Service Manuals

This electronic document is provided as a service to our customers. We do not create the contents of the information contained in this document. Should you have detailed questions pertaining to the information contained in this document, you may contact Michco, or the manufacturer which provided the original information in this electronic deliverable. Michco's only part in this electronic deliverable was the electronic assembly process. By providing this manual on line we are not guaranteeing parts availability.

You may contact Michco through the following methods:

Phone (517) 484-9312 or (800) 331-3339

2011 N. High St. -- Lansing, Michigan -- 48906

Fax: (517) 484-9836

Email: CustServe@Michco.com

Web site: www.Michco.Com

Parts Web site: www.FloorMachineParts.Com

Order Parts on Line at:

www.FloorMachineParts.Com

Directly to Parts & Service:

By Email: **Shop@Michco.com**

By Fax: (517) 702-2041

By Voice: Use numbers above.

Serving the Cleaning Industry Since 1922

Notice: All copyrighted material remains property of original owners, all trademarks are property of respective owners. Manuals are subject to Manufacturer's reproduction limitations. Originals or reproductions were provided by manufacturers through a request. We make no warranty as to the correctness of information provided in this document and you assume all risk. By placing these manuals on line we are not declaring our corporation to be an manufacturer authorized dealer or provider, please check our web site for authorized manufacturers we represent.

OWNER'S GUIDE

POW-R-SWEEP

LAWN SWEEPER

MODEL PS-5724

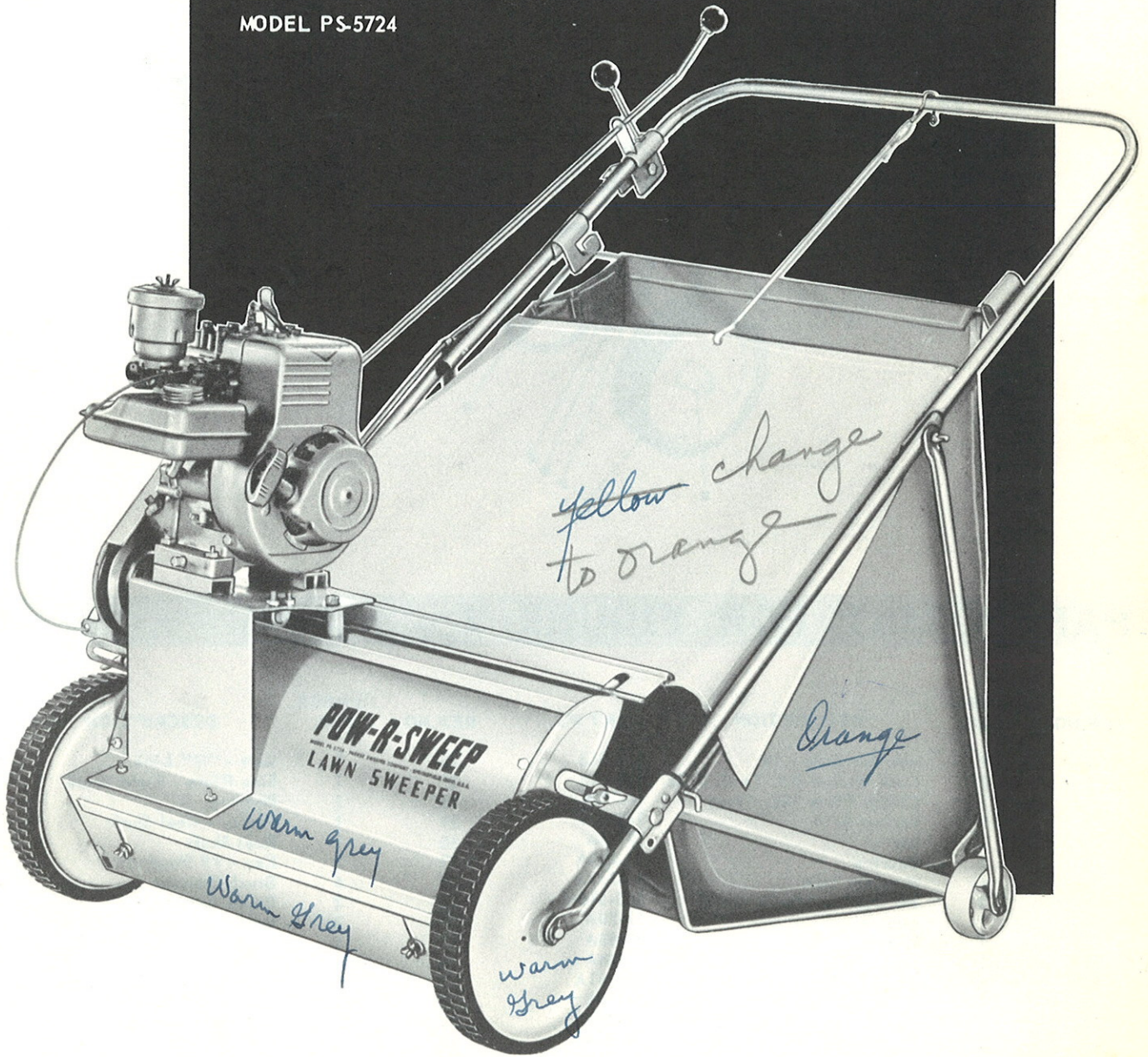

FORM NO. 57916
PRINTED IN U.S.A.

PARKER LAWN SWEEPERS

Parker Sweeper Company, 000 Bechtle Avenue, Springfield, Ohio

7 7 7 7 7 7 7

DDI P: 72

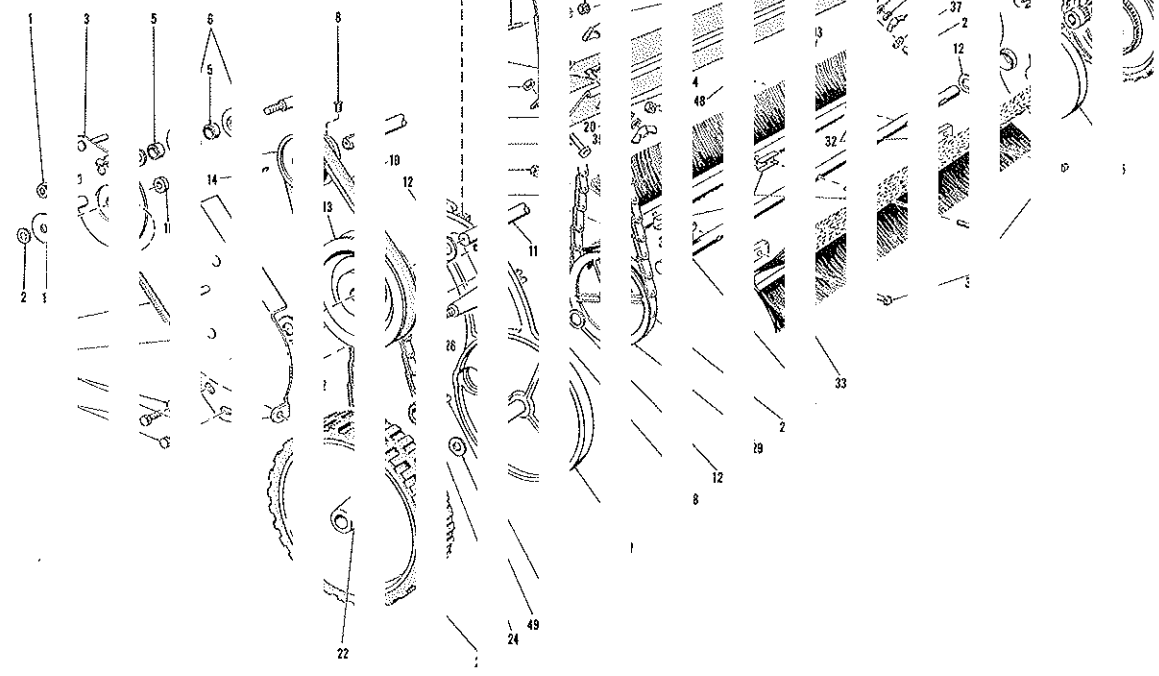

ICUIE

PART LIST

RE NO	QUANTITY	DESCRIPTION	UNIT	REF	REMARKS	PA	IN
Helut	16	8		26	alt V"	57-	A
Lo Wa	er l	Tc	5,	27	de ite	56-	5RE
Cl h F	te S	. A	7.	28	ari	48-	5A
Wa ar	6			29	ille Re	56-	3A
Sp r				30	rel aft	57-	3
Be ng				31	ry - 9 W	280	
Sh der	olt			32	ust rac	49-	A
Se cre	51	8 >	/8	33	ust sse	57-	3
En ie				34	olt s. f	66-	i-21
V- lt				35	de ite	56-	5LE
Sh - l	r			36	nio	56-	RC
Wa ar	sec			37	ock ish.	936	16
Pu y	er			38	ng t -	351	16-
Ke 3/	x	6 x		39	ock ish.	935	6
Pu y	ive			40	od ter	54-	5C
Sp r				41	rrri : B	70-	i-1:
Wa ar	sec			42	od	56-	2D
Sp g	ut			43	lt Hc	66-	i-1c
Br cet	lut	Su	ort	44	ppt -Cl	56-	1P
Wc er	!			45	acc	56-	3
He lec	scrc	- 1/4	1 x	46	rrri : B	70-	i-1:
Wh l				47	rin	57	A
Ti				48	ix t	335	6
Pi n				49	ishu - F	946	216
Pc				25			

POW-R-SWEEP

ASSEMBLY INSTRUCTIONS

MODEL PS-5724

Your new Parker "POW-R-SWEEP" lawn sweeper comes to you complete in two cartons. The larger carton contains the following:

- 1 Sweeper unit
- 1 Basket
- 1 Clutch control rod
- 1 Throttle control and cable assembly
- 1 Wind Apron
- 1 Upper handle assembly
- 1 Bag containing the following:
 - 1 "V" single groove pulley with set screw
 - 1 Pulley key 3/16 x 3/16 x 1
 - 4 Engine mounting bolts 5/16 x 2 1/4 Hex or Square Head
 - 4 Lock Washers 5/16
 - 4 Hex nuts 5/16
 - 2 Engine support Channels
 - 2 Special Washers 1/2
 - 1 Retaining Ring

The small carton contains the following:

- 1 Briggs & Stratton 6BS engine
- 1 Engine Manual

To assemble this sweeper; first read these instructions through. Refer to the exploded views figures 1 and 2. Parts are located by the use of reference numbers. The right side of a sweeper is the side to your right when you are standing at the operators position. After becoming familiar with the parts and having them unpacked and checked, proceed to assemble step by step according to the following instructions.

1.

Having removed the sweeper unit from the carton, remove the tape from around the handle and machine. Pull the upper handle assembly (Ref. No. 58, Fig. 2) back from the sweeper into its relative position, with the basket hooks down as illustrated.

2.

Remove the wing nuts, lock washers, hex nuts and cable clip (Ref. Nos. 34, 26, 25 and 59, Fig. 2) on the right hand side of the handle assembly.

3.

Place the upper handle assembly into the recesses of the lower handles (Ref. No. 46, Fig. 2) and put the round head screw (Ref. No. 22, Fig. 2) through the holes in the handles with the screw head toward the inside. Put the cable clip (Ref. No. 59, Fig. 2) on the outside with the loop up, as illustrated. Then put the hex nut on finger tight. Repeat this on the left side except the cable clip is not used on the left side.

4.

Untape the clutch rod, throttle assembly and the Wind Apron. Remove the nut and washer from the bracket stamping (Ref. No. 13, Fig. 2) which is on the clutch rod (Ref. No. 12, Fig. 2).

5.

Insert the throttle cable (Ref. No. 11, Fig. 2) through the (Ref. No. 59, Fig. 2) as illustrated. Place the throttle handle bracket (Ref. No. 31, Fig. 2) into position over the hole on the right side of the upper handle. Place the clutch rod bracket (Ref. No. 13, Fig. 2) over the throttle handle bracket. Insert the screw (Ref. No. 14, Fig. 2) through the holes of parts and handle. Place lockwasher (Ref. No. 26, Fig. 2) and Hex nut (Ref. No. 25, Fig. 2) as illustrated and tighten securely.

6.

On the left side only, tighten the hex nut which is located where the upper and lower handles are joined. Raise the handle upwards and place the braces (Ref. No. 33, Fig. 2) over the projecting screws. Replace the lockwashers and wing nuts and tighten on left side of machine only.

7.

Place one special washer (Ref. No. 36, Fig. 2) on the shifter pin that extends from the belt tightener plate (Ref. No. 3, Fig. 1). Place the clutch rod (Ref. No. 12, Fig. 2) on this pin followed by the other special washer. Push the retaining ring (Ref. No. 37, Fig. 2) on the pin as illustrated.

8.

Having removed the engine from the carton, place the square key (Ref. No. 14, Fig. 1) into the key slot on the engine shaft. Slide the pulley (Ref. No. 15, Fig. 1) on the shaft with the hub toward the engine, leaving about $\frac{9}{16}$ of an inch of shaft protruding through the pulley. Snug the pulley set screw up but do not tighten at this time.

9.

Place one engine support channel (Ref. No. 18, Fig. 2) over the bolt slots in the engine mount (Ref. No. 52, Fig. 2). Have the edge the holes are nearer to, toward the front; the other channel, over the other two slots, with the edge the holes are nearer to, towards the rear. Push the clutch control rod forward as far as it will go. Place the engine on the engine mount channels with the pulley under the belt. Pull the clutch rod back as far as it will go. Place the engine mounting bolts (Ref. No. 21, Fig. 2) through from the under side of the engine mount and through the channels and engine base. Place the four lockwashers (Ref. No. 20, Fig. 2) and the four Hex nuts (Ref. No. 19, Fig. 2) on the engine bolts but do not tighten at this time. Slide the engine as far forward as the belt will let it go, keeping the engine squared up to the machine and then tighten the engine mounting bolts. Line up the engine pulley with the idler pulley (Ref. No. 13, Fig. 1) and tighten the engine pulley set screw securely.

10.

Loosen the small screw that holds the "L" shaped cable clamp (Ref. No. 32, Fig. 2) onto the throttle control assembly. Place the lower end of the throttle cable through the hole where the clutch spring (Ref. No. 18, Fig. 1). Refer to page 6, plate No. 3026 of the engine manual for attaching the throttle cable and control wire

to the engine. After throttle control is attached to the engine properly as shown in the engine manual, proceed to the other end of the control cable and set the cable under and even with the upper end of the "L" cable clamp (Ref. No. 32, Fig. 2) and tighten the small screw. Next loosen the small screw (Ref. No. 3, Fig. 2) in the hex swivel and insert the throttle wire (Ref. No. 30, Fig. 2) through the small hole in the hex swivel until it extends through about $\frac{1}{2}$ of an inch. Be sure that the throttle handle is pushed all the way forward when this is done. Tighten the small screw down on the throttle wire and lock the hex nut securely. Use care and do not bend a kink in the wire when tightening screw and lock nut.

11.

Pull all of the slack out of the cable between the upper cable clamp and cable clamp which is located at the handle brace. Tighten the hex nut and wing nut at the handle brace at this time. Place the spring type cable clamp (Ref. No. 38, Fig. 2) over the cable and the lower handle, about 14 inches below the clamp at the handle brace, as illustrated.

12.

Standing at the operator's position, hold the basket at the upper corners. Place the protruding ends of the lower front support rod of basket with the hooks pointing down over bottom braces. Slide the basket forward and hook the top corners into the slots of the basket brackets on the upper handle.

13.

Place the wind apron into position by hooking the front metal edge over the hooks which are located on the top of each side plate. Fasten the wind apron hook over the handle, making sure that the flap at top of the wind apron is hanging down inside of the basket.

CAUTION: Before attempting to operate this sweeper, refer to operating and adjustment instructions on page 6.

FIGURE 2

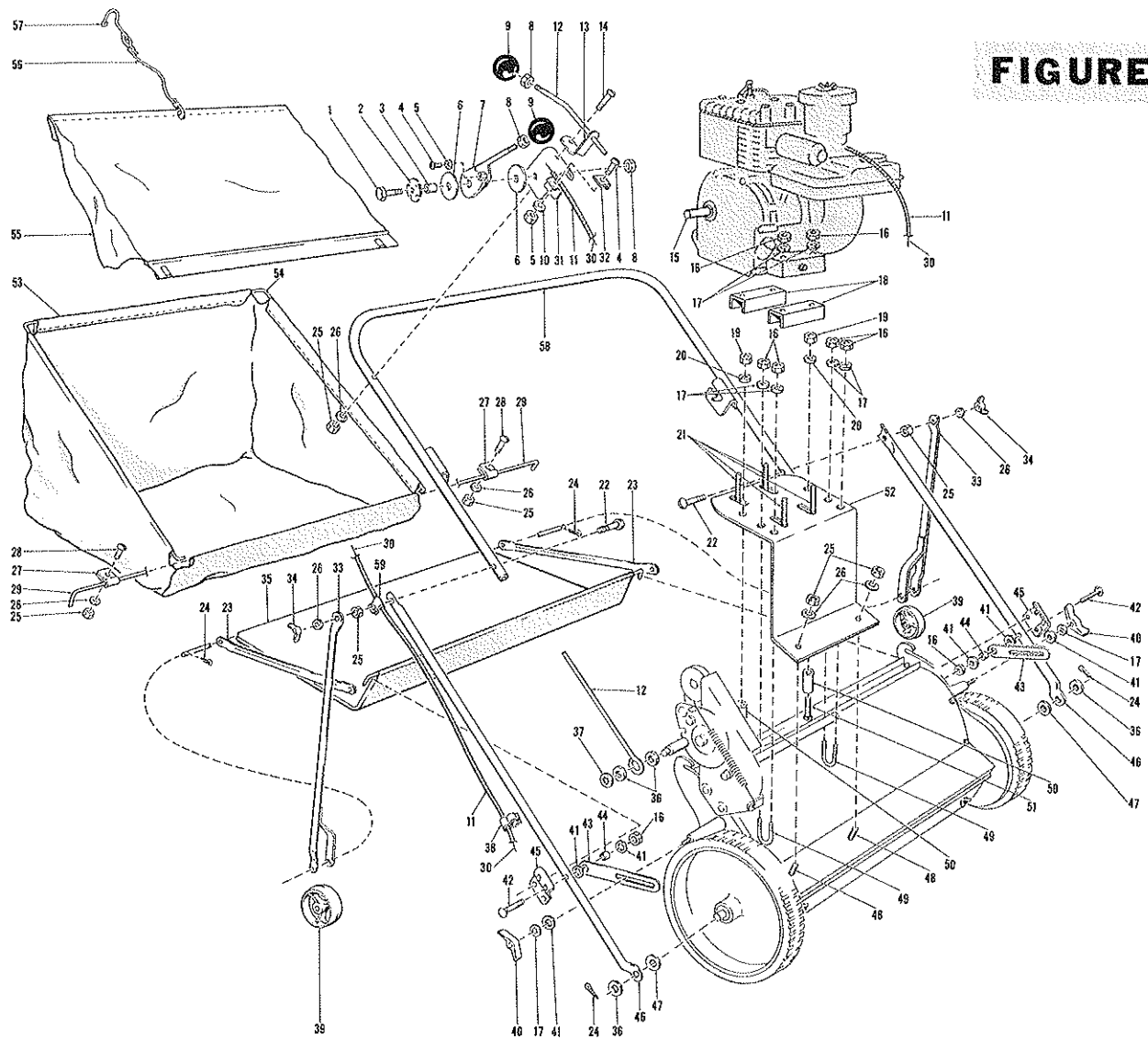

PARTS LIST FOR FIGURE 2

REF. NO.	NUMBER REQ.	DESCRIPTION	PART NO.	REF. NO.	NUMBER REQ.	DESCRIPTION	PART NO.
1	1	Hex Head Bolt	65-516-12	31	1	Bracket - Throttle	57-04B
2	1	Washer - Spring	53-165A	32	1	Clamp - Throttle Cable	55-136A
3	1	Spacer	55-132A	33	2	Handle Brace Assy.	56-103B
4	2	Rd. Head Screw 8-32 x 1/2	515-8-8	34	2	Wing Nut 1/4 -20 x 7/8 Span	351-416-14
5	2	Hex Nut 8-32	335-8	35	1	Basket Bottom Assy.	57-01E
6	2	Washer - Special	55-156A	36	4	Washer - Special	46-81A
7	1	Throttle Handle Assy.	55-131B	37	1	Retaining Ring	998-8
8	3	Hex Jam Nut 5/16-18	340-516	38	1	Clip - Cable	53-84A
9	2	Ball Knob	55-130A	39	2	Wheel	56-97B
10	1	Lock Washer - Int. Tooth #10	936-10	40	2	Wing Nut - Special 5/16-18 x 2 1/2 Span	351-516-40
11	1	Throttle Cable	20-66-6	41	6	Washer 5/16	945-516
12	1	Clutch Shifter Rod	56-107B	42	2	Carriage Bolt 5/16 - 18x1 1/2	70-516-24
13	1	Clutch Shifter Support	57-02B	43	2	Bracket - Brush adjusting	54-201A
14	1	Rd. Hd. Screw 1/4-20 x 1 1/4	515-416-20	44	2	Spacer	54-227A
15	1	Engine	57-20A	45	2	Bracket - Handle to Basket	47-423A
16	10	Hex Nut 5/16	335-516	46	2	Handle - Lower	54-203B
17	10	Lock Washer - Int. Tooth 5/16	936-516	47	2	Washer - Fiber	946-816-16
18	2	Support - Engine	56-119A	48	2	Carriage Bolt 1/4-20 x 3/4	70-416-12
19	2	Hex Nut 3/8 - 16	335-616	49	2	"U" Bolt	53-139A
20	2	Lock Washer - Int. Tooth 3/8	936-616	50	2	Spacer	56-118A
21	4	Hex Head Bolt 5/16-18 x 2 1/4	65-516-36	51	2	Carriage Bolt 3/8-16 x 2 1/4	70-616-36
22	2	Rd. Head Screw 1/4-20 x 1 3/4	515-416-28	52	1	Engine Mount	56-110D
23	2	Brace - Handle	54-202B	53	1	Basket - Canvas	57-11D
24	4	Cotter Pin	380-332-12	54	1	Basket - Frame	57-10C
25	7	Hex Nut 1/4-20	335-416	55	1	Wind Apron Assy.	57-76C
26	7	Lock Washer - Int. Tooth 1/4	936-416	56	1	Cord - Rubber	49-295A-6
27	2	Clamp - Basket Rod	53-116A	57	1	Hook - Wind Apron	54-209A
28	2	Rd. Head Screw 1/4-20 x 5/8	515-416-10	58	1	Handle - U per	57-09C
29	1	Tie Rod - Basket	57-31A	59	1	Clip - Cable	47-229A
30	1	Trottle Wire	30-70-.054				

POW-R-SWEEP OPERATING INSTRUCTIONS

1. Do not start the engine until you have read the starting instructions in the engine Operating Instructions Manual. See Pages 3 to 5 of Manual.
2. Inspect the sweeper to make sure that all the nuts, bolts, and set screws are tight. Also that all moving parts are free and do not rub or malfunction.
3. **LUBRICATION** – Oil the idler pulley by raising the right drive wheel about 4" then put oil (SAE 20 or 30) into the oil hole that is in the end of the shaft (Ref. No. 11, Fig. 1). This will allow oil to run into the idler pulley bearings. This bearing should be oiled each time sweeper is used or every hour of continuous operation.

The wheels, reel shaft, rear wheels and gears should be oiled at the oil holes provided, or at the ends of

shafts before sweeper is run and about every 5 hours of operation thereafter.

All the moving parts of the clutch mechanism should be oiled with a few drops of SAE 20 or 30 oil as needed to keep operating freely.

4. **CAUTION** – Pull the clutch control rod backwards so that the sweeper will not move forward when the engine is started.
5. Start the engine and adjust as instructed in the engine Manual.

Your new POW-R-SWEEP Power Sweeper is now ready to sweep for you.

After you operate this machine for a short time check it over and refer to the following adjustments.

POW-R-SWEEP ADJUSTMENTS

BRUSH HEIGHT ADJUSTMENTS – loosen the two large wing nuts (Ref. No. 40, Fig. 2) just above the wheels and raise or lower the brushes to the desired height then tighten wing nuts. Always keep your brushes adjusted as high as good sweeping results will permit. This will add to the life of the brushes and the machine. Always keep the hood extension (Ref. No. 40, Fig. 1) which is located on the front of the machine adjusted low enough in front to prevent the sweepings from throwing ahead of the sweeper, but not so low that it may drag. Keep brushes and hood extension as high as good sweeping will permit.

BASKET AND WIND APRON – The wind apron does not necessarily have to be removed as the basket can very easily be removed by lifting up and sliding to the rear. Do not allow the basket frame to become twisted, the top must be kept level with the bottom rod to hook properly.

MAINTENANCE – Brushes – If the brushes should become bent or deformed from continual use, wet thoroughly with water and comb out straight with your fingers. Remember that the brush life is prolonged by adjusting the brushes so they contact the sweeping surface lightly.

CLUTCH ADJUSTMENT – If the engine belt slips due to wear, it will need occasional adjustment. To do this, leave the clutch engaged, loosen the engine mounting bolts and slide the engine back until the belt is tight, then declutch and move the engine back another 1/16 inch, then tighten the bolts up again. Loosen the two hex head screws holding the clutch mounting plate (Ref. No. 19, Fig. 1) to the sweeper and adjust the plate so it clears the top side of the belt by 1/8 inch. If the brush shaft belt becomes loose, a link should be removed from the belt to take care of belt stretch. To do this, roll the belt off of the brush shaft pulley, follow the instructions of how to uncouple and couple "veelos V Belt", as shown in the instructions furnished by the belt manufacturer, and are attached to the handle of the sweeper in a small envelope.

GENERAL – After each 4 or 5 hours of operation, check over all the nuts, bolts and set screws and tighten. Do this at least twice as any new machine of this kind, powered with a single cylinder engine, is apt to vibrate the fastenings loose until they become set.

When this sweeper is operating in deep turf it is best to lift the rear part up when backing. This allows the brushes to clear the turf and thus relieve the drag.

STORAGE – Clean and oil the Sweeper before winter storage. Also drain the gasoline from the tank. If desired to conserve space the Sweeper may be hung on a wall by removing the handle braces (Ref. No. 33, Fig. 2) and collapsing the Basket, facing the rollers to the wall; if this is done the oil should be drained from the crankcase.

REPAIR PARTS – To eliminate errors and delay in shipping orders, always give the following information: The model Number, found on the Hood and on the Left Hand Side Plate; year made or purchased; and the Serial Number found on your guarantee card.

"Right" and "Left" refer to the side of the Sweeper with the operator standing at the operating position.

Find the part wanted by referring to the exploded view, then give the part number and the quantity desired.

Order all parts from your nearest dealer.

To make valid your guarantee, make certain you have returned your serial identification card. Contact your nearest Engine Dealer for engine service and parts.

PARKER SWEEPER COMPANY
Bechtle Ave., Springfield, Ohio