



Electronic Service Manuals

This electronic document is provided as a service to our customers. We do not create the contents of the information contained in this document. Should you have detailed questions pertaining to the information contained in this document, you may contact Michco, or the manufacturer which provided the original information in this electronic deliverable. Michco's only part in this electronic deliverable was the electronic assembly process. By providing this manual on line we are not guaranteeing parts availability.

You may contact Michco through the following methods:

Phone (517) 484-9312 or (800) 331-3339

2011 N. High St. -- Lansing, Michigan -- 48906

Fax: (517) 484-9836

Email: CustServe@Michco.com

Web site: www.Michco.Com

Parts Web site: www.FloorMachineParts.Com

Order Parts on Line at:

www.FloorMachineParts.Com

Directly to Parts & Service:

By Email: **Shop@Michco.com**

By Fax: (517) 702-2041

By Voice: Use numbers above.

Serving the Cleaning Industry Since 1922

Notice: All copyrighted material remains property of original owners, all trademarks are property of respective owners. Manuals are subject to Manufacturer's reproduction limitations. Originals or reproductions were provided by manufacturers through a request. We make no warranty as to the correctness of information provided in this document and you assume all risk. By placing these manuals on line we are not declaring our corporation to be an manufacturer authorized dealer or provider, please check our web site for authorized manufacturers we represent.

MODEL PM 5636

PARKMASTER

OWNERS GUIDE

Parker
LAWN SWEEPERS

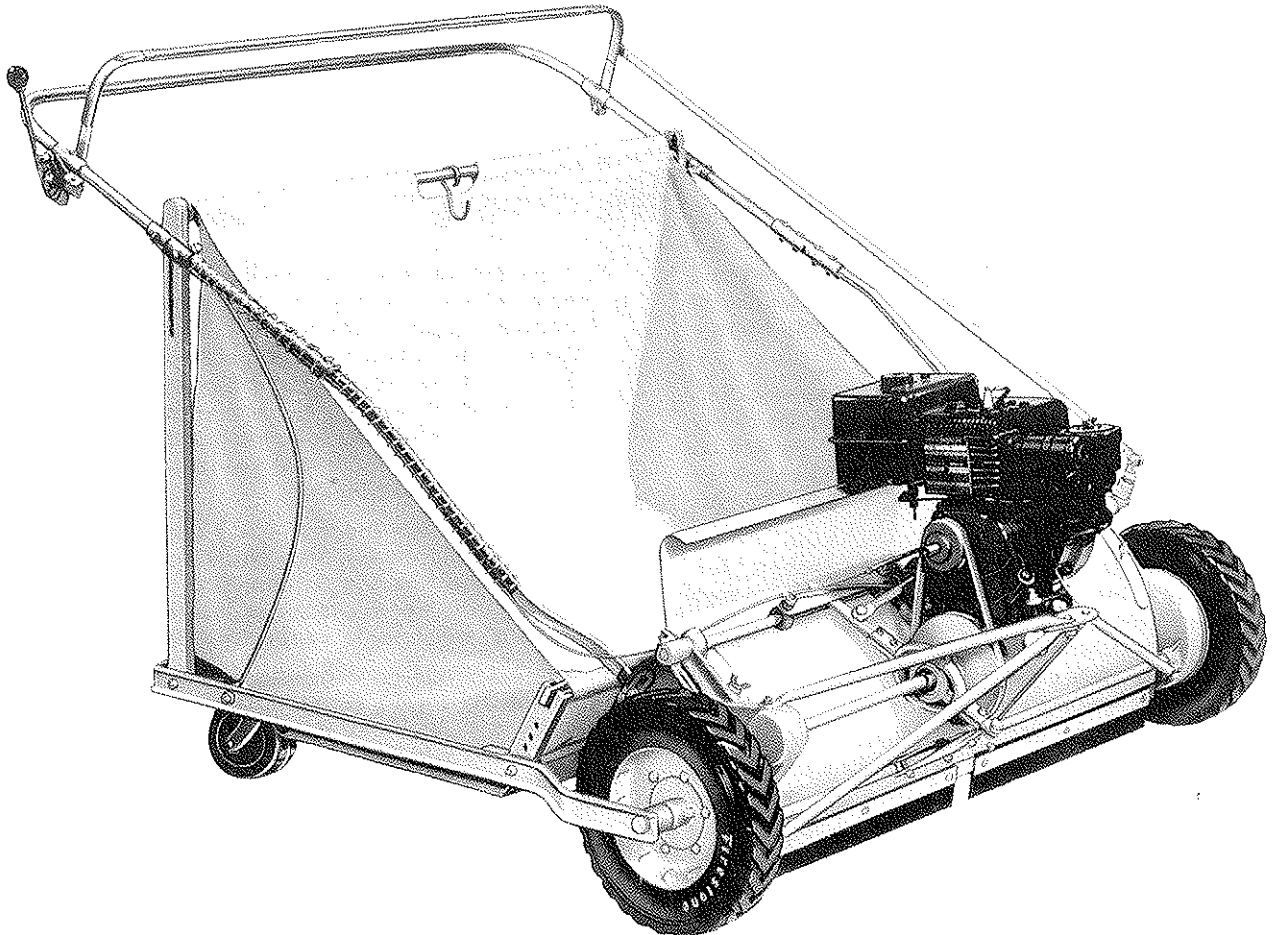

The *Parker* SWEEPER COMPANY • SPRINGFIELD, OHIO

ASSEMBLY AND OPERATING INSTRUCTIONS FOR THE MODEL PM-5636 PARKMASTER POWER LAWN SWEEPER

Please read these instructions through very carefully before attempting to set up and run. After reading the instructions through, proceed with the set-up as follows:

NOTE — Refer to the exploded view and reference numbers for parts identification.

UNPACKING INSTRUCTIONS

1. Have crated machine laying so that the wheels are down and the engine is up.
2. Open the crate and set the machine on the ground.
3. Unfasten the paper covered bundle from the machine and crate.
4. Open the paper bundle which contains the following items:
 - 1 Basket — Ref. No. 103
 - 1 Wind Aron — Ref. No. 99
 - 2 Handle Support Springs with hardware — Ref. No. 96
 - 1 Tube containing Wrap Spring — Ref. No. 65
 - 1 Clutch Rod — Ref. No. 56
 - 1 Envelope containing the following items:
 - 1 Engine Instruction Book
 - 1 Engine Starter Rope
 - 1 Allen Wrench for $\frac{3}{16}$ set screw — Ref. No. 70
 - 1 Guarantee Card
 - 1 Customer Purchase Record Post Card
5. Remove the two wires that hold the handle assembly, Ref. No. 82, to the basket support frame, Ref. No. 98.

ASSEMBLY INSTRUCTIONS

1. Lift the upper handle section, Ref. No. 82, and pull it straight back and lay this handle assembly at the rear of the machine with the throttle handle and clutch bar up.
2. Remove the two round head machine screws, Ref. No. 77, that are located at the end of each of the upper handle, Ref. No. 82. Loosen but do not remove the other two screws that hold the couplings to the lower handle sections, Ref. No. 85. Do this on both sides of the machine.
3. Insert the ends of the upper handle section, Ref. No. 82, into the loosened couplings, making sure that the throttle control, Ref. 73, is up, to the right side of the machine. The right side of the machine is the side to your right when you are standing at the rear end looking forward towards the engine.
4. Replace the two round head machine screws into the handle and couplings. Do this on each side of the machine. Tighten these screws very securely.
5. Remove the hex head bolts, Ref. No. 28, and shoulder bushings, Ref. No. 107, which are located about two inches from the rear of the basket frame at each side of the machine.
6. Place the small end of the bushing into the round hole which is located at the bottom end of the handle support channel, Ref. No. 94. Place this bushing into the channel from the inside. Place the hex head bolt through the bushing and into the hole of the basket frame from which you removed it and then place the lock washer, Ref. No. 32, and hex nut, Ref. No. 23, and tighten. Do this on both sides of the machine.
7. Remove the hex nut, Ref. No. 22, lock washer, Ref. No. 32, one clamp, Ref. No. 89. Do not remove the second hex nut, clamp, and the round head screw, Ref. No. 93, that are located at the end of each of the handle support springs, Ref. No. 96.
8. These springs must be assembled to the machine in the following manner: To make the assembly for the right hand side, hold the spring in your left hand with the loop end up and towards you. Place this assembly into the inside hole of the right side handle, Ref. No. 82. This hole is located just forward of the handle support channel, Ref. No. 94. Place the other clamp, Ref. No. 89, over the screw that projects through the handle. This clamp must have the inside of the curve towards the

PARKMASTER POWER LAWN SWEEPER	SIZE 36"	PRODUCTION YEAR 1956 & 1957	MODEL No. PM-5636
--	---------------------	--	------------------------------

REF. No.	PART No.	QTY. PER UNIT	DESCRIPTION	REF. No.	PART No.	QTY. PER UNIT	DESCRIPTION
1	55-144-A	7	Shoulder Bolt	42	50-72-B	1	Clutch Bracket
2	935-616	2	Spring Lock Washer $\frac{3}{8}$	43	49-74-D	1	Engine Mtg. Bracket
3	53-16-A	9	Washer	44	56-52-B	1	Top Brace
4	936-416	30	Internal Tooth Lock Washer $\frac{1}{4}$	45	560-C-516-10	7	Sq. Head Set Screw ($\frac{5}{16}$ -18 x $\frac{3}{8}$)
5	56-10-D	1	Clutch Bar Handle	46	564-C-516-16	5	Allen Head Set Screw ($\frac{5}{16}$ -18 x 1)
6	56-104-A	1	Engine (Briggs & Stratton 6B)	47	56-37-B	1	Friction Strip
7	48-277-A	1	Key ($\frac{3}{16}$ sq. x $1\frac{1}{8}$ long)	48	515-416-24	2	Round Head Mach. Screw ($\frac{1}{4}$ -20 x $1\frac{1}{2}$)
8	56-41-A	1	V-Belt Pulley	49	56-57-C	1	Hood Baffle
9	564-C-516-4	3	Allen Head Set Screw ($\frac{5}{16}$ -18 x $\frac{1}{4}$)	50	56-36-A	2	Collar
10	54-128-A	1	V-Belt	51	56-23-B	1	Top Tie Rod
11	56-39-D	1	Hood	52	56-35-B	1	Transverse Clutch Rod Lever
12	49-11-A	2	Hood Clamp	53	56-32-A	1	Shoulder Bolt
13	351-516-20	2	Wing Nut ($\frac{5}{16}$ -18 x $1\frac{1}{4}$)	54	560-C-416-6	1	Sq. Head Set Screw ($\frac{1}{4}$ -20 x $\frac{3}{8}$)
14	49-251-B	1	R. H. Metal Hood Ext.	55	56-26-A	1	Pivot Pin
15	505-416-12	6	Flat Head Mach. Screw ($\frac{1}{4}$ -20 x $\frac{3}{4}$)	56	56-22-B	1	Clutch Control Lever (upper)
16	49-248-B	1	R. H. Rubber Hood Ext.	57	46-81-A	1	Washer
17	49-250-B	1	L. H. Metal Hood Ext.	58	53-65-A	1	Roll Pin R/W 71-06-A
18	49-249-B	1	L. H. Rubber Hood Ext.	59	56-21-B	1	Bell Crank Lever
19	335-416	27	Hex Nut ($\frac{1}{4}$ -20)	60	56-25-B	1	Clutch Control Block
20	351-416-18	2	Wing Nut ($\frac{1}{4}$ -20)	61	49-91-LE	1	L. H. Side Plate
21	346-416	8	Speed Nut ($\frac{1}{4}$ -20)	62	49-258-A	1	Front Tie Rod
22	340-516	28	Hex Jam Nut ($\frac{5}{16}$ -18)	63	49-269-B	2	Bottom Tie Rod Brace
23	335-516	35	Hex Nut ($\frac{5}{16}$ -18)	64	49-254-B	1	Reel Shaft
24	945-516	15	Washer $\frac{3}{8}$	65	54-162-A	1	Spiral Cable Clip
25	65-516-32	4	Hex Hd. Mach. Bolt ($\frac{5}{16}$ -18 x 2)	66	380-232-8	2	Cotter Pin ($\frac{1}{16}$ x $\frac{1}{2}$)
26	66-516-12	2	Sq. Hd. Mach. Bolt ($\frac{5}{16}$ -18 x $\frac{3}{4}$)	67	56-56-A	2	Adj. Screw Handle
27	65-516-12	13	Hex Hd. Mach. Bolt ($\frac{5}{16}$ -18 x $\frac{3}{4}$)	68	20-84-6	1	Conduit Control Cable $\frac{3}{8}$
28	65-516-16	15	Hex Hd. Bolt ($\frac{5}{16}$ -18 x 1)	69	54-209-A	1	Hook - Wind Apron
29	30-88-054	1	Control Cable Wire	70	49-296-A	1	Allen Wrench $\frac{3}{32}$
30	515-8-8	3	Round Head Mach. Screw ($\frac{8}{32}$ x $\frac{1}{2}$)	71	49-295-A-6	1	Elastic Cord
31	936-10	2	Lock Washer	72	335-8	2	Nut (8-32)
32	936-516	54	Internal Tooth Lock Washer $\frac{3}{8}$	73	55-131-B	1	Throttle Handle Assy.
33	51-37-A	4	Ball Bearing	74	55-130-A	1	Ball Knob Handle
34	56-8-A	1	Disc Clutch	75	55-136-A	1	Throttle Cable Clamp
35	56-9-A	1	Clutch Fork (set 2)	76	55-138-B	1	Clutch and Throttle Bracket
36	56-15-A	1	Lower Clutch Fork Ext.	77	515-416-20	10	Rd. Hd. Screw ($\frac{1}{4}$ -20 x $1\frac{1}{4}$)
37	515-416-16	4	Round Head Mach. Screw ($\frac{1}{4}$ -20 x 1)	78	53-165-A	1	Cupped Washer
38	56-16-A	1	Upper Clutch Fork Ext.	79	55-156-A	2	Washer
39	56-17-A	1	Clutch Bracket	80	55-132-A	1	Throttle Spacer
40	515-416-8	3	Round Hd. Mach. Screw ($\frac{1}{4}$ -20 x $\frac{1}{2}$)	81	945-616	4	Washer $\frac{3}{8}$
41	65-516-20	2	Hex Hd. Mach. Bolt ($\frac{5}{16}$ -18 x $1\frac{1}{4}$)	82	56-20-D	1	Upper Handle
				83	49-257-A	1	Rear Tie Rod
				84	53-44-B	2	Handle Clamp (set 2)
				85	56-28-1D	1	L. L. H. Handle
				86	56-28-RD	1	L. Right Hand Handle
				87	52-110-A	2	Lower Basket Hanger
				88	55-134-A	1	Clutch Bracket
				89	4584-A	8	Handle Clamp

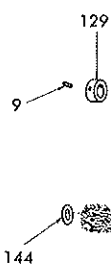
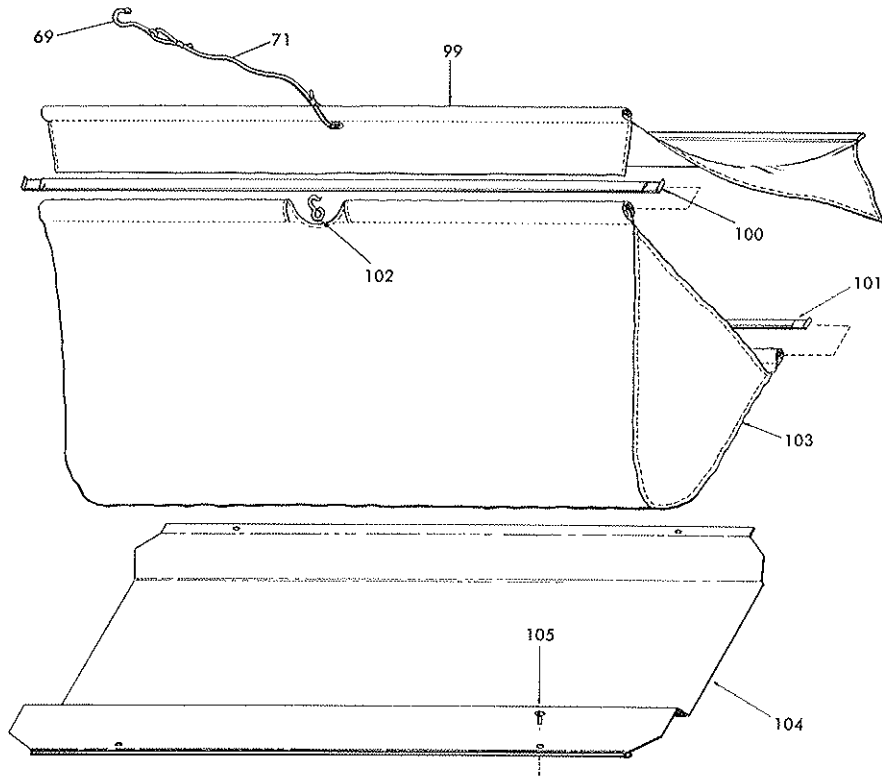
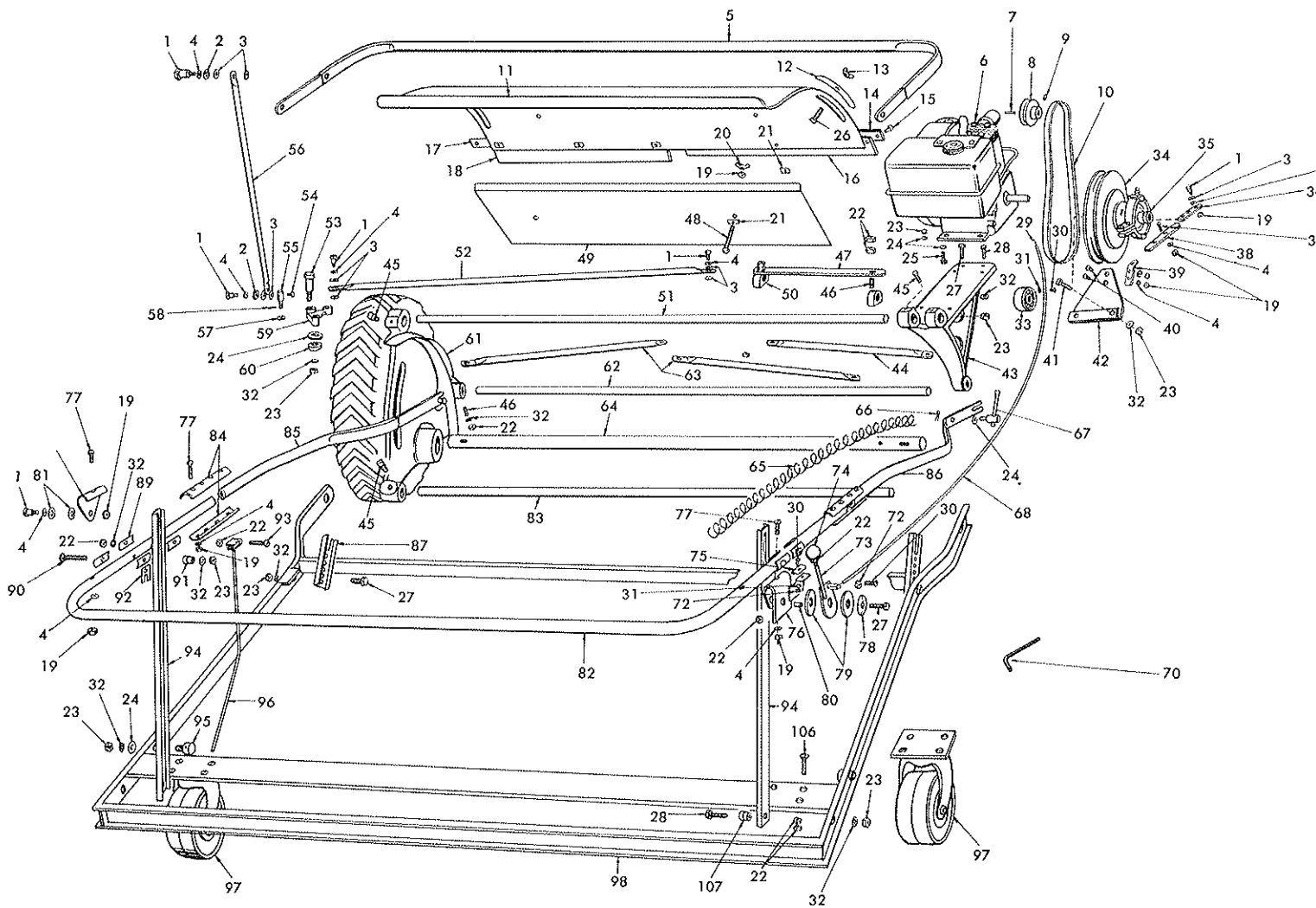

REF. No.	PART No.	QTY. PER UNIT	DESCRIPTION	REF. No.	PART No.	QTY. PER UNIT	DESCRIPTION
90	70-516-32	2	Carriage Bolt (5/16-18 x 2)	128	564-C-516-6	4	Allen Head Set Screw (5/16-18 x 3/8)
91	4553-A	2	Spacer	129	56-53-A	1	Collar
92	53-55-A	2	Top Basket Rod Clip	130	280-9	1	Woodruff Key
93	515-516-32	2	Round Head Mach. Screw (5/16-18 x 2)	131	280-5	2	Woodruff Key
94	52-109-B	2	Handle Support	132	56-29-A	1	Jack Shaft
95	49-261-A	2	Spring Pivot Block	133	47-229-A	1	Control Cable Clip
96	49-252-B	2	Handle Support Spring Assy.	134	49-246-C	1	Inner Side Plate
97	56-65-A	2	5" Dual Wheel Caster	135	47-101-B	1	Belt Guard Cover
98	49-262-C	1	Basket Frame Assy.	136	47-86-A	1	Clutch Spring
99	56-60-D	1	Wind Apron (Model WPM-5636)	137	47-90-A	1	Clutch Pin Sleeve
100	53-53-B	1	Top Basket Rod	138	47-98-A	1	Clutch Drive Pin Assy.
101	53-54-B	1	Bottom Basket Rod	139	47-89-A	1	Clutch Spring Pin
102	48-282-A	1	Hook	140	47-85-A	1	Clutch Spring Retainer
103	56-55-D	1	Basket Canvas	141	47-222-A	1	Sprocket (12 tooth)
104	49-302-C	1	Basket Bottom	142	56-76-A	1	Spacer
105	535-T0-6	4	Drive Screw (10 x 3/8)	143	47-280-A	1	Roller Chain (140 links)
106	505-516-16	8	Flat Head Mach. Screw (5/16-18 x 1)	144	946-1016-16	4	Fiber Washer
107	49-260-A	2	Spacer	145	47-97-C	1	Jack Shaft Bracket
108	56-24-RE	1	R. H. Side Plate	146	65-416-20	1	Hex Hd. Bolt (1/4-20 x 1 1/4)
109	515-416-32	3	Round Head Mach. Screw (1/4-20 x 2)	147	945-416	1	Washer 1/4
110	936-816	2	Internal Tooth Lock Washer 1/2	148	55-161-A	4	Washer
111	345-816	2	Hex Jam Nut (1/2-20)	149	49-255-A	1	Clutch Spacer
112	946-1416-20	4	Fiber Washer	150	564-C-516-8	2	Allen Head Set Screw (5/16-18 x 1/2)
113	53-29-A	2	Drive Lock Pin	151	47-94-C	1	Chain Guard
114	47-242-A	2	Axle Stud	152	47-282-A	1	Connector Link
115	4525-A	2	Pawl	153	505-416-16	3	Flat Head Mach. Screw (1/4-20 x 1)
116	56-18-RC	1	R. H. Pinion <i>R/W 45-19-RA</i>	154	47-88-A	1	Sprocket (40 tooth)
116	56-19-LC	1	L. H. Pinion <i>R/W 45-19-LA</i>	155	47-84-B	1	Clutch Housing
117	48-226-A	2	Pinion Cover	156	47-96-B	1	Chain Guard Cover
118	505-416-8	4	Flat Head Mach. Screw (1/4-20 x 1/2)	157	49-292-A	2	Needle Bearing
119	47-243-C	2	Wheel Gear	158	49-253-B	1	Reel Tube
121	55-91-B	2	Hub Assy.	159	66-516-24	8	Sq. Hd. Machine Bolt (5/16-18 x 1 1/2)
123	56-7-A	4	Wheel Rim	160	49-432-B	8	Brush Bracket Cap
124	56-6-B	2	Tire	161	49-431-B	8	Brush Bracket
126	997-1416	2	Retaining Ring Washer 3/8	162	49-157-C-9	1	Brush Assy. (set 8)
127	47-325-A	2	Axle Extension	163	70-516-24	8	Carriage Bolt (5/16-18 x 1 1/2)
				164	286-A-3	2	Alemite Fitting #1792
					56-31-D	1	Handle Assy. Complete

INSTRUCTIONS FOR ORDERING PARTS

- Order all parts from your nearest Authorized Parker Service Station. Orders received at the factory will be referred to the nearest Authorized Parker Service Station.
- Print your name and address clearly—state shipping address if different from mailing address.
- Specify sweeper model number (found on side plate or hood) and length of brushes.
- Give part number and name as shown on parts list.
- Specify quantity.
- If a part cannot be identified, return it with your order. (Do not ship any parts to the factory.)

The words "right" and "left" refer to the sides of the sweeper when facing in the direction machine travels in use.

handle. Place the lock washer and hex nut and tighten securely.

9. To make the spring assembly for the left hand side, hold the spring in your right hand with the loop up and towards you. Follow the above instructions for the right side from this point on, except assembly will be on the left side of the machine.
10. Turn the handle support spring pivot blocks, Ref. No. 95, which are located about six inches from the rear of the basket support frame, Ref. No. 98, so that the holes in them are up and turned forward to about 45 degrees or a one-eighth turn. Grasp the lower part of the basket support spring, Ref. No. 96, firmly and insert the end into the hole in the spring pivot block, Ref. No. 95. Do this on both sides of the machine.
11. Loosen but do not remove the round head screw, Ref. No. 30, which is located in the end of the hex pivot throttle wire connector which is located just forward of the throttle handle post, Ref. No. 73. Make sure that this pivot turns freely.
12. Loosen the round head screw, Ref. No. 30, that holds the throttle cable clamp, Ref. No. 75, which is located on the shelf projection just forward of the throttle handle assembly, turn this clamp, Ref. No. 75, around so that the angle is towards the handle.
13. Place the throttle wire, Ref. No. 29, into the small hole in the hex pivot and the throttle cable, Ref. No. 68, under the cable clamp, Ref. No. 75, so that the end of the cable is flush with the clamp. Tighten this clamp onto the cable.
14. Push the throttle knob, Ref. No. 74, forward as far as it will go, allow the throttle wire to slip through the hex swivel and do not tighten the throttle wire screw at this time.
15. Refer to page eight, illustration number 3033, of the Engine Instruction book and pull the top speed limit device upwards as far as it will go.
16. Now tighten the screw which holds the throttle wire into the hex swivel. Be sure to hold the hex swivel with a wrench when you tighten the screw and lock nut so that you do not bend the throttle control wire.
17. Remove the wrap spring, Ref. No. 65, from the cardboard tube. Wind this spring over the handle and throttle cable, starting at the point just forward of the handle support spring, Ref. No. 96. The throttle cable should run along the outside of the handle, nesting into the slot formed by the two handle couplings, Ref. No. 85. Continue winding down the handle, terminating at the lower curve of the handle.
18. Remove the shoulder bolt, Ref. No. 1, with the two flat washers, Ref. No. 3, one spring washer, Ref. No. 2, and one internal tooth lock washer, Ref. No. 4, from the clutch control bar, Ref. No. 5, which is located on the left side of the machine, about 4 inches from the end of the clutch bar, Ref. No. 5.
19. Place the spring lock washer, Ref. No. 2, next to the head of the shoulder bolt, followed by one flat washer. With the clutch rod, Ref. No. 56, held so that the flat or flush side is towards the clutch bar, Ref. No. 5, place the shoulder bolt into the hole in the clutch rod. Place another flat washer, Ref. No. 3, followed by the internal tooth lock washer, Ref. No. 4, on the screw. Fasten this assembly to the clutch bar back in the threaded hole from which the shoulder bolt was removed. Be sure that the inside flat washer is free and up on the shoulder before tightening, if free, tighten the shoulder bolt, Ref. No. 1.
20. Loosen the square head set screw, Ref. No. 54, which is located in the hex swivel, Ref. No. 55, of the bell crank, Ref. No. 59, just above the left wheel.
21. Remove the shoulder bolt, Ref. No. 1, which is opposite the square head set screw, Ref. No. 54, in the hex swivel post, Ref. No. 55.
22. Remove the hardware in the same manner as you did the above shoulder bolt. Fasten the clutch rod to the hex post and tighten the shoulder bolt, then tighten the square head set screw which locks the shoulder bolt.
23. Place the basket, Ref. No. 103, into the machine as follows: Place the rod with the hook, Ref. No. 102, into the slots of the rear channel supports, Ref. No. 94, the front rod into the front channel supports, Ref. No. 87. Make sure that the basket is turned right side out by looking at the hem which is formed by the loop in the yellow canvas through which the basket rods are contained. The hem should be to the outside.
24. The wind apron is installed as follows: Place the metal edge over the curved lip at the top of the sweeper hood, Ref. No. 11, and place the hook at the end of the elastic cord, over the handle, making certain the cord is under the clutch bar and over the basket top rod.

OPERATION, MAINTENANCE AND ADJUSTMENTS

1. Refer to the Engine Instruction book for oiling and other procedure.
2. When the engine is ready to start, have the clutch bar, Ref. No. 5, pulled backwards into the de-clutched position.
3. Start your engine.
4. Adjust engine idle speed with the throttle handle in the full forward position.
5. Cut off the extra throttle wire that projects through the hex swivel, cut this off about a half inch from the hex swivel and bend downwards. Be careful not to bend the throttle wire while doing this.

6. Stop the engine.
7. Adjust the machine so that the engine is level with the ground. To do this, loosen the clamp screws, Ref. No. 67, which are located at the lower end of the handles on each side plate. When engine is level, retighten the clamp screws.
8. Remove and read the tag which is located on the right side of the brush reel shaft for engaging the pin clutch, Ref. No. 138. Remove and read the tag which is located on the drive clutch, Ref. No. 34, just below the engine. After reading these tags, place them in the engine instruction book for future reference.
9. Correct brush height is always relative to the conditions of the turf on which you are sweeping and the best thing to remember is always have your brushes adjusted as high as possible and yet sweeping. Having your engine level is a good average trial adjustment. Also, the hood should be adjusted as high as possible without allowing debris to throw ahead of the sweeper. To adjust the hood, loosen the wing nuts, Ref. No. 13, which are located at the outside edge of the hood, next to the side plates. Raise or lower the hood to the desired height and tighten the wing nuts.
10. As the brushes wear or bend over with use and the brush tips do not contact the secondary hood, Ref. No. 49, the sweeping action will reduce to the extent that the debris will not flow to the rear of the basket. When this occurs, loosen the wing nuts, Ref. No. 20, and hex nuts which are located about ten inches from the side plates towards the center of the hood. Loosen the nuts so that the patented secondary hood springs out towards the brush tips. When the brush tips lightly touch this secondary hood, tighten the wing nuts while holding the hex nuts with a wrench. This will hold the secondary hood in adjustment. When the brushes wear down to a point that they no longer will touch the secondary hood with it fully adjusted, replace with new brushes.
11. To tighten the drive belt, Ref. No. 10, raise the engine by transposing the extra flat washers provided, from the top of the engine base to under the engine base.
12. Lubricate as follows: Refer to the Engine Instruction book for the engine, and to the tag which was removed from the clutch for clutch lubrication. Grease fittings are provided at each wheel hub, also at each end of the brush reel shaft. These points are lubricated with a grease gun. ALL of the other moving parts should be oiled with a drop or two of SAE-20 oil whenever used or about every other day while the sweeper is being used. To oil the wheel gears, simply drop some oil in the two oil holes that are provided in each side plate.
CAUTION — Do not maneuver this machine by the clutch bar. Turning around, pushing or pulling backwards must be done with the handle only or severe damage will be done to the clutch bar linkage.
 Keep your sweeper in good adjustment and well lubricated. Store in a clean, dry place when not in use. For winter storage, drain the gas tank and run the engine to empty the carburetor and fuel line.
REPAIR PARTS: To eliminate errors and delay in shipping orders, always give the following information. The Model Number, found on the Hood and on the Left Hand Side Plate; year made or purchased; and the Serial Number found on the Side Plate. Order all parts from your nearest dealer.
 To make valid your guarantee, make certain you have returned your serial identification card. Contact your nearest Engine Dealer for engine service and parts.

PARKER
RS SWEEPER *Company*
 ESTABLISHED 1884 SPRINGFIELD, OHIO · U. S. A.