



Electronic Service Manuals

This electronic document is provided as a service to our customers. We do not create the contents of the information contained in this document. Should you have detailed questions pertaining to the information contained in this document, you may contact Michco, or the manufacturer which provided the original information in this electronic deliverable. Michco's only part in this electronic deliverable was the electronic assembly process. By providing this manual on line we are not guaranteeing parts availability.

You may contact Michco through the following methods:

Phone (517) 484-9312 or (800) 331-3339

2011 N. High St. -- Lansing, Michigan -- 48906

Fax: (517) 484-9836

Email: CustServe@Michco.com

Web site: www.Michco.Com

Parts Web site: www.FloorMachineParts.Com

Order Parts on Line at:

www.FloorMachineParts.Com

Directly to Parts & Service:

By Email: **Shop@Michco.com**

By Fax: (517) 702-2041

By Voice: Use numbers above.

Serving the Cleaning Industry Since 1922

Notice: All copyrighted material remains property of original owners, all trademarks are property of respective owners. Manuals are subject to Manufacturer's reproduction limitations. Originals or reproductions were provided by manufacturers through a request. We make no warranty as to the correctness of information provided in this document and you assume all risk. By placing these manuals on line we are not declaring our corporation to be an manufacturer authorized dealer or provider, please check our web site for authorized manufacturers we represent.



ASSEMBLY AND OPERATING INSTRUCTIONS

HURRICANE

MODEL HC-6970

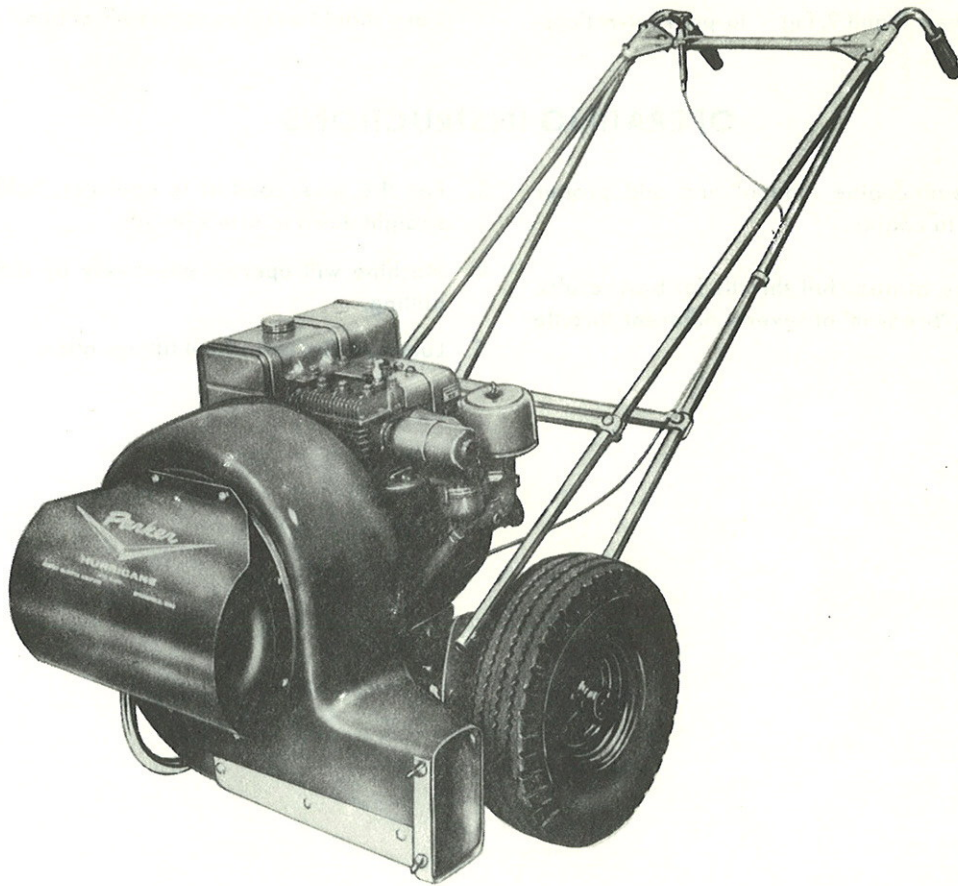

The Hurricane is packed in two cartons. One contains the power unit and the other contains the handle components.

To facilitate assembly of the Hurricane, we have placed all of the attaching bolts, lock nuts, and inserts into their correct locations on the various parts. When removing these items for assembly purposes, be sure they are reinstalled in the same manner.

REMOVAL OF POWER UNIT FROM CARTON

1. Open top of carton, then lay carton on side so unit can be rolled out. Place unit in upright position. Care should be taken to see that the throttle control cable is not damaged or kinked during removal of the unit from the carton.

HANDLE INSTALLATION

1. Remove handle componets from other carton, Fig. 2. Assemble all handle componets (Except Item 16) loosely as shown in Fig. 2. (Hand Tighten Nuts) Connect handle tubes Item 14 to top most hole in Items 8 and 9, Fig. 1. Connect braces Item 15 in bottom hole in Items 8 and 9, Fig. 1. Be sure to place Item 16 in the ends of handle tubes Item 14 and braces Item 15 before inserting screw thru Items 8 and 9, Fig. 1 to prevent collapsing tubes when nut is tightened. Now tighten all nuts alternating from side to side and top to bottom of handle assembly. The handle should now be a rigid part of the power unit.
2. Uncoil throttle assembly Item 12, Fig. 2 from around engine and fasten cable in cable clamps Items 21 and 31. Bolt throttle bracket Item 13 to cross brace Item 18. Care should be taken not to kink, or bend cable sharply.

OPERATING INSTRUCTIONS

1. **IMPORTANT:** Read engine manual and add proper gasoline and oil to engine.
2. Operate machine at near full throttle for best results. If engine is new, "break in" at several different throttle settings.
3. For the most comfort to operator, hold handle grips straight down at arm's length.
4. Machine will operate effectively by either pushing or pulling.
5. Lubricate the two wheel fittings often.

ALWAYS GIVE THE FOLLOWING INFORMATION WHEN ORDERING REPAIR PARTS

If you are unable to obtain parts locally, write to the factory for name of nearest service dealer.

1. Part Number and Quantity.
2. Model Number (found on hood).
3. Serial Number (found on guarantee card).

Your unit is right hand (R.H.) or left hand (L.H.) as you stand behind it.

*Standard hardware items may be purchased locally.

MODEL HC - 6970 HURRICANE PARTS LIST

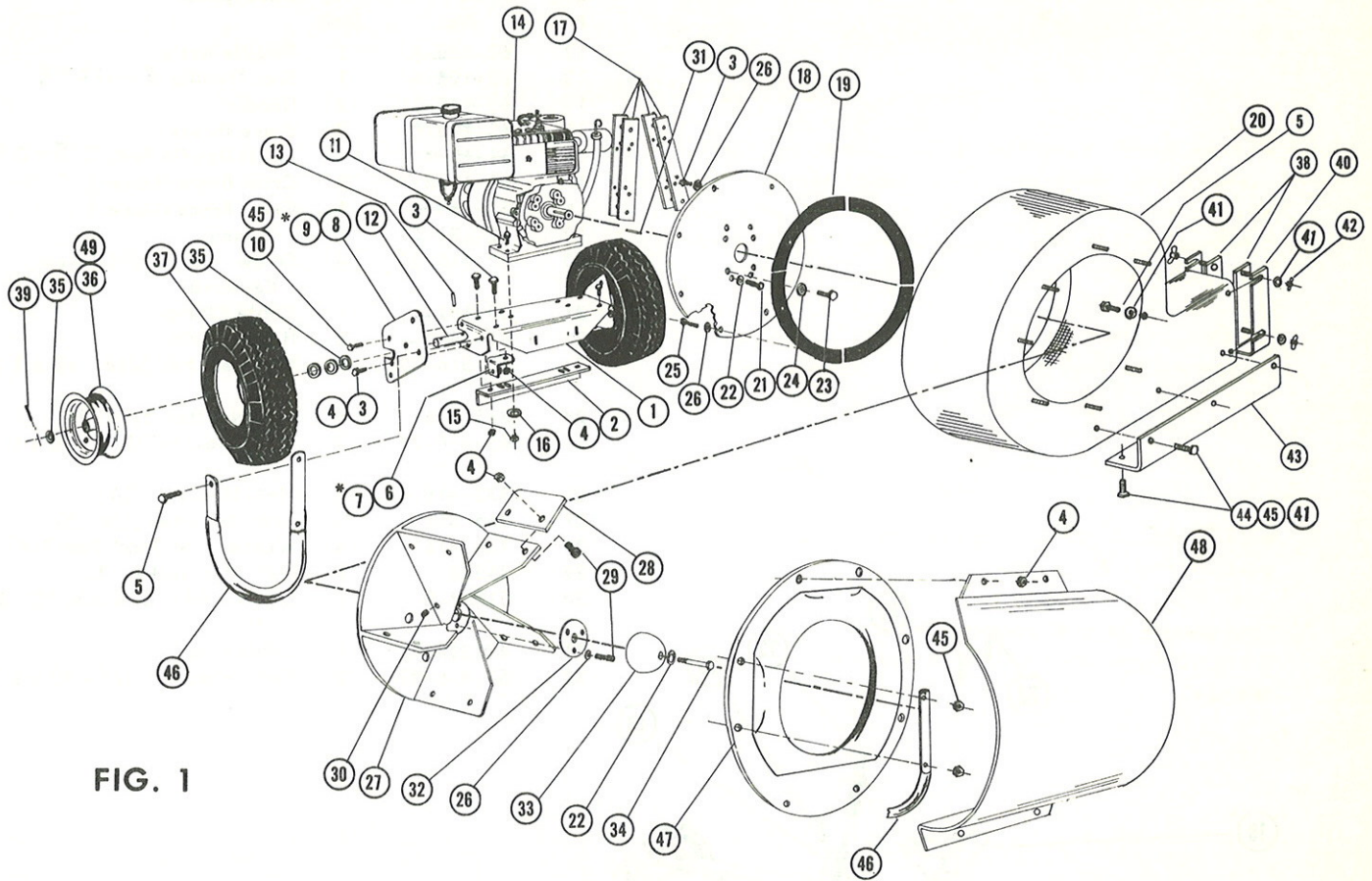

FIG. 1

| Ref. No. | Part No. | Qty. Per Unit | Description | Ref. No. | Part No. | Qty. Per Unit | Description |
|----------|---------------------|---------------|-----------------------------------|----------|---------------------------|---------------|-------------------------------------|
| 1 | 64-111-F | 1 | Bracket - Engine | 26 | 936-416 | 11 | Washer - (Int. Tooth Lock) 1/4 |
| 2 | 66-440-B | 1 | Support - Angle | 27 | 63-88-EA | 1 | Fan - Wheel 72-175-D |
| 3 | 65-416-12 | 16 | Bolt - Hex. Hd. 1/4 - 20 x 3/4 | 28 | 62-228-B | 5 | Extension Fan Blade |
| 4 | 365-416 | 25 | Nut - Hex. Lock 1/4 - 20 | 29 | 524-416-12 | 13 | Screw - Soc. Hd. Cap 1/4 - 20 x 3/4 |
| 5 | 65-416-16 | 9 | Bolt - Hex. Hd. 1/4 - 20 x 1 | 30 | 564-C-516-16-1 | 1 | Screw - Allen Hd. Set 5/16 - 18 x 1 |
| 6 | 65-36-RA | 1 | Brace (R. H.) | 31 | 63-130-A | 1 | Key Engine |
| 7 | 65-37-LA | 1 | Brace (L. H.) | 32 | 63-10-A | 1 | Plate - Retainer |
| 8 | 64-60-RC | 1 | Brkt. - Handle & Axle (R. H.) | 33 | 61-10-AD | 1 | Retainer - Fan |
| 9 | 64-61-LC | 1 | Brkt. - Handle & Axle (L. H.) | 34 | 64-120-A | 1 | Bolt - Special 3/8 - 24 x 2 1/2 |
| 10 | 65-516-12 | 4 | Bolt - Hex. Hd. 5/16 - 18 x 3/4 | 35 | 945-1216 | 8 | Washer - Plain SAE 3/4 |
| 11 | 65-516-28 | 4 | Bolt - Hex. Hd. 5/16 - 18 x 1 3/4 | 36 | 68-447-B | 2 | Wheel |
| 12 | 64-125-B | 1 | Axle | 37 | 68-312-A | 2 | Tire - Tubless |
| 13 | 67-521-A | 4 | Roll Pin 3/16 Dia. x 1 | 38 | 69-65-A | 2 | Plate Washer (Weldment) |
| 14 | 69-36-A | 1 | Engine B & S 7 H. P. | 39 | 380-432-20 | 2 | Cotter Pin 1/8 Dia. x 1 1/4 |
| 15 | 365-516 | 4 | Nut - Hex Lock 5/16 - 18 | 40 | 69-64-B | 1 | Guard - Blower Outlet |
| 16 | 945-516 | 4 | Washer (5/16) | 41 | 945-416 | 12 | Washer - Plate SAE Med. 1/4 |
| 17 | 64-110-B | 4 | Spacer Tie Bar | 42 | 351-416-18 | 4 | Wing Nut - 1/4 - 20 |
| 18 | 64-109-C | 1 | Back Cover | 43 | 69-62-B | 1 | Shield Blower Housing |
| 19 | 64-78-C | 4 | Anti - Wrap Segment | 44 | 65-416-8 | 5 | Bolt - Hex. Hd. 1/4 - 20 x 1/2 |
| 20 | 69-61-D | 1 | Housing - Blower <i>SA-1199-C</i> | 45 | 364-416 | 8 | Nut - Hex Lock 1/4 - 20 Thin |
| 21 | 65-616-20 | 4 | Bolt - Hex. Hd. 3/8 - 16 x 1 1/4 | 46 | 64-114-D | 1 | Support Tube |
| 22 | 935-616 | 5 | Washer - Spring Lock 3/8 | 47 | 62-188-D | 1 | Front Plate |
| 23 | 60-516-20 | 4 | Bolt - Hex Hd. 5/16 - 24 x 1 1/4 | 48 | 62-206-E | 1 | Guard |
| 24 | 935-516 | 4 | Washer - Spring Lock 5/16 | 49 | 68-313-A | 1 | Valve |
| 25 | 65-416-24 | 2 | Bolt - Hex. Hd. 1/4 - 20 x 1 1/2 | | | | |

* Left Hand Not Shown

MODEL HC-6970 HURRICANE PARTS LIST

| Ref. No. | Part No. | Qty. Per Unit | Description |
|----------|---------------------|---------------|-------------------------------------|
| 12 | 63-149-A | 1 | Throttle Ass'y. |
| 13 | 62-128-A | 1 | Brkt. Throttle <i>81-02-4</i> |
| 14 | 63-147-B | 2 | Handle |
| 15 | 63-148-B | 2 | Brace Thruss |
| 16 | 61-13-A | 4 | Insert Handle Ends <i>75-30-4</i> |
| 17 | 61-11-B | 2 | Cross Brace (Lower) |
| 18 | 63-150-A | 1 | Cross Brace (Upper) |
| 19 | 62-131-C | 4 | T - Clamp |
| 20 | 69-416-20 | 4 | Screw - Curver Hd. Stress Relieved |
| 21 | 68-101-A | 1 | Cable Clamp |
| 22 | 61-26-A | 2 | Handle Grip |
| 23 | 65-516-20 | 4 | Bolt Hex. Hd. 5/16 - 18 x 1 1/4 |
| 24 | 365-516 | 4 | Lock Nut Hex. 5/16 - 18 |
| 25 | 65-416-24 | 5 | Bolt - Hex. Hd. 1/4 - 20 x 1 1/2 |
| 26 | 335-416 | 4 | Nut - Hex. 1/4 - 20 |
| 27 | 365-416 | 11 | Lock Nut - Hex. 1/4 - 20 |
| 28 | 936-416 | 4 | Washer - Int. Tooth Lock 1/4 |
| 29 | 365-8 | 1 | Nut - Hex. Lock 8 - 32 |
| 30 | 515-8-8 | 1 | Screw - Rd. Hd. Mach. #8 - 32 x 1/2 |
| 31 | 47-220-A | 1 | Cable Clip |
| 32 | 65-416-20 | 2 | Bolt - Hex. Hd. 1/4 - 20 x 1 1/4 |

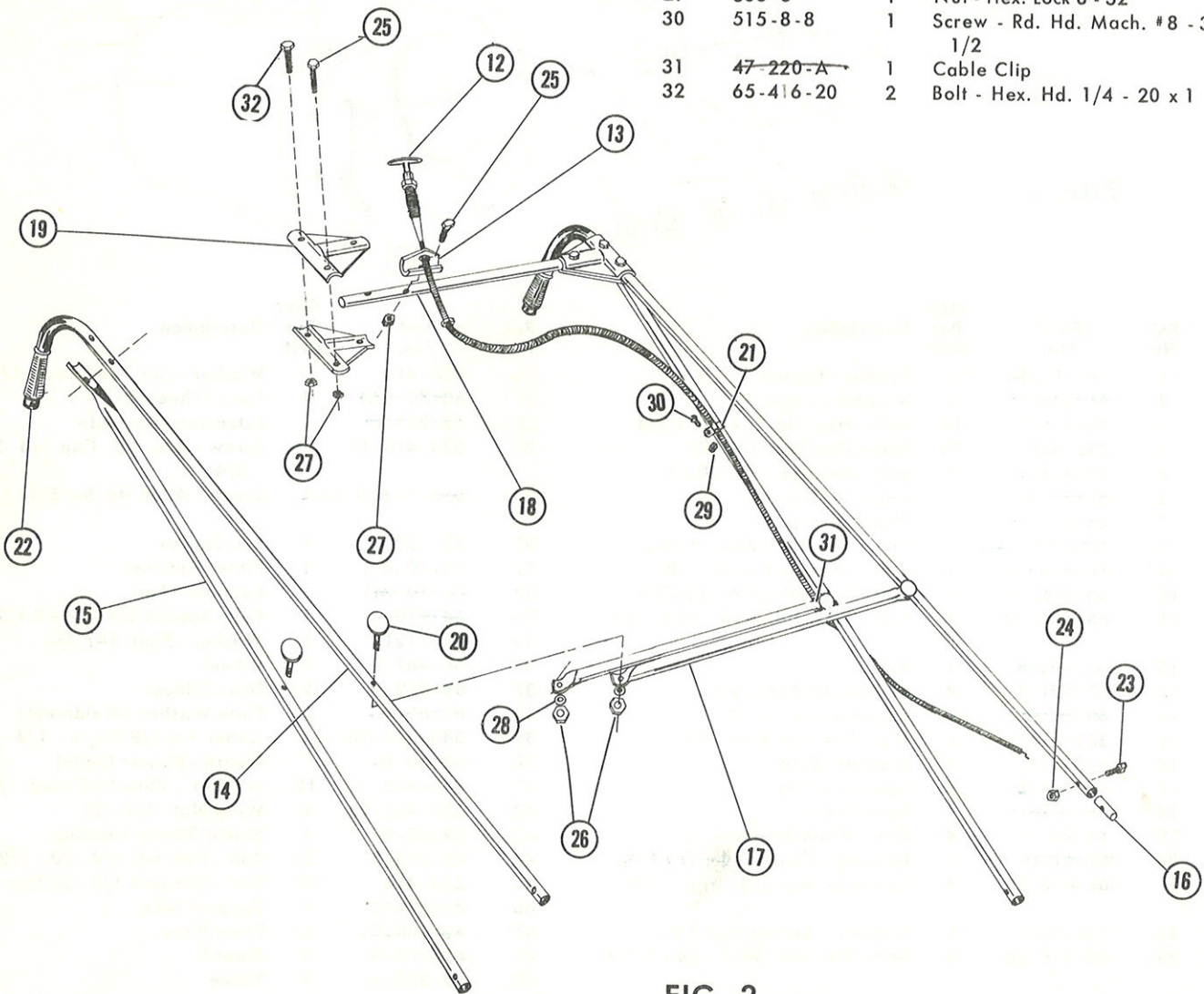

FIG. 2