



Electronic Service Manuals

This electronic document is provided as a service to our customers. We do not create the contents of the information contained in this document. Should you have detailed questions pertaining to the information contained in this document, you may contact Michco, or the manufacturer which provided the original information in this electronic deliverable. Michco's only part in this electronic deliverable was the electronic assembly process. By providing this manual on line we are not guaranteeing parts availability.

You may contact Michco through the following methods:

Phone (517) 484-9312 or (800) 331-3339

2011 N. High St. -- Lansing, Michigan -- 48906

Fax: (517) 484-9836

Email: CustServe@Michco.com

Web site: www.Michco.Com

Parts Web site: www.FloorMachineParts.Com

Order Parts on Line at:

www.FloorMachineParts.Com

Directly to Parts & Service:

By Email: **Shop@Michco.com**

By Fax: (517) 702-2041

By Voice: Use numbers above.

Serving the Cleaning Industry Since 1922

Notice: All copyrighted material remains property of original owners, all trademarks are property of respective owners. Manuals are subject to Manufacturer's reproduction limitations. Originals or reproductions were provided by manufacturers through a request. We make no warranty as to the correctness of information provided in this document and you assume all risk. By placing these manuals on line we are not declaring our corporation to be an manufacturer authorized dealer or provider, please check our web site for authorized manufacturers we represent.

ASSEMBLY INSTRUCTIONS
OPERATING INSTRUCTIONS
AND PARTS LIST
FOR

Parker

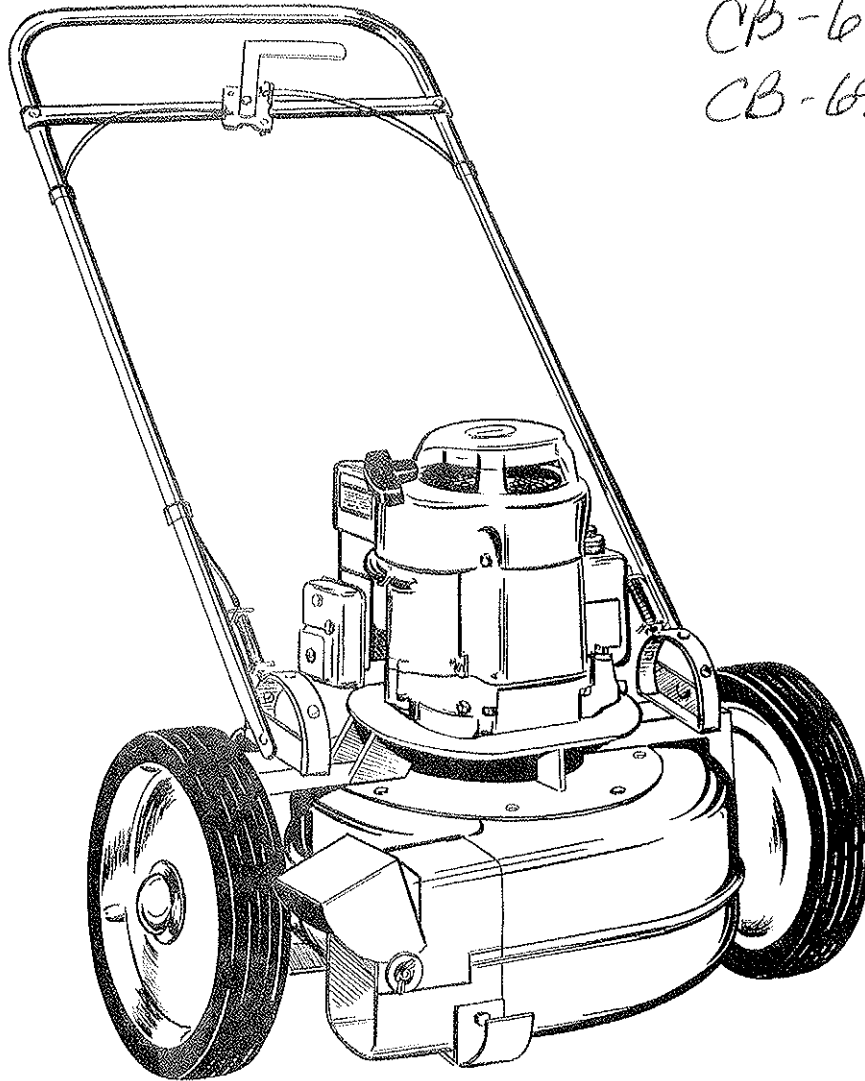

CB-6935
CB-6950

NOTICE: These instructions were written to assist you in assembling your Hurricane quickly and correctly. Read instructions thoroughly before attempting assembly so that you are familiar with the complete procedure.

PARKER SWEEPER COMPANY

BOX 720

Printed in U.S.A.

SPRINGFIELD, OHIO

HURRICANE

MODEL CB-6935
MODEL CB-6950

ASSEMBLY INSTRUCTIONS

1. The Hurricane 35 & 50 are packed in two cartons. One carton contains the power unit and the other contains the handle.
2. Remove each from their respective cartons and place on a level working surface.
3. Remove Shoulder Bolt, Item 35, Fig. 1, and Lock Nut, Item 36, Fig. 1, from each end of handle assembly.
4. Turn power unit so that discharge opening is to your right and in front of wheel.
5. Place handle assembly on power unit so that cable control, Item 2, Fig. 2, is on top of cross brace, Item 3, Fig. 2; and pawls, Item 5, Fig. 2, align themselves in rear holes of each quadrant.
6. Secure handle assembly to power unit with shoulder bolts on outside of handle and lock nuts next to engine and on inside of each quadrant.
7. IMPORTANT: Read engine manual and add proper gasoline and oil to engine.
8. Engine should be "Broke in" by running at 1/2 throttle for 30 minutes, and full throttle for 30 minutes.

OPERATING INSTRUCTIONS

1. IMPORTANT: Read engine manual and add proper gasoline and oil to engine.
2. No lubrication is required on Hurricane (except engine).
3. Operate machine at near full throttle for best results.
4. Machine will operate effectively by either pushing or pulling.
5. Shield portion of deflector assembly, Item 6, Fig. 1, may be rotated up or down by loosening wing nut, Item 28, Fig. 1, on each side of adapter, Item 10, Fig. 1. Retighten wing nuts after desired position of shield is obtained.
6. Elbow assembly, Item 7, Fig. 1, for blowing forward, may be secured to unit by loosening wing nuts, Item 28, Fig. 1, sufficiently to allow removal of deflector assembly, Item 6, Fig. 1, by lifting same straight up. Place Elbow assembly, Item 7, Fig. 1, over discharge opening aligning slots in Elbow assembly with bolts, Item 21, Fig. 1.
7. Secure Elbow assembly to unit by placing flat washer, Item 31, Fig. 1, and wing nuts, Item 28, Fig. 1, to outside of Elbow assembly and tighten wing nuts.
8. When cleaning an area which requires working from one side only the handle can be changed from back to front side by releasing cable control, Item 2, Fig. 2, and moving handle to opposite side. This allows blower to be pushed from either side while blowing continuously in same direction when using side discharge. Handle can be locked in vertical position for storage.

ALWAYS GIVE THE FOLLOWING INFORMATION WHEN ORDERING REPAIR PARTS:

- | | |
|-------------------------------|---|
| 1. PART NUMBER (Not Ref. No.) | 4. SERIAL No. (Found on Guarantee Card) |
| 2. QUANTITY NEEDED | |
| 3. DESCRIPTION OF PART | 5. MODEL No. CB-6935 & CB-6950 |

If unable to obtain parts locally, write down above information and send to:
PARKER SWEEPER CO., BOX 720, SPRINGFIELD, OHIO 45501

Your unit is right hand (R.H.) or left hand (L.H.) as you stand behind it.

IMPORTANT

PARTS LIST FOR FIG. 2

Ref. No.	Part No.	Qty. Per Unit	Description of Part
1	68-198-C	1	Handle Weldment
2	68-200-B	1	Cable Control
3	68-201-B	1	Cross Brace
4	59-77-A	2	Clamp
5	68-176-A	2	Pawl
6	68-206-A	2	Spring
7	68-101-A	4	Cable Clamp
8	380-232-12	2	Cotter Pin 1/16 Dia. x 3/4
9	945-616	2	Washer - Flat SAE 3/8
10	515-8-8	4	Screw Rd. Hd. Mach. #8-32 x 1/2
11	365-8	4	Nut - Hex Self Lock #8 - 32
12	65-416-24	2	Bolt - Hex Hd. 1/4-20 x 1 1/2
13	365-416	2	Nut - Hex Self Lock 1/4-20
14	515-10-20	2	Screw Rd. Hd. Mach. #10-24 x 1 1/4
15	365-10	2	Nut - Hex Self Lock #10-24

FIG. 2

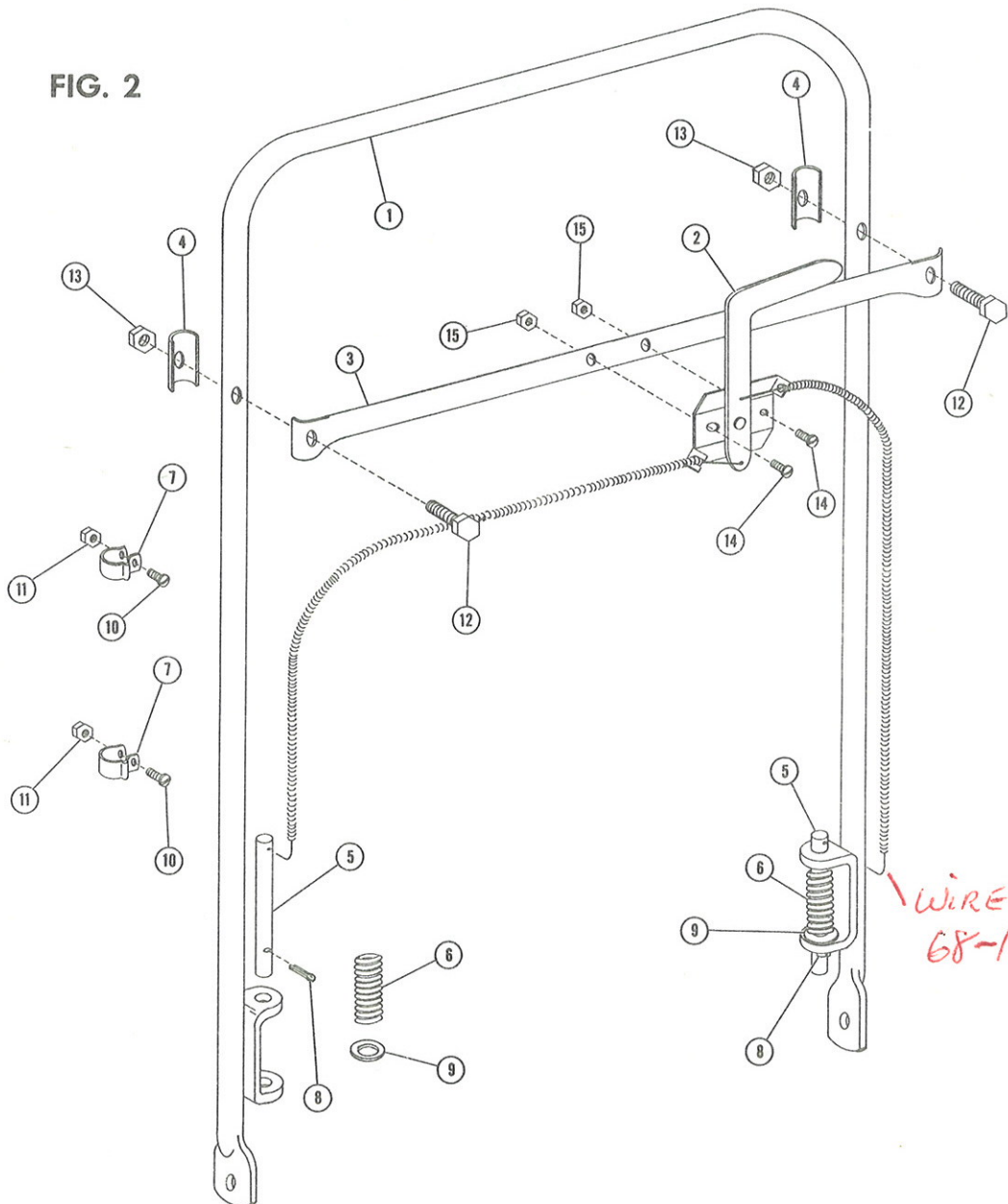

WIRE ONLY
68-181 A1 .060 X 35 3/4

PARTS LIST FOR FIG. 1

Ref. No.	Part No.		Qty. per Unit		Description of Part
	CB-6935	CB-6950	CB-6935	CB-6950	
1	68-199-D	68-199-D	1	1	Frame Weldment
2	68-211-B	68-193-B	1	1	Fan Weldment
3	68-215-B	68-217-B	1	1	Wheel Assembly
4	68-216-A	68-216-A	4	4	Flange Bearing
5	68-243-B	68-243-B	1	1	Bumper Leg Weldment
6	68-258-B	68-258-B	1	1	Deflector Assem.
7	68-257-C	68-257-C	1	1	Elbow Assem.
8	65-428-A	68-159-A	1	1	Engine B & S
9	68-157-F	68-157-F	1	1	Blower Housing
10	68-240-C	68-240-C	2	2	Adapter
11	67-213-A	67-213-A	2	2	Hub Cap
12	68-191-B	68-191-B	1	1	Tie Bar
13	68-180-A	68-180-A	2	2	Axle
14	68-213-A		1		Spacer
15	280-6		2		Key - Woodruff #6
16		67-542-A		1	Key Sq. 3/16 x 1 1/8
17	53-66-A	53-66-A	2	2	Roll Pin 1/8 Dia. x 1 1/2
18	380-432-24	380-432-24	2	2	Cotter Pin 1/8 Dia. x 1 1/2
19	65-416-8	65-416-8	8	8	Bolt Hex Hd 1/4-20 x 1/2
20	65-416-12	65-416-12	8	8	Bolt Hex Hd. 1/4-20 x 3/4
21	65-416-16	65-416-16	2	2	Bolt Hex Hd. 1/4-20 x 1
22	65-516-20	65-516-20	3	4	Bolt Hex Hd. 5/16-18 x 1 1/4
23	346-416	346-416	2	2	Nut - Speed 1/4
24	347-416	347-416	8	8	Nut - Speed "U" Type 1/4
25	364-416	364-416	2	2	Nut-Hex Self Lock (Thin) 1/4-20
26	365-416	365-416	6	6	Nut - Hex Self Lock 1/4-20
27	364-516	364-516	3	4	Nut-Hex Self Lock (Thin) 5/16-18
28	351-416-8	351-416-8	2	2	Nut Wing 1/4-20 x 1 1/8
29	60-616-96		1		Bolt-Hex Hd. 3/8-24 x 6
30		60-616-96		1	Bolt-Hex Hd. 3/8-24 x 6
31	68-259-A	68-259-A	2	2	Washer - Special
32	68-254-A	68-254-A	1	1	Washer - Special
33	935-616	935-616	1	1	Washer - Spring Lock 3/8
34	504-7-6	504-7-6	4	4	Screw-Rd. Hd. Self Tap #7
35	68-161-A	68-161-A	2	2	Shoulder Bolt
36	363-716	363-716	2	2	Nut-Hex Self Lock 7/16-20

FIG. 1

