



Electronic Service Manuals

This electronic document is provided as a service to our customers. We do not create the contents of the information contained in this document. Should you have detailed questions pertaining to the information contained in this document, you may contact Michco, or the manufacturer which provided the original information in this electronic deliverable. Michco's only part in this electronic deliverable was the electronic assembly process.

You may contact Michco through the following methods:
Phone (517) 484-9312 or (800) 331-3339 MI, OH, IN only
2011 N. High St. -- Lansing, Michigan -- 48906
Fax: (517) 484-9836
Email: CustServ@Michco.com
Web site: www.Michco.Com
Parts Web site: www.FloorMachineParts.Com

Order Parts on Line at:
www.FloorMachineParts.Com

Directly to Parts & Service:
By Email: **Shop@Michco.com**
By Fax: (517) 702-2041
By Voice: Use numbers above.

Serving the Cleaning Industry Since 1922

Notice: All copyrighted material remains property of original owners, all trademarks are property of respective owners. Manuals are subject to Manufacturer's reproduction limitations. Originals or reproductions were provided by manufacturers through a request. We make no warranty as to the correctness of information provided in this document and you assume all risk.

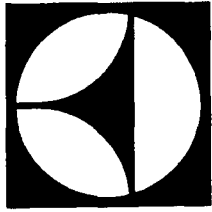

KENT

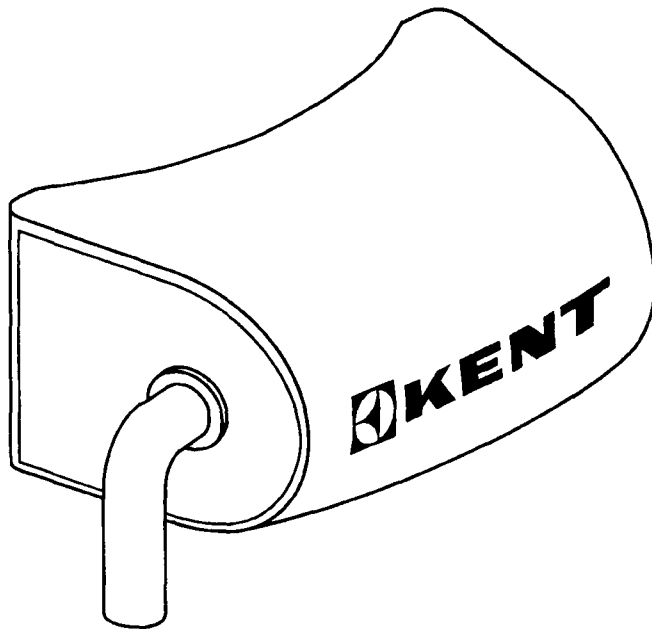

MODEL:
KT-BP5
BACK PACK
PORTABLE
VACUUM

COMMERCIAL

**OPERATING,
MAINTENANCE
INSTRUCTIONS
& ILLUSTRATED
PARTS LIST**

THE KENT COMPANY
P.O. Box 1665
2310 Industrial Parkway
Elkhart, IN 46515
TEL: (219)293-8661,
(800)334-1083
FAX: (219)295-8610

~~TELEX: 95 8331 KENT CO EKR~~

JUNE 1994

MACHINE SPECIFICATIONS:

Vacuum, Motor	115V - 50/60 HZ, 5.9 Amp - 700 Watt - 1.0 PHP Single Stage - Thru flow type with Thermal Protector 123.0 cfm (3.48 ³ m) @ 2.0 in. (5.08 cm) orifice 76.4 in. (194 cm) sealed Lamb Electric Motor (230V, optional)
Power Cord	50 ft. (15.2 m), 18-3 SJT, Black
Intake	1.5 in. (3.81 cm) OD, swivel, 90° elbow
Housing	Rotational molded polyethylene
End Covers	16 gauge steel, epoxy painted
Bag	Standard - One paper bag Standard - One cloth bag w/slide, P/N 039496 (SLIDE ONLY P/N 039574) 5.0 in. x 4.75 in. x 8.0 in or 180 in. ² area (12.7 cm x 12.1 cm x 20.3 cm - 1,161 cm ² area) Volume is 190 in. ³ (3,113 cm ³) (3 ! l) (Package of 10 paper bags is P/N 16608)
Switch	ON/OFF rocker type
Portable Dolly	Not available
Blower	Not available
Noise Level	78 db
Hospital Filter	Optional--14 in. Microstat filter (12 pack) P/N 661843
Belts	Two pivotal 6 in. (15.2 cm) wide supports with three tool attachment loops. Fitted with velcro holders 2 in. (5.08 cm) wide and black nylon 2 in. (5.08 cm) strap with aircraft style lock/release buckle. Adjustment range 18 in. (46 cm) to 52 in. (132 cm).
Length	16.0 in. (40.6 cm)
Height	9.0 in. (22.9 cm)
Width	7.25 in. (18.4 cm)
Weight	10.0 lbs. (4.5 kg)
Shipping Weight	14.5 lbs. (6.5 kg)
Hose	SEE LAST PAGE
Tools	SEE LAST PAGE

GROUNDING INSTRUCTIONS

This appliance must be grounded. If it should malfunction or break down, grounding provides a path of least resistance for electric current to reduce the risk of electric shock. This appliance is equipped with a cord having an equipment-grounding conductor and grounding plug. The plug must be plugged into an appropriate outlet that is properly installed and grounded in accordance with all local codes and ordinances.

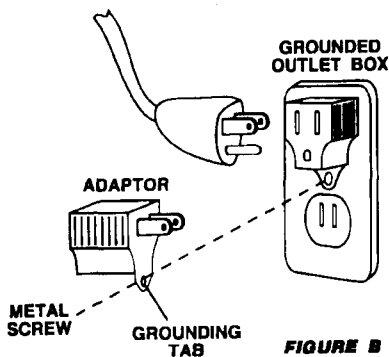
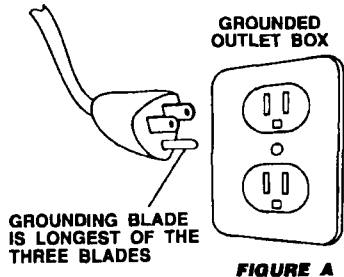

WARNING—Improper connection of the equipment-grounding conductor can result in a risk of electric shock. Check with a qualified electrician or service person if you are in doubt as to whether the outlet is properly grounded. Do not modify the plug provided with the appliance—if it will not fit the outlet, have a proper outlet installed by a qualified electrician.

If this appliance is for use on a nominal 120V circuit, it has a grounded plug that looks like the plug illustrated in Figure A. A temporary adapter that looks like the adapter illustrated in Figure B may be used to connect this plug to a 2-pole receptacle as shown if a properly grounded outlet is not available. The temporary adapter should be used only until a properly grounded outlet (Figure A) can be installed by a qualified electrician. The green colored rigid ear, lug, or the like extending from the adapter must be connected to a permanent ground such as a properly grounded outlet box cover. Whenever the adapter is used, it must be held in place by a metal screw.

Make sure that the appliance is connected to an outlet having the same configuration as the plug.

NOTE: IN CANADA, THE USE OF A TEMPORARY ADAPTER IS NOT PERMITTED BY THE CANADIAN ELECTRICAL CODE.

IMPORTANT SAFETY INSTRUCTIONS

When using an electrical appliance, basic precautions should always be followed including the following:

READ ALL INSTRUCTIONS BEFORE USING THIS APPLIANCE

WARNING:

To reduce the risk of fire, electric shock, or injury:

- Do not leave appliance when plugged in. Unplug from outlet when not in use and before servicing.
- To avoid electric shock, do not use outdoors or on wet surfaces.
- Do not allow to be used as a toy. Close attention is necessary when used by or near children.
- Use only as described in this manual. Use only manufacturer's recommended attachments.
- Do not use with damaged cord or plug. If appliance is not working as it should, has been dropped, damaged, left outdoors, or dropped into water, return it to a service center.
- Do not pull or carry by cord, use cord as a handle, close a door on cord, or pull cord around sharp edges or corners. Do not run appliance over cord. Keep cord away from heated surfaces.
- Do not unplug by pulling on cord. To unplug, grasp the plug, not the cord.
- Do not handle plug or appliance with wet hands.
- Do not put any object into openings. Do not use with any opening blocked; keep free of dust, lint, hair, and anything that may reduce air flow.
- Keep hair, loose clothing, fingers, and all parts of body away from openings and moving parts.
- Do not pick up anything that is burning or smoking, such as cigarettes, matches, or hot ashes.
- Do not use without dust bag and/or filters in place.
- Turn off all controls before unplugging.

- Use extra care when cleaning on stairs.
- Do not use to pick up flammable or combustible liquids such as gasoline or use in areas where they may be present.
- For a grounded appliance: Connect to a properly grounded outlet only. See "Grounding Instructions."

SAVE THESE INSTRUCTIONS

Safety Recommendations

For long service life and safe use of your vacuum cleaner, we recommend the following guidelines:

Your cleaner is designed to pick up dirt and dust particles, it is not designed for water pickup. Avoid picking up hard or sharp objects with your cleaner to avoid bag breakage, hose clogging, or possible motor damage.

SERVICE INFORMATION

To obtain consistent performance over the life of your floor machine, read through these instructions and keep them handy for future reference. If you require service, contact the dealer from whom the floor machine was purchased, or the authorized Kent Service Station. Always refer to your Kent Limited Warranty for complete service information.

THE KENT CO.		
ELKHART, INDIANA USA		
SERIAL NO.		MODEL
VOLTS	PHASE	Hz
MOTOR 1	AMP	Hz
MOTOR 2	AMP	Hz

Rating Plate

The model, type and serial number are indicated on the rating plate. For prompt and complete service information, always refer to these numbers when inquiring about service.

THE KENT BACK PACK VACUUM

Your Kent Back Pack Vacuum Cleaner has been carefully engineered and manufactured to give outstanding performance in all cleaning operations.

Careful maintenance of the unit will insure that high standards of performance will be maintained through its lifetime of operation.

HOW TO USE AND CARE FOR YOUR KENT BACK PACK VACUUM

1. Always operate your Back Pack Vacuum on the proper voltage as outlined on the rating plate.

2. Before turning your vacuum on, be sure paper bag or cloth bag and lint filter are in place. To turn ON, push rocker switch —. To turn OFF, push same rocker switch O.

3. After using for dry application, remove the 55991 Lint Filter and clean thoroughly. This must be cleaned daily to insure top performance. Remove bag and clean base before re-using vacuum, replacing paper bag when one-third full of materials. For added convenience, keep a supply of P/N 16608 Disposable Filter Bags or P/N 35496 Cloth Bag on hand. They may be obtained from your local Kent distributor.

4. If air movement is interrupted in your vacuum, check the P/N 55991 Filter to make sure it is clean. To see if hose has become plugged, remove hose from machine and test suction at machine intake. The vacuum motor is protected by a thermal cut-out switch so that extended use of the motor with interrupted air movement will automatically shut it off. When this situation occurs, the thermal switch must cool down for approximately 12 minutes before it will automatically reset. Remove all blockage in system before using vacuum again.

5. Store machine in clean dry place after removing all dirt from the tank and thoroughly cleaning the tools, hose and the outside of the unit.

6. The carbon motor armature brushes should be inspected after the first 400 hours of operation and frequently thereafter. They should be replaced when worn to 3/8 inch length. Permitting the brushes to be worn to less than 3/8 inch in length invariably will cause damage to the armature thus nullifying the guarantee. Always replace both brushes at the same time.

7. No other maintenance of the motor is required and none should be attempted during the first year after purchase.

8. Many tools are available for your Kent Back Pack Vacuum. Contact your Kent Authorized Distributor for additional tools.

9. Standard tools included with this Back Pack vacuum are listed in "MACHINE SPECIFICATIONS".

10. Placing the Back Pack vacuum on the operator. Grasp the left padded strap with the left hand and hold vacuum against left side of body. With right hand, grasp right padded strap and pull vacuum up tightly against back just above the hips. Overlap left padded velcro strap snugly over right padded velcro strap. Securely pull nylon belt through adjustment buckle and lock securely. Lift buckle to release belt lock.

11. To maintain proper back support, the user must insure a snug fit at all times. This will reduce back fatigue and add many hours of comfortable operation.

12. Three tool loops are sewn on the belt to aid the operator in carrying tools when not in use.

WIRING DIAGRAM

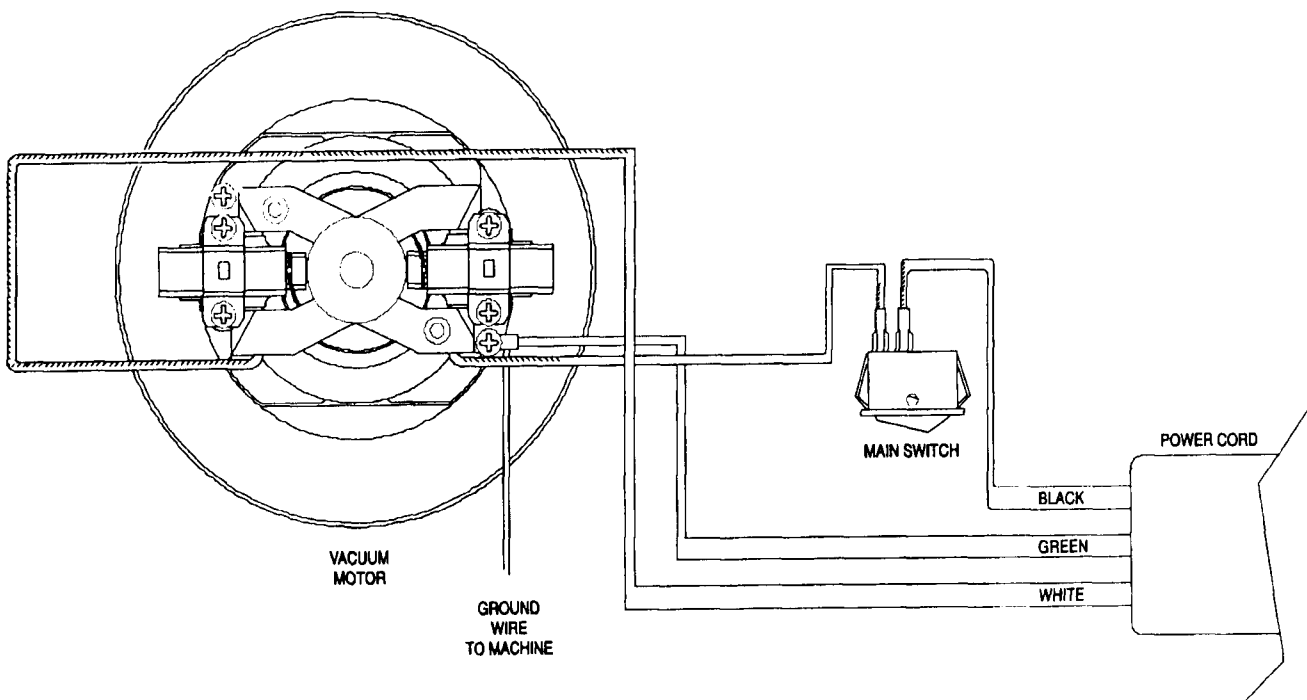

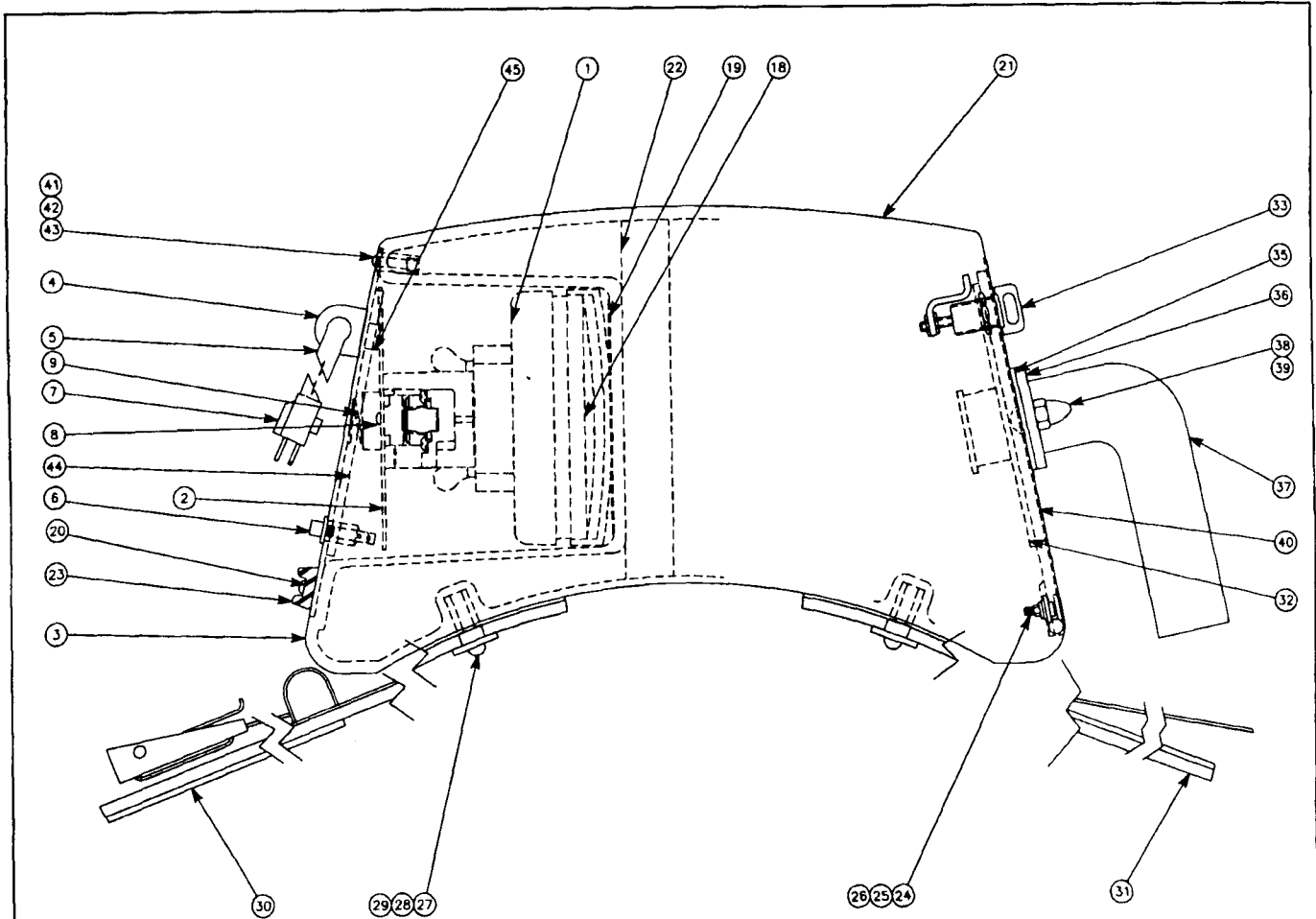

DET PART NO.	DESCRIPTION	QUANT
1 024413	VAC MOTOR--230V/50,SS NBP	1
1 039500	ASM,VAC MOTOR & TERMINAL--115V	1
2 056416	MOTOR COVER--	1
3 039528	WDMT,EXHAUST COVER--BACK VAC	1
4 027106	BSHG,STRAIN RLF--HEYCO 1401,RT	1
5 048350	TUBE,VINYL--.375X.500, 2.75L	1
6 027034	SWITCH,RKR--SPST,16A,125/250V	1
7 027119	ASM,POWER CORD	1
8 005316	SCR TPG F PAN HD 10-24X.375L	1
9 056112	SPRING,COMP	1
11 027120	ASM,WIRE--16GA,GREEN,2 TERM	1
18 055772	GASKET,HOUSING--	1
19 055992	SCREEN,VAC MOTOR--	1
20 005609	SCR MACH PAN HD 10-32X.5,BLK	2
21 055975	HOUSING,MACHINED--HIP VAC	1
22 055991	FILTER--BACK VAC	1
23 039516	CAP--RUBBER FOOT	2
24 003279	NUT,HEX-- 10-24,ZN PLT	2
25 224074	WSHR,SEAL--.203ID,SS	2
26 005297	WSHR LK .200ID.334OD.047TSPLT	2

DET PART NO.	DESCRIPTION	QUANT
27 002248	SCR MACH RD HD .250-20X.750L	2
28 004462	WSHR FLT .250ID1.00OD.062T STL	2
29 054335	SPACER,STL--.258X.444,.204 L,Z	2
30 055994	BELT--HIP VAC,RIGHT	1
31 055996	BELT--HIP VAC,LEFT	1
32 055773	GASKET--INTAKE BACK VAC	1
33 056070	LATCH--TURN BACK VAC	1
34 046810	PORT, INTAKE-MACHINED	1
35 046819	INTAKE GASKET	1
36 046820	INTAKE FLANGE	1
37 046822	INTAKE	1
38 002259	SCR MACH RD HD .250-20X1.00L	2
39 S50472	NUT,ACORN--.250-20,NI PLT,HC	2
40 039497	WDMT,ACC PANEL--	1
41 004528	SCR RD HD 10-32 X 1.250 BLK	1
42 004527	WSHR,FLT .203ID,.500OD,STL BLK	1
43 004526	NUT,10-32 COMPRESSION	1
44 056109	FILTER--SOUND RETAINER	1
45 047085	STRAP,TIE,ELEC-- 5.50L,NYLON	1

1 024410 Mtr only

MODEL WITH 1-1/2 in. (3.8 cm) TOOLS:

Hose 18 in. x 1.5 in. (45.7 cm x 3.8 cm) plastic expandable to 3 ft. (0.91 m) with
P/N 034959 two 1-1/2 in. (3.8 cm) cuffs.

Round Dust Brush 3 in. (7.6 cm) round plastic.
P/N 016430

Crevice Tool 17 in. (43.2 cm) plastic.
P/N 016435

Floor Brush
P/N 016599

MODEL WITH 1-1/4 in. (3.1 cm) TOOLS:

Hose 18 in. x 1.5 in. (45.7 cm x 3.8 cm) plastic expandable to 3 ft. (0.91 m) with
P/N 035116 one 1-1/2 in. (3.8 cm) cuff and one 1-1/4 in. (3.1 cm) cuff and bent end
piece - black.

Dust Brush 3 in. x 2 in. (7.6 cm x 5.1 cm) plastic with brush-black.
P/N E57782-3

Crevice Tool 9 in. (22.9 cm) x 1-1/4 in. (3.1 cm) plastic-black.
P/N E27237-3

Wand (2/unit) 19 in. (48.3 cm) x 1-1/4 in. (3.1 cm) plastic - straight - black.
P/N E13719-3

Two-Way Floor Tool 10.7 in. (27.2 cm) combination hard floor and brush tool - foot operable - black.
P/N E57916

Bent End Piece 1-1/4 in. (3.1 cm) plastic with air bleed - black.
P/N E26193-3

THE KENT LIMITED WARRANTY

Your Kent equipment which has been manufactured, tested, and inspected in accordance with carefully specified engineering requirements, is warranted to be free from defects in material and workmanship. This warranty is, however, subject to the following qualifications, conditions, and limitations which are set forth to provide you and all users of the equipment with information concerning the duration, extent, availability, and applicability of the Kent limited warranty, the procedure to be taken to obtain its performance, and other information concerning the Kent warranty policy.

The Kent Limited Warranty is extended to the original end user as follows

All Kent cord electric machines with the exception of upright and two motor upright vacuums have a three year warranty on parts, and one year labor coverage. Upright and two motor upright vacuums have a one year parts and labor warranty (except the Duravac 15 which has a two year parts one year labor warranty). Motor and gear unit assemblies on 175 RPM Floor Machines carry a warranty of five years.

Poly components carry a ten year replacement warranty with one year service labor. This warranty will not cover damage attributable to the following:

- : Improper, unreasonable or negligent use or abuse of the equipment.
- : Use of the equipment with hot water (over 120 deg. F , 49 deg. C).
- : "Warpage", "Creepage", or "Distortion" of the part so long as the same does not interfere with normal operation.
- : Abrasions or punctures of the equipment.

The start date of the warranty coverage shall be the date the machine was shipped from the factory, or with proof of purchase, the purchase date of the original end user. The start date of the warranty shall not exceed one year from the ship date from the factory.

Parts of Kent Equipment not covered by the Kent Limited Warranty

Certain parts of Kent Equipment require replacement in the ordinary course of use due to normal wear by reason of their characteristics. These are normal wear items such as cords, squeegee blades, belts, gaskets, bumpers, carbon brushes, filters, hoses, bags, padholders, brushes, etc.

Exceptions and Exclusions from Warranty

This equipment is required to be used on electric current as indicated on the dataplate. Otherwise damage, defects, malfunctions or other failures of the equipment arising from the use on electric current not as indicated are excepted and excluded from this warranty. Defects, malfunctions, failure, or damage of the equipment caused by improper care, unreasonable or negligent use or abuse of the equipment are likewise excluded from this warranty. If repair is done to the equipment by anyone other than those designated as authorized to perform such work without having obtained factory authorization in writing, the Kent Company at its sole option, may determine that this warranty will not apply and that reimbursement for such repair will not be made because of the failure to comply with such factory instructions.

Procedure to be taken to obtain performance of warranty repair

To secure repair of the equipment or any warranted parts under this warranty, the following procedure must be taken. The inoperative equipment or warranted parts together with satisfactory evidence of the purchase date, must be delivered, with shipping and delivery charges prepaid, to one of the following:

- : The dealer from whom purchased.
- : Any Kent distributor's service department in the United States.
- : Any Kent authorized service station in the United States.

If you are unable to locate any of the foregoing, you may write or otherwise communicate with The Kent Company for instructions before repair service is performed by anyone else. In such event, The Kent Company will provide either the location of a Kent authorised service department or other factory instructions. In the event that no local service department is available, Kent at its discretion will repair or replace the part or equipment at the factory, the products will be returned to the owner freight prepaid. No warranty will be honored without proof of purchase, the model number, and serial number if applicable.

Replacement

In the event of a defect, malfunction, or failure of your Kent equipment or any warranted part to conform with this warranty, The Kent Company may, at its sole option and own expense, replace the equipment or any warranted part with another new identical or reasonably equivalent model or part in lieu of repairing the defect.

No refund of purchase price

The Kent Company will not, as a matter of its warranty policy, refund the customer's purchase price.

Warranty registration

Your Kent Company distributor from whom you purchased your equipment is responsible for the registration of your warranty with the factory. We ask that you cooperate with your distributor in supplying the necessary information on the warranty card so that we may better serve you. Any information or questions that you may have concerning your Kent equipment or this warranty may likewise be secured from the factory. This warranty gives you specific legal rights, and you may also have other rights which vary from state to state.