



## Electronic Service Manuals

This electronic document is provided as a service to our customers. We do not create the contents of the information contained in this document. Should you have detailed questions pertaining to the information contained in this document, you may contact Michco, or the manufacturer which provided the original information in this electronic deliverable. Michco's only part in this electronic deliverable was the electronic assembly process.

You may contact Michco through the following methods:  
Phone (517) 484-9312 or (800) 331-3339 MI, OH, IN only  
2011 N. High St. -- Lansing, Michigan -- 48906  
Fax: (517) 484-9836  
Email: [CustServ@Michco.com](mailto:CustServ@Michco.com)  
Web site: [www.Michco.Com](http://www.Michco.Com)  
Parts Web site: [www.FloorMachineParts.Com](http://www.FloorMachineParts.Com)

Order Parts on Line at:  
**[www.FloorMachineParts.Com](http://www.FloorMachineParts.Com)**

Directly to Parts & Service:  
By Email: **[Shop@Michco.com](mailto:Shop@Michco.com)**  
By Fax: (517) 702-2041  
By Voice: Use numbers above.

**Serving the Cleaning Industry Since 1922**

Notice: All copyrighted material remains property of original owners, all trademarks are property of respective owners. Manuals are subject to Manufacturer's reproduction limitations. Originals or reproductions were provided by manufacturers through a request. We make no warranty as to the correctness of information provided in this document and you assume all risk.

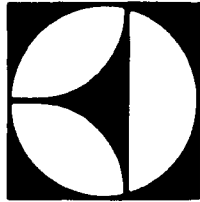

# KENT

MODEL

**KMV-5**  
**KMV-10**

## HOSPITAL VACUUM

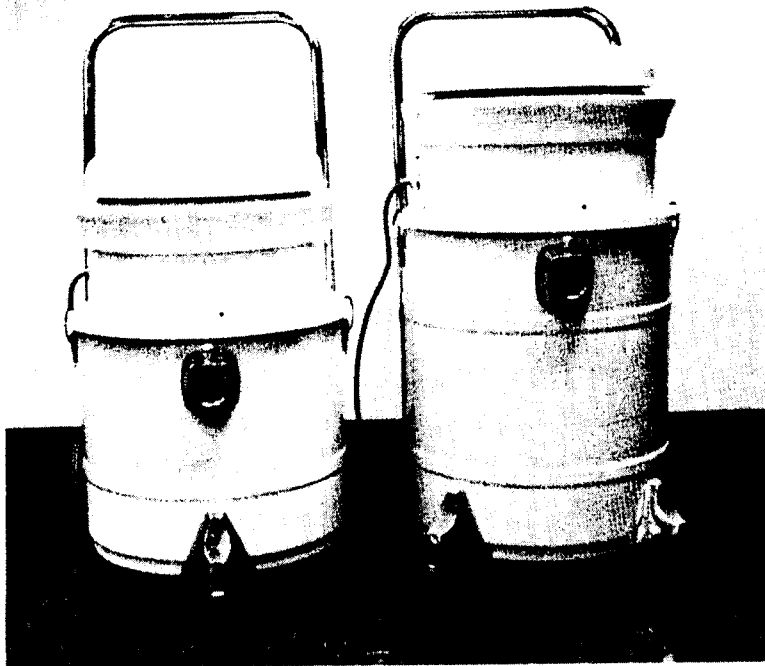

### OPERATING, MAINTENANCE INSTRUCTIONS & ILLUSTRATED PARTS LIST

FEBRUARY 1982

Write the model and serial number of your vacuum in the space provided. Refer to the rating plate on cleaner.

Model #

Serial #

Retain this owner's guide for future reference.

### THE KENT COMPANY

2310 Industrial Parkway  
Elkhart, IN 46515 (219) 293-8661

Western Branch: 10011 South Pioneer Blvd.  
Santa Fe Springs, CA 90670 (213) 949-9351

## GENERAL INFORMATION

BEFORE YOU PLUG IN YOUR CLEANER, check the voltage rating plate located on the cleaner near the power switch to check if it agrees within 10% of the voltage available (See "Rating Plate"). Connect only to a grounded (3-wire) electrical outlet.

## SERVICE INFORMATION

To obtain consistent performance over the life of your vacuum, read through these instructions and keep them handy for future reference. If you require service, contact the dealer from whom the vacuum was purchased, or the local authorized Kent Service Agency. Always refer to your Kent Limited Warranty for complete service information.

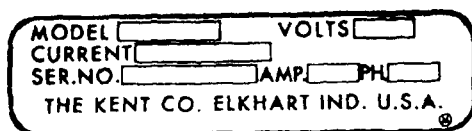

The model, type, and serial number are indicated on the rating plate. For prompt and complete service information, always refer to these numbers when inquiring about service.

## SAFETY PRECAUTIONS

**WARNING** - - To avoid electrical shock, use indoors only.

Do NOT use your vacuum cleaner in areas where flammable and/or explosive vapors or dust are present. Do not use attachments such as a demolisher or paint sprayer that could create such a hazardous condition.

Areas cleaned with cleaning fluids should be allowed to dry completely before vacuuming.

Disconnect power cord from the electrical outlet before cleaning the filter assemblies, emptying the tank, and doing daily machine maintenance.

Do NOT pick up matches, fireplace ashes, or smoking material with cleaner as a possible fire hazard may result.

Turn cleaner off before removing power cord from electrical outlet.

Do not allow children or unauthorized personnel to operate cleaner. Do not leave cleaner connected to an electrical outlet unattended.

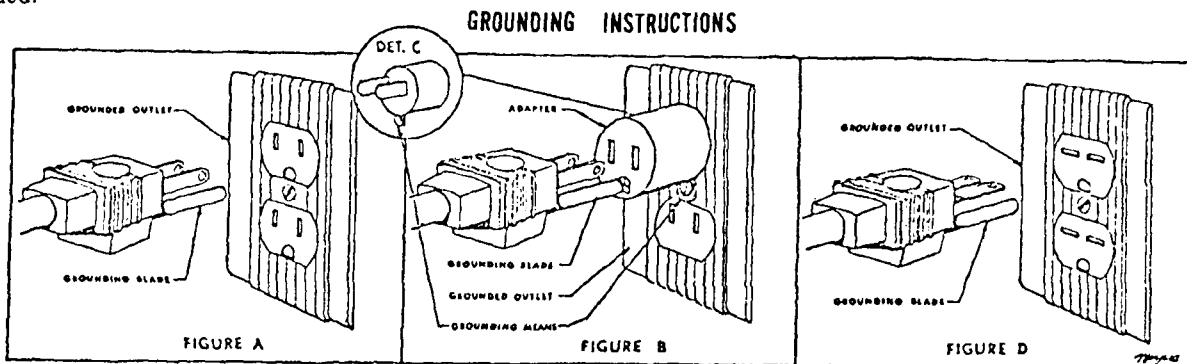

This floor finishing machine should be grounded while in use to protect the operator from electric shock. The machine is equipped with a 3 conductor cord and a 2 prong grounding type attachment plug cap to fit the proper grounding type receptacle. The green (or green & yellow) conductor in the cord is the grounding wire. Never connect this wire to other than the grounding blade.

Floor Finishing Machines Rated Less than 150 Volts - If the floor finishing machine is provided with an attachment plug cap as shown in Figure A, it is intended for use on a 120 volt (nominal) circuit. If a properly grounded receptacle as shown in Figure A is not available an adapter, as shown in Det. C is available and should be installed as shown in Figure B if the outlet box that houses the receptacle is grounded. Be sure to fasten the grounding tab with the faceplate screw.

Floor Finishing Machines Rated 150-250 Volts - If the machine is provided with an attachment plug cap as shown in Figure D, it is intended for use on a 240 volt (nominal) circuit. No adapter is available for this cap.

## ASSEMBLY INSTRUCTIONS FOR KMV-5 OR KMV-10 HOSPITAL VACUUM FOR WET OR DRY USE

After unpacking the shipping carton carefully inspect all components to insure that there is no concealed freight damage. If such damage is discovered, file a "concealed freight damage report" immediately with the delivering carrier.

### Model KMV-5

#### FOR WET USE

1. Direct elbow horizontally.
2. Tuck hose under deflector.
3. Use for WET operation only.

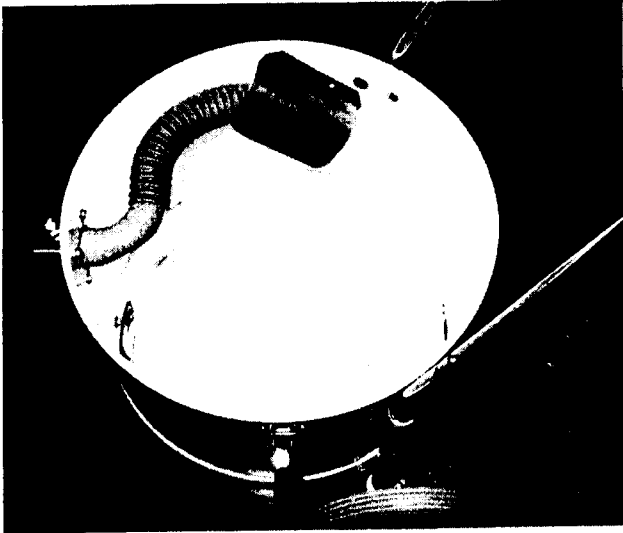

### Model KMV-10

#### FOR WET USE

1. Direct elbow horizontally.
2. Tuck hose under deflector.
3. Use for WET operation only.

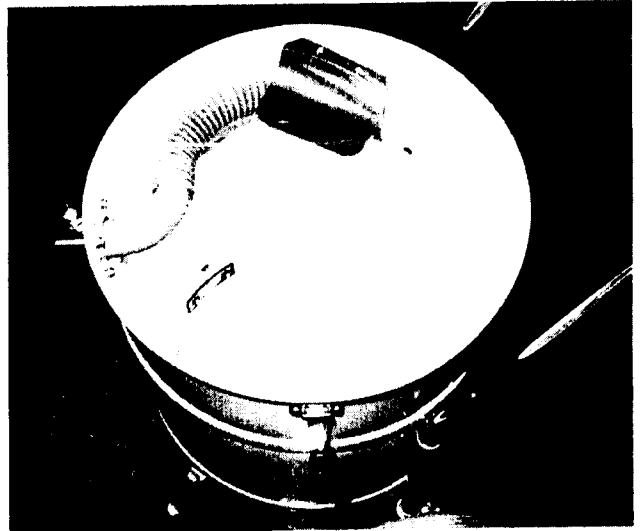

### Model KMV-5

#### FOR DRY USE

1. Direct elbow 45% downward.
2. Tuck enclosed bag in bottom of tank and insert 11" hose.
3. Use for DRY operation only.

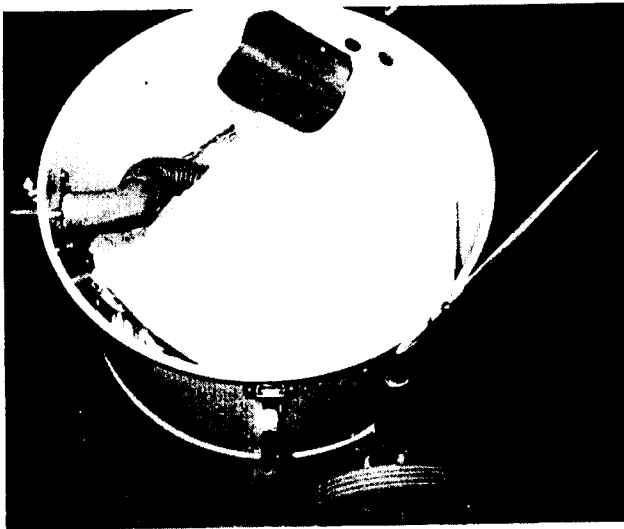

### Model KMV-10

#### FOR DRY USE

1. Direct elbow straight down.
2. Tuck enclosed bag in bottom of tank and insert 11" hose.
3. Use for DRY operation only.

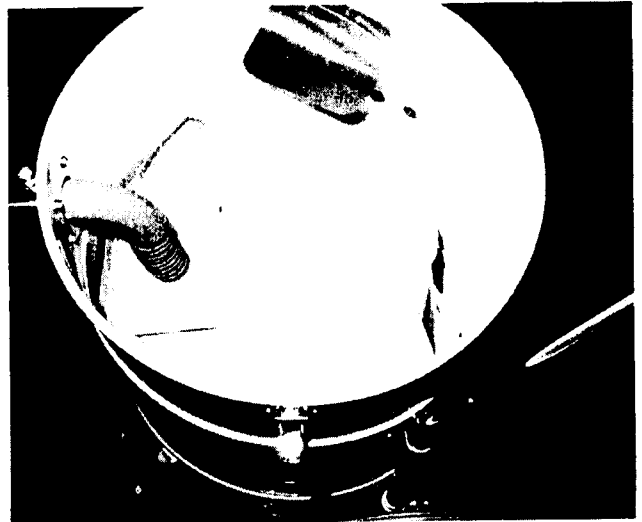

**A THOROUGH CLEANING OF THE RECOVERY TANK IS NECESSARY WHEN CHANGING FROM EITHER WET TO DRY OR DRY TO WET APPLICATION.**

## CHANGING THE MICROSTAT FILTERS

In order to guarantee effective and efficient operation of your Microstate filter system, the Microstat filters must be changed when necessary (Every two to four weeks under heavy use is recommended.)

### To Change the Microstat Filter

Remove the Motor Head Assembly from the vacuum and place on floor in an inverted position.

Remove the Wet Shut-Off Assembly from the Motor Head by unscrewing the three-wing nuts.



Take out the old filter and replace it with a new Kent Microstat Filter. Cover the entire screen with the filter, pushing holes in the filter at the three (3) screws so the screws protrude through the filter. Place the wet shut-off assembly over the filter, slipping the three (3) holes of the screen over the screws. Replace the three (3) wingnuts, tightened to a firm position.



Replace the vacuum head on the tank, secure the clamps, and the vacuum is ready for operation.

## REGULAR MAINTENANCE PROCEDURES

### End of the Day Cleaning Procedure

Wheel vacuum to disposal area of waste dumping which has been selected by the Operating Room Supervisor or Executive Housekeeper.

Empty the vacuum recovery tank of liquid if you have been using the machine for wet pick-up. If it has been used for dry use, remove and discard the paper filter bag of waste.

Remove motor head from tank.

Plug electrical cord into the nearest outlet.

Lay motor head on its side, switch on and run until the lower layers of the filter are dry. (Approximately 5 minutes.)



Use detergent germicide solution to clean:

1. Interior of tank and hose outlet.
2. All surfaces of the wet shut-off assembly.
3. Exterior of the motor head.

Reassemble unit after all components are cleaned. Clean pick-up tool by dipping in a detergent germicide solution. Wipe dry. Wipe hose and operator's handle down with detergent germicide. Store hose with ends hanging down.

### **MAINTENANCE OF MOTOR UNIT**

Inspect the armature brushes after the first 400 hours of operation and frequently thereafter. They should be replaced when worn to 3/8" in length. Permitting the brushes to be worn to less than 3/8" in length invariably will cause damage to the armature, thus nullifying the warranty. Always replace all brushes at the same time.

**DO NOT OIL.** The motor in your vacuum is permanently lubricated and sealed. Do not oil the motor at any time.

No other maintenance of the motors is required and none should be attempted during the first year of purchase.

### **IF THE AIR MOVEMENT IS INTERRUPTED IN THE VACUUM . . .**

Check the dust filter to make sure it is clean. To see if the hose has been plugged, remove the hose from the machine and test suction at the machine intake. Sometimes a plugged tool is responsible, so also check the tools carefully.

### **SERVICE INFORMATION**

To obtain consistent performance from your vacuum, read through these instructions and keep them handy for future reference. If you need service, contact the dealer from whom you purchased your vacuum, or the local authorized Kent Service Station. Always refer to your Kent Limited Warranty for complete service information.

The model, type and serial number are indicated on the data plate (P. 1). For prompt and complete service information, always refer to these numbers when inquiring about service.

We have found that following these step-by-step procedures results in longer machine life and fewer major service problems. We urge that these procedures be **POSTED** and carefully followed.

# 16494 TOOL KIT

INCLUDES:



33505 VAC HOSE ASSEMBLY  
10' x 1 1/2" Plastic Hose  
w/Cuffs

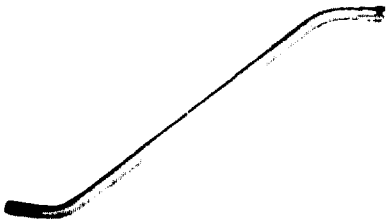

16429 Aluminum Wand



16430 Round Dusting Brush



16431 Upholstery Tool



16434 Wet Pick-up Tool



16435 28" Crevice Tool



16432 Carpet Tool

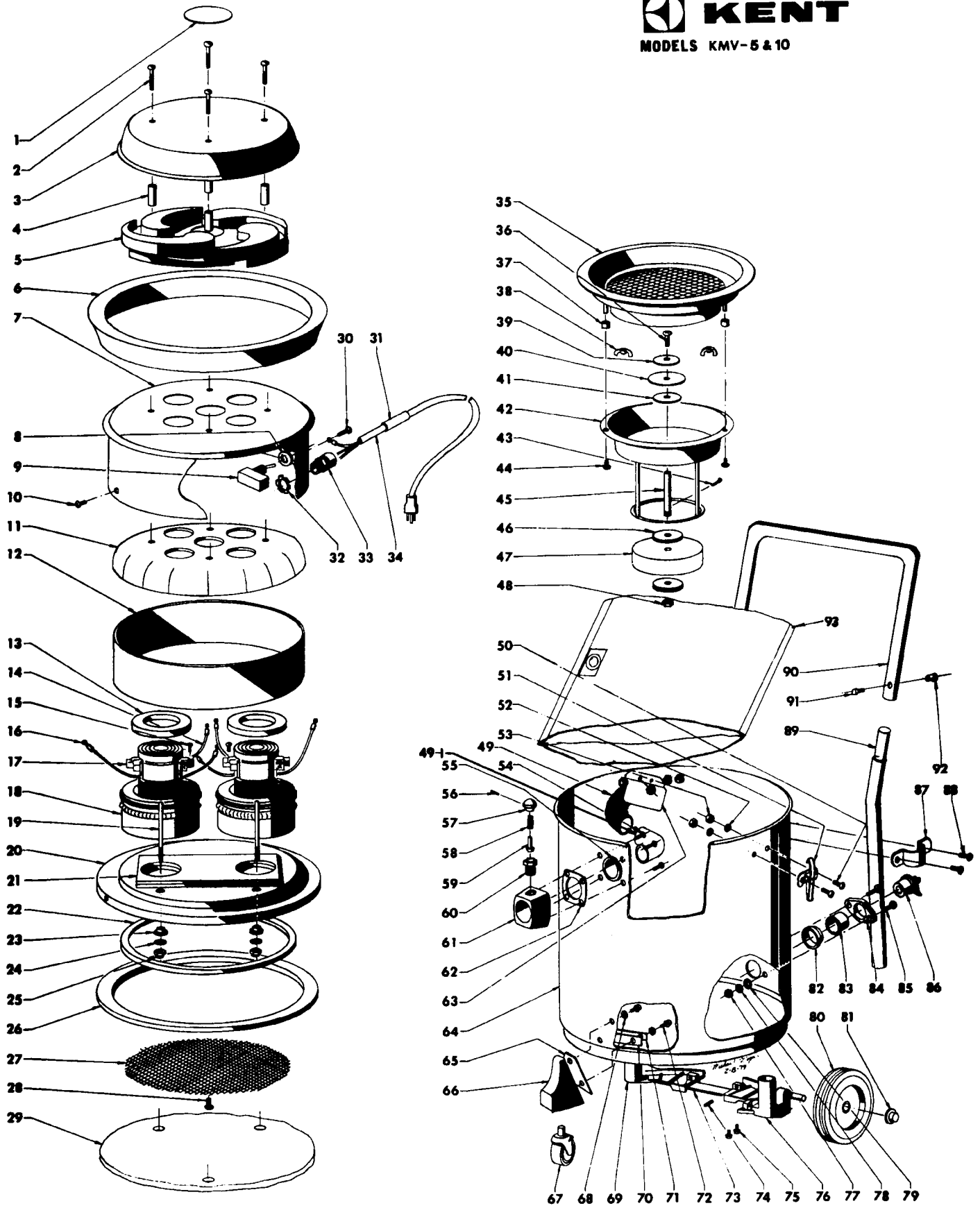

KENT TANK VACUUM  
MODELS KMV-5 AND KMV-10  
PARTS LIST

REF. NO.	PART NO.	DESCRIPTION	NO. REQ.
	10383	Kent Microstat Vacuum 10 115 volt Model KMV-10	
	10384	Kent Microstat Vacuum 10 230 volt Model KMV-10	
	10385	Kent Microstat Vacuum 5 115 volt Model KMV-5	
	10386	Kent Microstat Vacuum 5 230 volt Model KMV-5	
	33255	Vac Head Assy. Comp. 230 volt	
	33254	Vac Head Assy. Comp. 115 volt	
1	48806	Kent Lable	1
2	22-3044	Screw 10-24 x 2 Rd. Hd.	4
2	22-4012	Washer #10 Id. Flat	4
2	03279	Nut 10-24 Hex	4
3	11-1004	Cover Muffler	1
4	05537	Spacer Roll Pin (3/8 x 1½)	4
5	32909	Muffler Assy.	1
6	40-2602	Ring Deflector	1
6	22-3200	Screw for Ring Deflector	4
7	50042	Cover Motor	1
8	04227	Lockwasher	1
9	26644	Switch	1
10	22-3014	Screw #10 x ¼ Type A Bind Hd.	4
11	49715	Disc Motor Cover Felt	1
12	40-0203	Strip Motor Cover Felt	1
13	49714	Gasket Air Intake	2
14	11-1609	Ground Wire Assy	2
15	01332	Screw 10-24 x 3/8 Pan Hd. T. T.	2
16	26124	Terminal	4
17	26650	Carbon Brush Assy.	4
18	23867	Vac Motor	2
19	40-0502	Anchor Rod Vac Motor	4
20	33066	Support Plate Assy.	1
21	40-0602	Gasket Vac Motor	2
22	50209	Gasket Support Plate (wet shut off)	1
23	11-1384	Bushing	4
24	22-4015	Washer	4

WHEN ORDERING PARTS - Please Furnish Part Number, Model & Serial Number

KENT TANK VACUUM  
MODELS KMV-5 AND KMV-10  
PARTS LIST

REF. NO.	PART NO.	DESCRIPTION	NO. REQ.
25	22-2223	Nut 10 - 32 Flex Loc.	4
26	49954	Gasket Support Plate (Base)	4
27	50210	Screen Microstat Filter	1
28	02343	Screw $\frac{1}{4}$ - 20 x $\frac{1}{2}$ Taptite	1
29A	66-1843	Microstat Filters - PKG.of 12	1
29	90-2901	Microstat Filter	1
30	22-3188	Screw 6 - 32 x $\frac{1}{2}$ Pan. Hd.	1
30	04250	Washer #6 I.D.	1
30	03275	Nut 6 - 32 Hex.	1
31	48350	Guard Strain Relief	1
32	06108	Nut Strain Relief	2
33	48356	Strain Relief	1
34	25417	Power Cord Assy.	1
35	90-0500	Cupped Head Assy.	1
35A	33323	Wet Shut-off Assy. Comp.	1
36	22-3016	Screw #8 Self Tapping	1
37	46309	Spacer $\frac{1}{4}$ I.D. x $\frac{1}{2}$ Lg.	3
38	03285	Wing Nut $\frac{1}{4}$ - 20	3
39	11-1032	Steel Disc.	1
40	11-1034	Rubber Disc.	1
41	11-1033	Steel Disc.	1
42	90-0600	Outer Cup & Bag Support	1
43	22-2607	Cotter Pin.	2
44	01242	Screw 6 - 32 x 5/8 Rd. Hd.	3
45	90-1202	Float Rod	1
46	51037	Washer 2.875 O.D. x .265 I.D. x 16 Ga.	5
47	11-1509	Float	1
48	03329	Nut $\frac{1}{4}$ - 20 Brass Hex	1
49	49850	Hose 11" x 1-1/2"	1
49-1	47577	Elbow - Pick-Up Tube	1
50	02366	Screw Pan Hd. S.S.(EW110SS10-5P)	8
51	E36398	Clamp Toggle	2
52	E49039A	Washer Plain	8
53	03406	Nut 10 - 24 Hex SS. (EW14 SS 10)	8
54	02369	Screw Hex Soc (EW 62-416C16C)	4
55	71-5402	O-Ring (for dry pick up)	1
56	05541	Pin Drive Lock	1

WHEN ORDERING PARTS - Please Furnish Part Number, Model & Serial Number

KENT TANK VACUUM  
MODELS KMV-5 AND KMV-10  
PARTS LIST

REF. NO.	PART NO.	DESCRIPTION	NO. REQ.
57	E36379	Knob	1
58	E49037	Spring-Coupling Lock	1
59	E49036	Pin Coupling Lock	1
60	E36378	Sleeve Coupling Lock	1
61A	E36380	Inlet Assembly (Inc. Det: 56-61)	1
61	E12990	Body Connector	1
62	E36384	Gasket Inlet	1
63	E25630A	Deflector (Wet Pick Up)	1
64	50842	Tank 5 Gal.	1
64	50841	Tank 10 Gal.	1
65	E49332	Gasket Caster Body (KMV-5)	1
65	E49332	Gasket Caster Body (KMV-10)	2
66	E12991A	Body Caster Mounting (KMV-5)	1
66	E12991A	Body Caster Mounting (KMV-10)	2
67	51578	Caster Assembly (KMV-5)	1
67	51578	Caster Assembly (KMV-10)	2
68	22-4074	Sealing Washer #10 I.D. (KMV-5)	5
68	22-4074	Sealing Washer #10 I.D. (KMV-10)	10
69	33504	Frame & Axle Assembly Right	1
70	E36460	Gasket Backing Plate (KMV-5)	1
70	E36460	Gasket Backing Plate (KMV-10)	2
71	E36405A	Backing Plate (KMV-5)	1
71	E36405A	Backing Plate (KMV-10)	2
72	02367	Screw 10 - 24 x 5/8 Hex Hd. T.T. (KMV-5)	9
72	02367	Screw 10 - 24 x 5/8 Hex Hd. T.T. (KMV-10)	12
73	E36370	Support Carriage	1
74	02369	Setscrew $\frac{1}{4}$ - 20 x 1	4
75	02368	Screw $\frac{1}{4}$ - 20 x $\frac{1}{2}$ Hex Hd. T.T.	4
76	33503	Frame & Axle Assy. Left Hand	1
77	03283	Nut $\frac{1}{4}$ - 20 Hex.	2
78	05433	Washer	2
79	22-4073	Sealing Washer $\frac{1}{4}$ I.D.	2
80	50103	Wheel	2
81	E48939	Push Nut	2
82	46819	Gasket	1

WHEN ORDERING PARTS - Please Furnish Part Number, Model & Serial Number



# THE KENT LIMITED WARRANTY

Your Kent Equipment, which has been manufactured, tested and inspected in accordance with carefully specified engineering requirements, is warranted to be free from defects in material and workmanship.

This warranty is, however, subject to the following qualifications, conditions, and limitations which are set forth to provide you and all users of the Kent Equipment with information concerning the duration, extent, availability, and applicability of this Kent Limited Warranty, the procedure to be taken to obtain its performance, and other information concerning the Kent Warranty policy.

## DURATION OF WARRANTY AND TO WHOM EXTENDED

This warranty extends for a period of one year from the date of the original purchase of the Kent Equipment by the original purchaser. During this period this warranty is available to such first purchaser and:

Members of his or her immediate family for the personal use of the Kent Equipment  
or on behalf of such first purchaser,

OR

Members of his or her immediate employment.

## PARTS OF KENT EQUIPMENT NOT COVERED BY WARRANTY

Certain parts of Kent Equipment require replacement in the ordinary course of use due to normal wear by reason of their characteristics. These are normal wear items such as cords, gaskets, switches, bumpers, carbon brushes, handle grips, bags, hoses, bearings, etc.

## EXCEPTIONS AND EXCLUSIONS FROM WARRANTY

This equipment is required to be used on electric current as indicated on the name plate. Otherwise damage, defects, malfunctions or other failures of the equipment arising from use on electric current not as indicated are excepted and excluded from this warranty.

Defects, malfunctions, failure or damage of the equipment caused by improper, unreasonable or negligent use or abuse while in the possession of the purchaser are likewise excluded from this warranty.

If repair is done on your equipment by anyone other than those below designated as authorized to perform such work without first having obtained factory instructions, The Kent Company, at its sole option, may determine that this warranty will not apply and that reimbursement for such repair will not be made because of the failure to comply with such factory specified instructions.

## PROCEDURE TO BE TAKEN TO OBTAIN PERFORMANCE OF WARRANTY

### REPAIR

To secure repair of the equipment or any warranted parts under this warranty, the following procedure should be taken.

The inoperative equipment or warranted parts, together with satisfactory evidence of the purchase date, must be delivered, with shipping and delivery charges prepaid, to one of the following:

- 1) The Dealer from whom purchased;
- 2) Any Kent distributor's Service Department in the United States;
- 3) Any Kent Authorized Service Station in the United States.

If you are unable to locate any of the foregoing, you may write or otherwise communicate with The Kent Company, Division of Dometic Incorporated, for instructions before repair service is performed by anyone else. In such event, The Kent Company will provide either the location of a closely available Kent distributor Service Department or Kent Authorized Service Station or other factory instructions.

Upon compliance with the above procedure, all warranted defects will be repaired, at no additional charge or costs to the customer, and the repaired product returned to the customer, with all shipping and delivery charges prepaid.

In following the procedures above set forth, PLEASE MAKE CERTAIN to state the Kent model, type and serial number as shown on the name plate of the equipment.

### REPLACEMENT

In the event of a defect, malfunction or failure of your Kent Equipment or any warranted part to conform with this warranty, The Kent Company may, at its sole option and own expense, replace the equipment or any warranted part with another new identical or reasonably equivalent model or part in lieu of repairing the defect.

## NO REFUND OF PURCHASE PRICE

The Kent Company will not, as a matter of its warranty policy, refund the customer's purchase price.

## WARRANTY REGISTRATION CARD FOR YOUR KENT EQUIPMENT AND REQUESTS FOR INFORMATION

Your Kent Company Distributor from whom you purchased your equipment is responsible for the registration of your warranty with the factory. We ask that you cooperate with your Distributor in supplying the necessary information on the warranty card so that we may better serve you.

Any information or questions you may have concerning your Kent Equipment or this warranty may likewise be secured from the factory.

This warranty gives you specific legal rights, and you may also have other rights which vary from state to state.

THE KENT COMPANY  
P.O. BOX 1665  
ELKHART, INDIANA 46515