



Electronic Service Manuals

This electronic document is provided as a service to our customers. We do not create the contents of the information contained in this document. Should you have detailed questions pertaining to the information contained in this document, you may contact Michco, or the manufacturer which provided the original information in this electronic deliverable. Michco's only part in this electronic deliverable was the electronic assembly process.

You may contact Michco through the following methods:
Phone (517) 484-9312 or (800) 331-3339 MI, OH, IN only
2011 N. High St. -- Lansing, Michigan -- 48906
Fax: (517) 484-9836
Email: CustServ@Michco.com
Web site: www.Michco.Com
Parts Web site: www.FloorMachineParts.Com

Order Parts on Line at:
www.FloorMachineParts.Com

Directly to Parts & Service:
By Email: **Shop@Michco.com**
By Fax: (517) 702-2041
By Voice: Use numbers above.

Serving the Cleaning Industry Since 1922

Notice: All copyrighted material remains property of original owners, all trademarks are property of respective owners. Manuals are subject to Manufacturer's reproduction limitations. Originals or reproductions were provided by manufacturers through a request. We make no warranty as to the correctness of information provided in this document and you assume all risk.

BackVacuum™

Parts list for models:

BackVacuum STANDARD	-	110-120V:	100901
BackVacuum HEPA	-	110-120V:	100902



NILFISK

Made for ADVANCE

11/98 FORM NUMBER 042344

TABLE OF CONTENTS SERVICE KIT

BackVacuum, double insulated

1

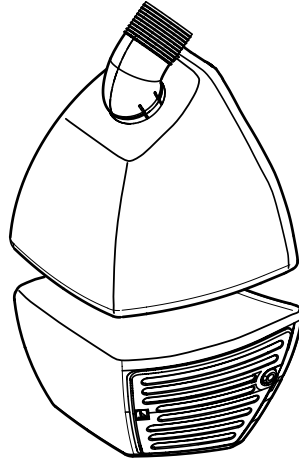

DESCRIPTION	PLAN
Motors, internal wires and cords	B - 1.9.3 - 2
Container upper parts	B - 1.9.3 - 4
Container lower parts	B - 1.9.3 - 6
Electric unit	B - 1.9.3 - 8
Motorfilter and exhaust filter (Standard and HEPA)	B - 1.9.3 - 10
Nozzles	B - 1.9.3 - 12
Tubes, hose and dust bag	B - 1.9.3 - 14
Electrical diagrams	B - 1.9.3 - 19

WHEN ORDERING PARTS

- * Use the 6 digit numbers from the "Ref. No." columns in this parts list.
- * Specify the model and serial number of the machine.
- * Use the space below to record the model and serial number for future reference.

Model _____ Serial No. _____

MOTOR SERVICE KIT

2

MOTOR AND CORD TYPES, BackVacuum, double insulated

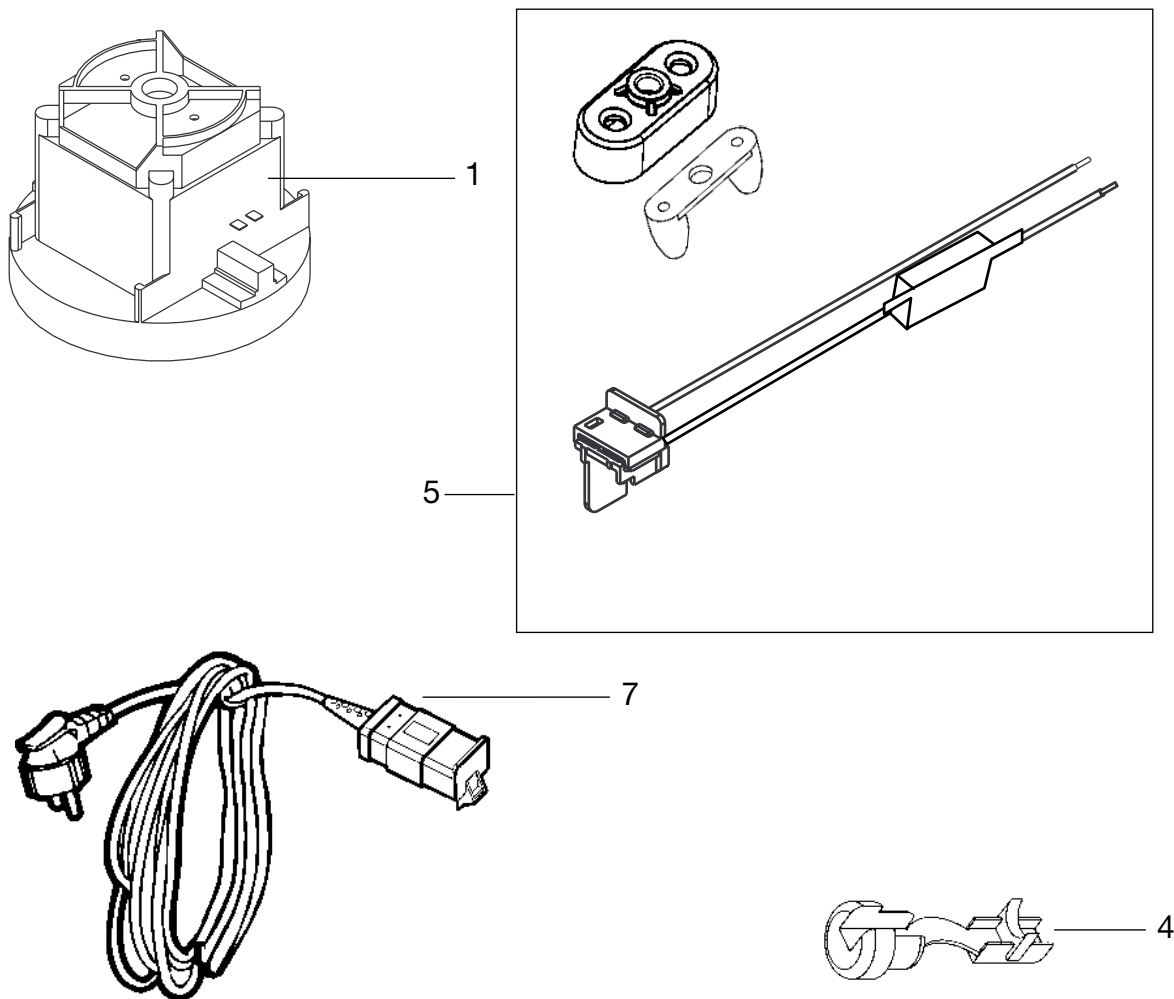

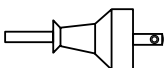

Fig. 1 Cord, ref. no. 100903

	Voltage	Plug type	
USA/Japan	120		

MOTOR SERVICE KIT**MOTOR AND CORD TYPES, BackVacuum, double insulated****3**

Item	Ref. No.	Qty.	Description	Note	EAN code 5715492+
1			Motor/fan unit for:	Mat.: Plast and steel	
	100903	1	110-120 V, 50-60 Hz, 1000 W		+ 003020
	100903	1	100 V, 50-60 Hz, 850 W		+ 003020
5	100904	1	Internal wire kit with thermo switch and cable relief	Mat.: PVC and copper, PP	+ 006793
7			Cord with plug and socket.. length = 15 m	Mat.: PVC and copper Colour: Grey, RAL 7001	
	100905	1	USA, Japan, Canada		+ 006861
4	100906	1	Strain relief bush		

CONTAINERS SERVICE KIT

4

UPPER PART BackVacuum, double insulated

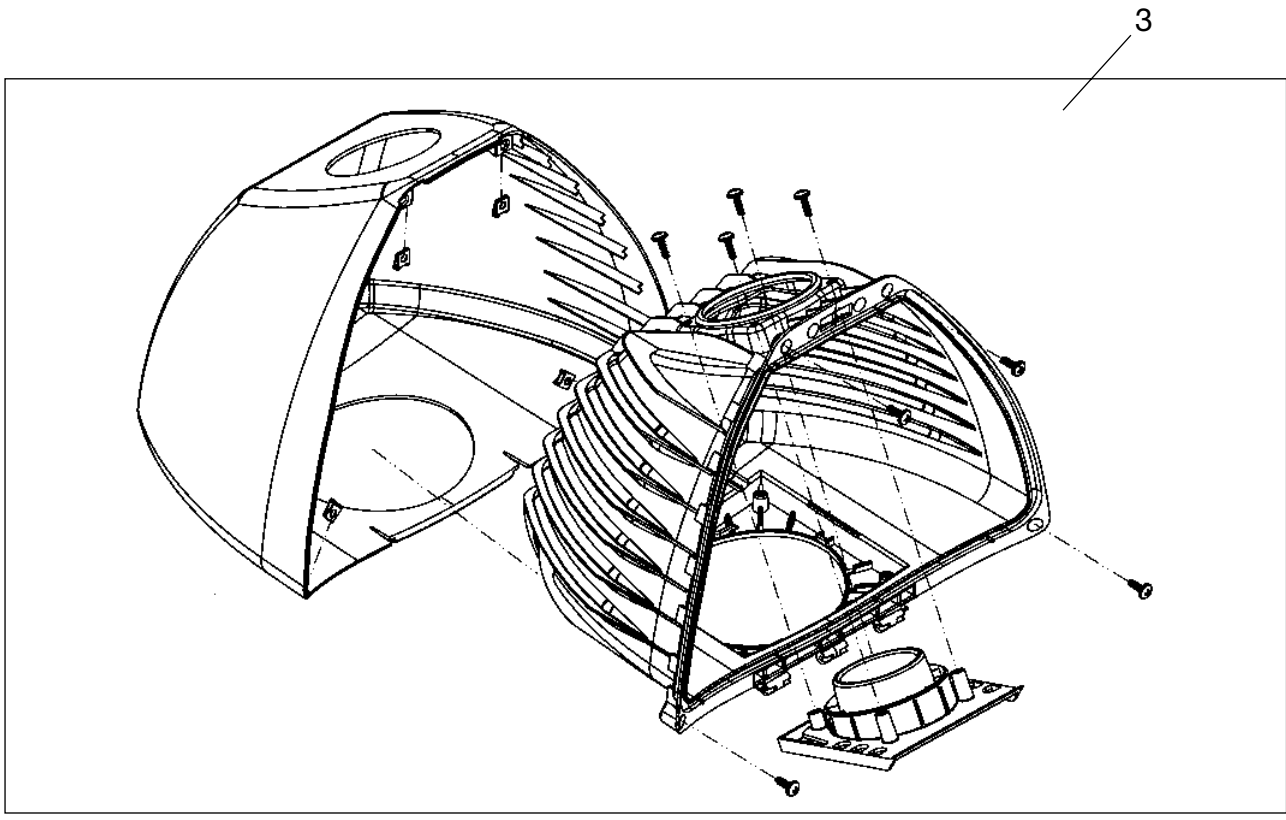
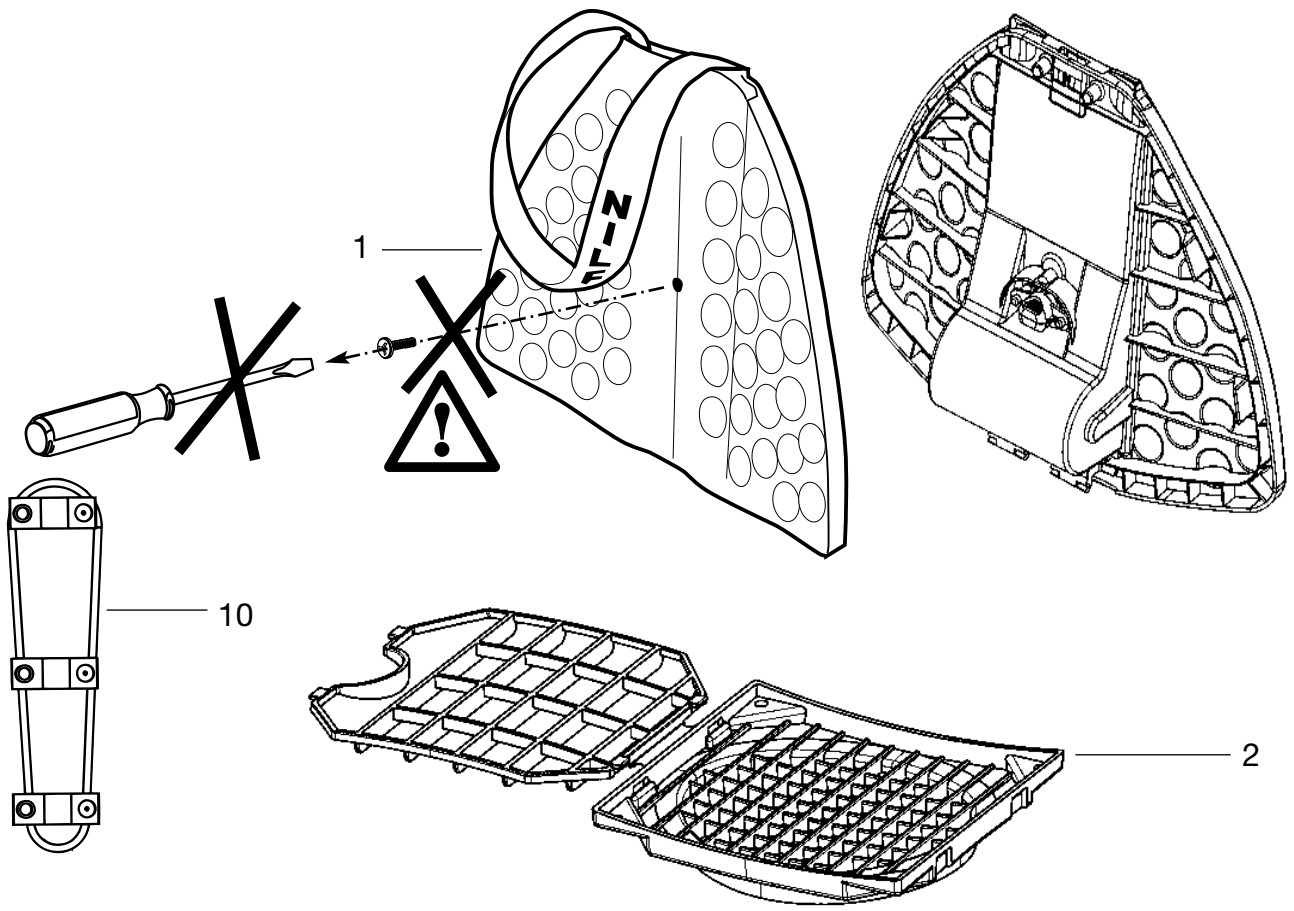

CONTAINERS SERVICE KIT**UPPER PART BackVacuum, double insulated****5**

Item	Ref. No.	Qty.	Description	Note	EAN code 5715492+
1	100907	1	Dust chamber lid complete	Mat.: ABS grey RAL 7001	+ 006694
2	100908	1	Frame for main filter complete		+ 006755
3	100944	1	Dust chamber complete	Mat: ABS	+ 007806
10	100939	1	Shoulder pad, 2 pcs.		+ 007400

CONTAINER SERVICE KIT

6

LOWER PART BackVacuum, double insulated

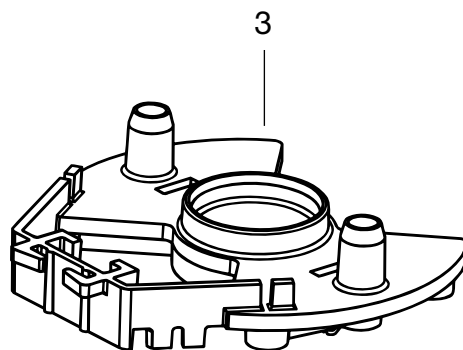
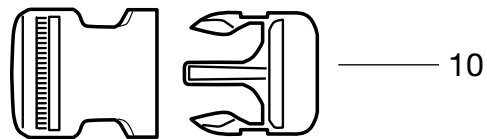
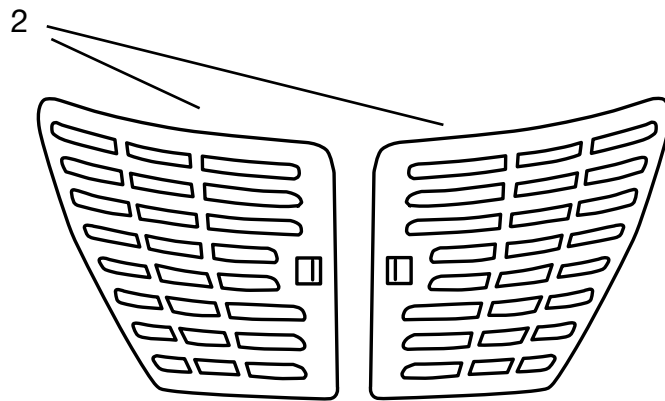
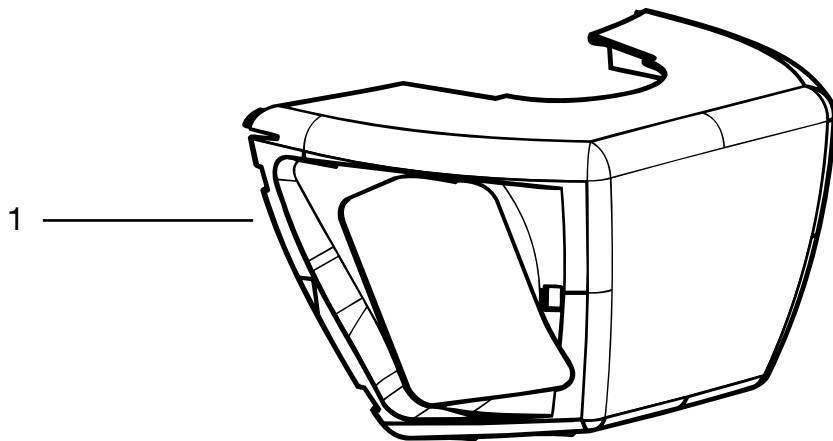

CONTAINER SERVICE KIT**LOWER PART BackVacuum, double insulated****7**

Item	Ref. No.	Qty.	Description	Note	EAN code 5715492+
1	100909	1	Motor housing cover	Mat.: ABS Colour: Grey, RAL 7001	+ 006809
2	100910	1	Grid, one left and one right	Mat.: ABS Colour: Grey, RAL 7001	+ 006700
3	100911	1	Motor suspension	Mat.:	+006748
10	100912	1	Buckles male/female complete	Mat: PP Colour: Black	+ 006786

ELECTRIC SWITCH SERVICE KIT

8

ELECTRICAL UNIT, BackVacuum, double insulated

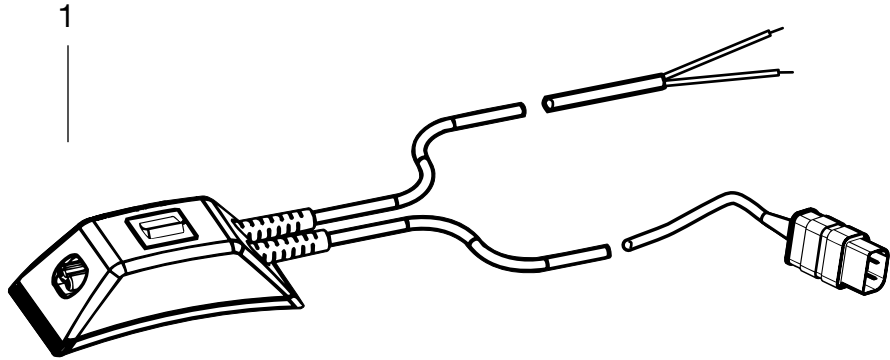

ELECTRIC SWITCH SERVICE KIT**ELECTRICAL UNIT, BackVacuum, double insulated****9**

Item	Ref. No.	Qty.	Description	Note	EAN code 5715492+
1			Electrical unit, complete	With electric outlet for electro nozzle	
	100913	1	USA version		+ 007134

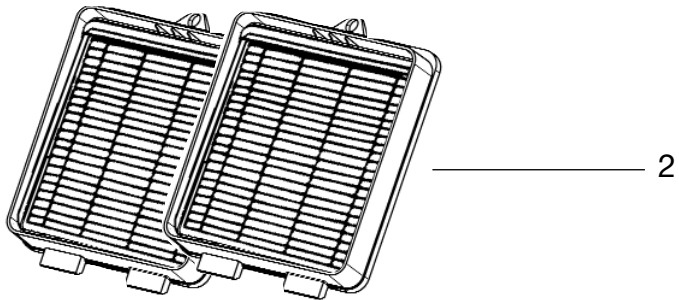
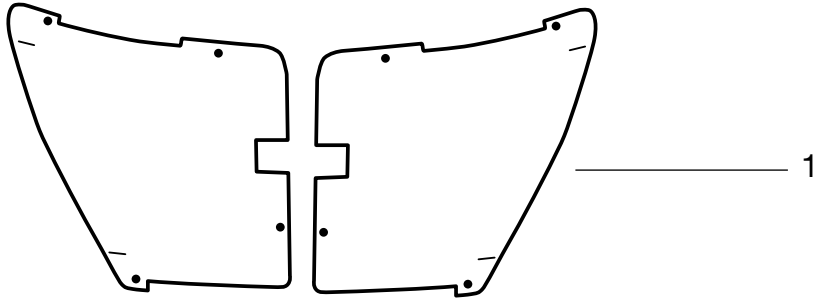

FILTER SERVICE KIT, BackVacuum, double insulated

EXHAUST FILTER (STANDARD/HEPA)

11

Item	Ref. No.	Qty.	Description	Note	EAN code 5715492+
1	100914	1	Exhaust diffuser filter (two pieces)		+ 006731
2	100915	1	Exhaust HEPA filter (two filters)	Area: 1300 cm ² each Filtration: H13	+ 006717

	ACCESSORIES Ø32 MM	
	12	NOZZLES, BackVacuum, double insulated

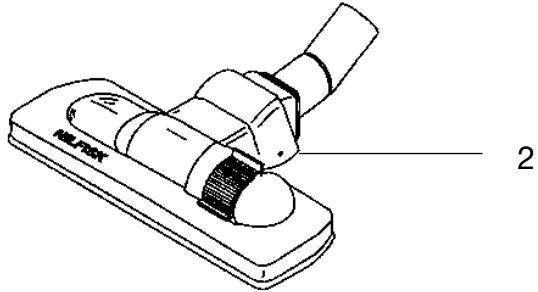

ACCESSORIES Ø32 MM**NOZZLES, BackVacuum, double insulated****13**

Item	Ref. No.	Qty.	Description	Note	EAN code 5715492+
2	100918	1	Roller combi dry nozzle	Plastic	+ 002573

ACCESSORIES Ø32 MM

14

TUBES, HOSE AND DUST BAG. BackVacuum, double insulated

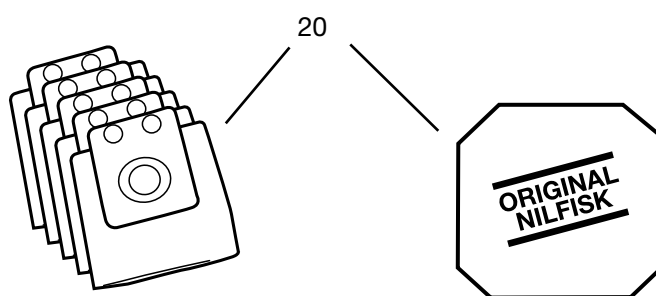
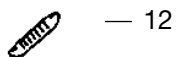
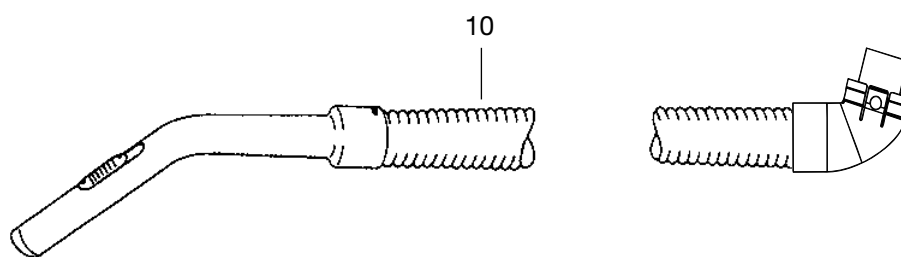

ACCESSORIES Ø32 MM**TUBES, HOSE AND DUST BAG. BackVacuum, double insulated****15**

Item	Ref. No.	Qty.	Description	Note	EAN code 5715492+
2	100916	1	Tube, telescopic Length max 1130 mm	Steel	
10	100917	1	Hose plastic with coupling and curved tube. Length: 1150 mm	Plastic	+ 006762
12	100951	1	Atmos valve	Plastic	
20	100919	1	Dust bag, 5 pcs. packed with + one prefilter in a plastic bag		+ 006724

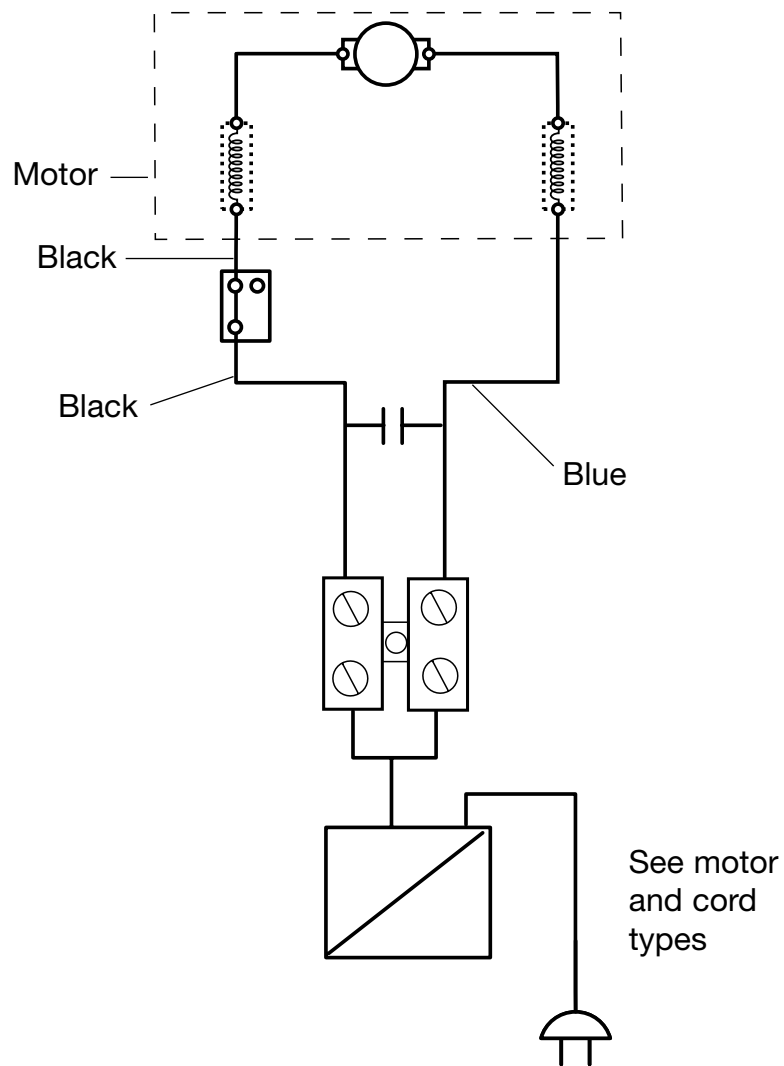

Symbol explanation

Armature	Field coil	Cord with plug	Terminal block	El-unit with on/off switch and socket for el-outlet	Thermo switch	Capacitor

