



Electronic Service Manuals

This electronic document is provided as a service to our customers. We do not create the contents of the information contained in this document. Should you have detailed questions pertaining to the information contained in this document, you may contact Michco, or the manufacturer which provided the original information in this electronic deliverable. Michco's only part in this electronic deliverable was the electronic assembly process. By providing this manual on line we are not guaranteeing parts availability.

You may contact Michco through the following methods:

Phone (517) 484-9312 or (800) 331-3339

2011 N. High St. -- Lansing, Michigan -- 48906

Fax: (517) 484-9836

Email: CustServe@Michco.com

Web site: www.Michco.Com

Parts Web site: www.FloorMachineParts.Com

Order Parts on Line at:

www.FloorMachineParts.Com

Directly to Parts & Service:

By Email: **Shop@Michco.com**

By Fax: (517) 702-2041

By Voice: Use numbers above.

Serving the Cleaning Industry Since 1922

Notice: All copyrighted material remains property of original owners, all trademarks are property of respective owners. Manuals are subject to Manufacturer's reproduction limitations. Originals or reproductions were provided by manufacturers through a request. We make no warranty as to the correctness of information provided in this document and you assume all risk. By placing these manuals on line we are not declaring our corporation to be an manufacturer authorized dealer or provider, please check our web site for authorized manufacturers we represent.

OWNERS GUIDE

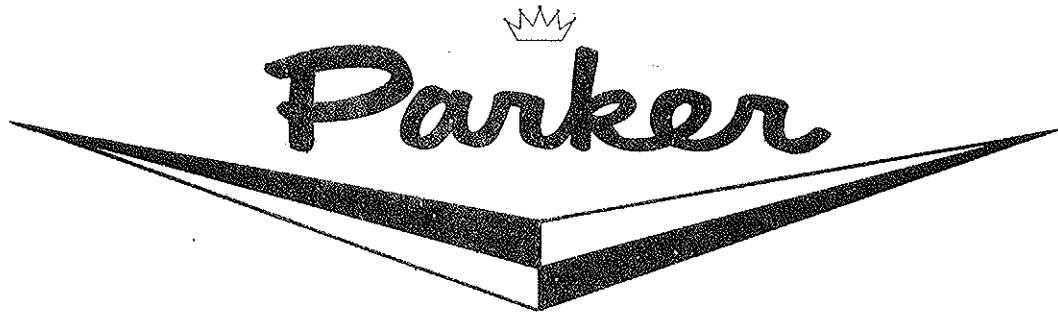

Lawn Beauty® Spreaders

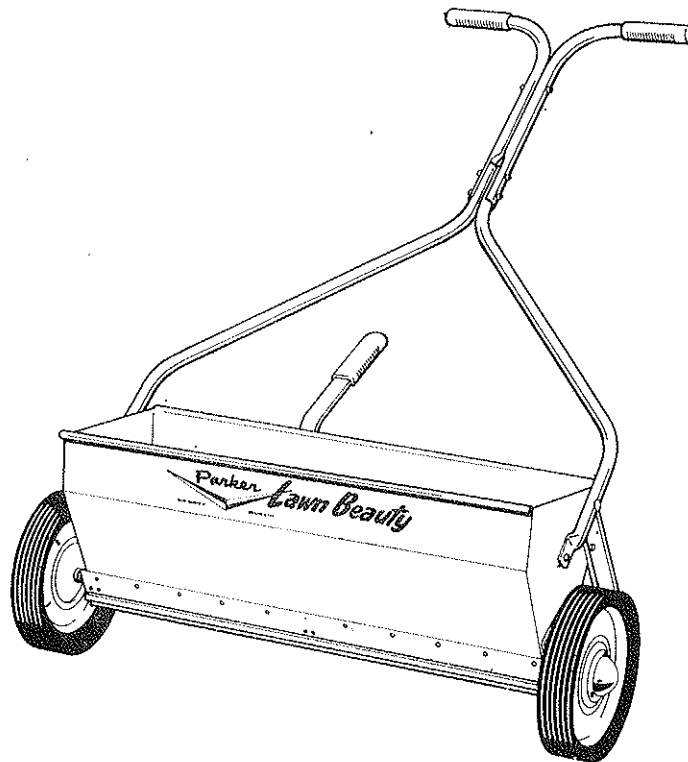

-Plate No. 313-

IMPORTANT

ALWAYS GIVE THE FOLLOWING INFORMATION WHEN ORDERING REPAIR PARTS:

- | | |
|-------------------------------|---|
| 1. PART NUMBER (Not Ref. No.) | 3. DESCRIPTION OF PART |
| 2. QUANTITY NEEDED | 4. MODEL No. LB-7624 - LB-7630
LB-7636 |

If unable to obtain parts locally, write down above information and send to:
PARKER SWEEPER CO., BOX 1728, SPRINGFIELD, OHIO 45501

Your unit is right hand (R.H.) or left hand (L.H.) as you stand behind it.

SPREADER ASSEMBLY

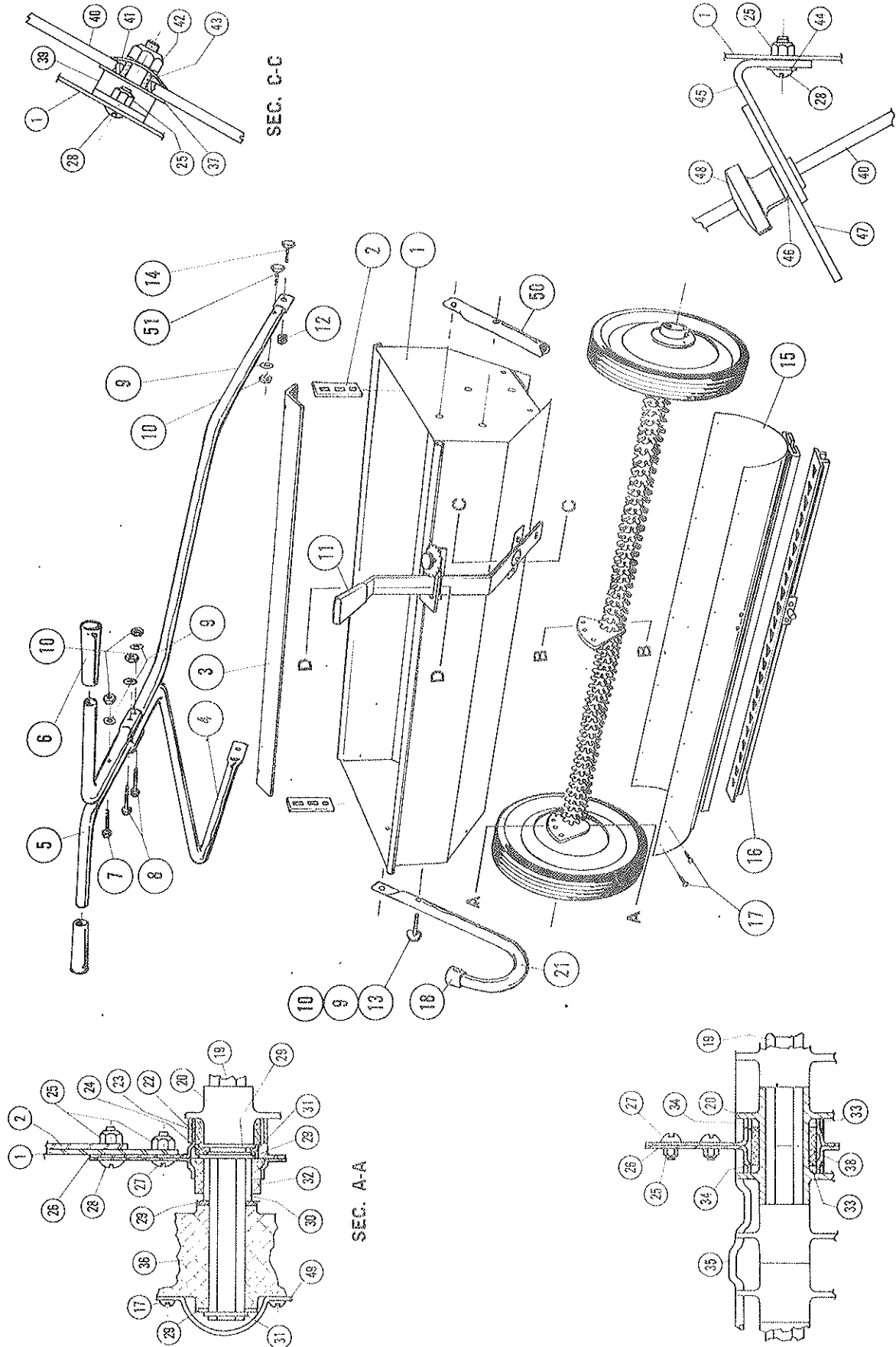

SEC. D-D

Figure 1

SEC. B-B

SEC. A-A

SEC. C-C

SPREADER ASSEMBLY PARTS LIST

Ref. No.	Part No.	Description	Qty. Per Unit 24" 30" 36"	Ref. Part No.	Description	Qty. Per Unit 24" 30" 36"
1	76-98-C	Hopper Assembly	1	23	76-84-A Seal-Felt	2
	76-99-C	Hopper Assembly	1	24	76-83-A Spacer-Foam	2
2	76-100-C	Hopper Assembly	2	25	365-10 Nut-Hex Lock 10-24	2
3	76-92-B	Support - Baffle	1	26	76-108-C Bearing-Retainer	13
	76-125-B	Baffle	1	27	515-10-6 Screw-Rd. Hd. 10-24 x 3/8	6
	76-126-B	Baffle	1	28	515-10-8 Screw-Rd. Hd. 10-24 x 1/2	7
4	76-105-C	Handle-Lower	2	29	76-86-A Washer-Special	6
	76-106-C	Handle-Lower	2	30	76-89-A Wheel Spacer	8
	76-107-C	Handle-Lower	2	31	1000-10 Ring-Retaining-Ext.	2
5	76-94-B	Handle-Upper	2	32	76-87-A Bearing	4
6	76-68-A	Grip-Handle	2	33	76-85-A Seal-Felt	2
7	69-416-32	Bolt-Cont. Hd. 1/4-20 x 1 3/4	1	34	76-66-A Seal Protector	2
8	69-416-36	Bolt-Cont. Hd. 1/4-20 x 3	2	35	76-95-B Rod-Agitator	2
9	935-416	Washer-Spring Lock 1/4	5	36	76-96-B Rod-Agitator	2
10	335-416	Nut-Hex Plain 1/4-20	5		76-97-B Rod-Agitator	2
11	76-80-A	Grip-Lever	1		76-90-C Wheel	2
12	365-416	Nut-Hex Lock 1/4-20	4		SA-399-C Wheel Assembly	2
13	69-416-20	Bolt-Cont. Hd. 1/4-20 x 1 1/4	4	37	71-37-A Washer-Special	1
14	65-416-10	Bolt-Hex Hd. 1/4-20 x 5/8	2	38	76-88-A Bearing	1
15	76-118-F	Hopper-Bottom	1	39	73-188-A Bracket Weldment	1
	76-119-F	Hopper-Bottom	1	40	73-182-B Lever	1
	76-120-F	Hopper-Bottom	1	41	53-165-A Washer-Spring	1
16	SA-525-B	Slide Assembly	1	42	365-516 Nut-Hex Lock 5/16-18	1
	SA-527-B	Slide Assembly	1	43	59-29-A Spacer	1
	SA-527-B	Slide Assembly	1	44	945-10 Washer-Plain #10	2
17	534-7-6-SS	Screw-Sht. Metal SS	28	45	73-384-A Bracket-Supt. Weldment	1
18	73-35-A	Caps-Tubing	32	46	945-416 Washer-Plain 1/4	1
19	76-102-B	Shaft-Agitator	2	47	67-204-A Gauge - Regulator	1
	76-103-B	Shaft-Agitator	2	48	67-618-A Knob	1
	76-104-B	Shaft-Agitator	2	49	67-213-A Hub Cap	1
20	71-53-A	Disk-Agitator	30	50	76-147-RB Leg	2
21	76-146-LB	Leg	1	51	65-416-24 Bolt-Hex Hd. 1/4-20 x 1 1/2	2
22	76-65-A	Seal Protector	2			2

Figure 1

SPREADER ASSEMBLY

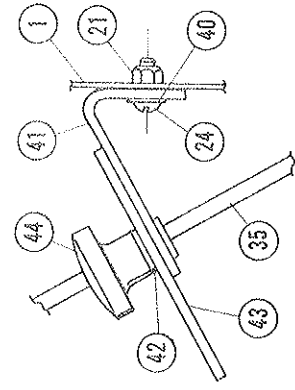
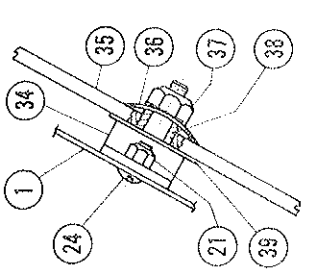
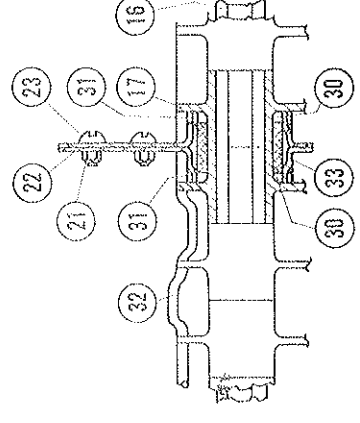
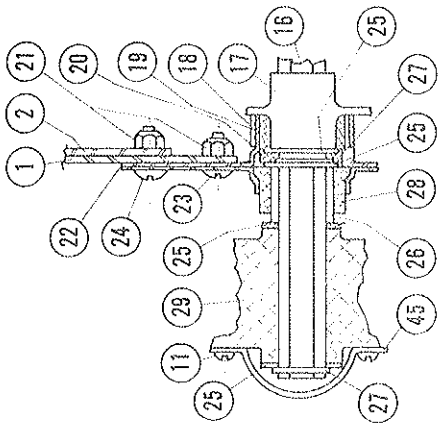
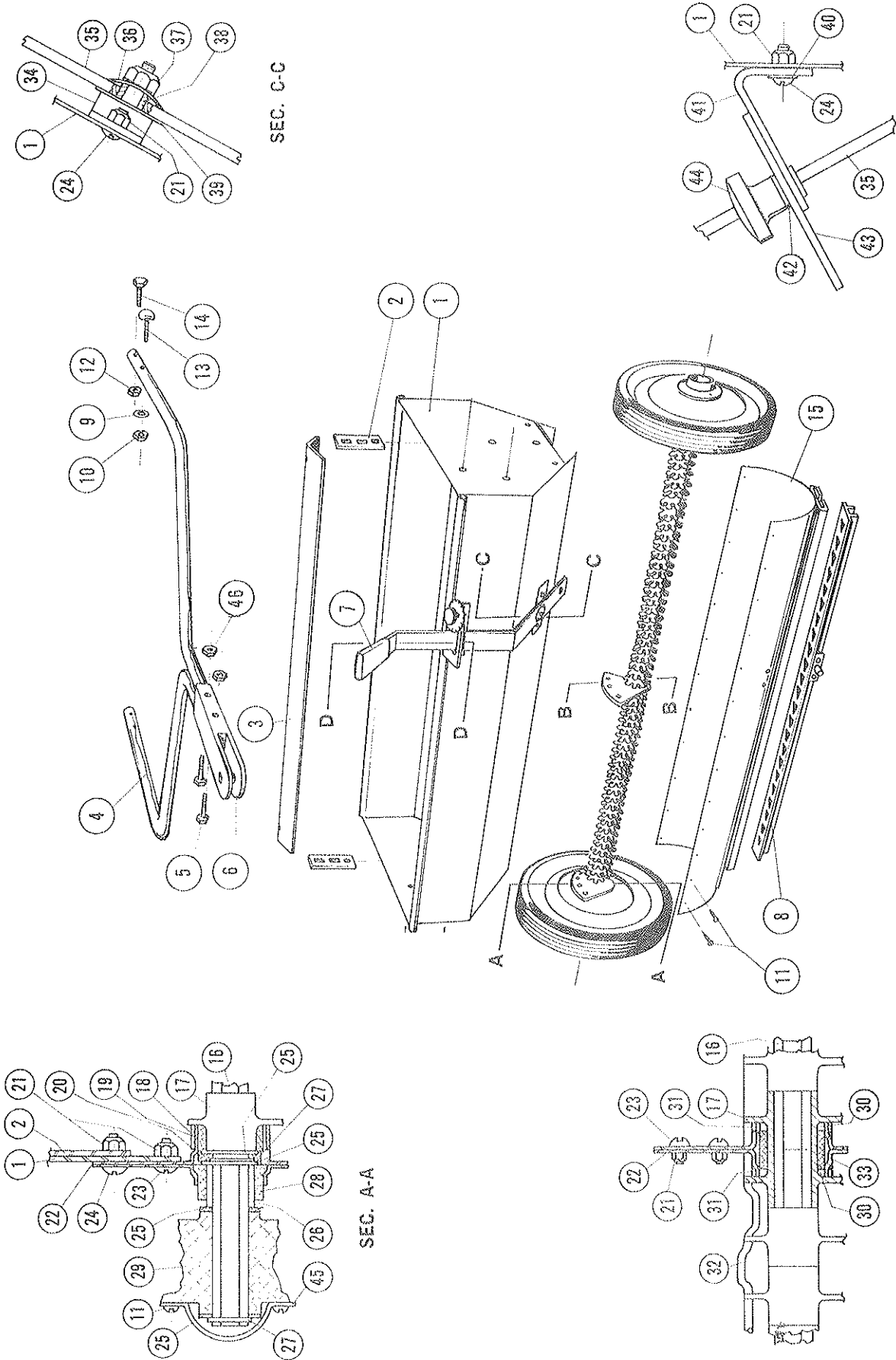

Figure 1

SPREADER ASSEMBLY PARTS LIST

Ref. Part No.	Description	Quantity per Unit 30" 36"	Ref. Part No.	Description	Quantity per Unit 30" 36"
1	76-99-C Hopper Weldment	1	22	76-108-C Bearing Retainer	6
2	76-100-C Hopper Weldment	1	23	515-10-6 Screw-Rd. Hd. 10-24 x 3/8	6
3	76-92-B Support - Baffle	2	24	515-10-8 Screw-Rd. Hd. 10-24 x 1/2	6
4	76-125-B Baffle	1	25	76-86-A Washer-Special	8
5	76-126-B Baffle	1	26	76-89-A Wheel Spacer	2
6	76-106-C Handle-Lower	2	27	1000-10 Ring-Retaining-Ext.	4
7	76-107-C Handle-Lower	2	28	76-87-A Bearing	4
8	65-416-40 Bolt-Hex Hd. 1/4-20 x 2 1/2	2	29	76-90-C Wheel	2
9	76-101-C Tongue	1	30	SA-399-C Wheel Assembly	2
10	76-80-A Grip-Lever	1	31	76-85-A Seal-Felt	2
11	SA-526-A Slide Assembly	1	32	76-66-A Seal Protector	2
12	SA-527-A Slide Assembly	1	33	76-96-B Rod-Agitator	2
13	935-416 Washer-Spring Lock 1/4	2	34	76-97-B Rod-Agitator	2
14	335-416 Nut-Hex Plain 1/4-20	2	35	76-88-A Bearing	1
15	534-7-6-SS Screw-Sht. Metal	2	36	73-182-A Bracket-Weldment	1
16	365-416 Nut-Hex Lock 1/4-20	2	37	73-182-B Lever	1
17	69-416-20 Bolt-Cont. Hd. 1/4-20 x 1 1/4	2	38	53-165-A Washer-Spring	1
18	65-416-8 Bolt-Hex Hd. 1/4-20 x 1/2	2	39	365-516 Nut-Hex Lock 5/16-18	1
19	76-119-F Hopper Bottom	1	40	59-29-A Spacer	1
20	76-120-F Hopper Bottom	1	41	71-37-A Washer-Special	1
21	76-103-B Shaft-Agitator	2	42	945-10 Washer-Special #10	2
22	76-104-B Shaft-Agitator	2	43	73-384-A Bracket-Supt. Weldment	2
23	71-53-A Disk Agitator	30	44	946-416 Washer-Plain 1/4	1
24	76-65-A Seal Protector	2	45	67-204-A Gauge - Regulator	1
25	76-84-A Seal-Felt	2	46	67-618-A Knob	1
26	76-83-A Spacer-Foam	2		67-213-A Hub Cap	1
27	365-10 Nut-Hex Lock 10-24	13		364-416 Nut-Hex Lock 1/4-20	2

Figure 1

CARTON CONTENTS

When unpacking the Spreader, you will find the following items and assemblies.

Fig. 2 - HOPPER ASSEMBLY

1. Lay the Spreader Hopper Assembly down with the opening resting on a flat surface.

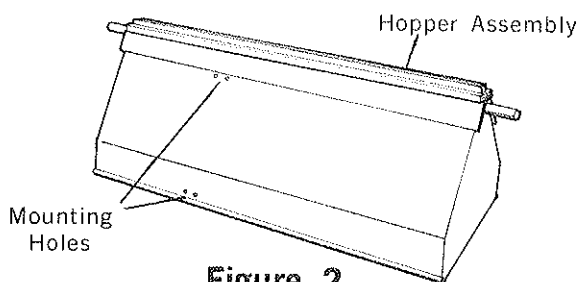

Figure 2

Fig. 3 - WHEELS - HANDLE (UPPER) - LEGS HANDLE (LOWER) - BAFFLE SLIDE ASSEMBLY - SHIFT LEVER REGULATOR ASSEMBLY - HARDWARE BAG

Hardware Bag Contains the following:

1	73-188-A	Bracket Weldment
1	71-37-A	Washer-Special
1	59-29-A	Spacer
1	53-165-A	Washer-Spring
1	365-516	Nut-Hex $\frac{5}{8}$ -18
2	65-416-24	Bolt-Hex Hd. $\frac{1}{4}$ -20 x $1\frac{1}{2}$
2	76-68-A	Handle Grips
5	935-416	Washer-Lock
5	335-416	Nut-Hex Plain $\frac{1}{4}$ -20
4	365-416	Nut-Lock $\frac{1}{4}$ -20
2	69-416-20	Bolt-Cont. Hd. $\frac{1}{4}$ -20 x $1\frac{1}{4}$
2	65-416-10	Bolt-Hex Hd. $\frac{1}{4}$ -20 x $\frac{5}{8}$
2	65-416-36	Bolt-Hex Hd. $\frac{1}{4}$ -20 x $2\frac{1}{4}$
2	1000-10	Ring-Retaining-Ext.
4	76-86-A	Washer-Special
4	515-10-8	Rd. Hd. Screw 10-32 x $\frac{1}{2}$
2	945-10	Washer
4	365-10	Nut-Lock 10-32
1	65-416-32	Bolt-Hex Hd. $\frac{1}{4}$ -20 x 2
2	73-35-A	Cap-Tube

USED ON MODEL LB-7636 ONLY.

4	534-7-6-SS	Sheet Metal Screw
2	67-213-A	Hub Caps

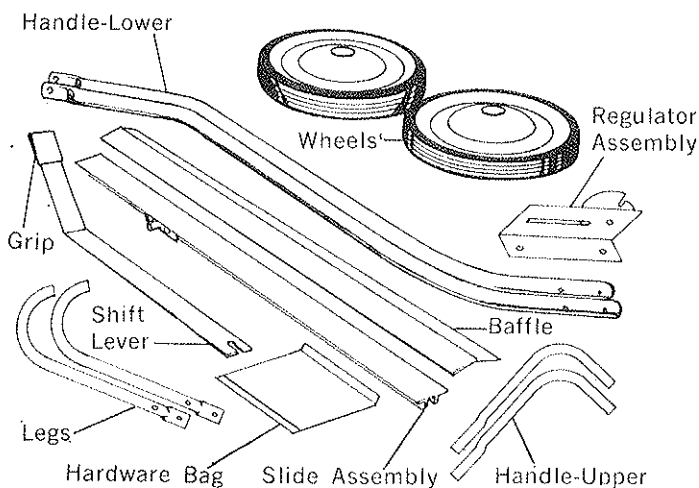

Figure 3

ASSEMBLY INSTRUCTIONS

2. Fig. 4 - Install the Slide Assembly into the bottom opening of the Hopper Assembly. Be sure the Bracket Stud is on the same side as the Mounting Holes as shown.

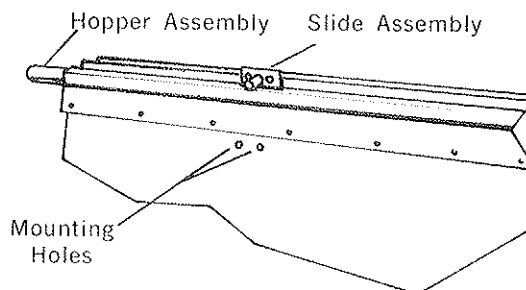

Figure 4

3. Fig. 5 - Mount both Wheels on the Hopper Assembly Axle in the sequence as shown; Washer, Wheel, Washer and Ring-Retaining-Ext.

The Hub Cap and Sheet Metal Screws are only used on Model LB-7636.

Wheels on LB-7636 Spreader have a long Hub toward the side of the Hopper.

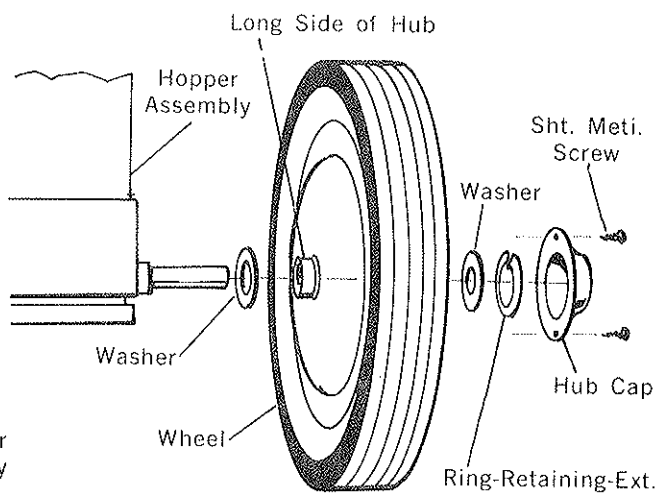

Figure 5

4. Fig. 6, Ref. Fig. 1, Sec. C-C - Slide the Lever through the Regulator Assembly Bracket. Now attach the Bracket Weldment to the Lever as shown in Fig. 1, Sec. C-C, using the Spacer, Washers and Lock Nut. Now place the Slot at the bottom of the Shift Lever over the

ASSEMBLY INSTRUCTIONS

Stud on the Slide Assembly. Line the holes in the Lever Assembly and Regulator Assembly with the Hopper Assembly. Position the Lever against the end of the Slot opposite the Gauge. Now fasten together with Rd. Hd. Screws and Lock Nuts. (Place a Flat Washer under the Screw Hd. and over the slot in the Regulator Assembly Bracket. See Fig. 1, Sec. D-D). The Lock Nuts to be on the inside of the Hopper.

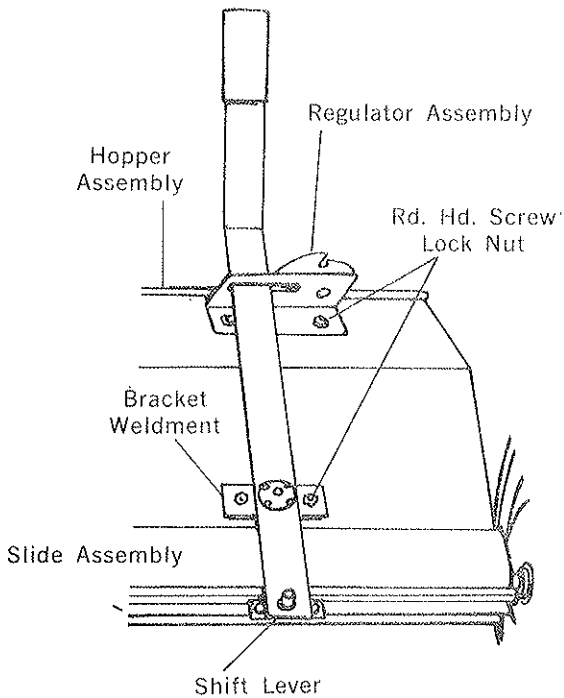

Figure 6

- Fig. 7 - Fasten a Leg on each side at the Hopper Assembly using a Contour Hd. Bolt, Lock Washer and Nut at hole "A". Line up the top hole in the Leg with hole "B" in the Hopper Assembly before tightening up the Bolt and Nut. The Contour Hd. of the Bolt must be on the tube side (Leg). **NOTE** - The Legs are left and right. Install Tube Caps.

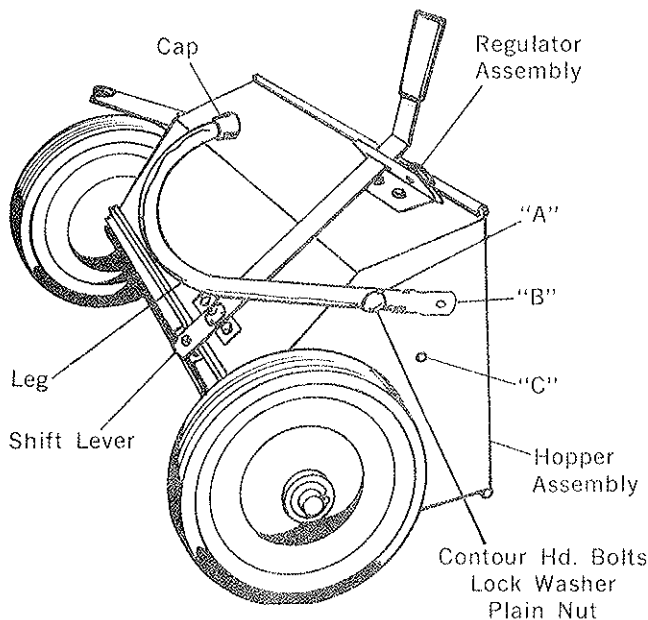

Figure 7

HANDLE ASSEMBLY

- Fig. 8 - Using the Bolts, Washers and Nuts called for, assemble the Handle, leaving the Bolts loose. Slip the Handle Grips on the Upper Handles.

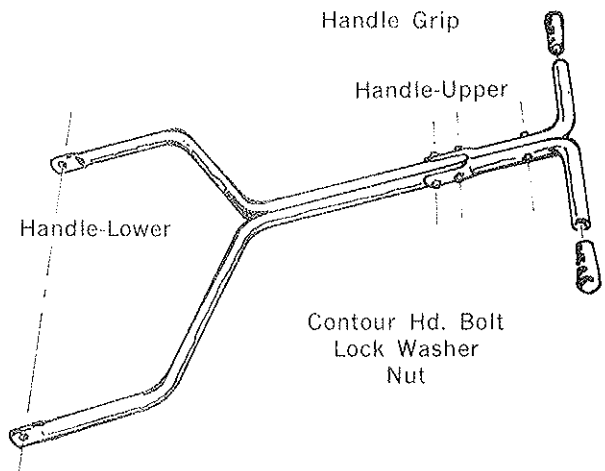

Figure 8

ASSEMBLY INSTRUCTIONS

- Fig. 9 - Place the Handle Assembly over the Hopper Assembly and fasten with Bolts, Washers and Nuts shown at holes "B" and "C". The Hex Hd. Bolt goes thru the Leg Handle and side panel of the Hopper. The Hex Hd. Bolt goes thru the Handle and side panel of the Hopper and Support Baffle. The Washers and Nuts to be on the inside of the Hopper.

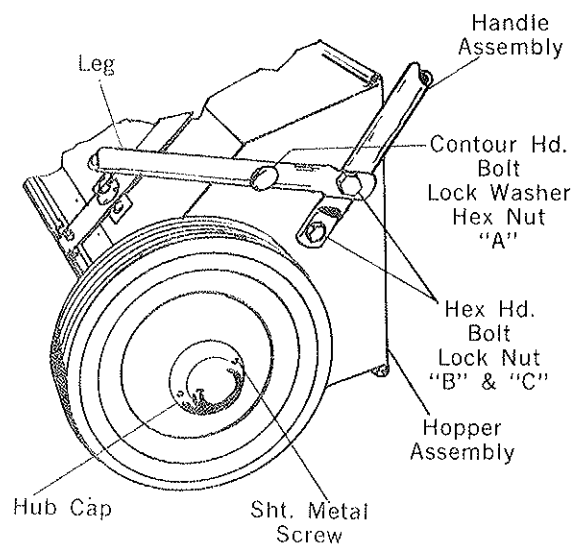
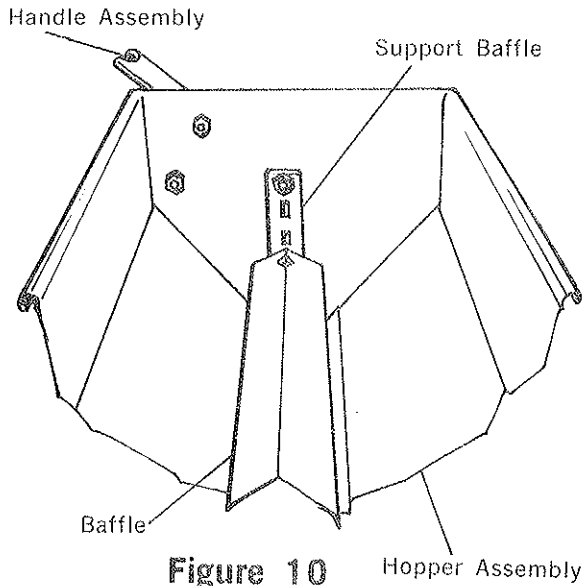

Figure 9

ASSEMBLY & OPERATING INSTRUCTIONS

8. Fig. 10- The Baffle is positioned over the Hooks on the Support Baffle. Position to height best suited for type material used.



HOW TO ADJUST

9. Fig. 6 - Loosen the two Rd. Hd. Screws holding the Regulator Assembly to the Hopper Assembly so the Regulator Assembly will slide in the Screw Slots.

Fig. 11 - Now loosen the Knob on the Regulator Assembly and turn the Gauge so the No. 1 is in line with the Shift Lever, then tighten the Knob. Shift the Lever tight against Regulator Gauge. While holding the Lever against the Gauge, move the entire Regulator Assembly and Lever left or right, as necessary to move the Slide Assembly so that the holes in the Hopper Assembly bottom are closed by the Slide Assembly. Now lighten the Rd. Hd. Screws to fasten the Regulator Assembly to the Hopper Assembly. To check the setting of the Regulator Assembly, turn the Gauge to No. 19 and move the Shift Lever against the Gauge. The Slots in the Hopper Assembly bottom should be completely open. You should be able to open and close the openings in the Hopper Bottom now by setting the Gauge at different number settings.

Now check and tighten all Bolts, Screws and Nuts on the Spreader.

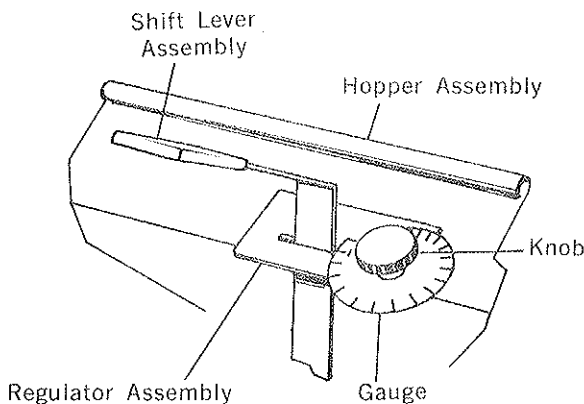

Figure 11

HOW TO OPERATE

10. Fig. 12 - Loosen the Knob on the Regulator Assembly and set the Gauge so that No. 7 is in line with the Shift Lever (No. 7 is an arbitrary dial setting for testing the spreading of the material). Now set the Baffle in a low position for free flowing material or high position for organic fertilizer, peat moss, etc. Fill the Hopper about $\frac{1}{2}$ full of material. Using a clean area on a side walk or drive-way, make a pass a couple of feet long with the Shift Lever open. According to your choice of coverage, it may be necessary to re-adjust the Gauge setting and make several passes to arrive at a satisfactory setting. Sweep up the material from the test passes and put back into the Hopper.

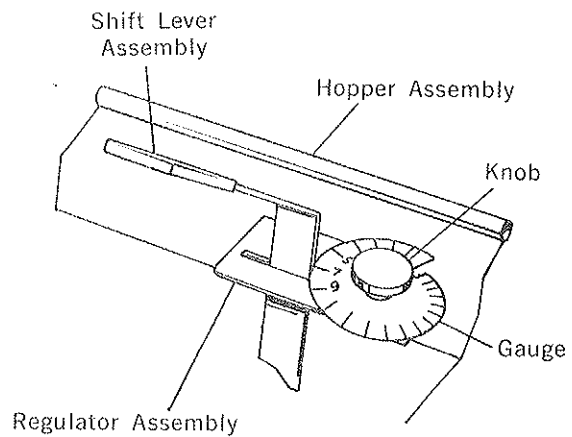

Figure 12

CLEAN THOROUGHLY AFTER EACH USE.

11. Your Lawn Beauty Spreader is a precision-built machine designed to give you years of satisfactory service. As with all quality machines, it does require care - a few minutes servicing after each use will assure you a perfect spreader for perfect spreading.
 - A. First empty the Hopper of all materials. **CAUTION: do not dump on lawn or ground.**
 - B. Loosen the Knob and rotate the Gauge until the Slot lines up with the Shift Lever.
 - C. Move the Shift Lever in the slot on the Gauge. Tighten the Knob.
 - D. Ref. Fig. 6 - Loosen the R.H. Screw and Nut holding the Shift Lever Assembly to the Hopper. Slip the Shift Lever Assembly off the Slide Assembly Stud.
 - E. Remove one Wheel from the Hopper Assembly and remove Slide Assembly from the Hopper Assembly.
 - F. Use a dry cloth to clean inside and outside of the Hopper and Bottom Slide. Put a light coat of oil on the outside of the Bottom Slide and bottom of the Hopper.
 - G. Reassemble Slide Assembly, Wheel and Shift Lever Assembly. Ref. to Paragraph 2-3-4-9 and 10.

ASSEMBLY INSTRUCTIONS

Stud on the Slide Assembly. Line the holes in the Lever Assembly and Regulator Assembly with the Hopper Assembly. Position the Lever against the end of the Slot opposite the Gauge. Now fasten together with Rd. Hd. Screws and Lock Nuts. (Place a Flat Washer under the Screw Hd. and over the slot in the Regulator Assembly Bracket. See Fig. 1, Sec. D-D). The Lock Nuts to be on the inside of the Hopper.

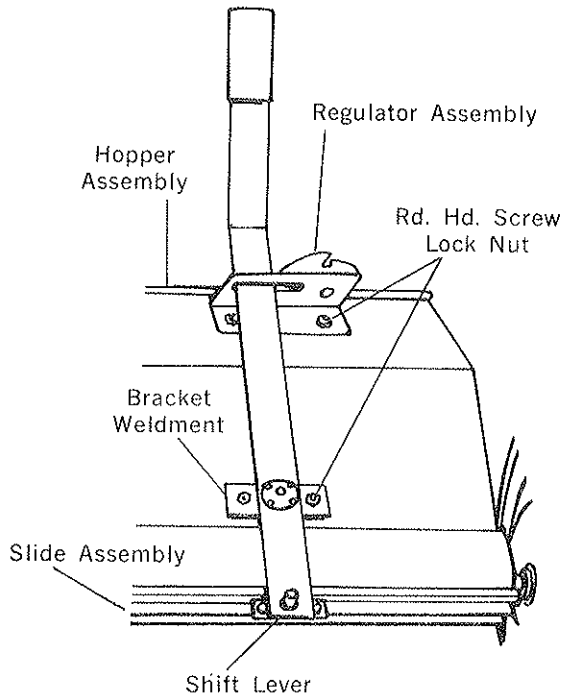

Figure 6

HITCH ASSEMBLY

5. Fig. 7 - Using the Bolts, Washers and Nuts called for, assemble the Hitch leaving the Bolts loose.

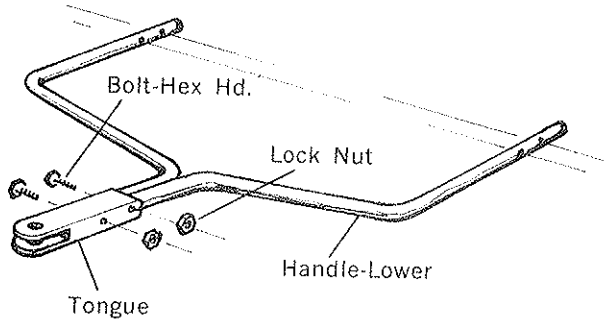

Figure 7

6. Fig. 8 - Place the Hitch Assembly over the Hopper Assembly and fasten with Bolts, Washers and Nuts shown at holes "A" and "B". The Contour Hd. Bolt goes thru the Handle-Lower and side panel of the Hopper. The Hex Hd. Bolts go thru the Handle side panel of the Hopper and Support Baffle. The Washers and Nuts to be on the inside of the Hopper. Now tighten all Bolts and Nuts.

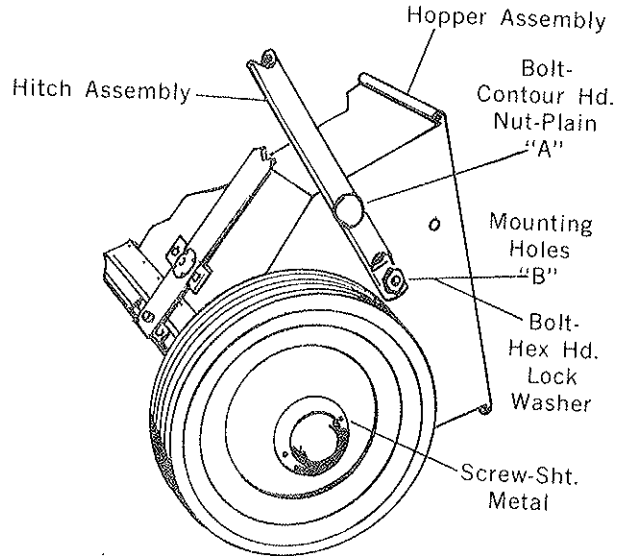

Figure 8

ASSEMBLY INSTRUCTIONS

7. Fig. 9 - The Baffle is positioned over the Hooks on the Support Baffle. Position to height best suited for type material used.

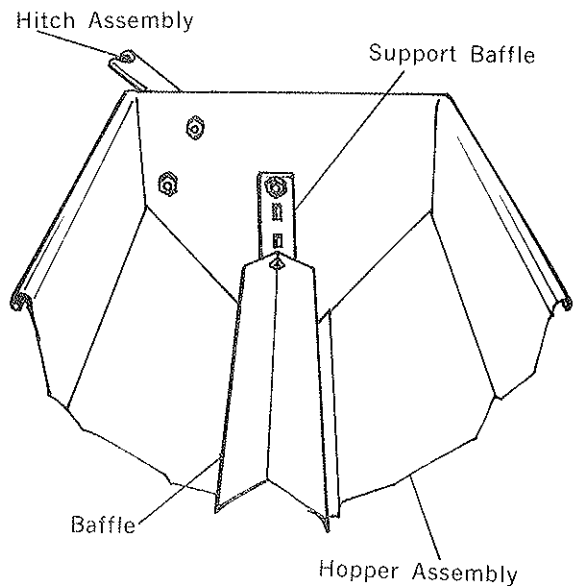
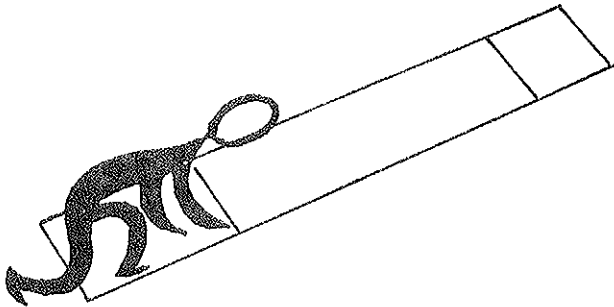

Figure 9

HOW TO FIND A DIAL SETTING NUMBER FOR YOUR LAWN BEAUTY SPREADER.

To find a dial setting number for the material you wish to spread, fill the Hopper about half full and then follow the procedure below.



1. First obtain a piece of wrapping paper wider than your Spreader and at least five feet longer than the test strip length indicated in paragraph 8 below. Set this down on a level area.
2. Place on the paper two heavy marks the distance apart required for your size Spreader.

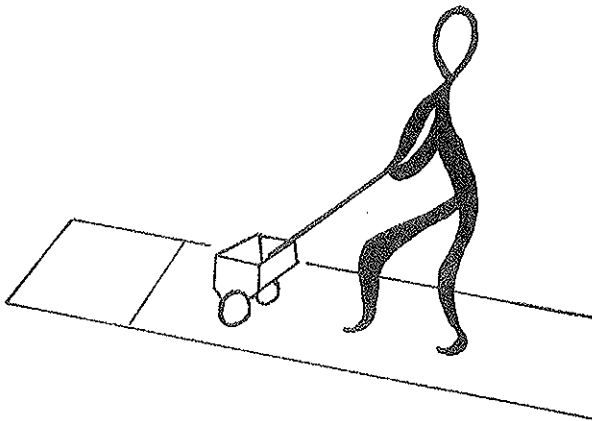

3. Pelletized and granular fertilizers are usually applied in heavier rates per thousand square feet . . . an arbitrary dial number of 7 could be chosen for your first test for a product such as this. Many insecticides are applied in lighter rates so a good arbitrary dial setting to use for these would be 5.
4. Make one pass over the test-strip, opening the slide at the first mark, and closing it securely at the second mark.

5. Gather the material just spread and weigh it in ounces.

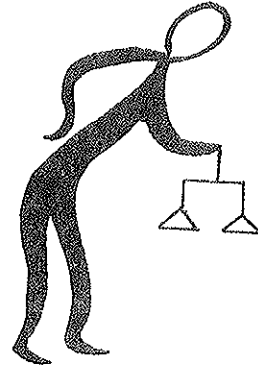

6. Multiply the weight by $2\frac{1}{2}$; the result will be the rate in pounds per thousand square feet.

Example

Weight of material spread in one pass . . . 4 oz.
 Multiply $4 \times 2\frac{1}{2}$ to equal 10 pounds, per thousand square feet.

7. If the rate per thousand square feet arrived at in step 6 above is different than that desired, additional passes will be required using higher or lower dial numbers; if it is too high, use a lower dial number and try another pass; if it is too low, use a higher number for an additional pass. It may take a number of trials to find the exact rate desired.

8. Test Strip Lengths	English	Metric
24" Spreader	12 $\frac{1}{2}$ ft.	328 CM
30" Spreader	10 ft.	263 CM
36" Spreader	8 $\frac{1}{3}$ ft.	220 CM

9. If the material to be applied is marked for metric measurements, follow the instructions for paragraph (1) thru paragraph (4). Then gather the material you have just spread and weigh it in grams. Divide by two (2) and the result is the number of grams per square meter.
10. For the most uniform application, calibrate the Spreader for half the application rate, then cover the turf area in two applications, the second at a right angle to the first. While this method takes twice as long, it minimizes streaking and uneven patches.

PARTS DISTRIBUTOR LISTING

Order all parts from your nearest **PARKER PARTS DISTRIBUTORS**. If unable to locate the part from your Parts Distributor, forward your order to **PARKER SWEEPER COMPANY** for handling.

PARKER SWEEPER CO.
P. O. Box 1728
Springfield, Ohio 45501
Phone: 513-323-4901

Hart-Greer, Inc.
106 Distribution Dr.
BIRMINGHAM, ALABAMA 35209

Lawn & Garden Supply Co.
2222 N. 27th Ave.
PHOENIX, ARIZONA 85701

Lawn & Garden Supply Co.
5455 So. Nogales Highway
TUCSON, ARIZONA 85706

H. V. Carter Company
1700 East 14th St.
OAKLAND, CALIFORNIA 94607

Tarzana Mower & Engine Parts, Inc.
18750 Oxnard St.
TARZANA, CALIFORNIA 19356

Colorado Outdoor Power Equip., Inc.
527 W. Evans
DENVER, COLORADO 80223

Zaun Equipment Co.
Route 13, Box 685-Z
FORT MYERS, FLORIDA 33908

Zaun Equipment Inc.
1741 Hamilton St.
JACKSONVILLE, FLORIDA 32210

Florida Turf & Garden
7275 N. W. 64th St.
MIAMI, FLORIDA 33166

Zaun Equipment, Inc.
1140 So. Pio Grande Ave.
ORLANDO, FLORIDA 32805

Zaun Equipment Inc.
3032 44th Avenue, North
ST. PETERSBURG, FLORIDA 33714

Wislar & Company Inc.
4505 Mills Place, S.W.
ATLANTA, GEORGIA 30336

Geo. A. Davis
5440 Northwest Highway
CHICAGO, ILLINOIS 60630

Plante's Lawn Equipment Inc.
4 Grant St.
NORTH AURORA, ILLINOIS 60542

T. E. Booher & Sons
1009 West State St.
ALBANY, INDIANA 47320

Bruce Engine Inc.
1791 N. W. 86th St.
DES MOINES, IOWA 50322

Louisville Cycle & Supply
400 Almond Avenue
LOUISVILLE, KENTUCKY 40209

Morton B. Collins
300 Birnie Avenue
SPRINGFIELD, MASSACHUSETTS 01170

Frost Company
483 Wildwood Street
WOBURN, MASSACHUSETTS 01801

Ideal Mower Sales Inc.
811 Woodward Heights
FERNDALE, MICHIGAN 48910

Lorenz Service Company
2500 So. Pennsylvania Ave.
LANSING, MICHIGAN 48910

Ball Sales & Service Co.
G-6200 N. Saginaw
MT. MORRIS, MICHIGAN 48458

R. L. Gould Company
3711 N. Lexington Ave.
ST. PAUL, MINNESOTA 55112

Gunthers Service & Supply
7320 Wornall Rd.
KANSAS CITY, MISSOURI 64114

Henzler, Inc.
2015 Lemay Ferry Rd.
ST. LOUIS, MISSOURI 63125

Port Huron Machinery & Supplies
801 Que Street
LINCOLN, NEBRASKA 68508

George Smith & Sons Inc.
322 Broadway
BETHPAGE, L.I., NEW YORK 11714

Grasslands Equip. & Irrigation
892 Troy Schenectady Rd.
LATHAM, NEW YORK 12110

PARTS DISTRIBUTOR LISTING (continued)

The Messinger Company, Inc.
374 Avery St.
ROCHESTER, NEW YORK 14606

Henry W. O'Neil & Associates Inc.
410 No. Goodman St.
ROCHESTER, NEW YORK 14609

E. J. Smith & Sons
4250 Golf Acres Drive
CHARLOTTE, NORTH CAROLINA 28266

Hayward Distributing Co.
460 Neilston St.
COLUMBUS, OHIO 43215

Hershman's Inc.
12477 Benner Rd.
RITTMAN, OHIO 44270

M.P.E. Sales Inc.
25850 Chardon Road
CLEVELAND, OHIO 44143

Tri-County Sales & Service
15 North West Avenue
YOUNGSTOWN, OHIO 44502

Wait Sales Company
406-10 S. Peoria, Box 1015
TULSA, OKLAHOMA 74120

Baltz & Son Co.
9817 East Burnside
PORTLAND, OREGON 97216

Polson Company
208 S. E. Hawthorne Blvd.
PORTLAND, OREGON 97214

Lawn & Golf Supply Co.
647 Nutt Rd.
PHOENIXVILLE, PENNSYLVANIA 19460

Bluemont Co.
11125 Frankstown Road
PITTSBURGH, PENNSYLVANIA 15235

Niemeyer Corp.
1135 Phoenixville Pike, Box 531
WEST CHESTER, PENNSYLVANIA 19380

Goldthwaite's of Dallas Inc.
2700 Forest Lane, Box 34660
DALLAS, TEXAS 75234

Goldthwaites of Houston Inc.
5703 Chimney Rock Rd., Box 343
HOUSTON, TEXAS 77001

Goldthwaite's of Texas Inc.
10751 Sentinel
SAN ANTONIO, TEXAS 78217

A-1 Engine & Mower Co.
437 East 9th Street
SALT LAKE CITY, UTAH 84111

The Bentley Company
4126 Airport Way, South
SEATTLE, WASHINGTON 98108

Northwest Mower, Inc.
926 N. 165th Street
SEATTLE, WASHINGTON 98133

Polson Company
625 Lander Street
SEATTLE, WASHINGTON 98134

Polson Company
East 210 Montgomery St.
SPOKANE, WASHINGTON 99207

Farm & Tiller Sales, Ltd.
1205 E. Hastings Street
VANCOUVER, B.C., CANADA

Robertson Seeds, Ltd.
8118 - 103 Street
EDMONTON, ALBERTA, CANADA

Morin Equipment Inc.
270 Industrial Park Road
LONGUEUIL, QUEBEC, CANADA

Morin Equipment Inc.
2075 Branley
STE FOY, QUEBEC, CANADA

Duke Lawn Equipment
1184 Plains Road, East
BURLINGTON, ONTARIO, CANADA