



## Electronic Service Manuals

This electronic document is provided as a service to our customers. We do not create the contents of the information contained in this document. Should you have detailed questions pertaining to the information contained in this document, you may contact Michco, or the manufacturer which provided the original information in this electronic deliverable. Michco's only part in this electronic deliverable was the electronic assembly process. By providing this manual on line we are not guaranteeing parts availability.

You may contact Michco through the following methods:

Phone (517) 484-9312 or (800) 331-3339

2011 N. High St. -- Lansing, Michigan -- 48906

Fax: (517) 484-9836

Email: [CustServe@Michco.com](mailto:CustServe@Michco.com)

Web site: [www.Michco.Com](http://www.Michco.Com)

Parts Web site: [www.FloorMachineParts.Com](http://www.FloorMachineParts.Com)

Order Parts on Line at:

**[www.FloorMachineParts.Com](http://www.FloorMachineParts.Com)**

Directly to Parts & Service:

By Email: **[Shop@Michco.com](mailto:Shop@Michco.com)**

By Fax: (517) 702-2041

By Voice: Use numbers above.

**Serving the Cleaning Industry Since 1922**

Notice: All copyrighted material remains property of original owners, all trademarks are property of respective owners. Manuals are subject to Manufacturer's reproduction limitations. Originals or reproductions were provided by manufacturers through a request. We make no warranty as to the correctness of information provided in this document and you assume all risk. By placing these manuals on line we are not declaring our corporation to be an manufacturer authorized dealer or provider, please check our web site for authorized manufacturers we represent.

# OWNER'S GUIDE



# Parker™

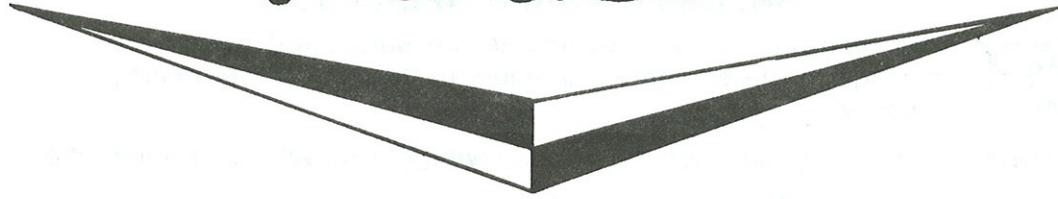

## SV-8330-SP SCAVENGER®

SELF-PROPELLED  
30" VACUUM SWEEPER



AF-364

**READ THESE INSTRUCTIONS  
BEFORE SETTING UP AND OPERATING MACHINE**

**BE SAFE. PROTECT YOUR FAMILY, YOUR FRIENDS, YOURSELF.  
OBSERVE ALL SAFETY INSTRUCTIONS.**

**PARKER SWEEPER COMPANY    Box 1728    Springfield, Ohio 45501-1728**

Plate No. 933 (Rev. 9-26-84)  
*updated 8-94*

## TO THE OWNER

These instructions were written to assist you in the assembly and operation of your Scavenger. **READ THE INSTRUCTIONS** thoroughly **BEFORE** attempting to assemble and operate the machine so that you are familiar with the complete procedure and the safety precautions.

### RULES FOR SAFE OPERATION



The following safety precautions are suggested to prevent damage to the equipment or injury to the operator or nearby persons.

1. Do not allow anyone to operate the Scavenger without proper instructions.
2. Do not permit children to operate the Scavenger.
3. Do not sweep too close to fire. Ingesting hot ashes will ignite the bag.
4. Stop the engine before reaching into the intake nozzle or discharge chute to dislodge sticks or other debris.
5. Stop the Engine before attempting to make any adjustment or performing any maintenance work on the Scavenger.
6. When working on the engine, always remove the spark plug wire from the engine and attach it to the V shaped clip on the engine head.
7. Do not run the engine in an enclosed area. Exhaust gases contain carbon monoxide, an odorless and deadly poison.
8. Do not fill the fuel tank while the engine is running. Spilling gasoline on a hot engine may cause a fire or an explosion.
9. While machine is running, do not leave it unattended.
10. Before using the machine to pick up debris, police the area to be cleaned first, picking up any large objects such as cans, toys, dog bones and chunks of wood. If these pass through the machine, they could damage the impeller, bend the engine crankshaft or put a hole in the bag.
11. Avoid using the machine in dangerous places where steep slopes or loose debris will endanger the safety of the operator or other people.
12. Keep all nuts, bolts and screws tight to be sure the Scavenger is in safe working condition.
13. Follow the maintenance instructions as outlined in this manual.
14. Do not start or run engine unless bag is properly secured as injury may result.

### IMPORTANT

#### ALWAYS GIVE THE FOLLOWING INFORMATION WHEN ORDERING REPAIR PARTS:

- |                               |                           |
|-------------------------------|---------------------------|
| 1. Part Number (Not Ref. No.) | 3. Description of Part    |
| 2. Quantity Needed            | 4. Model No. of Scavenger |

If unable to obtain parts locally, write down above information and send to:  
**PARKER SWEEPER CO., BOX 1728, SPRINGFIELD, OHIO 45501**

Your unit is right hand (R.H.) or left hand (L.H.) as you stand behind it.

## ASSEMBLY INSTRUCTIONS

**YOUR SAFETY IS OUR CONCERN. READ ALL SAFETY RULES AND OPERATING INSTRUCTIONS BEFORE ATTEMPTING TO OPERATE THIS EQUIPMENT. FAILURE TO FOLLOW SAFETY RULES AND OPERATING INSTRUCTIONS MAY RESULT IN SERIOUS INJURY.**

**NOTE:** All mounting hardware is on the unit in its proper location.

1. Remove unit from box. Do not discard any inserts or packing until unit is completely assembled.

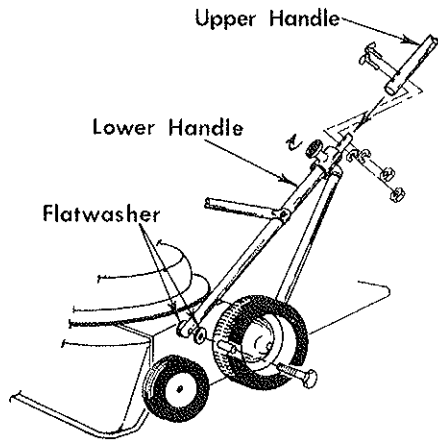

AF-361

2. Lower Handle has to be attached to the side of the unit at side plate in between the two wheels. Remove the Hex. Lock Nut from the bolt on the end of lower handle and insert the bolt into the hole in the side plate with the handle and flatwasher against the side. Add the Hex. Lock Nut and tighten. Repeat for opposite side.
3. To attach the upper handles to the lower handles, remove contour head bolts, lockwashers and hex nuts. Slide the ends of the upper handles down over the ends of the lower handles. Re-insert the contour head bolts into the handles. Add lockwasher and screw on hex nut.

**NOTE:** Be sure torque knobs are in holes and tightened securely.

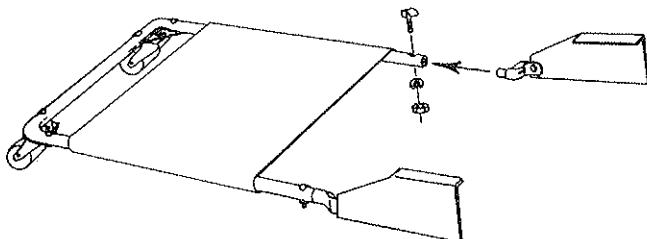

AF-362

4. Remove the contour Hd. bolt, lockwasher and hex. nut from the open end of the bag platform on each side. Insert the ends of the bag platform onto the ends of the end caps as shown. Insert the contour bolt through tubing and end cap and secure with lockwasher and hex. nut. Your bag platform was made to support the bag and keep it from dragging the floor, do not use it to carry any other object because damage may occur.
5. Attach the clutch cable to the spring on the lower portion of the machine. Cable must go through clamp at pivot bracket.

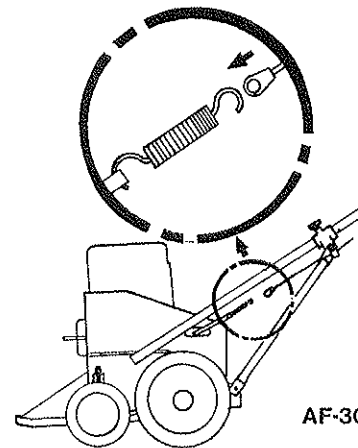

AF-303

6. Slide the bag deflector over the discharge chute, as shown. Engage the strap into the buckle and tighten to retain bag deflector. Slip the neck of the bag over the bag deflector and discharge housing until the tightening strap passes over the bag deflector to rest on the discharge housing. Pull the strap tight to secure the bag to the unit.

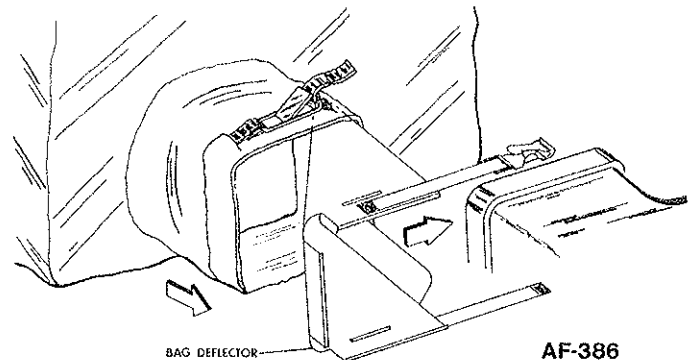

AF-386

**NOTE:** Unit can be used as a blower by removing bag and reversing deflector.

**OBSERVE SAFETY RULES AT ALL TIMES. DON'T TAKE CHANCES!**

# OPERATING INSTRUCTIONS

## READ SAFETY & OPERATING INSTRUCTIONS BEFORE OPERATING EQUIPMENT

**CAUTION:** The engine contains NO OIL. Read the engine instruction manual carefully before operating. Be sure you know how to start and stop engine.

1. Before starting the engine read and understand the following:
  - a. Be sure your engine crankcase is filled with the proper type and amount of oil.
  - b. Lubricate the wheel bearings and wheel axle on the caster once a week if used daily. A few drops of oil applied to the throttle control cable and wire where applicable, will keep it operating smoothly.

**NOTE:** Refer to engine operating instructions for proper lubrication of the engine.

### 2. HEIGHT ADJUSTMENT:

With the new side 5 position wheel adjustment it has been made possible to sweep up against the curbs, buildings, etc., from both sides or front. The height of the intake nozzle can be adjusted by the two smaller side wheels. By pulling the spring lever away from the bracket you will be able to move the tire up or down. Be sure the pin on the lever is properly seated in one of the 5 holes in the bracket. Move the tire up or down the same amount on both sides. **NOTE:** Be sure wheels are locked into position and level.

TO ADJUST NOZZLE  
PULL OUT AND SLIDE  
FRONT TIRE UP OR DOWN

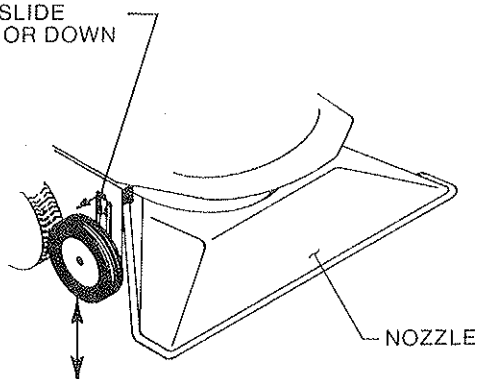

AF-360

3. To prevent loss of the bag hooks, be sure that the end of the hooks are closed after attaching to the bag straps. This can be done by a light blow with a hammer or by squeezing with pliers.

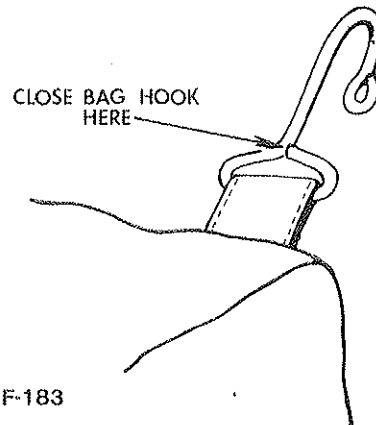

AF-183

4. Heavy concentration of sand and gravel should be avoided. These materials are extremely abrasive, and while the Scavenger will handle moderate amounts of these materials, it is not designed for heavy applications. Because these materials are extremely heavy, only small amounts should be allowed to collect in the bag because large amounts cause poor handling and difficulty in pushing. The Scavenger is capable of picking up empty tin cans and blocks of wood, but it was not intended for this type of service, since tremendous stresses build up as these pieces pass through the impeller. Treat your Scavenger with reasonable care and it will repay you with long trouble-free service.
5. The Scavenger will handle most common kinds of debris found around industrial plants, commercial buildings, homes and farms. Acid contaminated materials, magnesium, dust and other **DANGEROUS DEBRIS** that is considered hazardous should not be handled with the Scavenger unless approved by a regulating authority considered to be an expert in the handling of such hazardous materials.

**DANGER:** Improper use of this equipment may result in serious injury.

6. There is a Hose Kit available as an optional accessory for vacuuming in close areas, such as shrubs, bushes, or flower beds. It can be purchased by ordering: MA-482-C SCAVENGER HOSE KIT.

**OBSERVE SAFETY RULES AT ALL TIMES. DON'T TAKE CHANCES!**

# MAINTENANCE INSTRUCTIONS

**OBSERVE SAFETY RULES AT ALL TIMES. DON'T TAKE CHANCES!**

**WARNING: DO NOT WORK ON SCAVENGER** with engine running or idling. Bring to a **DEAD STOP**. Remove spark plug on engine.

1. For servicing and operating instructions for engine refer to Engine Manufacturers Service Manual. Careful attention to care of air cleaner and crankcase lubrication instructions will insure longer engine life. **KEEP ENGINE CLEAN.**
2. Be sure to keep the oil at the proper level in the engine. Check the oil level each time you fill the fuel tank.
3. Clean the engine air cleaner every 10 hours of operation. (Do so more often under dusty conditions.) If it is punctured, torn, or uncleanable, it should be replaced.
4. Keep the dust bag clean and dry. Clean the bag thoroughly after each use. A dirty bag will reduce the efficiency of the machine.
5. To drain the crankcase oil from the engine, we have provided a siphon pump. To use it, run the engine for a short time to warm the oil and make it flow more easily. Then remove the cap from the filler hole in the engine and insert the plastic tube into the hole. Hold the pump below the bottom of the crankcase and squeeze it several times until oil appears in the tube above the pump, and allow the oil to siphon into a container for disposal. **DISPOSE OF PROPERLY.**
6. The jackshaft and the main drive shaft are mounted on ball bearings and require occasional lubrication.
7. Once a year, remove the wheels and add fresh grease in the teeth of the gears. Also, before each use, oil the wheel axles through the oil holes in the wheel hubs.
8. **DUST BAG CARE**
  - a. Keep the Dust Bag clean at all times.
  - b. To clean the Dust Bag, turn the bag inside out and reattach to the sweeper.
  - c. Start the engine and run at full throttle. Lightly tap the bag to release the dust trapped in the weave.
  - d. When the bag is clean, remove it and turn it right side out again. Reattach to the sweeper and resume sweeping.
  - e. **DO NOT** wash the Dust Bag to clean. Washing will shrink the material, reducing air flow through the bag and seriously reduce vacuum.
9. The efficiency of this unit depends on the breathing capacity of the Dust Bag. Under extremely dusty conditions the bag should be emptied and cleaned frequently. Always empty and clean bag before storing after use. Debris allowed to remain in the bag may cause spontaneous combustion, resulting in an explosion or fire.

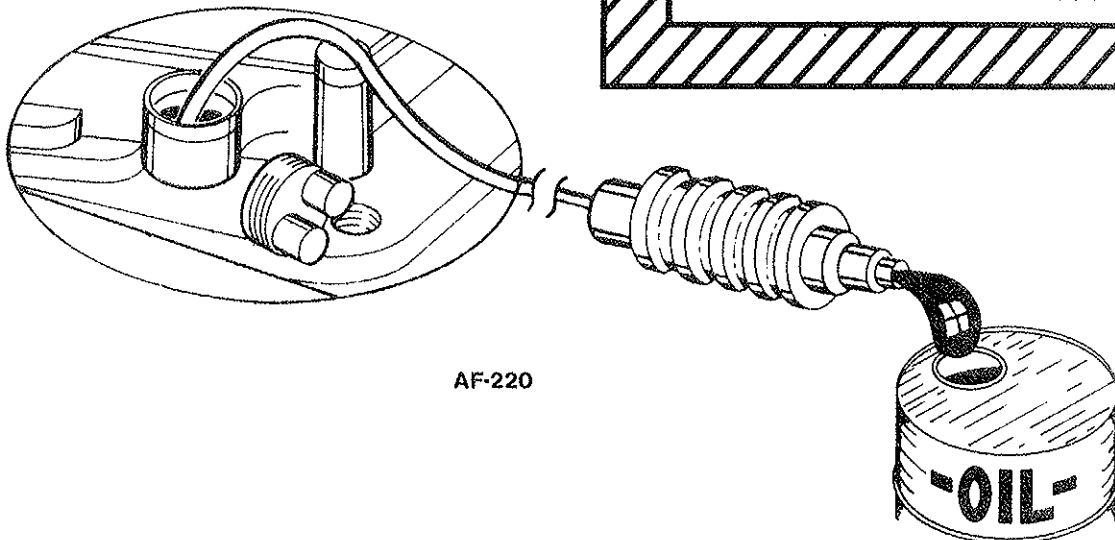

AF-220

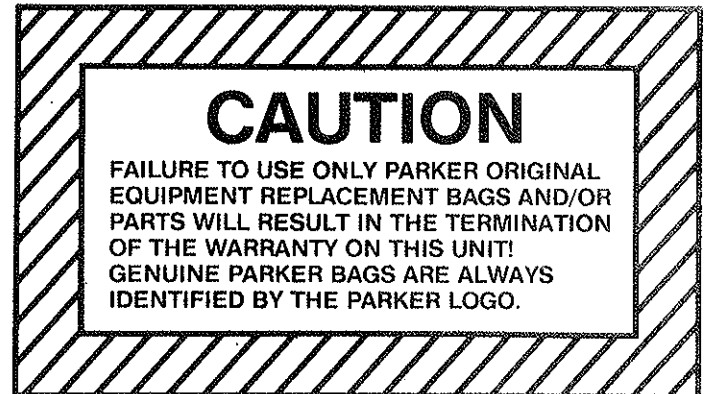

**NOTE: FAILURE TO OBSERVE SAFETY INSTRUCTIONS MAY RESULT IN SERIOUS INJURY.**

HANDLE AND BAG ASSEMBLY

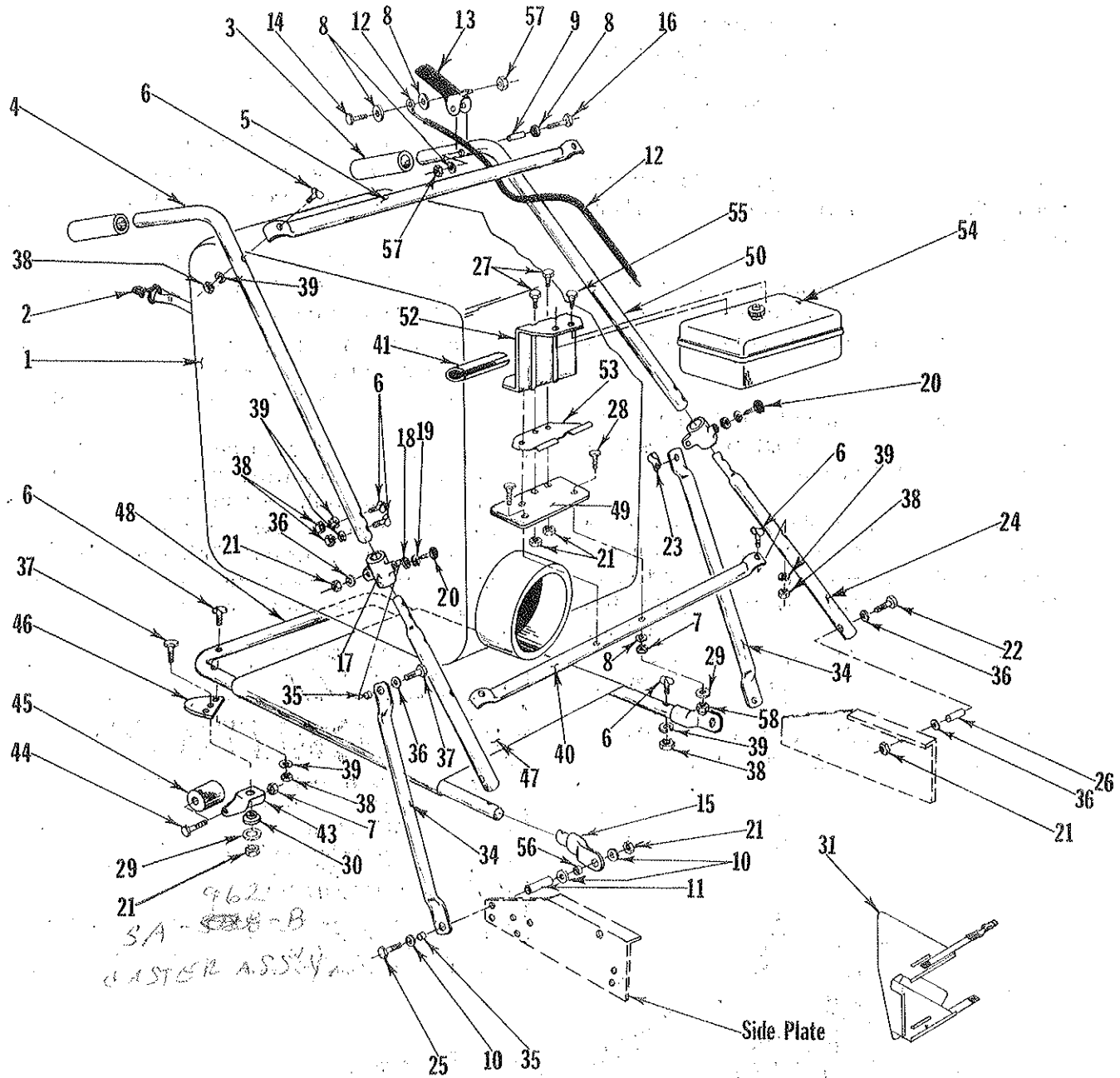

AF-359

HANDLE AND BAG ASSEMBLY

PARTS LIST

Ref. No.	Part No.	Qty. Per Unit	Description	Ref. No.	Part No.	Qty. Per Unit	Description
1	MA-426	1	Dust Bag Assy.	27	65-516-12	3	Bolt, Hex. Hd. 5/16-18x3/4
2	63-304-A	4	Bag Hook	28	65-416-28	2	Bolt, Hex. Hd. 1/4-20x1 3/4
3	80-232-A	2	Handle Grip, Red	29	50-230-A	4	Washer, Special, 5/16
4	80-321-C	1	Upper Handle, R.H.	30	78-130-A ✓	2	Caster Bearing
5	81-157-B	1	Cross Bar, Upper	31	82-194-C	1	Deflector
6	69-416-24	14	Bolt, Contour Hd. 1/4-20x1 1/2	<del>34</del>	<del>80-187-C</del>	2	Truss Brace
7	365-416	7	Nut, Hex. Lock, 1/4-20	35	54-227-A ✓	4	Spacer
8	945-416	6	Flatwasher, 1/4	36	945-516	8	Flatwasher, 5/16
9	<del>80-225-A</del>	1	Spacer <del>80-264-A</del> ✓	37	65-516-16	4	Bolt, Hex. Hd., 5/16-18x1
10	76-36-A	6	Special Washer ✓	38	335-416	14	Nut, Hex. 1/4-20
11	82-31-A	2	Spacer	39	935-416	14	Lockwasher, 1/4
12	80-303-A	1	Cable, Clutch	40	<del>81-156-B</del>	1	Cross Bar, Lower
13	SA-1176-A	1	Clutch Handle Assembly	41	<del>81-200-A</del>	1	Bag Protector
14	65-416-16	1	Bolt, Hex. Hd. 1/4-20x1	43	76-136-B	2	Caster Fork
15	81-116-A	2	Tubing End Cap	44	76-202-A	2	Axle
16	65-416-32	1	Bolt, Hex. Hd., 1/4-20x2	45	81-79-A	2	Roller
17	80-246-B	2	Pivot Bracket	46	82-02-B	2	Caster Plate
18	936-616	2	Lockwasher, Int. Tooth 3/8		<del>SA-982-C</del>		Bag Platform (Complete Assembly) <i>MA-471-D</i>
19	935-616	2	Lockwasher, Spring, 3/8	47	81-117-D	1	Bag Platform
20	80-228-A	2	Knurled Torque Knob	48	<del>81-96-B</del>	1	Frame, Bag Platform <i>MA-471-D</i>
21	365-516	11	Nut, Hex. Lock, 5/16-18	49	<del>81-145-B</del>	1	Tank Bracket
22	65-516-28	2	Bolt, Hex. Hd., 5/16-18x1 3/4	50	<del>80-324-C</del>	1	Upper Handle, L.H.
23	82-54-A	1	Clamp	*52	<del>22-553-153</del>	1	Lower Bracket
24	81-60-B	2	Middle Handle	*53	<del>22-553-154</del>	1	Tank Support
25	65-516-36	2	Bolt, Hex. Hd. 5/16-18x2 1/4	*54	<del>1-A-116-251-26</del>		Gas Tank, 4 Qt.
26	80-238-A	2	Handle Inserts	*55	<del>42-481-60</del>	2	Self Tapping Screw
				56	81-120-A	2	Spacer
				57	364-416	1	Nut, Hex. Lock Thin, 1/4-20
				58	352-416	2	Acorn Nut, 1/4-20

\* Tecumseh Part No.

CHASSIS ASSEMBLY

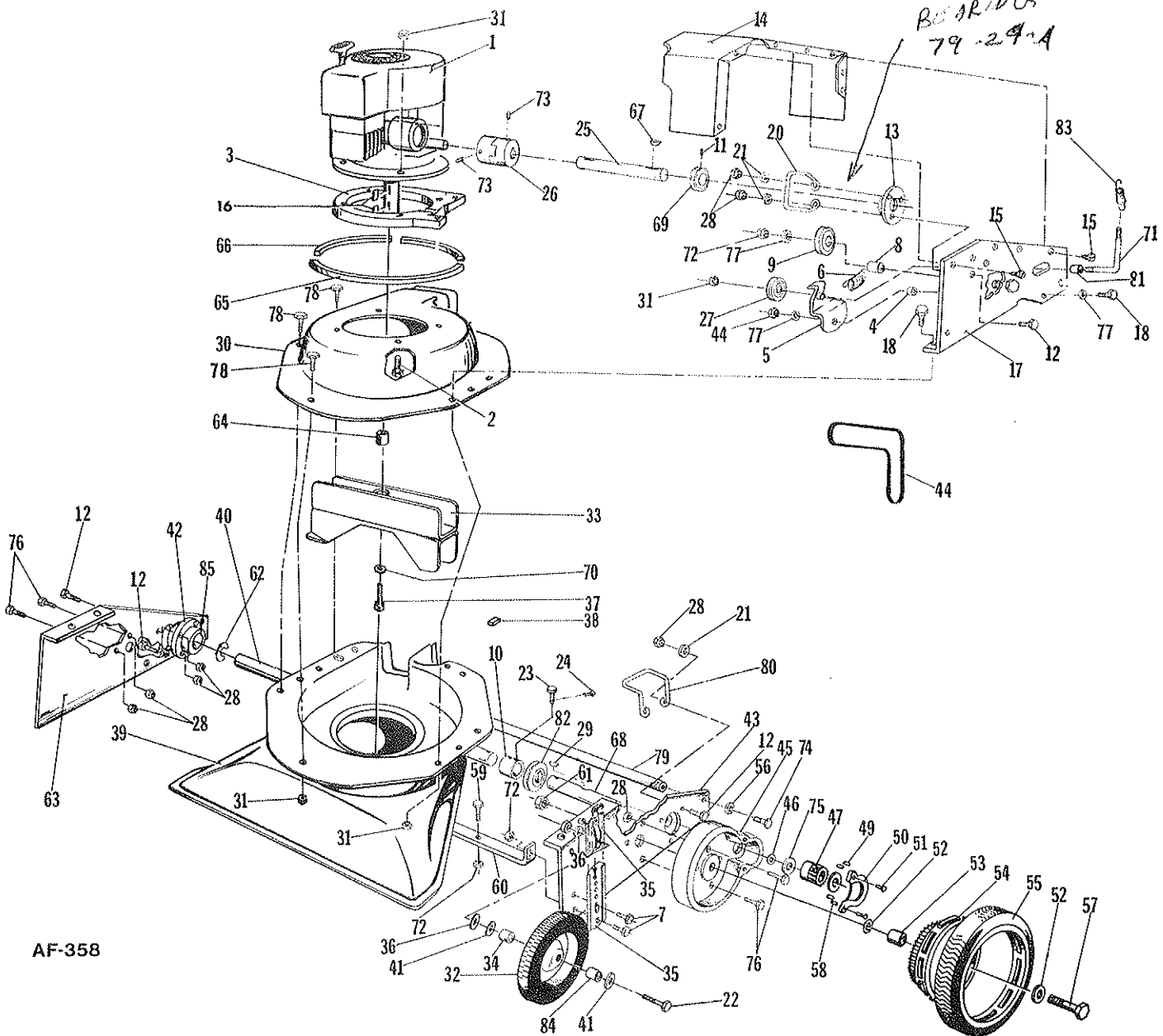

## CHASSIS ASSEMBLY

## PARTS LIST

Ref. No.	Part No.	Qty. Per Unit	Description	Ref. No.	Part No.	Qty. Per Unit	Description
*1	<del>81-127-D1</del>	1	Engine, Tecumseh	44	<del>82-53-A</del>	1	Belt
2	65-516-32	3	Bolt Hex. Hd. 5/16-18x2	45	78-69-C	2	Dust Cover
3	<del>77-112-B-R</del>	1	Adapter Ring	46	79-104-A	2	Retaining Ring
4	<del>80-317-A</del>	1	Spacer	47	<del>74-78-RB</del> *	1	Pinion Left Hand SA-1580-B
5	<del>80-244-A</del>	1	Clutch Arm	48	<del>74-79-LB</del> *	1	Pinion Right Hand "
6	80-193-A	1	Extension Spring	49	<del>74-80-A</del> *	4	Roller Pawl "
7	<del>81-129-B5</del>	4	Bolt Hex. Hd. 3/8-16x1 (Special)	50	80-01-B	2	Pinion Cover
8	<del>80-213-A</del>	1	Spacer	51	61-416-6	4	Bolt Hex. Hd. Thd. Cutting 1/4-20x3/8
9	76-456-A	1	Clutch Pulley	52	58-05-A	4	Special Washer 1/2
10	80-180-A	1	Coupling	53	58-06-A	2	Sleeve
11	<del>584-C-416-4</del>	2	Set Screw 1/4-20x1/4	54	58-14-D-1	2	Wheel
12	65-416-16	5	Bolt Hex. Hd. 1/4-20x1	55	75-88-C	2	Tire
13	SA-863-A	1	Bearing Support	56	935-516	2	Lockwasher 5/16
14	<del>81-132-B-R</del>	1	Guard, Belt	57	<del>60-816-56</del>	2	Bolt Hex. Hd. 1/2-20x3 1/2
15	<del>77-27-A</del>	6	Self Tapping Screw	58	<del>76-37-A</del> *	4	Pawl Spring SA-1580-B
16	74-83-A	1	Engine Key	59	65-616-12	1	Bolt Hex. Hd. 3/8-16x3/4
17	<del>81-162-C-R</del>	1	Upper Side Plate	60	<del>82-11-C-R</del>	1	Side Plate Support
18	65-516-16	7	Bolt Hex. Hd. 5/16-18x1	61	363-816	2	Hex. Lock Nut 1/2-20
20	<del>81-165-A</del>	1	Belt Popper	62	79-104-A	2	Retaining Ring
21	945-416	6	Flatwasher 1/4	63	<del>81-114-A-R</del>	1	Side Plate R.H.
22	65-616-44	2	Bolt Hex. Hd. 3/8-16x2 3/4	64	82-24-A	1	Fan Spacer
23	80-44-A	2	Clevis Pin	65	64-178-A-9.5	1	Rubber Shim
24	380-332-8	2	Cotter Pin	66	64-178-A-6	2	Rubber Shim
25	<del>81-161-A</del>	1	Clutch Shaft R/w 86-84-A	67	<del>79-39-A</del>	1	Hi-Pro Key #504 280-5
26	78-197-A	1	Flexible Coupling Assy.	68	<del>81-126-A</del>	1	Shaft
27	SA-864-A	1	Bearing & Sheave	69	75-55-A	1	Sheave
28	365-416	16	Hex. Lock Nut 1/4-20	70	935-616	1	Lockwasher 3/8
29	<del>63-132-A</del>	1	Hi-Pro Key #606 280-9	71	<del>81-124-A</del>	1	Clutch Control Rod
30	82-04-C	1	Upper Blower Housing	72	365-616	7	Lock Nut 3/8-16
31	365-516	20	Locknut, Hex. 5/16-18	73	<del>564-C-416-6</del>	2	Set Screw Allen Hd. 1/4-20x3/8
32	70-69-A	2	Wheel, Front	74	76-269-A	2	Lag Bolt 5/16-18x1 1/2
33	SA-1035-B	1	Fan Blade Assy.	75	55-161-A	2	Flat Washer
34	79-139-A	2	Spacer	76	65-416-12	10	Hex. Hd. Bolt 1/4-20x3/4
35	81-129-B	2	Wheel Adjuster Assy.	77	945-616	9	Flat Washer 3/8
36	936-616	2	Int. Tooth Lockwasher	78	65-516-12	12	Bolt Hex. Hd. 5/16-18x3/4
37	60-616-40	1	Bolt Hex. Hd. 3/8-24x2 1/2	79	<del>SA-984-A</del>	1	Cross Brace Assy.
38	64-178-A-1	1	Rubber Shim	80	<del>81-167-A</del>	1	Belt Popper
39	<del>84-09-D</del>	1	Housing & Silkscreen	81	51-23-A	1	Spacer
40	<del>81-125-A</del>	1	Drive Shaft	82	80-282-A	1	Sheave
41	945-616	5	Flatwasher 3/8	83	74-167-A	1	Spring
42	78-70-B-M2	2	Bearing Support	84	70-85-A	1	Spacer Bushing
43	<del>81-115-A-R</del>	1	Side Plate L.H.	85	68-60-A	1	Bearing

\*Tecumseh Model No. LAV-501A  
Spec. 62077-E

## HOW TO RE-INSTALL PINIONS

If for some reason you have found it necessary to remove the pinions, you should carefully follow the following instructions.

- (1) To assist you, we suggest using a piece of wood doweling or plastic material  $\frac{5}{8}$ " diameter, 2" long as shown. Each pinion is different as indicated by the part number and must be returned to the correct side of the shaft.

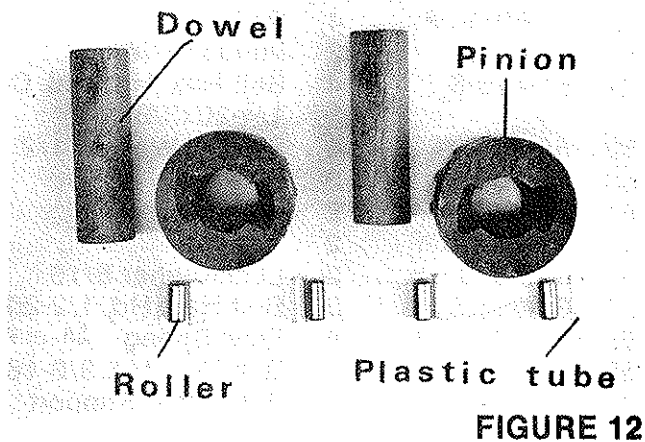

FIGURE 12

- (4) Pinion with part number **74-79 BL** is to be replaced on the **right side** of the shaft. Part Number **74-78BR** is for the **left side**. Line up the pinion (leaving the dowel in place) with the shaft as shown.

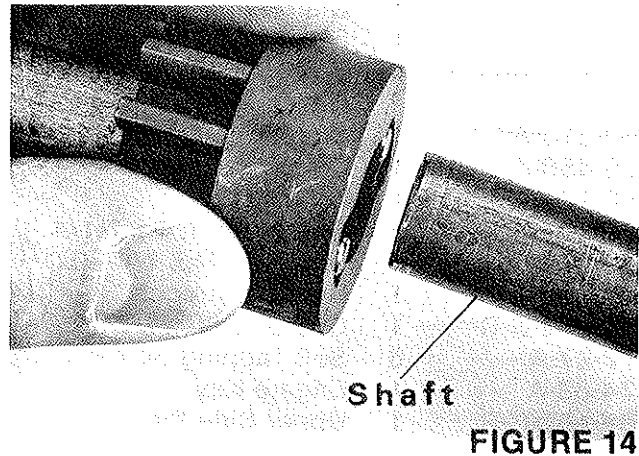

FIGURE 14

- (2) Insert the wooden dowel into the pinion.
- (3) Identify your pinion part number and insert the metal rollers. Place the plastic tubing in the cavity between the metal roller and the wall of the cavity. You may have to force the plastic tubing into this space but it is resilient and is supposed to fit tightly.

- (5) Push the pinion onto the shaft which will force the dowel to back out of the pinion. This will leave the rollers and plastic tubes in their proper position.

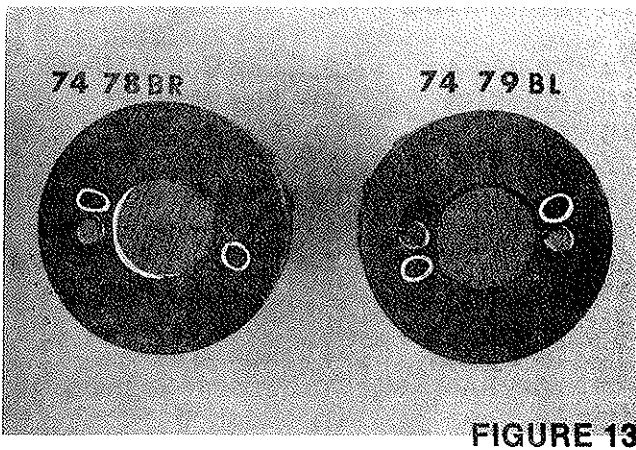

FIGURE 13

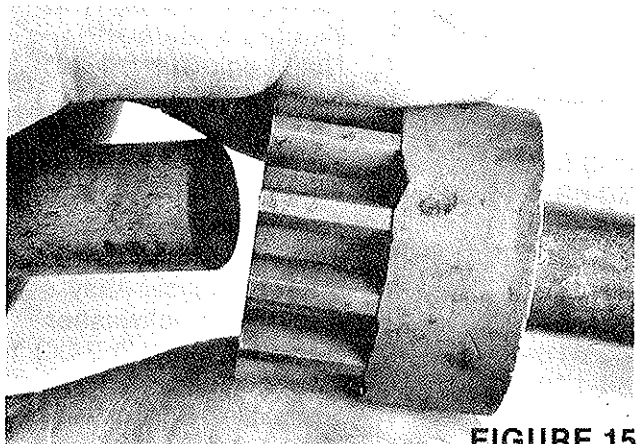

FIGURE 15

- (6) Apply a coating of grease on the outside of the pinion gear teeth and the wheel gear teeth. Replace the wheel.

**Note!** The right and left side are determined from the operators position.