



Electronic Service Manuals

This electronic document is provided as a service to our customers. We do not create the contents of the information contained in this document. Should you have detailed questions pertaining to the information contained in this document, you may contact Michco, or the manufacturer which provided the original information in this electronic deliverable. Michco's only part in this electronic deliverable was the electronic assembly process. By providing this manual on line we are not guaranteeing parts availability.

You may contact Michco through the following methods:

Phone (517) 484-9312 or (800) 331-3339

2011 N. High St. -- Lansing, Michigan -- 48906

Fax: (517) 484-9836

Email: CustServe@Michco.com

Web site: www.Michco.Com

Parts Web site: www.FloorMachineParts.Com

Order Parts on Line at:

www.FloorMachineParts.Com

Directly to Parts & Service:

By Email: **Shop@Michco.com**

By Fax: (517) 702-2041

By Voice: Use numbers above.

Serving the Cleaning Industry Since 1922

Notice: All copyrighted material remains property of original owners, all trademarks are property of respective owners. Manuals are subject to Manufacturer's reproduction limitations. Originals or reproductions were provided by manufacturers through a request. We make no warranty as to the correctness of information provided in this document and you assume all risk. By placing these manuals on line we are not declaring our corporation to be an manufacturer authorized dealer or provider, please check our web site for authorized manufacturers we represent.

OWNER'S GUIDE



SV-8230-I/C-SP SCAVENGER®

SELF-PROPELLED
30" VACUUM SWEEPER

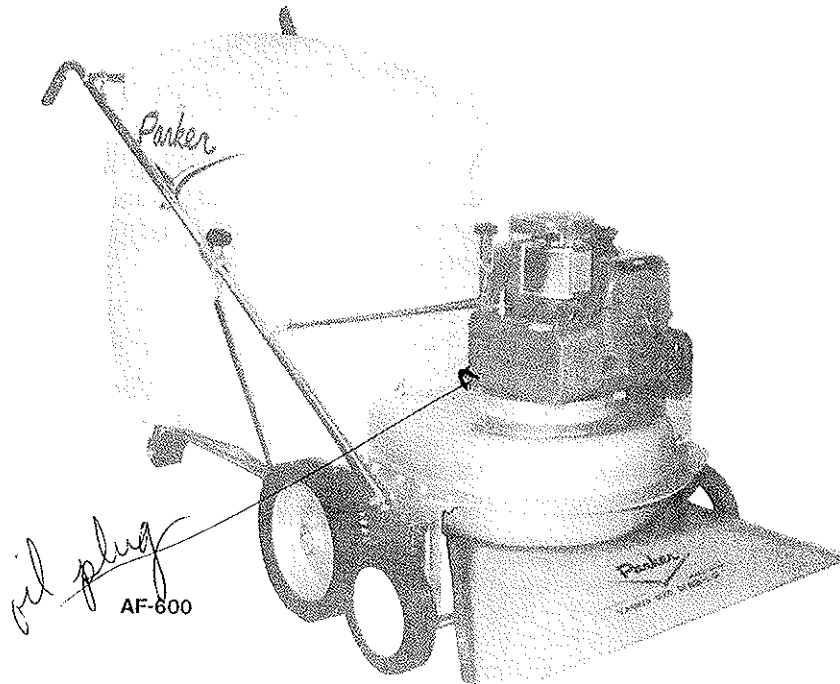

**READ THESE INSTRUCTIONS
BEFORE SETTING UP AND OPERATING MACHINE**

**BE SAFE. PROTECT YOUR FAMILY, YOUR FRIENDS, YOURSELF.
OBSERVE ALL SAFETY INSTRUCTIONS.**

PARKER SWEEPER COMPANY

Box 1728

Springfield, Ohio 45501-1728

Plate No. 1122

TO THE OWNER

These instructions were written to assist you in the assembly and operation of your Scavenger. **READ THE INSTRUCTIONS** thoroughly **BEFORE** attempting to assemble and operate the machine so that you are familiar with the complete procedure and the safety precautions.

RULES FOR SAFE OPERATION



The following safety precautions are suggested to prevent damage to the equipment or injury to the operator or nearby persons.

1. Do not allow anyone to operate the Scavenger without proper instructions.
2. Do not permit children to operate the Scavenger.
3. Do not sweep too close to fire. Ingesting hot ashes will ignite the bag.
4. Stop the engine before reaching into the intake nozzle or discharge chute to dislodge sticks or other debris.
5. Stop the Engine before attempting to make any adjustment or performing any maintenance work on the Scavenger.
6. When working on the engine, always remove the spark plug wire from the engine and attach it to the V shaped clip on the engine head.
7. Do not run the engine in an enclosed area. Exhaust gases contain carbon monoxide, an odorless and deadly poison.
8. Do not fill the fuel tank while the engine is running. Spilling gasoline on a hot engine may cause a fire or an explosion.
9. While machine is running, do not leave it unattended.
10. Before using the machine to pick up debris, police the area to be cleaned first, picking up any large objects such as cans, toys, dog bones and chunks of wood. If these pass through the machine, they could damage the impeller, bend the engine crankshaft or put a hole in the bag.
11. Avoid using the machine in dangerous places where steep slopes or loose debris will endanger the safety of the operator or other people.
12. Keep all nuts, bolts and screws tight to be sure the Scavenger is in safe working condition.
13. Follow the maintenance instructions as outlined in this manual.
14. Do not start or run engine unless bag is properly secured as injury may result.

IMPORTANT

ALWAYS GIVE THE FOLLOWING INFORMATION WHEN ORDERING REPAIR PARTS:

- | | |
|-------------------------------|---------------------------|
| 1. Part Number (Not Ref. No.) | 3. Description of Part |
| 2. Quantity Needed | 4. Model No. of Scavenger |

If unable to obtain parts locally, write down above information and send to:
PARKER SWEEPER CO., BOX 1728, SPRINGFIELD, OHIO 45501

Your unit is right hand (R.H.) or left hand (L.H.) as you stand behind it.

ASSEMBLY INSTRUCTIONS

YOUR SAFETY IS OUR CONCERN. READ ALL SAFETY RULES AND OPERATING INSTRUCTIONS BEFORE ATTEMPTING TO OPERATE THIS EQUIPMENT. FAILURE TO FOLLOW SAFETY RULES AND OPERATING INSTRUCTIONS MAY RESULT IN SERIOUS INJURY.

NOTE: All mounting hardware is on the unit in its proper location.

1. Remove unit from box. Do not discard any inserts or packing until unit is completely assembled.

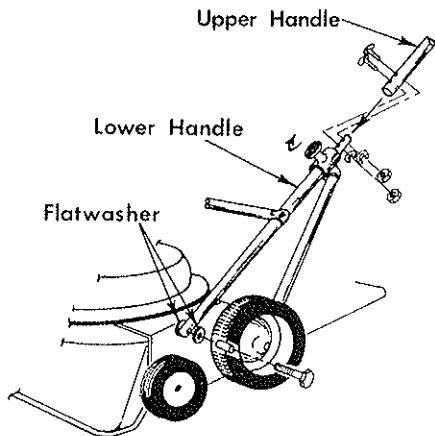

AF-361

2. Lower Handle has to be attached to the side of the unit at side plate in between the two wheels. Remove the Hex. Lock Nut from the bolt on the end of lower handle and insert the bolt into the hole in the side plate with the handle and flatwasher against the side. Add the Hex. Lock Nut and tighten. Repeat for opposite side.
3. To attach the upper handles to the lower handles, remove contour head bolts, lockwashers and hex nuts. Slide the ends of the upper handles down over the ends of the lower handles. Re-insert the contour head bolts into the handles. Add lockwasher and screw on hex nut.

NOTE: Be sure torque knobs are in holes and tightened securely.

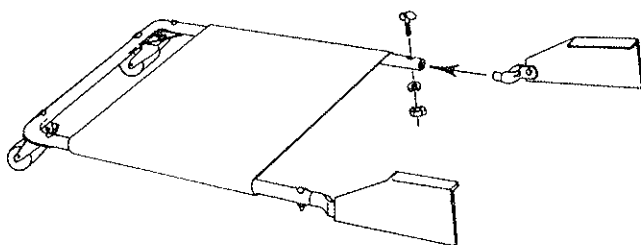

AF-362

4. Remove the contour Hd. bolt, lockwasher and hex. nut from the open end of the bag platform on each side. Insert the ends of the bag platform onto the ends of the end caps as shown. Insert the contour bolt through tubing and end cap and secure with lockwasher and hex. nut. Your bag platform was made to support the bag and keep it from dragging the floor, do not use it to carry any other object because damage may occur.

5. Attach the clutch cable to the spring on the lower portion of the machine. Cable must go through clamp at pivot bracket.

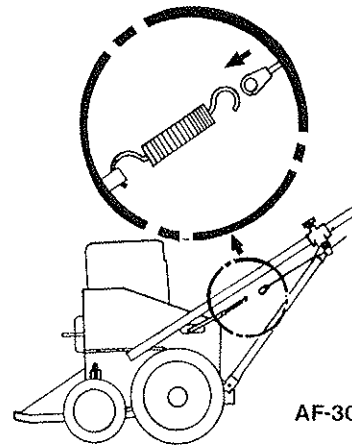

AF-303

6. Slide the bag deflector over the discharge chute, as shown. Engage the strap into the buckle and tighten to retain bag deflector. Slip the neck of the bag over the bag deflector and discharge housing until the tightening strap passes over the bag deflector to rest on the discharge housing. Pull the strap tight to secure the bag to the unit.

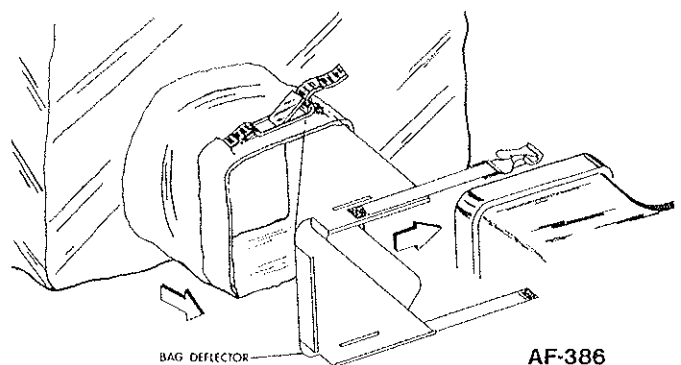

NOTE: Unit can be used as a blower by removing bag and reversing deflector.

OBSERVE SAFETY RULES AT ALL TIMES. DON'T TAKE CHANCES!

OPERATING INSTRUCTIONS

READ SAFETY & OPERATING INSTRUCTIONS BEFORE OPERATING EQUIPMENT

CAUTION: The engine contains NO OIL. Read the engine instruction manual carefully before operating. Be sure you know how to start and stop engine.

1. Before starting the engine read and understand the following:
 - a. Be sure your engine crankcase is filled with the proper type and amount of oil.
 - b. Lubricate the wheel bearings and wheel axle on the caster once a week if used daily. A few drops of oil applied to the throttle control cable and wire where applicable, will keep it operating smoothly.

NOTE: Refer to engine operating instructions for proper lubrication of the engine.

2. HEIGHT ADJUSTMENT:

With the new side 5 position wheel adjustment it has been made possible to sweep up against the curbs, buildings, etc., from both sides or front. The height of the intake nozzle can be adjusted by the two smaller side wheels. By pulling the spring lever away from the bracket you will be able to move the tire up or down. Be sure the pin on the lever is properly seated in one of the 5 holes in the bracket. Move the tire up or down the same amount on both sides. **NOTE:** Be sure wheels are locked into position and level.

TO ADJUST NOZZLE
PULL OUT AND SLIDE
FRONT TIRE UP OR DOWN

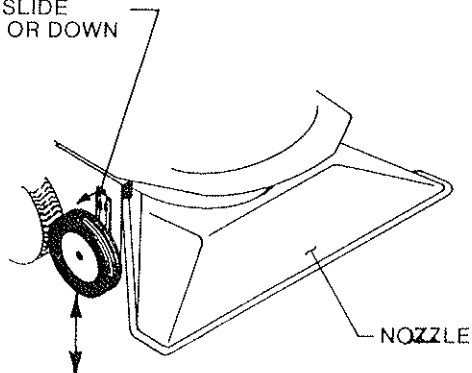

3. To prevent loss of the bag hooks, be sure that the end of the hooks are closed after attaching to the bag straps. This can be done by a light blow with a hammer or by squeezing with pliers.

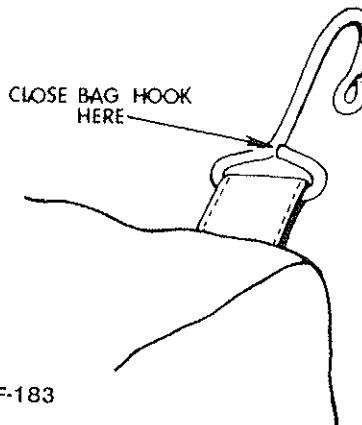

4. Heavy concentration of sand and gravel should be avoided. These materials are extremely abrasive, and while the Scavenger will handle moderate amounts of these materials, it is not designed for heavy applications. Because these materials are extremely heavy, only small amounts should be allowed to collect in the bag because large amounts cause poor handling and difficulty in pushing. The Scavenger is capable of picking up empty tin cans and blocks of wood, but it was not intended for this type of service, since tremendous stresses build up as these pieces pass through the impeller. Treat your Scavenger with reasonable care and it will repay you with long trouble-free service.
5. The Scavenger will handle most common kinds of debris found around industrial plants, commercial buildings, homes and farms. Acid contaminated materials, magnesium, dust and other DANGEROUS DEBRIS that is considered hazardous should not be handled with the Scavenger unless approved by a regulating authority considered to be an expert in the handling of such hazardous materials.

DANGER: Improper use of this equipment may result in serious injury.

6. There is a Hose Kit available as an optional accessory for vacuuming in close areas, such as shrubs, bushes, or flower beds. It can be purchased by ordering: MA-482-C SCAVENGER HOSE KIT.

OBSERVE SAFETY RULES AT ALL TIMES. DON'T TAKE CHANCES!

MAINTENANCE INSTRUCTIONS

OBSERVE SAFETY RULES AT ALL TIMES. DON'T TAKE CHANCES!

WARNING: DO NOT WORK ON SCAVENGER with engine running or idling. Bring to a DEAD STOP. Remove spark plug on engine.

1. For servicing and operating instructions for engine refer to Engine Manufacturers Service Manual. Careful attention to care of air cleaner and crankcase lubrication instructions will insure longer engine life. **KEEP ENGINE CLEAN.**
2. Be sure to keep the oil at the proper level in the engine. Check the oil level each time you fill the fuel tank.
3. Clean the engine air cleaner every 10 hours of operation. (Do so more often under dusty conditions.) If it is punctured, torn, or uncleanable, it should be replaced.
4. Keep the dust bag clean and dry. Clean the bag thoroughly after each use. A dirty bag will reduce the efficiency of the machine.
5. To drain the crankcase oil from the engine, we have provided a siphon pump. To use it, run the engine for a short time to warm the oil and make it flow more easily. Then remove the cap from the filler hole in the engine and insert the plastic tube into the hole. Hold the pump below the bottom of the crankcase and squeeze it several times until oil appears in the tube above the pump, and allow the oil to siphon into a container for disposal. **DISPOSE OF PROPERLY.**
6. The jackshaft and the main drive shaft are mounted on ball bearings and require occasional lubrication.

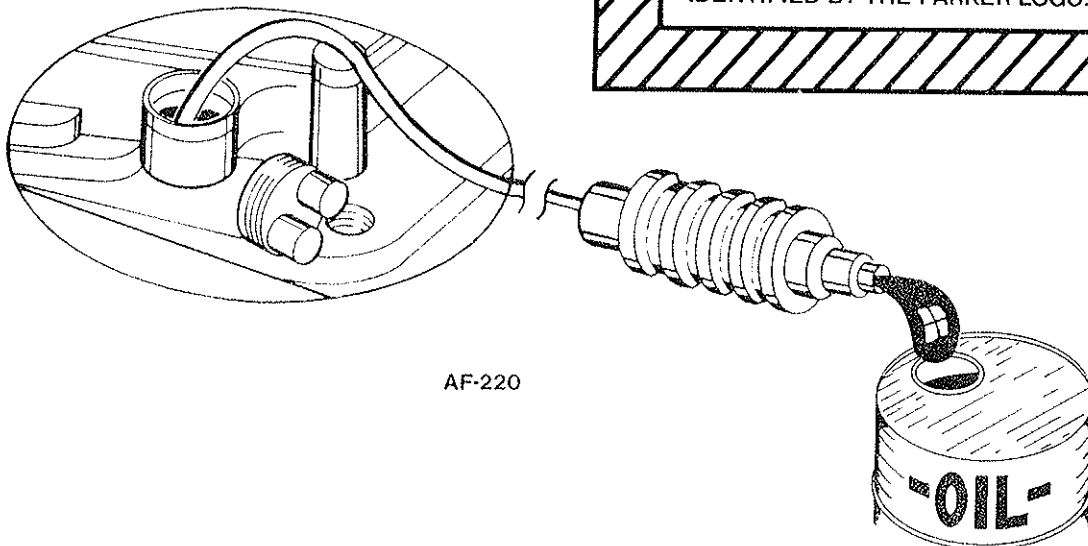

AF-220

7. Once a year, remove the wheels and add fresh grease in the teeth of the gears. Also, before each use, add grease to the wheel axles through the grease fittings in the wheel hubs.
8. **DUST BAG CARE**
 - a. Keep the Dust Bag clean at all times.
 - b. To clean the Dust Bag, turn the bag inside out and reattach to the sweeper.
 - c. Start the engine and run at full throttle. Lightly tap the bag to release the dust trapped in the weave.
 - d. When the bag is clean remove it and turn it right side out again. Reattach to the sweeper and resume sweeping.
 - e. **DO NOT** wash the Dust Bag to clean. Washing will shrink the material, reducing air flow through the bag and seriously reduce vacuum.
9. The efficiency of this unit depends on the breathing capacity of the Dust Bag. Under extremely dusty conditions the bag should be emptied and cleaned frequently. Always empty and clean bag before storing after use. Debris allowed to remain in the bag may cause spontaneous combustion, resulting in an explosion or fire.

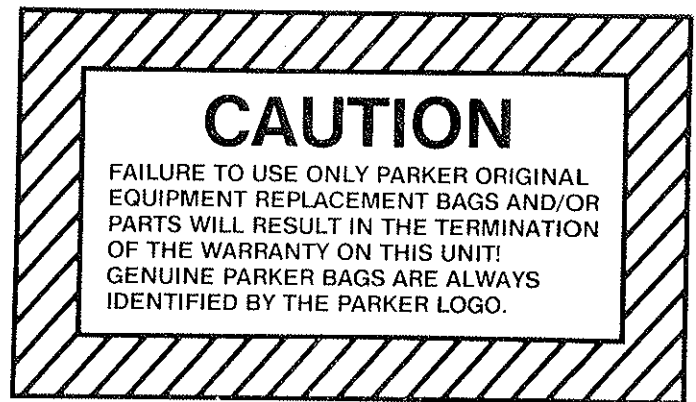

NOTE: FAILURE TO OBSERVE SAFETY INSTRUCTIONS MAY RESULT IN SERIOUS INJURY.

HANDLE AND BAG ASSEMBLY

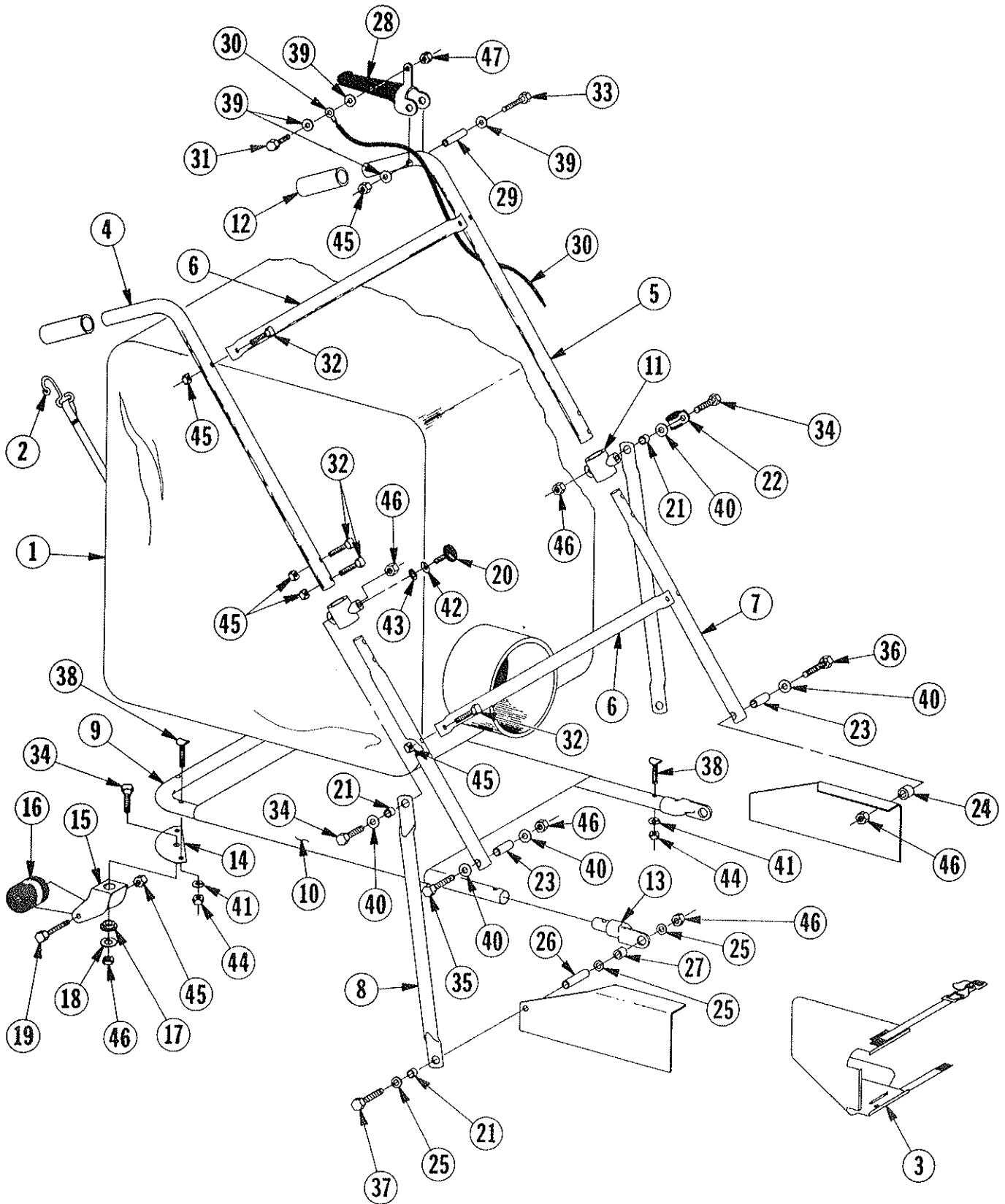

AF-598

HANDLE AND BAG ASSEMBLY

Ref. No.	Part No.	Qty. Per Unit	Description	Ref. No.	Part No.	Qty. Per Unit	Description
1	MA-426	1	Dust Bag Assy.	25	76-36-A	6	Special Washer
*2	63-304-A	4	Bag Hook	26	82-31-A	2	Spacer
3	82-194-C	1	Deflector	27	81-120-A	2	Spacer
4	80-321-C	1	Upper Handle, R.H.	28	SA-1176-A	1	Clutch Handle Assy.
5	80-324-C	1	Upper Handle, L.H.	29	80-225-A	1	Spacer <i>80-264-A</i>
6	81-157-B	2	Cross Bar, Upper	30	80-303-A	1	Cable, Clutch
7	81-60-B	2	Middle Handle	31	65-416-16	1	Bolt, Hex Hd. 1/4-20 x 1
8	80-187-C	2	Truss Brace	32	65-416-24	8	Bolt, Hex Hd. 1/4-20 x 1 1/2
9	81-96-B	1	Frame, Bag Platform	33	65-416-32	1	Bolt, Hex Hd. 1/4-20 x 2
10	81-117-C	1	Bag Platform	34	65-516-16	4	Bolt, Hex Hd. 5/16-18 x 1
11	80-246-B	2	Pivot Bracket	35	65-516-28	1	Bolt, Hex Hd. 5/16-18 x 1 3/4
12	80-232-A	2	Handle Grip, Red	36	65-516-32	1	Bolt, Hex Hd. 5/16-18 x 2
13	81-116-A	2	Tubing End Cap	37	65-516-36	2	Bolt, Hex Hd. 5/16-18 x 2 1/4
14	82-02-B	2	Caster Plate	38	69-416-24	6	Bolt, Contour Hd. 1/4-20 x 1 1/2
15	76-136-B	2	Caster Fork				
16	81-79-A	2	Roller	39	945-416	4	Flatwasher, Plain 1/4
17	78-130-A	2	Caster Bearing	40	945-516	5	Flatwasher, Plain 5/16
18	50-230-A	2	Special Washer	41	935-416	6	Lockwasher, Spring 1/4
19	76-202-A	2	Axle	42	935-616	2	Lockwasher, Spring 3/8
20	80-228-A	2	Knurled Torque Knob	43	936-616	2	Lockwasher, Int. Tooth 3/8
21	54-227-A	4	Spacer	44	335-416	6	Nut, Plain Hex 1/4-20
22	82-54-A	1	Clamp	45	365-416	11	Nut, Hex Lock 1/4-20
23	80-238-A	2	Handle Inserts	46	365-516	8	Nut, Hex Lock 5/16-18
24	82-135-A	1	Spacer	47	364-416	1	Nut, Thin Hex Lock 1/4-20

*Item 2, Bag Hook, supplied with item 1 Dust Bag but can be purchased separately.

CHASSIS ASSEMBLY

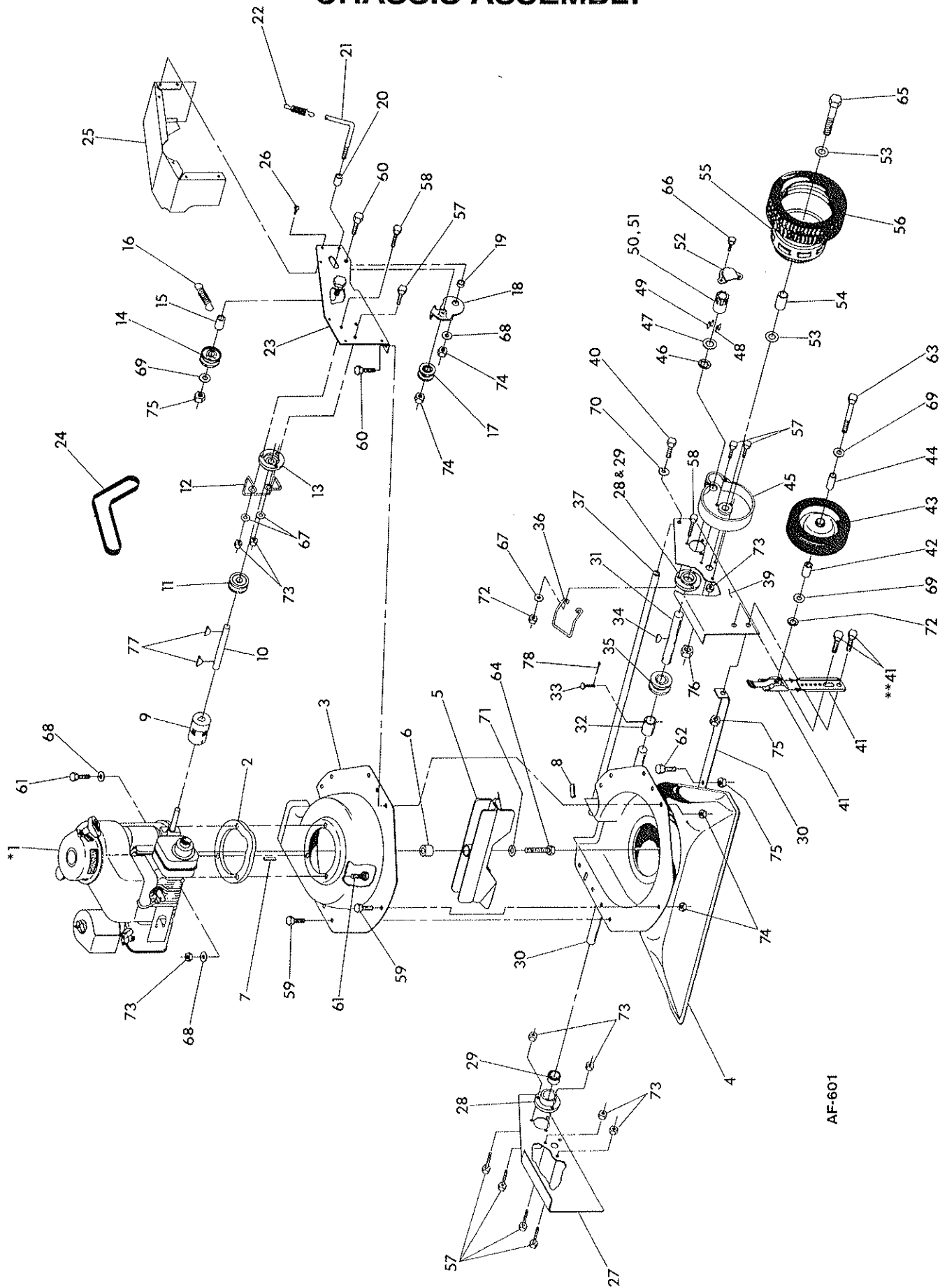

AF-601

CHASSIS ASSEMBLY

Ref. No.	Part No.	Description	Qty. Per Unit	Ref. No.	Part No.	Description	Qty. Per Unit
1	86-05-D	Engine, 5HP B&S-I/C	1	39	81-115-A	Side Plate L.H.	1
2	86-13-C	Adapter Ring	1	40	76-269-A	Lag Bolt	2
3	82-04-C	Upper Blower Housing	1	41	81-129-B	5/16-18 x 1 1/2 Wheel Adjuster Assembly	2
4	86-06-D	Housing & Silkscreen	1	**41	81-129-B-5	Bolt, Hex Hd. 3/8-16 x 1 (Special)	4
5	SA-1392-C	Fan Blade Assy.	1	42	79-139-A	Spacer	2
6	82-24-A	Fan Spacer	1	43	70-69-A	Wheel, Front	2
7	63-130-A	Engine Key	1	44	70-85-A	Spacer Bushing	2
8	64-178-A-1	Rubber Shim	1	45	78-69-C	Dust Cover	2
9	78-197-A	Flexible Coupling Assembly	1	46	79-104-A	Retaining Ring	2
10	81-161-A	Clutch Shaft	1	47	50-33-A	Special Washer	2
11	75-55-A	Sheave	1	48	74-80-A	Roller Pawl	4
12	81-165-A	Belt Popper	1	49	76-37-A	Pawl Spring	4
13	SA-863-A	Bearing Support	1	50	74-79-LB	Pinion Left Hand	1
14	76-456-A	Clutch Pulley	1	51	74-78-RB	Pinion Right Hand (Not Shown)	1
15	80-213-A	Spacer	1	52	80-01-B	Pinion Cover	2
16	80-193-A	Extension Spring	1	53	58-05-A	Special Washer	4
17	SA-864-A	Bearing & Sheave	1	54	58-06-A	Sleeve	2
18	80-244-A	Clutch Arm	1	55	58-14-D-1	Wheel	2
19	80-317-A	Spacer	1	56	75-88-C	Tire	2
20	51-23-A	Spacer	1	57	65-416-12	Bolt, Hex Hd. 1/4-20 x 3/4	10
21	81-124-A	Clutch Control Rod	1	58	65-416-16	Bolt, Hex Hd. 1/4-20 x 1	5
22	74-167-A	Spring	1	59	65-516-12	Bolt, Hex Hd. 5/16-18 x 3/4	8
23	86-16-C	Upper Side Plate	1	60	65-516-16	Bolt, Hex Hd. 5/16-18 x 1	5
24	86-14-A	Belt	1	61	65-516-32	Bolt, Hex Hd. 5/16-18 x 2	3
25	81-132-B	Guard, Belt	1	62	65-616-12	Bolt, Hex Hd. 3/8-16 x 3/4	1
26	77-27-A	Self Tapping Screw	6	63	65-616-44	Bolt, Hex Hd. 3/8-16 x 2 3/4	2
27	81-114-A	Side Plate R.H.	1	64	60-616-40	Bolt, Hex Hd. 3/8-24 x 2 1/2	1
28	78-70-B-M2	Bearing Support	2				
29	68-60-A	Bearing	2				
30	81-125-A	Drive Shaft	1				
31	81-126-A	Drive Shaft	1				
32	80-180-A	Coupling	1				
33	80-44-A	Clevis Pin	2				
34	63-132-A	Hi-Pro Key #606 280	1				
35	80-282-A	Sheave	1				
36	81-167-A	Belt Popper	1				
37	SA-984-A	Cross Brace Assy.	1				
38	82-11-C	Side Plate Support	1				

*Briggs & Stratton Model No. 132982
Type 0163 Trim 01

**Items 41, 81-129-B-5 Special Bolts are supplied with item 41 Wheel Adjuster Assembly but can be purchased separately.

HOW TO RE-INSTALL PINIONS

If for some reason you have found it necessary to remove the pinions, you should carefully follow the following instructions.

- (1) To assist you, we suggest using a piece of wood doweling or plastic material $\frac{5}{8}$ " diameter, 2" long as shown. Each pinion is different as indicated by the part number and must be returned to the correct side of the shaft.

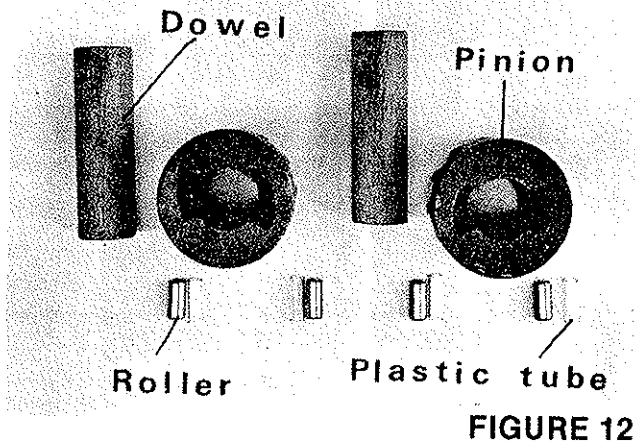

- (4) Pinion with part number **74-79 BL** is to be replaced on the **right side** of the shaft. Part Number **74-78BR** is for the **left side**. Line up the pinion (leaving the dowel in place) with the shaft as shown.

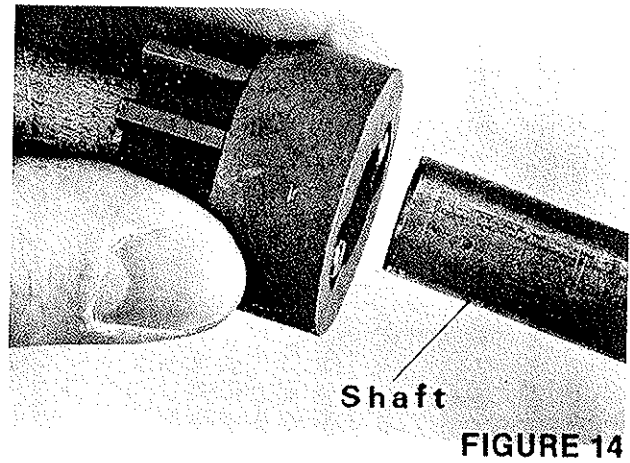

- (2) Insert the wooden dowel into the pinion.
- (3) Identify your pinion part number and insert the metal rollers. Place the plastic tubing in the cavity between the metal roller and the wall of the cavity. You may have to force the plastic tubing into this space but it is resilient and is supposed to fit tightly.

- (5) Push the pinion onto the shaft which will force the dowel to back out of the pinion. This will leave the rollers and plastic tubes in their proper position.

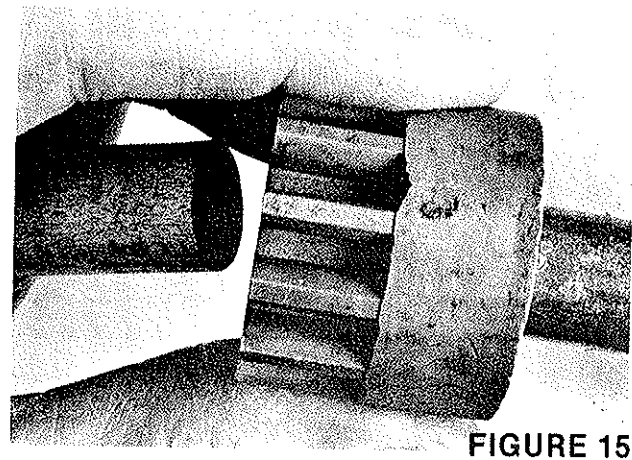
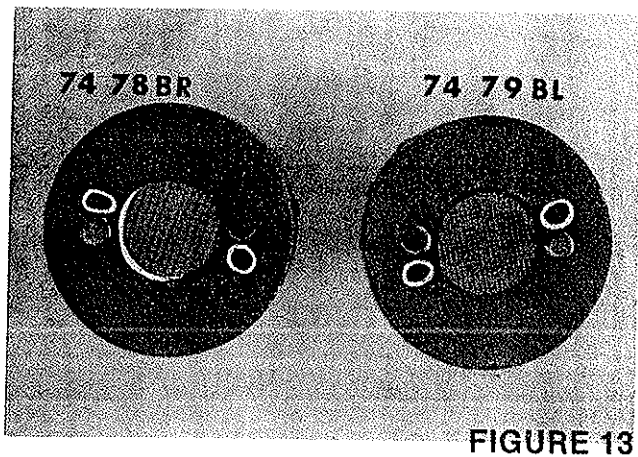

- (6) Apply a coating of grease on the outside of the pinion gear teeth and the wheel gear teeth. Replace the wheel.

Note! The right and left side are determined from the operators position.

OWNERS GUIDE

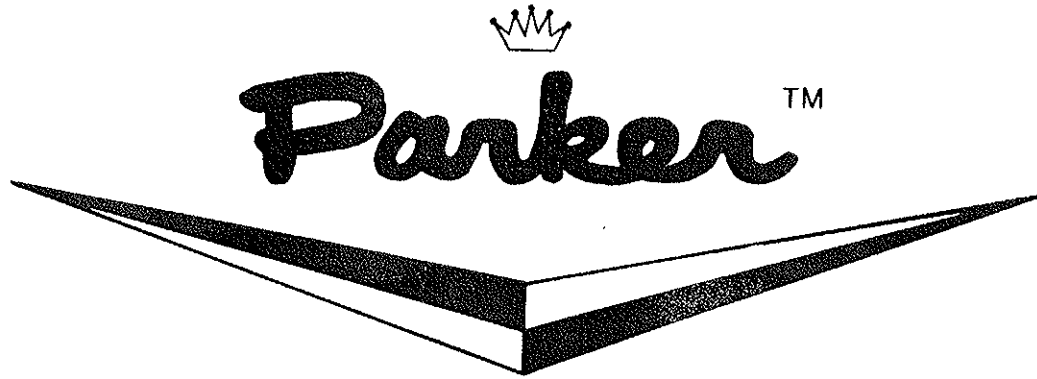

SV-8230-I/C SCAVENGER[®]

30" VACUUM SWEEPER



AF-473

**READ THESE INSTRUCTIONS
BEFORE SETTING UP AND OPERATING MACHINE**

PARKER SWEEPER COMPANY Box 1728 Springfield, Ohio 45501-1728

Plate No. 964

TO THE OWNER

These instructions were written to assist you in the assembly and operation of your Scavenger. **READ THE INSTRUCTIONS** thoroughly **BEFORE** attempting to assemble and operate the machine so that you are familiar with the complete procedure and the safety precautions.

RULES FOR SAFE OPERATION



The following safety precautions are suggested to prevent damage to the equipment or injury to the operator or nearby persons.

1. Do not allow anyone to operate the Scavenger without proper instructions.
2. Do not permit children to operate the Scavenger.
3. Do not sweep too close to fire. Ingesting hot ashes will ignite the bag.
4. Stop the engine before reaching into the intake nozzle or discharge chute to dislodge sticks or other debris.
5. Stop the Engine before attempting to make any adjustment or performing any maintenance work on the Scavenger.
6. When working on the engine, always remove the spark plug wire from the engine and attach it to the V shaped clip on the engine head.
7. Do not run the engine in an enclosed area. Exhaust gases contain carbon monoxide, an odorless and deadly poison.
8. Do not fill the fuel tank while the engine is running. Spilling gasoline on a hot engine may cause a fire or an explosion.
9. While machine is running, do not leave it unattended.
10. Before using the machine to pick up debris, police the area to be cleaned first, picking up any large objects such as cans, toys, dog bones and chunks of wood. If these pass through the machine, they could damage the impeller, bend the engine crankshaft or put a hole in the bag.
11. Avoid using the machine in dangerous places where steep slopes or loose debris will endanger the safety of the operator or other people.
12. Keep all nuts, bolts and screws tight to be sure the Scavenger is in safe working condition.
13. Follow the maintenance instructions as outlined in this manual.
14. Do not start or run engine unless bag is properly secured as injury may result.

IMPORTANT

ALWAYS GIVE THE FOLLOWING INFORMATION WHEN ORDERING REPAIR PARTS:

- | | |
|-------------------------------|---------------------------|
| 1. Part Number (Not Ref. No.) | 3. Description of Part |
| 2. Quantity Needed | 4. Model No. of Scavenger |

If unable to obtain parts locally, write down above information and send to:
PARKER SWEEPER CO., BOX 1728, SPRINGFIELD, OHIO 45501

Your unit is right hand (R.H.) or left hand (L.H.) as you stand behind it.

ASSEMBLY INSTRUCTION

With the new side 5 position wheel adjustment it has been made possible to sweep up against the curbs, buildings etc. from both sides or front. The height of the intake nozzle can be adjusted by the two smaller side wheels. By pulling the spring lever away from the bracket you will be able to move the tire up or down. Be sure the pin on the lever is properly seated in one of the 5 holes in the bracket. Move the tire up or down the same amount on both sides. NOTE: Be sure wheels are locked into position and level.

TO ADJUST NOZZLE
PULL OUT AND SLIDE
FRONT TIRE UP OR DOWN

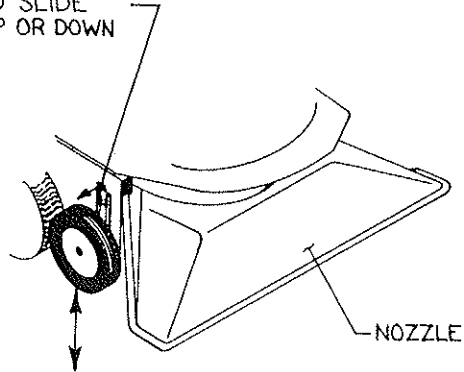

AF-360

Remove the contour Hd. bolt, lockwasher and hex. nut from the open end of the bag platform on each side. Insert the ends of the bag platform onto the ends of the end caps as shown. Insert the contour bolt thru tubing and end cap and secure with lockwasher and hex. nut. Your bag platform was made to support the bag and keep it from dragging the floor, do not use it to carry any other object because damage may occur.

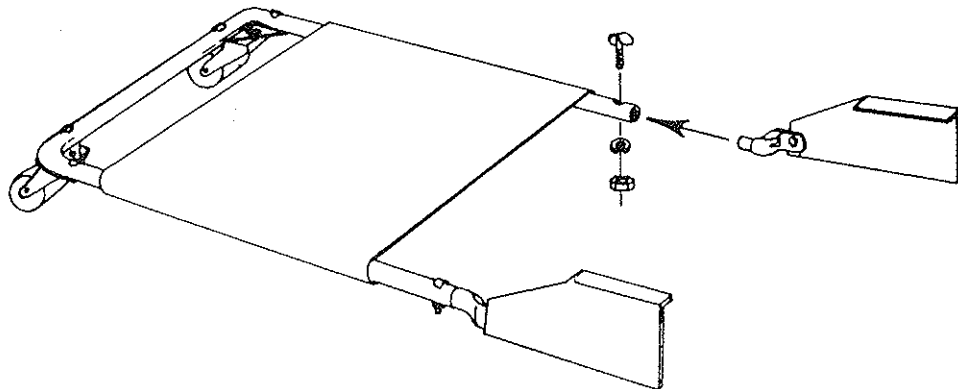

AF-362

ASSEMBLY INSTRUCTIONS

1. Lower Handle has to be attached to the side of the unit at side plate in between the two wheels.
2. Remove the Hex. Lock Nut from the bolt on the end of lower handle and insert the bolt into the hole in the side plate with the handle and flat-washer against the side.
3. Add the Hex. Lock Nut back and tighten. Repeat for opposite side.
4. To attach the upper handles to the lower handles, remove contour head bolts, lockwashers and hex nuts.
5. Slide the ends of the upper handles down over the ends of the lower handles.
6. Re-insert the contour head bolts into the handles and screw on the lockwasher and hex nut.
7. NOTE: Be sure torque knobs are tightened securely.

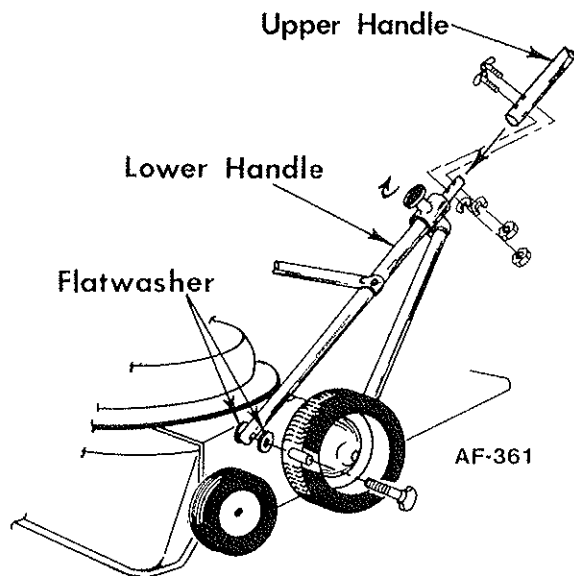

DUST BAG CARE

1. Keep the Dust Bag clean at all times.
2. To clean the Dust Bag, turn the bag inside out and reattach to the sweeper.
3. Start the engine and run at full throttle. Lightly tap the bag to release the dust trapped in the weave.
4. When the bag is clean, remove it and turn it right side out again. Reattach to the sweeper and resume sweeping.
5. DO NOT wash the Dust Bag to clean. Washing will shrink the material, reducing air flow through the bag and seriously reduce vacuum.

The efficiency of this unit depends on the breathing capacity of the Dust Bag. Under extremely dusty conditions the bag should be emptied and cleaned frequently. Always empty and clean bag before storing after use. Debris allowed to remain in the bag may cause spontaneous combustion, resulting in an explosion or fire.

ATTACHING DUST BAG

1. Attach the dust bag to the sweeper by placing the loops over the handles.
2. Bag hooks are not necessary on new manual Scavengers with Bag Platform. The Bag Platform will help support the bag. If your unit is used for any reason without the Bag Platform, then bag hooks should be used on the lower straps and lower crossbar.
3. To prevent loss of the bag hooks, be sure that the end of the hooks are closed after attaching to the bag straps. This can be done by a light blow with a hammer or by squeezing the pliers.

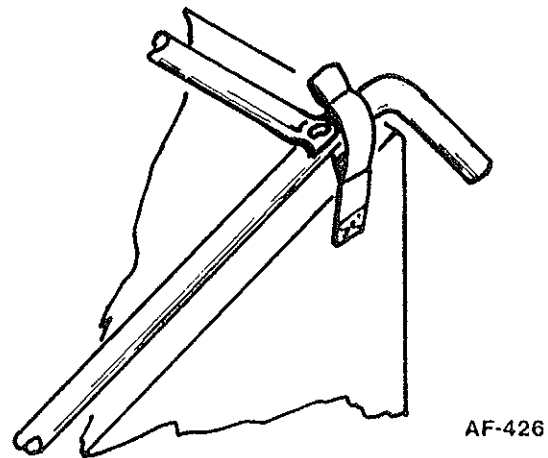

Slide the bag deflector over the discharge chute, as shown. Engage the strap into the buckle and tighten to retain bag deflector. Slip the neck of the bag over the bag deflector and discharge housing until the tightening strap passes over the bag deflector to rest on the discharge housing. Pull the strap tight to secure the bag to the unit.

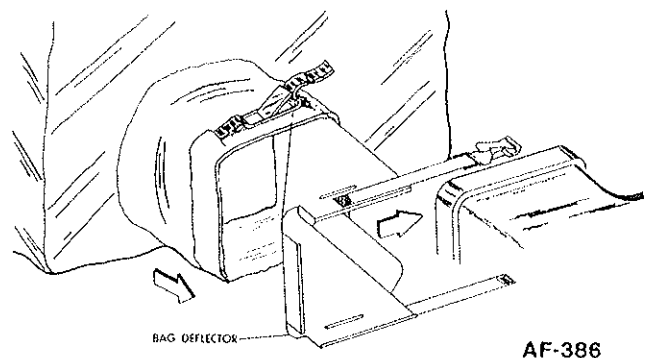

NOTE: Unit can be used as a blower by removing bag and reversing deflector.

OPERATING INSTRUCTIONS

IMPORTANT – Read the engine instruction manual and add the proper gasoline and oil to the engine.

- To start the engine, place the throttle control lever on the engine in the start position.
- To stop the engine, move the throttle control lever to stop position. The engine has a built-in stop switch.
- For maximum vacuum, operate machine at full throttle.
- To adjust the nozzle height above the ground, raise or lower the side wheels to the required position. For best results on a hard paved surface the nozzle should be about 1/2" above surface. For picking up lawn debris, the nozzle should be about 1 1/4" above the top of the grass.

MAINTENANCE INSTRUCTIONS

1. Be sure to keep the oil at the proper level in the engine. Check the oil level each time you fill the fuel tank.
2. Clean the engine air cleaner every 10 hours of operation. (Do so more often under dusty conditions.) If it is punctured, torn, or uncleanable, it should be replaced.
3. Keep the dust bag clean and dry. Clean the bag thoroughly after each use. A dirty bag will reduce the efficiency of the machine.
4. To drain the crankcase oil from the engine, we have provided a siphon pump. To use it, run the engine for a short time to warm the oil and make it flow more easily. Then remove the cap from the filler hole in the engine and insert the plastic tube into the hole. Hold the pump below the bottom of the crankcase and squeeze it several times until oil appears in the tube above the pump, then disconnect the pump from the tube and allow the oil to siphon into a container for disposal. **DISPOSE OF PROPERLY.**
5. Once a year, remove the wheels and add fresh grease in the teeth of the gears. Also, before each use oil the wheel axles through the oil holes in the wheel hubs.

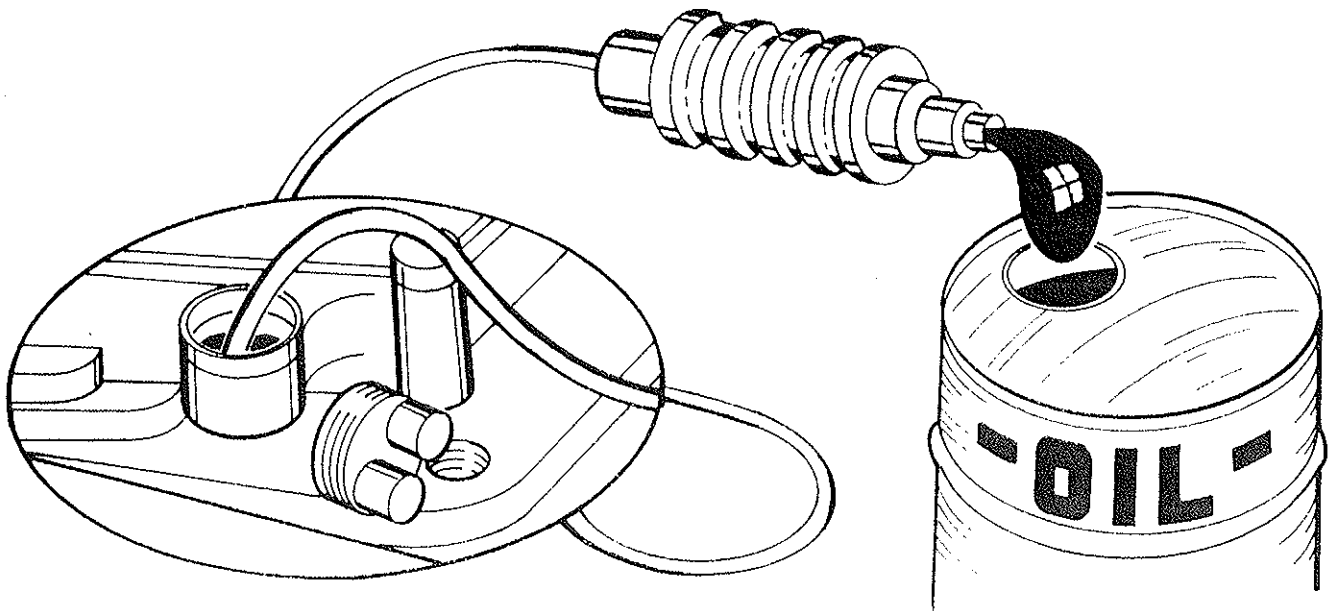

AF-220

HANDLE AND BAG ASSEMBLY

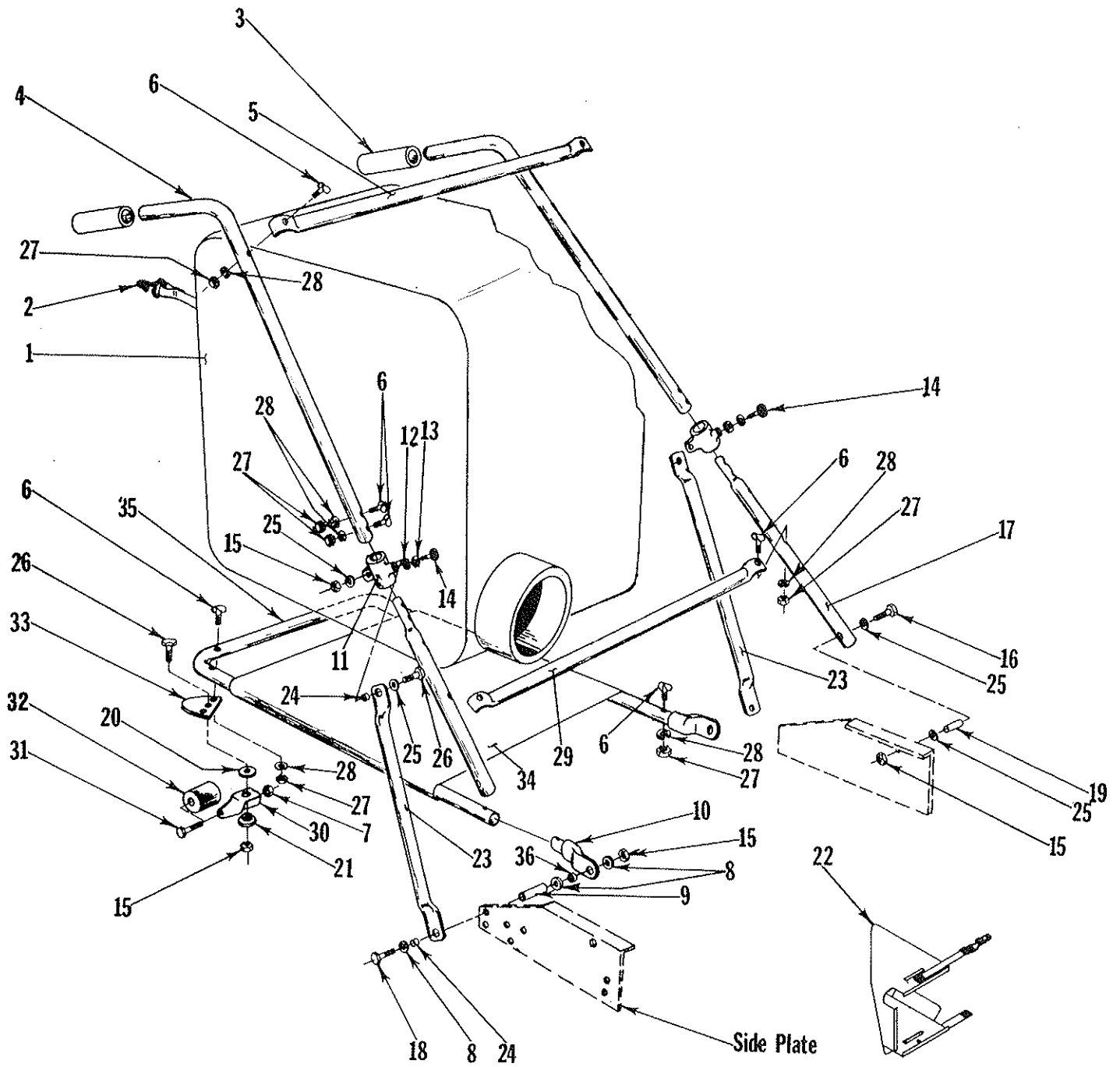

AF-474

HANDLE AND BAG ASSEMBLY

PARTS LIST

Ref. No.	Part No.	Qty. Per Unit	Description
1	MA-426	1	Dust Bag Assy.
2	63-304-A	4	Bag Hook (supplied with MA-426)
3	80-233-A 80-232-A	2	Handle Grip, Blue
4	80-321-C	2	Upper Handle
5	81-157-B	1	Cross Bar Upper
6	69-416-24	14	Bolt, Contour Hd. 1/4-20x1 1/2
7	365-416	2	Nut, Hex. Lock 1/4-20
8	76-36-A	6	Special Washer
9	82-31-A	2	Spacer
10	81-116-A	2	Tubing End Cap
11	80-246-B	2	Pivot Bracket
12	936-616	2	Lockwasher, Int. Tooth 3/8
13	935-616	4	Lockwasher, Spring 3/8
14	80-228-A	2	Knurled Torque Knob
15	365-516	8	Nut, Hex. Lock 5/16-18
16	65-516-28	2	Bolt, Hex. Hd. 5/16-18x1 3/4
17	81-60-B	2	Middle Handle
18	65-516-36	2	Bolt, Hex. Hd. 5/16-18x2 1/4
19	80-238-A	2	Handle Inserts
20	50-230-A 82-138-B-1	2	Special Washer
21	78-130-A	2	Caster Bearing
22	82-194-C	1	Deflector Assy.
23	80-187-C	2	Truss Brace
24	54-227-A	4	Spacer
25	945-516	8	Flatwasher 5/16
26	65-516-16	4	Bolt, Hex. Hd. 5/16-18x1
27	335-416	14	Nut, Hex. Plain 1/4-20
28	935-416	14	Lockwasher 1/4
29	81-157-B	1	Cross Bar Lower
30	76-136-B	2	Caster Fork
31	76-202-A	2	Axle
32	81-79-A	2	Roller
33	82-02-B	2	Caster Plate
34	81-117-C	1	Bag Platform
35	81-96-C	1	Frame, Bag Platform
36	81-120-A	2	Spacer

CHASSIS ASSEMBLY

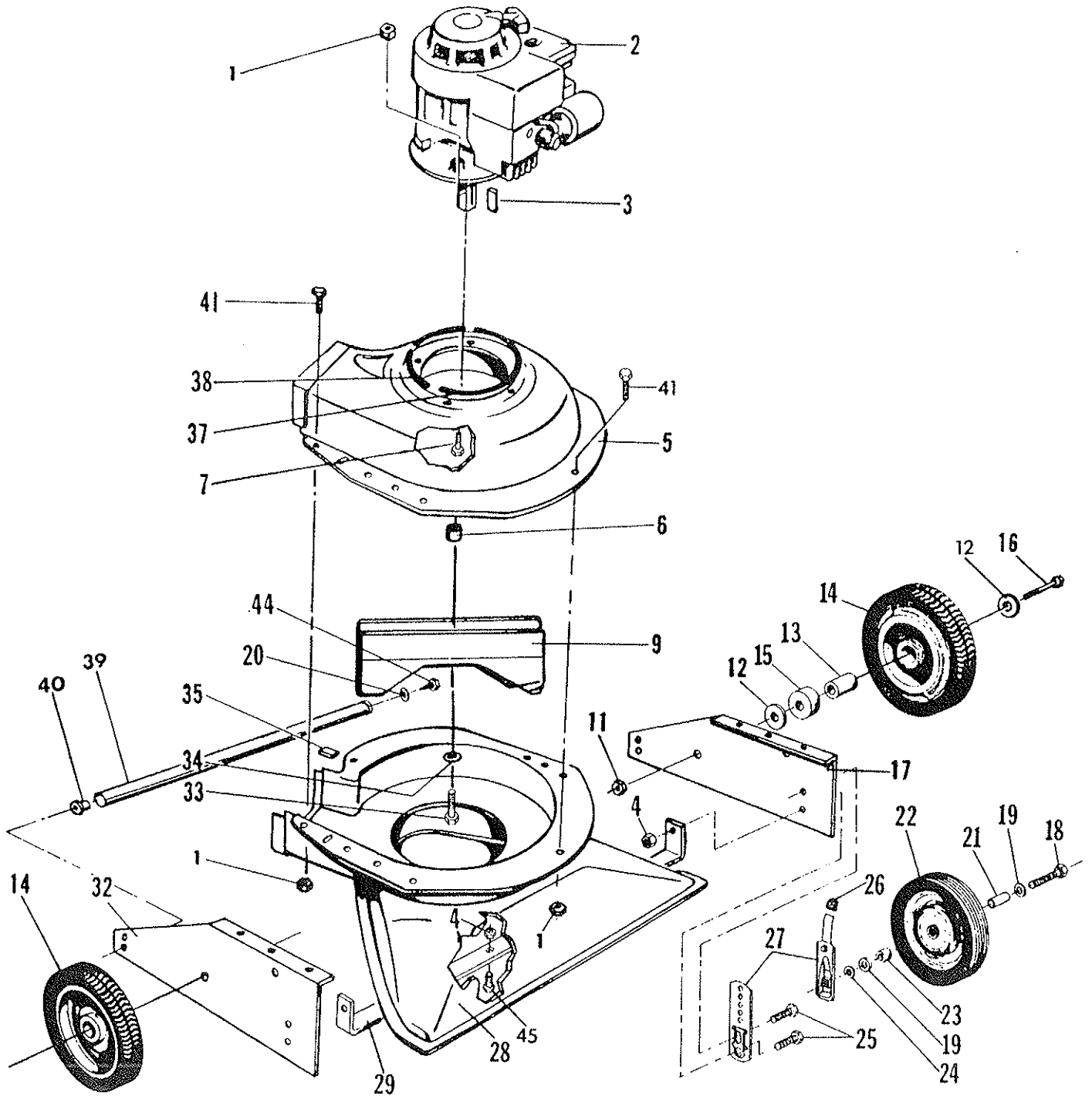

AF-356

CHASSIS ASSEMBLY

PARTS LIST

Ref. No.	Part No.	Qty. Per Unit	Description
1	365-516	15	Nut, Hex. Lock 5/16-18
2	84-12-D	1	Engine, B & S, I/C
3	63-130-A	1	Key, Engine
4	365-616	5	Nut, Hex. Lock 3/8-16
5	32-04-G	1	Upper Housing
6	73-414-A	1	Spacer
7	65-516-20	3	Bolt, Hex. Hd. 5/16-18x1 1/4
9	SA-1263-B	1	Impeller Assembly
11	363-816	2	Nut, Hex. Lock 1/2-20
12	58-05-A	4	Flatwasher 1/2
13	58-06-A	2	Sleeve
14	SA-1036-C	2	Wheel & Tire Assy.
15	76-325-A	2	Spacer
16	60-816-52	2	Bolt, Hex. Hd. 1/2-20x3 1/4
17	81-115-A	1	Side Plate, L.H.
18	65-616-44	2	Bolt, Hex. Hd. 3/8-16x2 3/4
19	945-616	4	Flatwasher 3/8
20	935-516	2	Lockwasher, Spring 5/16
21	70-85-A	2	Spacer Bushing
22	70-69-A	2	Front Wheel
23	79-139-A	2	Blower Spacer
24	936-616	2	Lockwasher, Int. Tooth 3/8
25	81-129-B-5	4	Bolt, Hex. Hd. 3/8-16x1
26	81-129-B-4	2	Vinyl Spring Tip, Red
27	81-129-B-3	2	Spring Lever Assy.
	81-129-B-1	2	Side Plate
	81-129-B-2	2	Back Plate
28	84-15-D	1	Housing Assembly
29	82-11-C	1	Support, Side Plate
32	81-114-A	1	Side Plate, R.H.
*33	60-616-28	1	Bolt, Hex. Hd. 3/8-24x1 3/4
34	935-616	1	Lockwasher, Spring 3/8
35	64-178-A-1	1	Rub-R-Shim 1"
37	64-178-A-9.5	1	Rub-R-Shim 9 1/2"
38	64-178-A-6	2	Rub-R-Shim 6"
39	SA-984-A	1	Cross Brace Assy.
41	65-516-12	11	Bolt, Hex. Hd. 5/16-18x3/4
44	76-269-A	2	Lag Bolt 5/16x1
45	65-616-12	1	Bolt, Hex. Hd. 3/8-16x3/4

*Torque to 29-33 Ft. lbs.

Order all parts from your nearest PARKER PARTS DISTRIBUTORS. If unable to locate the part from your Parts Distributor, forward your order to PARKER SWEEPER COMPANY for a quote.

Hart-Greer, Inc.
900 N. 24th St.
BIRMINGHAM, AL 35203

Lawn & Garden Supply Co.
2222 N. 27th Ave.
PHOENIX, AZ 85017

H. V. Carter Company
1700 E. 14th St.
OAKLAND, CA 94606

Tarzana Mower & Engine
Parts, Inc.
6075 Reseda Blvd.
RESEDA, CA 91335

Colorado Outdoor Equip., Inc.
527 W. Evans
DENVER, CO 80223

Roberts Supply, Inc.
2698 S. Orange Blossom Trail
ORLANDO, FL 32805

Lawn & Turf, Inc.
2570 Old Covington Hwy.
CONYERS, GA 30207

Tyner Distributing, Inc.
5437 Kendall St.
BOISE, ID 83706

Plante's Lawn Equipment, Inc.
4 Grant St.
NORTH AURORA, IL 60542

Davis Turf Products, Inc.
435 So. Wheeling Rd.
WHEELING, IL 60090

T. E. Booher & Sons
1009 W. State St.
ALBANY, IN 47320

The Harnack Co.
728 Commercial St.
WATERLOO, IOWA 50701

Mid-East Power Equip. Co., Inc.
185 Lisle Rd.
LEXINGTON, KY 40586

Morton B. Collins
300 Birnie Ave.
SPRINGFIELD, MA 01106

Frost Company
483 Wildwood St.
WOBURN, MA 01801

Frederick Trading Co.
7901 Trading Lane-Box 400
FREDERICK, MD 21701

Adams Equipment, Inc.
8001 Newell St.
SILVER SPRINGS, MD 20910

Power Equipment Distributors, Inc.
340 N. Hubbard
MT. CLEMENS, MI 48043

R. L. Gould Company
3711 N. Lexington Ave.
ST. PAUL, MN 55112

Hance Distributors
420 Excelsior Ave., W.
HOPKINS, MN 55343

Gunthers Service & Supply
7320 Wornall Rd.
KANSAS CITY, MO 64114

Henzler, Inc.
2015 Lemay Ferry Rd.
ST. LOUIS, MO 63125

Port Huron Machinery & Supply
801 Q St.
LINCOLN, NE 68508

George Smith & Sons, Inc.
322 Broadway
BETHPAGE, L.I., NY 11714

Grasslands Equip. & Irrigation
892 Troy Schenectady Rd.
LATHAM, NY 12110

Henry W. O'Neill & Associates, Inc.
410 N. Goodman St.
ROCHESTER, NY 14609

The Messinger Company, Inc.
374 Avery St.
ROCHESTER, NY 14606

Smith Hardware Co.
515 No. George St.
GOLDSBORO, NC 27530

Hayward Distributing Co.
460 Neilston St.
COLUMBUS, OH 43215

Schroeder Sales & Service, Inc.
1144 Harrison Ave.
HARRISON, OH 45030

PARKER SWEEPER COMPANY
P. O. Box 1728
SPRINGFIELD, OH 45501
Phone: 513-323-4901

Wait Sales Company
406-10 S. Peoria, Box 1015
TULSA, OK 74120

Baltz & Son Co.
9817 E. Burnside
PORTLAND, OR 97216

Monroe Machinery & Supplies, Inc.
1421 S. E. Gidson St.
PORTLAND, OR 97242

Lawn & Golf Supply Co.
647 Nutt Rd.
PHOENIXVILLE, PA 19460

Gardenville Supply Co., Inc.
Route 611
PIPERSVILLE, PA 18947

Bluemont Co.
11125 Frankstown Rd.
PITTSBURGH, PA 15235

Niemeyer Corp.
1135 Phoenixville Pike, Box 1477
WEST CHESTER, PA 19360

Fidelity Sales Corp.
6331 Baum Dr.
KNOXVILLE, TN 37919

Fidelity Sales Corp.
447 E. Market St.
KINGSPORT, TN 37662

Fidelity Sales Corp.
6044 Lee Highway
CHATTANOOGA, TN 37421

Goldthwaite's of Dallas, Inc.
2700 Forest Ln., Box 34660
DALLAS, TX 75234

Goldthwaite's of Ft. Worth
1401 Foch St.
FT. WORTH, TX 76107

Goldthwaite's of Houston, Inc.
220 Farris
HOUSTON, TX 77025

Goldthwaite's of Texas, Inc.
10751 Sentinel
SAN ANTONIO, TX 78217

Boyd Martin Company
1260 N. W. Temple
SALT LAKE CITY, UT 84116

Wetsel Seed Co.
941 N. Liberty
HARRISONBURG, VA 22801

The Bentley Company
4126 Airport Way, S.
SEATTLE, WA 98108

Northwest Mower, Inc.
926 N. 165th St.
SEATTLE, WA 98133

Interstate Radiator & Lawn Mower Co.
1611 4th Ave.
CHARLESTON, WV 25312

Reinders Brothers, Inc.
13400 Watertown Plank Rd.
ELM GROVE, WI 53122

R. L. Gould
344 Berger St.
GREEN BAY, WI 54302

Van's Supply & Equip. Co., Inc.
2640 So. Ashland Ave.
GREEN BAY, WI 54303

Shepherd Bros. Equip., Ltd.
19575 North 10 Highway
LANGLEY, B.C., CANADA
V3A 4R8

Fallis Turf Equip., Ltd.
11951 Forge Place
RICHMOND, B.C., CANADA
V7A 4V9

G. C. Duke Lawn Equipment
1184 Plains Rd., East
BURLINGTON, ONTARIO,
CANADA L7S 1W6