



Electronic Service Manuals

This electronic document is provided as a service to our customers. We do not create the contents of the information contained in this document. Should you have detailed questions pertaining to the information contained in this document, you may contact Michco, or the manufacturer which provided the original information in this electronic deliverable. Michco's only part in this electronic deliverable was the electronic assembly process. By providing this manual on line we are not guaranteeing parts availability.

You may contact Michco through the following methods:

Phone (517) 484-9312 or (800) 331-3339

2011 N. High St. -- Lansing, Michigan -- 48906

Fax: (517) 484-9836

Email: CustServe@Michco.com

Web site: www.Michco.Com

Parts Web site: www.FloorMachineParts.Com

Order Parts on Line at:

www.FloorMachineParts.Com

Directly to Parts & Service:

By Email: **Shop@Michco.com**

By Fax: (517) 702-2041

By Voice: Use numbers above.

Serving the Cleaning Industry Since 1922

Notice: All copyrighted material remains property of original owners, all trademarks are property of respective owners. Manuals are subject to Manufacturer's reproduction limitations. Originals or reproductions were provided by manufacturers through a request. We make no warranty as to the correctness of information provided in this document and you assume all risk. By placing these manuals on line we are not declaring our corporation to be an manufacturer authorized dealer or provider, please check our web site for authorized manufacturers we represent.

OWNERS GUIDE

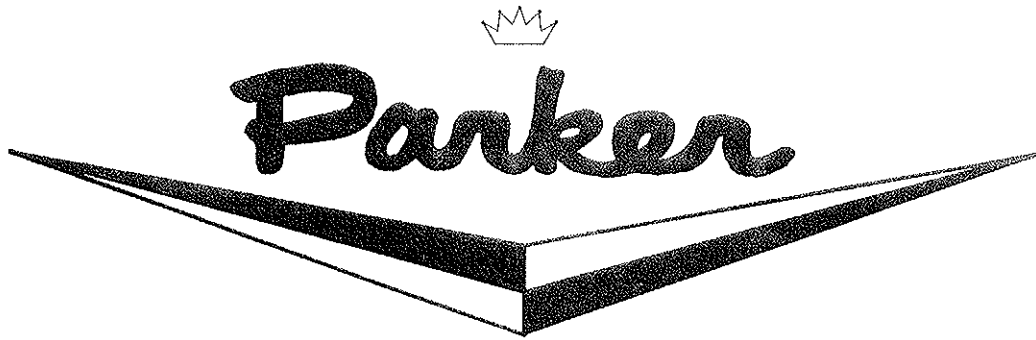

PA-7930 PARKERETTE® 30" LAWN SWEEPER

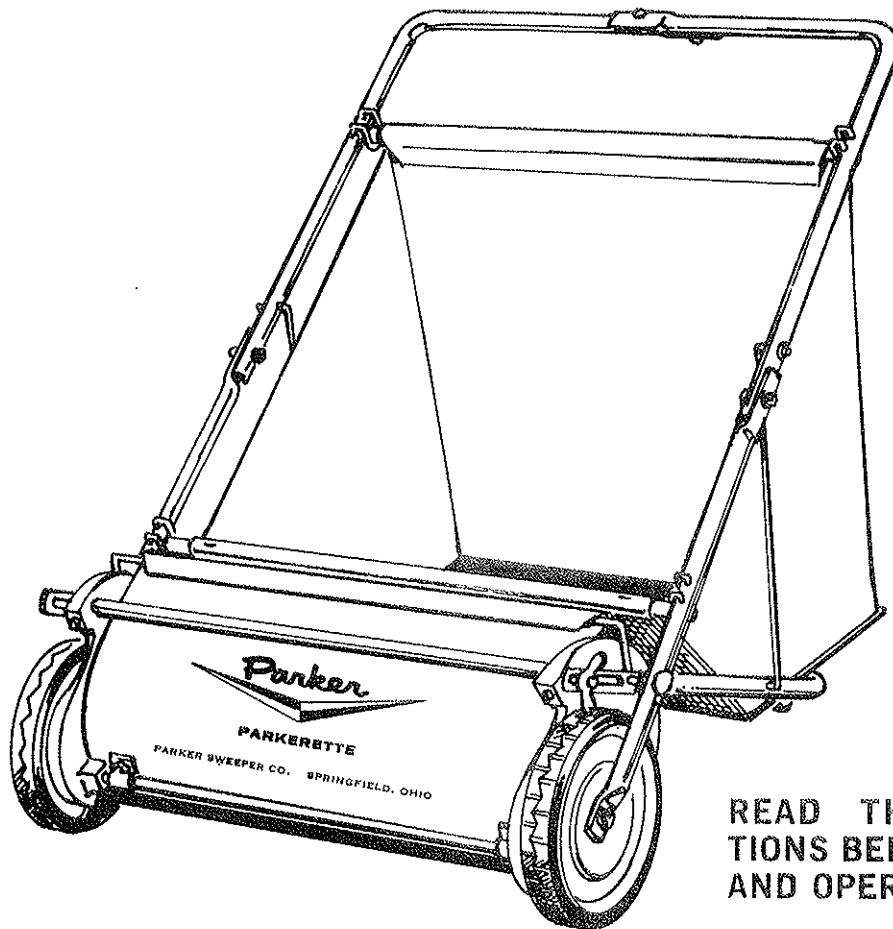

READ THESE INSTRUCTIONS BEFORE SETTING UP AND OPERATING MACHINE.

PARKER SWEEPER COMPANY **Box 1728** **Springfield, Ohio 45501**

Plate No. 491

ASSEMBLY INSTRUCTIONS

Remove the sweeper and components from the carton but do not dispose of the carton until you have the unit completely assembled.

The Lower Handles (Right and Left Hand) complete with basket clips, spacer, flat washer, contour head bolt and nut are taped to the lower frame. Remove the tape and select the Lower Left Handle Assembly. Take off **only** the nut, lock washer and flat washer leaving the spacer and brush adjusting bracket on the bolt. Assemble to the left side of the Lower Frame as shown. In sequence, reinstall the flat washer, lock washer and nut back on the bolt and tighten. **Do not over tighten** or the contour head bolt can crush the tubing. Repeat the procedure on the Right Lower Handle.

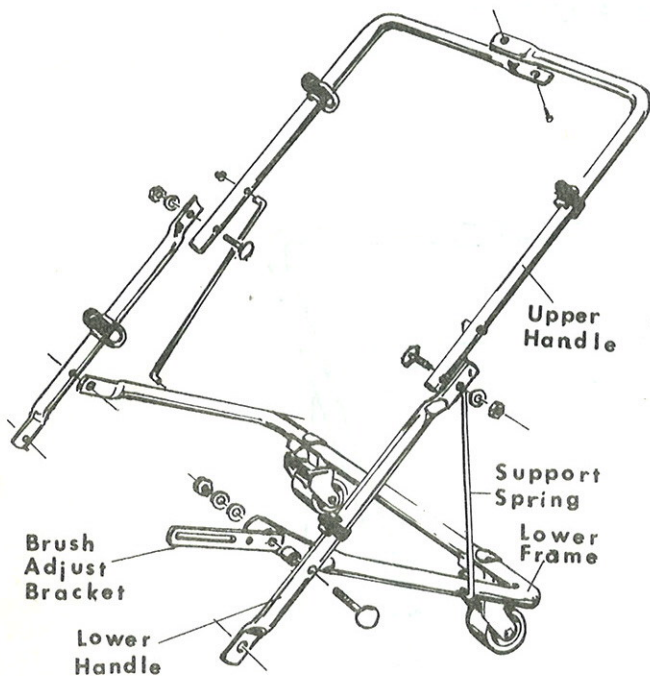

The Upper Handle is split in two sections. Self tapping screws have been temporarily taped to the upper part of the handle. Remove these screws and assemble the handle to form a U section. Attach the Upper Handle to the Lower Handle with the contour head bolts provided in the Lower Handle. Insert the bolt from the inside hole on the Upper Handle as shown in the sketch.

Remove **only** the cotter pin and flat washer from each axle. Install the Lower Handle on the axles and replace the flat washers and cotter pins. Spread the cotter pins to secure.

Remove the wing nut, washers and long bolt that passes through the tube at the top of the chassis assembly in front of the hood.

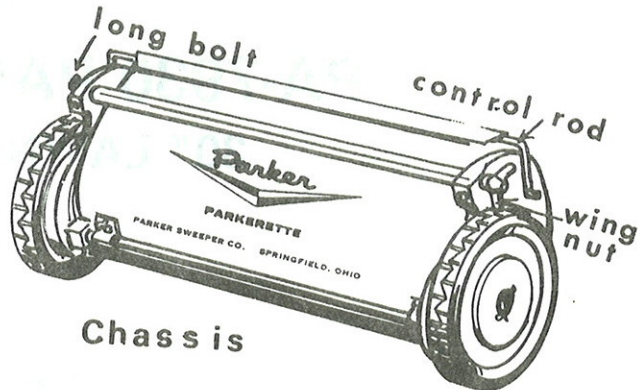

Raise the Upper Handle and remove the tape from the Support Springs. Swing the Support Springs down and insert the end into the hole in the lower frame.

Reinstall the long bolt from the right side in the following sequence: through the slot in the brush adjustment bracket, a 3/8" flat washer, the connecting tube, a 5/16" flat washer, the second brush adjustment bracket and the second 5/16" flat washer. Reinstall the large wing nut. Pull the adjusting tube forward as far as it will go in the brush adjustment brackets and tighten the wing nut to hold the sweeper in its highest brushing position. You are now ready to install the basket. Twist the basket clips (that were provided on the handles) towards the outside of the frame. You will do this in all four positions and then install the wooden rods in the support brackets. After you have the basket installed, then twist all clips back towards the inside of the frame to secure the basket in place. We provide the basket clips so that when you are sweeping on rough terrain the basket will not be jolted from the support brackets.

REPAIR PARTS

SECTION 4 MODEL NO. PA-7930

- SWEEPER UNIT ASSEMBLY -

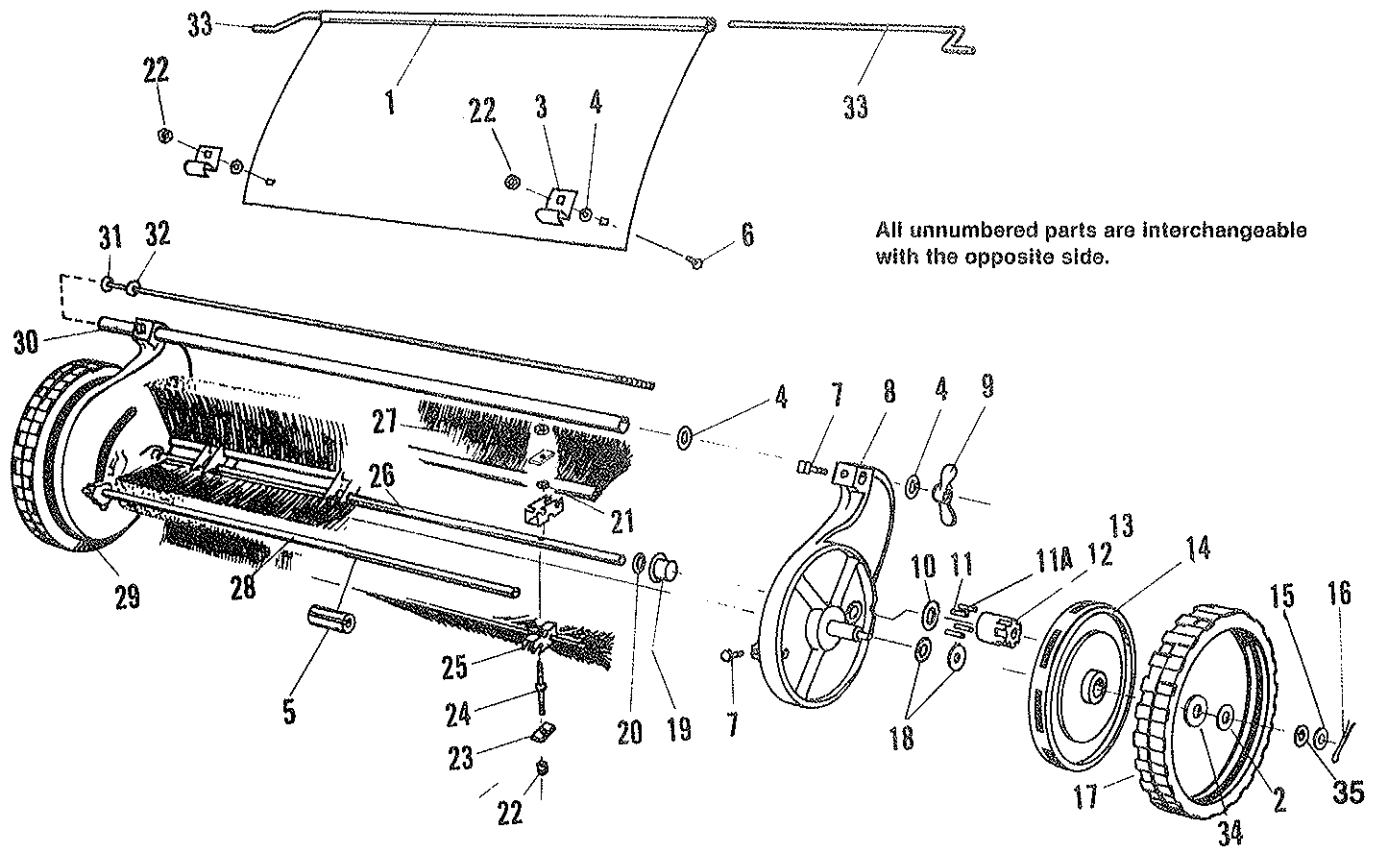

PARTS LIST

REF. PART NO. NO.	QTY. PER UNIT	DESCRIPTION	REF. PART NO. NO.	QTY. PER UNIT	DESCRIPTION
1 79-02	1	Hood	17	2	Tire
2 71-37-A	2	Special Washer	18	4	Fiber Washer
3 60-22-B	2	Hood Clamp	19	2	Ball Bearing
4 945-516	4	Plain Washer 5/16	20	2	Special Washer
5 79-50-A	1	Hood Spacer	21	4	Retainer
6 70-416-12	2	Carriage Bolt 1/4-20 x 3/4	22	10	Hexagon Lock Nut 1/4-20
7 560-C-516-10	4	Set Screw 5/16-18 x 5/8	23	8	Brush Clamp
8 68-04 <i>RIW</i>	1	Left Hand Side Plate <i>71-05-RD</i>	24	4	Brush Stud
9 73-71-A	1	Wing Nut 5/16	25	8	Brush Bracket
10 50-33-A	2	Special Washer	26	1	Reel Shaft
11 74-80	4	Roller	27	8	Brush Strip
11A 76-37	4	Plastic Tube	28	1	Bottom Tie Rod
12 74-79	1	Left Hand Pinion	29	1	Right Hand Side Plate <i>71-04-RD</i>
13 74-78	1	Right Hand Pinion	30	1	Adjusting Tube
14 49-377-C	2	Wheel	31	1	Adjusting Bolt
15 46-81-A	4	Special Washer	32	1	Plain Washer 5/16
16 380-432-16	2	Cotter Pin 1/8 x 1	33	2	Hood Control Rod
			34	2	Fiber Washer
			35	2	Spacer - Axle

BASKET AND HANDLE ASSEMBLY

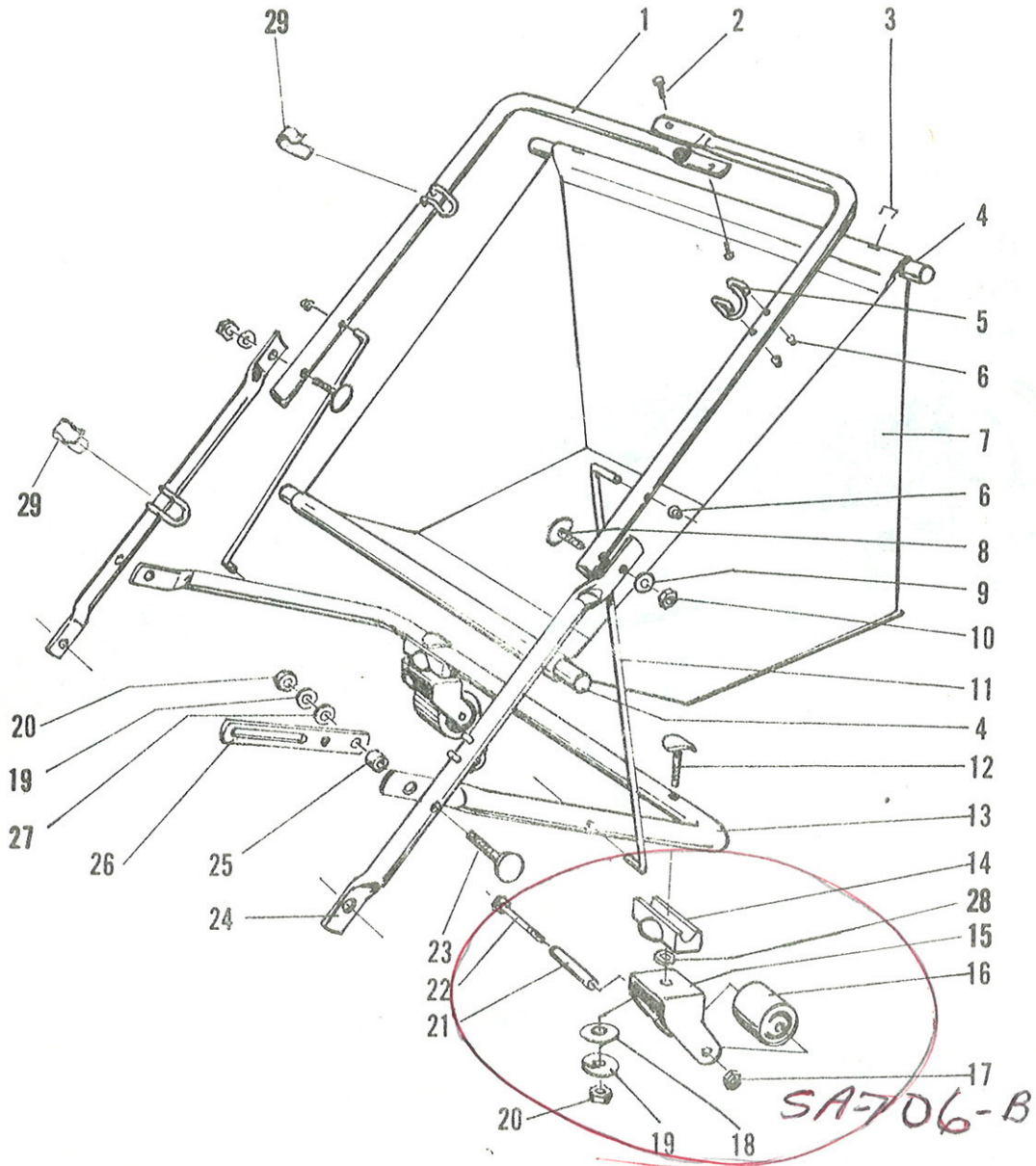

PARTS LIST

Ref. No.	Part No.	Qty. Per Unit	Description of Part	Ref. No.	Part No.	Qty. Per Unit	Description of Part
1	77-28-C	2	Upper Handle	16	78-56-A	2	Roller
2	77-27-A	2	Screw Self Tapping	17	365-416	2	Nut 1/4-20 Hex Lock
3	62-171-A <i>RIW</i>	4	Staple <i>82-236-A</i>	18	55-156-A <i>RIW</i>	2	5/16 Special Washer <i>82-138-B-2</i>
4	77-51-A	2	Basket Rod	19	935-516	4	5/16 Spring Lock Washer
5	76-415-A <i>RIW</i>	4	Basket Support Bracket <i>80-110-A</i>	20	335-516	4	Nut 5/16-18 Hex
6	77-10-A	10	Push Nut	21	78-65-A	2	Bushing
7	77-48-D	1	Basket Assembly	22	65-416-44	2	Bolt 1/4-20 x 2 3/4 Hex Head
8	69-416-20	2	Bolt 1/4-20 x 1 1/4 Contour Hd.	23	69-516-24	2	Bolt 5/16-18 x 1 1/2 Contour Hd.
9	935-416	2	1/4" Spring Lockwasher	24	77-29-B	2	Lower Handle
10	335-416	2	1/4-20 Hexagon Nut	25	54-227-A	2	Spacer
11	77-30-A	2	Handle Support Spring	26	60-21-A	2	Brush Adjusting Brkt.
12	69-516-28	2	Bolt 5/16-18 x 1 3/4 Contour Hd.	27	945-516	2	5/16 Flat Washer
13	77-49-C	1	Handle Support	28	74-126-A	2	Spacer
14	59-68-B <i>RIW</i>	2	Pivot Block <i>79-174-A</i>	29	78-123-A	4	Clip
15	78-55-B	2	Caster Fork				

OPERATING INSTRUCTIONS

THE ADJUSTMENT OF THIS SWEEPER IS VERY IMPORTANT FOR EASE OF OPERATION.

Adjusting Brush Height. Loosen large wing nut. To raise brushes to extreme height, pull sweeping unit forward as far as slots in brush adjustment brackets, will permit. To lower brushes to lowest position, push sweeping unit backward as far as slots will permit. Secure wing nut when desired brush adjustment is obtained.

NOTE: IF SWEEPER PUSHES HARD, THE BRUSHES ARE SET TOO LOW.

CARE AND BRUSH REPLACEMENT

Should the bristles take a set from use, reverse the brushes on the reel shaft. Never allow the brush bristles to remain in a bent position on any object for any length of time as they can take a set.

TO REMOVE BRUSHES

Turn the Sweeper upside down on the ground. Notice the Stud has a collar against the Brush Bracket holding it against the Reel Shaft.

Remove the Hex Nuts and Clamps from the Stud on the end having the collar. Remove the Brushes from the Brush Bracket slots, (4 places). Now remove the Hex Nuts and Clamps from the opposite end of the Studs. Do not remove the Speed Nuts or the Studs will fall away from the Reel Shaft (4 places).

TO REPLACE BRUSHES

Turn the Reel Shaft so you can position the Brush Strips in the slots on the Brush Bracket that are being held on the Stud and Shaft by the Speed Nut. Position the Clamps and Hex Nuts, center the Brush Strips between the Side Plates, then tighten the Hex Nuts.

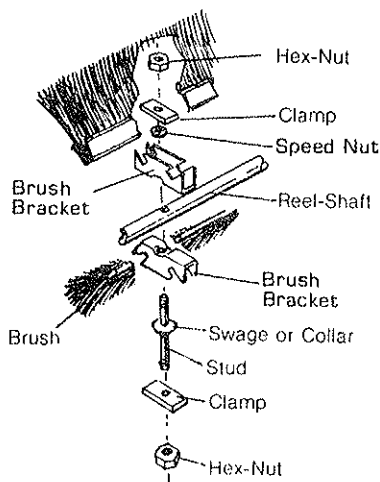

Turn the Reel Shaft so the Brushes are on the bottom side. Now place the Brush Strips in the slots on the Brush Brackets, on the top side. Position the Clamps and Hex Nuts. Center the Brush Strips between the Side Plates, then tighten the Hex Nuts.

BASKET CARE

The Basket should always be emptied immediately after each time the Sweeper is used, especially if the grass or leaves are wet or damp. Allowing the Basket to keep dry will lengthen its service life. Basket clamps were furnished to secure the basket and prevent it from bouncing out of the brackets when sweeping over rough terrain.

LUBRICATION

Frequent lubrication of the Sweeper will lengthen the service life.

Place a few drops of oil in the oil hole located on the hub of each wheel and between the Washer and Bearing Flange on the Reel Shaft inside the Side Plate (Both Sides). This should be done each time before the Sweeper is used.

Before using the Sweeper the first time each season, remove both Wheels and put a good grade of grease on the Pinion Gear and the gear of the Wheel.

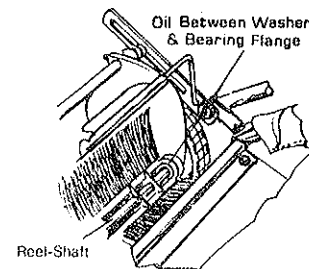

If for any reason it is necessary to remove the Pinion Gear, be sure the Pinion Gear, Roller Pawls and Pawl Springs are reassembled in their correct position. Both right and Left Pinion Gears must be turning the right direction so the Brush Reel is turning toward the operator when the Sweeper is pushed forward.

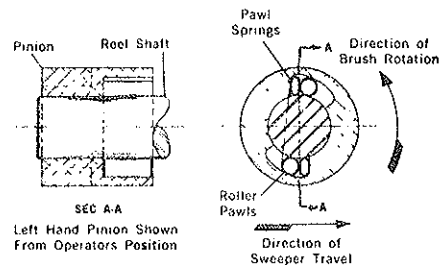

ALWAYS GIVE THE FOLLOWING INFORMATION WHEN ORDERING REPAIR PARTS:

1. PART NUMBER (Not Ref. No.)
2. QUANTITY NEEDED
3. DESCRIPTION OF PART
4. MODEL No. PA-7830

If unable to obtain parts locally, write down above information and send to:
PARKER SWEEPER CO., BOX 1728, SPRINGFIELD, OHIO 45501

Your unit is right hand (R.H.) or left hand (L.H.) as you stand behind it.

IMPORTANT

HOW TO RE-INSTALL PINIONS IN MANUAL OR TRAILING SWEEPERS

If for some reason you have found it necessary to remove the pinions, you should carefully follow the following instructions.

- (1) To assist you, we suggest using a piece of wood doweling or plastic material $\frac{5}{8}$ " diameter, 2" long as shown. Each pinion is different as indicated by the part number and must be returned to the correct side of the shaft.

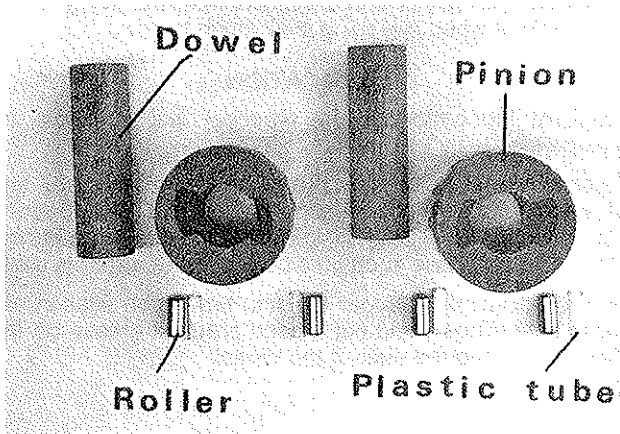

- (4) Pinion with part number **74-79 BL** is to be replaced on the **left side** of the shaft. Part Number **74-78BR** is for the **right side**. Line up the pinion (leaving the dowel in place) with the shaft as shown.

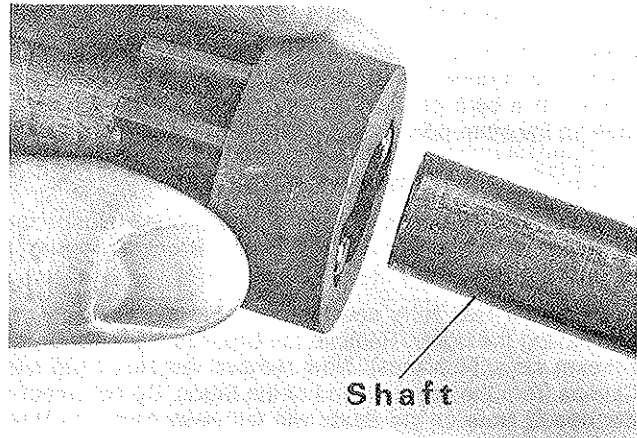

- (2) Insert the wooden dowel into the pinion.
- (3) Identify your pinion part number and insert the metal rollers. Place the plastic tubing in the cavity between the metal roller and the wall of the cavity. You may have to force the plastic tubing into this space but it is resilient and is supposed to fit tightly.

- (5) Push the pinion onto the shaft which will force the dowel to back out of the pinion. This will leave the rollers and plastic tubes in their proper position.

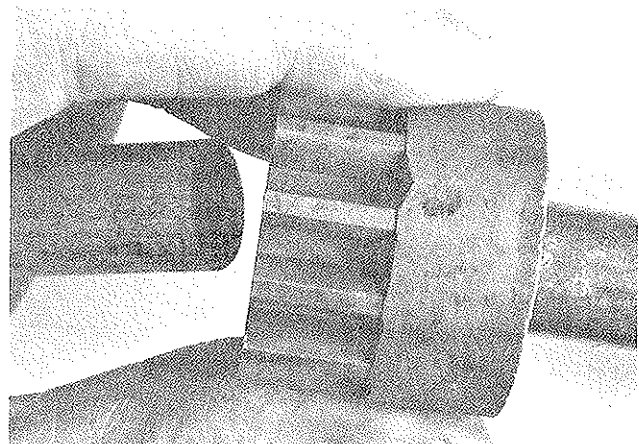
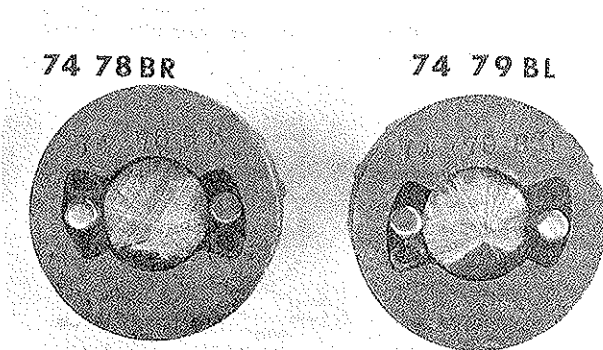

- (6) Apply a coating of grease on the outside of the pinion gear teeth and the wheel gear teeth. Replace the wheel.

Note! The right and left side are determined from the operators position.