



Electronic Service Manuals

This electronic document is provided as a service to our customers. We do not create the contents of the information contained in this document. Should you have detailed questions pertaining to the information contained in this document, you may contact Michco, or the manufacturer which provided the original information in this electronic deliverable. Michco's only part in this electronic deliverable was the electronic assembly process. By providing this manual online we are not guaranteeing parts availability.

You may contact Michco through the following methods:

Phone (517) 484-9312

2011 N. High St. -- Lansing, Michigan -- 48906

Fax: (517) 484-9836

Email: CustomerService@Michco.com

Website: www.Michco.Com

Order Parts online at:

www.Michco.Com

Directly to Parts & Service:

By Email: **CustomerService@Michco.com**

By Fax: (517) 484-9836

By Voice: (517) 484-9312

Serving the Cleaning Industry Since 1922

Notice: All copyrighted material remains property of original owners, all trademarks are property of respective owners. Manuals are subject to Manufacturer's reproduction limitations. Originals or reproductions were provided by manufacturers through a request. We make no warranty as to the correctness of information provided in this document and you assume all risk. By placing these manuals on line we are not declaring our corporation to be an manufacturer authorized dealer or provider, please check our web site for authorized manufacturers we represent.

700REV

7" Countertop Revolution Tool



Owner's Manual

EDIC

1753 Blake Ave Los Angeles, CA 90031

1-800-338-EDIC/323-660-1635

Fax 323-667-0144

www.edic-usa.com

7" REVOLUTION COUNTERTOP TOOL OVERVIEW

Thank you for purchasing a 700REV, 7" Revolution Countertop Tool. The 700REV is a smaller, hand held version of the larger 1200REV. The 700REV allows you to clean vertical and horizontal surfaces, both indoor and outdoor, such as grouted tile and outdoor brick, concrete, and limestone surfaces. Its pointed front end enables you to clean efficiently against floor and wall corners. Although it has been optimized for use with our EDIC ENDEAVOR series, It can be used with any high pressure extractor with 500 psi – 2500 psi pressure range.

WHEN THE PACKAGE IS DELIVERED

Check the box and packaging carefully for signs or rough handling. Remove the tool from the carton. If the tool is damaged, notify the carrier IMMEDIATELY and request an inspection. Be sure to keep the carton, packing inserts, packing lists and carrier's receipt until the inspector has verified your claim.

EDIC's liability ceases when the carrier picks up the shipment but our customer service staff will be glad to furnish any information needed in connection with the claim and will expedite repair of the machine.

BEFORE OPERATING THE REVOLUTION COUNTERTOP TOOL

Read this manual carefully and completely before attempting to operate the unit. This manual has important information for the use and safe operation of the tool. Keep this manual handy at all times. This tool will provide you with many years of satisfactory service if operated and maintained according to recommendation in this manual. If additional information is needed, please contact your local distributor or write to:

EDIC 1753 Blake Ave
Los Angeles, CA 90031-1006
E-mail:info@edic-usa.com

All information and specifications printed in the manual and parts list are current at the time of printing; however, because of EDIC's policy of continual product development, we reserve the right to make changes at any time without notice.

WARNING

- This tool is not designed to handle or use combustible/volatile substances such as gasoline or kerosene, in, on, or near the tool. The use of such materials may cause extreme hazardous conditions.
- Do not leave the tool exposed to harsh weather elements. Temperatures below freezing may damage components and void warranty.
- This is not a toy. Ensure children do not have access to the equipment. Do not allow children to play with or near the unit.
- Keep hair, loose clothing, fingers and all parts of the body away from all moving parts.
- The Revolution was designed for use on hard surfaces only such as grouted tile, stone, or concrete as per the instructions and recommendations written in this manual. Any deviation from its proper use or purpose and the consequential damage that may occur is the sole responsibility of the end-user.
- Repairs are only allowed by a qualified service center. Do not attempt to disassemble or repair the unit if you are not qualified to do so.
- Do not drop or throw the unit. Treatment of this type can cause damage to the components and create hazardous condition

FAILURE TO COMPLY WITH THE ABOVE WARNING INSTRUCTIONS WILL VOID THE WARRANTY.

PREPARATION

- Remove furniture from cleaning area, and remove any large debris and fibers by vacuuming or wiping the surface to be cleaned.
- Protect any cabinets, painted surfaces, walls, carpets, and other delicate materials from overspray by masking, using painter's tape, drop cloths, plastic, or spray shields.
- Identify the type of surface you are going to clean to ensure that you are using the proper chemicals, brushes and equipment and will not damage the floor.
- After identifying the surface, apply the appropriate pre-spray to the floor. To avoid longer dry time before sealing, use only 5 minute dwell time or less and do not over wet the surface.

OPERATION

(Pressure range of 700-1500 psi and temperature up to 200°F)

- Connect the Revolution to the vacuum and solution hoses from the extractor.
- Turn on the extractor to engage the vacuum.
- Make sure the bottom of the Revolution is flush with the surface to be cleaned to ensure proper suction.
- Squeeze the trigger to release the solution and move the Revolution at a moderate rate overlapping just enough to ensure complete coverage. Moving too fast may create a spiral pattern in the grout or tile.

AFTER USE

- Disconnect hoses and inspect them for any damage.
- Wipe the machine with a clean, soft damp cloth.
- Store indoors, in a clean, dry place.
- Do not store sitting on the brush.
- Do not store in freezing temperatures.

REGULAR MAINTENANCE

- Clean and inspect hoses.
- Check for loose hardware.
- Clean machine with a clean, soft, damp cloth.

WEEKLY MAINTENANCE

- Inspect spray tips. Do not adjust angle of the tips.

TROUBLE SHOOTING

Problem

Cause

The spinning arm does not spin

- Inspect the jets to make sure they are not clogged.
- Disconnect and check the solution line reaching the tool for normal flow.
- Try to spin the arm by hand. If it doesn't move, take the tool to a qualified service center for repair or replacement of the swivel fitting.

EXPLODED VIEW

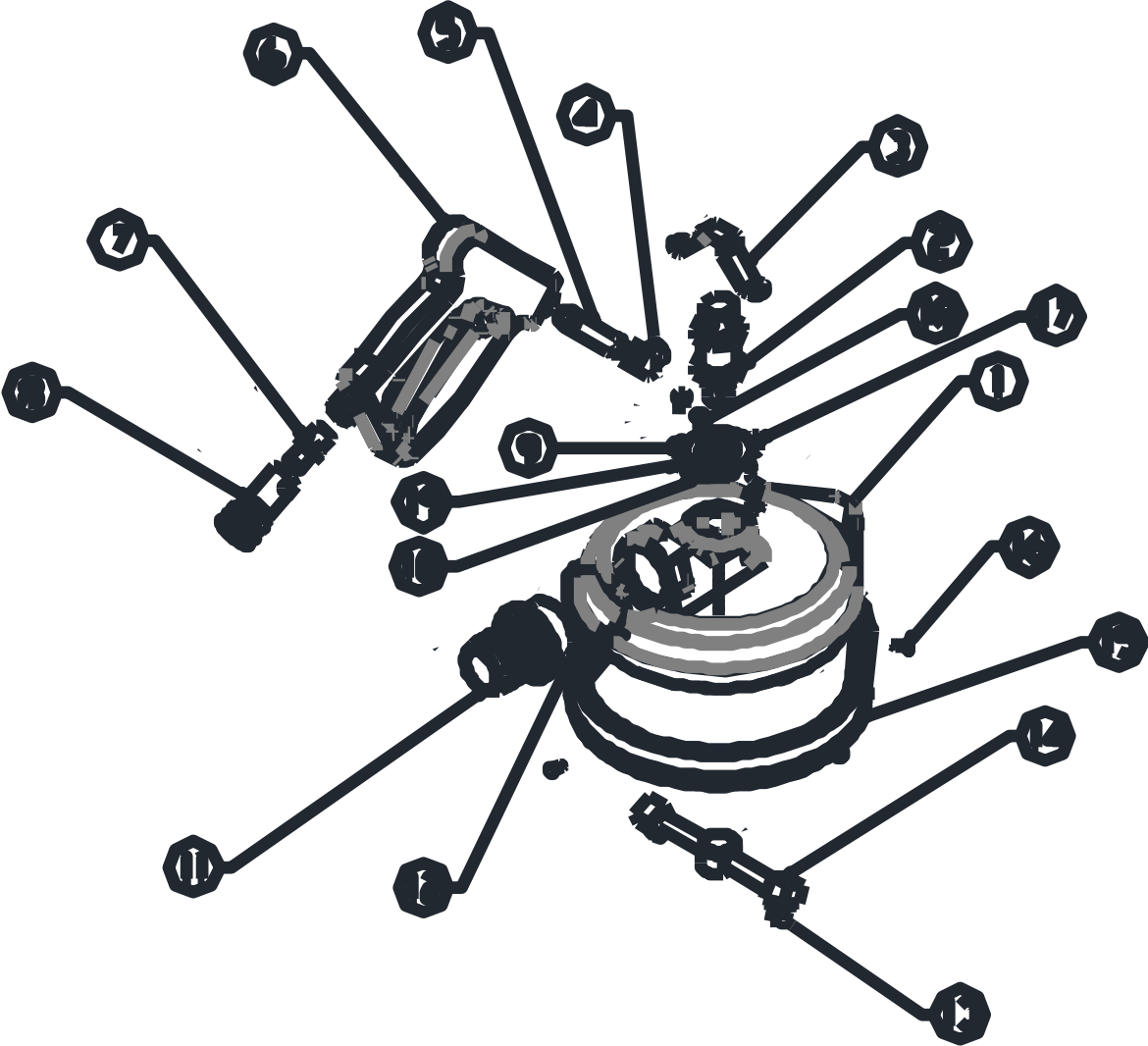

PARTS LIST

Item	Part Number	Description	Quantities
1	F13526	Housing	1
2	D13311	Swivel Fitting	1
3	D13928	Swivel Fitting Clamp	1
4	A00053	Elbow, 45° 1/4M-1/4F	1
5	A00163	Long Nipple ¼ x 3	1
6	G13298	Spray Gun	1
7	A13375	Reducing Hex Nipple 3/8-1/4	1
8	A00102	QD (Female) Coupler ¼	1
9	D13717	Swivel Fitting Washer 1	1
10	D13929	Swivel Fitting Washer 2	1
11	K00655-1	Flanged Hose Adapter 1-1/2	1
12	E11128	Gasket	1
13	A13323	Spray Tip #2	2
14	D13718	Spinner Arm	1
15	F13485	Skirt Brush	1
16	C13674	Thread forming screw #6	5
17	C00311	Screw, 8-32 x 3/8	2
18	C11237	Nut, 8-32	2
19	C02237	Thread forming screw #8	1