



Electronic Service Manuals

This electronic document is provided as a service to our customers. We do not create the contents of the information contained in this document. Should you have detailed questions pertaining to the information contained in this document, you may contact Michco, or the manufacturer which provided the original information in this electronic deliverable. Michco's only part in this electronic deliverable was the electronic assembly process. By providing this manual on line we are not guaranteeing parts availability.

You may contact Michco through the following methods:

Phone (517) 484-9312 or (800) 331-3339

2011 N. High St. -- Lansing, Michigan -- 48906

Fax: (517) 484-9836

Email: CustServe@Michco.com

Web site: www.Michco.Com

Parts Web site: www.FloorMachineParts.Com

Order Parts on Line at:

www.FloorMachineParts.Com

Directly to Parts & Service:

By Email: **Shop@Michco.com**

By Fax: (517) 702-2041

By Voice: Use numbers above.

Serving the Cleaning Industry Since 1922

Notice: All copyrighted material remains property of original owners, all trademarks are property of respective owners. Manuals are subject to Manufacturer's reproduction limitations. Originals or reproductions were provided by manufacturers through a request. We make no warranty as to the correctness of information provided in this document and you assume all risk. By placing these manuals on line we are not declaring our corporation to be an manufacturer authorized dealer or provider, please check our web site for authorized manufacturers we represent.

American-Lincoln®



7765 / 7760 SCRUBBER/SWEEPER

7765: 505-255, 505-258, 505-256, 505-259, 505-257, 505-260

7760: 505-255CE, 505-258CE, 505-257CE, 505-260CE

Instructions for Use

READ THIS BOOK

This book has important information for the use and safe operation of this machine. Failure to read this book prior to operating or attempting any service or maintenance procedure to your machine could result in injury to you or to other personnel; damage to the machine or to other property could occur as well. You must have training in the operation of this machine before using it.

All directions given in this book are as seen from the operator's position at the rear of the machine.

TABLE OF CONTENTS

TABLE OF CONTENTS	2-3
INTRODUCTION	4
INTRODUCTION.....	4
PARTS AND SERVICE	4
NAMEPLATE.....	4
UN-CRATING.....	4
MACHINE OPERATION.....	5
PREPARING THE MACHINE FOR OPERATION	5
CAUTIONS AND WARNINGS	6
CONSIGNES DE PRUDENCE ET DE SECURITE	7
OPERATION OF CONTROLS AND GAUGES	8
IGNITION SWITCH	8
LIGHT SWITCH	8
TURN SIGNAL (OPTION).....	9
GLOW PLUG SWITCH	9
HORN PUSH BUTTON.....	9
SIDE BROOM LIFT	9
MAIN BROOM SWITCH	10
SIDE BROOM SWITCH.....	10
DUST CONTROL SWITCH.....	10
FILTER SHAKER SWITCH.....	10
WATER TEMPERATURE GAUGE.....	11
HOUR METER	11
FUEL GAUGE	11
OIL PRESSURE GAUGE.....	11
VOLT METER	11
SCRUB BRUSHES SWITCH	11
BRUSH ROTATION SWITCH	12
BRUSH PRESSURE SWITCH.....	12
SQUEEGEE BLADE SWITCH.....	12
HIGH RECOVERY WARNING LIGHT	12
LOW SOLUTION WARNING LIGHT.....	12
HOPPER LIFT.....	13
HOPPER SAFETY LOCK ARM	13
HOPPER DUMP DOOR.....	13
MANUAL DUMP HOPPER.....	13
SOLUTION CONTROL	13
SWEEPING BROOM LIFT CONTROL	13
THROTTLE	14
CHECK ENGINE LIGHT	14
PARKING BRAKE	14
FOOT BRAKE	14
ACCELERATOR & DIRECTIONAL CONTROL PEDAL.....	15
BACK-UP ALARM SWITCH.....	15
SEAT ADJUSTMENT	15

TABLE OF CONTENTS

ESP SYSTEM OPERATING INSTRUCTIONS	16
ESP RECYCLING CONTROL PANEL	16
ESP RECYCLING SYSTEM ON/OFF SWITCH	16
SOLUTION HIGH WARNING LIGHT	16
DETERGENT LOW WARNING LIGHT	16
DETERGENT FLOW KNOB	16
THE SCRUBBING SYSTEM - HOW IT WORKS	17
NON-RECYCLING SCRUBBING SYSTEM - HOW IT WORKS	17
RECOVERY OR ESP SYSTEM - HOW IT WORKS	18
THE SWEEPING & DUST CONTROL SYSTEM - HOW IT WORKS	19
OPERATING INSTRUCTIONS	20
FILLING THE SOLUTION TANK - NON-RECYCLING (STANDARD)	20
FILLING THE SOLUTION TANK - ESP	20
PRE-START CHECKLIST	20
BEFORE STARTING THE ENGINE	20
STARTING THE ENGINE	20
POST-START CHECKLIST	21
TRANSPORTING THE MACHINE	21
BEGINNING THE CLEANING OPERATION	21
HELPFUL HINTS FOR CLEANING OPERATION	22
POST-OPERATION & CLEAN-UP INSTRUCTIONS	23
TO STOP THE CLEANING OPERATION	23
POST-OPERATION CHECKLIST	23
TO DRAIN THE SOLUTION TANK	23
TO CLEAN THE SOLUTION TANK	23
TO DRAIN THE RECOVERY TANK	23
TO CLEAN THE RECOVERY TANK	24
TO EMPTY THE DEBRIS HOPPER	25
TOWING INSTRUCTIONS	25
SERVICE CHART	26
GENERAL MACHINE MAINTENANCE	28
LUBRICATION	28
ENGINE	29
MAIN BROOM REMOVAL	29
MAIN BROOM LEVEL ADJUSTMENT	30
ADJUSTING MAIN BROOM WEAR PATTERN	30
SIDE BROOM LEVEL ADJUSTMENT	30
SIDE BROOM REPLACEMENT	30
FLAPS	31
SCRUB BRUSH REPLACEMENT	32
COVERS AND LATCHES	32
SOLUTION WARNING LIGHT	32
RECOVERY WARNING LIGHT	32
SOLUTION CONTROL - STANDARD	32
SOLUTION CONTROL - ESP	32
RECYCLING PUMP ESP SYSTEM	33
ESP SYSTEM STORAGE	33
REAR SQUEEGEE	33
SQUEEGEE CASTER WHEELS	33
ADJUSTING CASTERS	33
GENERAL TROUBLESHOOTING	34
TECHNICAL SPECIFICATIONS	36

INTRODUCTION

INTRODUCTION

This manual will help you get the most from your American-Lincoln™ - Alto sweeper / scrubber. Read it thoroughly before operating the machine.

PARTS AND SERVICE

Repairs, when required, should be performed by your Authorized American-Lincoln™ - Alto Service Center, who employs factory trained service personnel, and maintains an inventory of American-Lincoln™ - Alto original replacement parts and accessories.

Call the AMERICAN-LINCOLN / ALTO INDUSTRIAL DEALER named below for repairs or service. Please specify the Model and Serial Number when discussing your machine.

(Dealer, affix service sticker here.)

NAMEPLATE

The Model Number and Serial Number of your machine are shown on the Nameplate, located on the wall of the operator's compartment. This information is needed when ordering repair parts for the machine. Use the space below to note the Model Number and Serial Number of your machine for future reference.

MODEL _____

SERIAL NUMBER _____

Note: Reference the separately supplied engine manufacturer's maintenance and operator manual for more detailed engine specification and service data.

UN-CRATING

Upon delivery, carefully inspect the shipping crate and the machine for damage. If damage is evident, save all parts of the shipping crate so that they can be inspected by the trucking company that delivered the machine. Contact the trucking company immediately to file a freight damage claim.



FIGURE 1

YOUR 7765/7760 MACHINE HAS BEEN SHIPPED COMPLETE, BUT DO NOT ATTEMPT TO OPERATE WITHOUT FOLLOWING THESE INSTRUCTIONS.

PREPARING THE MACHINE FOR OPERATION

1. Connect and tighten battery cables.
2. Fill the tank with REGULAR GRADE unleaded gasoline; Diesel fuel if equipped with diesel engine.

⚠ WARNING

Never fill tank while engine is running. Always be sure fuel container and sweeper are electrically connected before pouring fuel. This can easily be done by permanently attaching one end of an insulated wire to the container with battery clip on the opposite end.

3. Check engine crankcase oil level. Although properly lubricated at factory, check before starting engine. No special brand oil is used. Recommended number of operating hours before the initial oil change is the same as normal. See Maintenance.
4. Check radiator coolant level. Permanent type antifreeze is added at the factory to provide protection to approximately -35° F (37° C). To retain this protection level, always mix 1 part water to 1 part antifreeze.
5. Check oil level in the hydraulic reservoir located at center of machine beside the engine. Oil fill level should be two (2) inches (5 cm.) below filler neck assembly. If oil is required, add HYDRAULIC FLUID ONLY, automatic transmission fluid FORD type "F". After the first 50 operating hours, service must be performed on your engine to insure future high performance and trouble-free operation. See Maintenance.

CAUTIONS AND WARNINGS

SYMBOLS

American-Lincoln™ - Alto uses the symbols below to signal potentially dangerous conditions. Always read this information carefully and take the necessary steps to protect personnel and property.

DANGER!

Is used to warn of immediate hazards that will cause severe personal injury or death.

WARNING!

Is used to call attention to a situation that could cause severe personal injury.

CAUTION!

Is used to call attention to a situation that could cause minor personal injury or damage to the machine or other property.



Read all instructions before using.

GENERAL SAFETY INSTRUCTIONS

Specific Cautions and Warnings are included to warn you of potential danger of machine damage or bodily harm.

DANGER!

- This machine emits exhaust gases (carbon monoxide) that can cause serious injury or death, always provide adequate ventilation when using machine.

WARNING!

- This machine shall be used only by properly trained and authorized persons.
- While on ramps or inclines, avoid sudden stops when loaded. Avoid abrupt sharp turns. Use low speed down hills. Clean only while ascending (driving up) the ramp.
- To avoid hydraulic oil injection or injury always wear appropriate clothing and eye protection when working with or near hydraulic system.
- Turn the key switch off (O) and disconnect the batteries before servicing electrical components.
- Never work under a machine without safety blocks or stands to support the machine.
- Do not dispense flammable cleaning agents, operate the machine on or near these agents, or operate in areas where flammable liquids exist.
- Do not clean this machine with a pressure washer.

CAUTION!

- This machine is not approved for use on public paths or roads.
- This machine is not suitable for picking up hazardous dust.
- Use care when using scarifier discs and grinding stones. American-Lincoln™ - Alto will not be held responsible for any damage to floor surfaces caused by scarifiers or grinding stones.
- When operating this machine, ensure that third parties, particularly children, are not endangered.
- Before performing any service function, carefully read all instructions pertaining to that function.
- Do not leave the machine unattended without first turning the key switch off (O), removing the key and applying the parking brake.
- Turn the key switch off (O) before changing the brushes, and before opening any access panels.
- Take precautions to prevent hair, jewelry, or loose clothing from becoming caught in moving parts.
- Use caution when moving this machine in below freezing temperature conditions. Any water in the solution or recovery tanks or in the hose lines could freeze.
- Before use, all doors and hoods should be properly latched.

SAVE THESE INSTRUCTIONS

CONSIGNES DE PRUDENCE ET DE SECURITE

SYMBOLES

American-Lincoln™ - Alto utilise les symboles reproduits ci-dessous pour attirer l'attention de l'opérateur sur des situations potentiellement dangereuses. Il est donc conseillé de lire attentivement ces indications et de prendre les mesures adéquates en vue de protéger le personnel et le matériel.

DANGER !

Ce symbole est utilisé pour mettre l'opérateur en garde contre les risques immédiats pouvant provoquer des dommages corporels graves, voire entraîner la mort.

ATTENTION !

Ce symbole est utilisé pour attirer l'attention sur une situation susceptible d'entraîner des dommages corporels graves.

PRUDENCE !

Ce symbole est utilisé pour attirer l'attention de l'opérateur sur une situation qui pourrait entraîner des dommages corporels minimes ou des dommages à la machine ou à d'autres équipements.

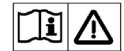

Lire toutes les instructions avant d'utiliser l'appareil.

CONSIGNES GENERALES DE SECURITE

Les consignes spécifiques de prudence et de sécurité mentionnées ici ont pour but de vous informer de la survenance de tout risque de dommages matériels ou corporels.

DANGER !

- Les gaz d'échappement (monoxyde de carbone) évacués par la machine peuvent entraîner de graves dommages corporels, voire la mort. Veillez donc toujours à bénéficier d'une ventilation suffisante lorsque vous utilisez la machine.

ATTENTION !

- Cette machine ne pourra être utilisée que par du personnel parfaitement entraîné et dûment autorisé.
- Evitez les arrêts subits lorsque la machine est chargée et se trouve sur des rampes ou des plans inclinés. Evitez les virages serrés. Adoptez une vitesse réduite lorsque la machine est en descente. Ne nettoyez que lorsque la machine monte la pente.
- Lorsque vous utilisez le système hydraulique ou travaillez à proximité de celui-ci, veillez à porter une tenue appropriée et des lunettes de protection afin d'éviter tout risque de blessures ou toute projection d'huile.
- Positionnez la clé de contact sur off (O) et déconnectez les batteries avant de procéder à l'entretien des composants électriques.
- Ne travaillez jamais sous une machine sans y avoir placé, au préalable, des blocs de sécurité ou des étais destinés à soutenir la machine
- Ne déversez pas d'agents nettoyants inflammables, ne faites pas fonctionner la machine à proximité de ces agents ou d'autres liquides inflammables.
- Ne nettoyez pas cette machine avec un nettoyeur à pression.

PRUDENCE !

- Cette machine n'est pas conçue pour une utilisation sur les chemins ou voies publiques.
- Cette machine n'est pas conçue pour le ramassage des poussières dangereuses.
- Faites extrêmement attention lorsque vous utilisez des disques de scarificateur et des meules. American-Lincoln™ - Alto ne pourra, en aucun cas, être tenu pour responsable des dommages occasionnés à vos sols par ce type d'équipement.
- Lors de l'utilisation de cette machine, assurez-vous que des tiers, et notamment des enfants, ne courent pas le moindre risque.
- Avant de procéder à toute opération d'entretien, veuillez lire attentivement toutes les instructions qui s'y rapportent.
- Ne laissez pas la machine sans surveillance sans avoir, au préalable, coupé le contact, enlevé la clé de contact (O) et tiré le frein à main.
- Positionnez la clé de contact sur off (O) avant de remplacer les brosses ou d'ouvrir tout panneau d'accès.
- Prenez toutes les mesures nécessaires pour éviter que les cheveux, les bijoux ou les vêtements amples ne soient entraînés dans les parties mobiles de la machine.
- Faites attention lorsque vous déplacez cette machine dans un endroit où la température peut descendre sous 0°. Car l'eau contenue dans la solution, dans les réservoirs de récupération ou dans les conduites risquerait de geler.
- Avant utilisation, toutes les portes et capots doivent être correctement fermés.

CONSERVEZ SOIGNEUSEMENT CES INSTRUCTIONS

OPERATIONS OF CONTROLS AND GAUGES

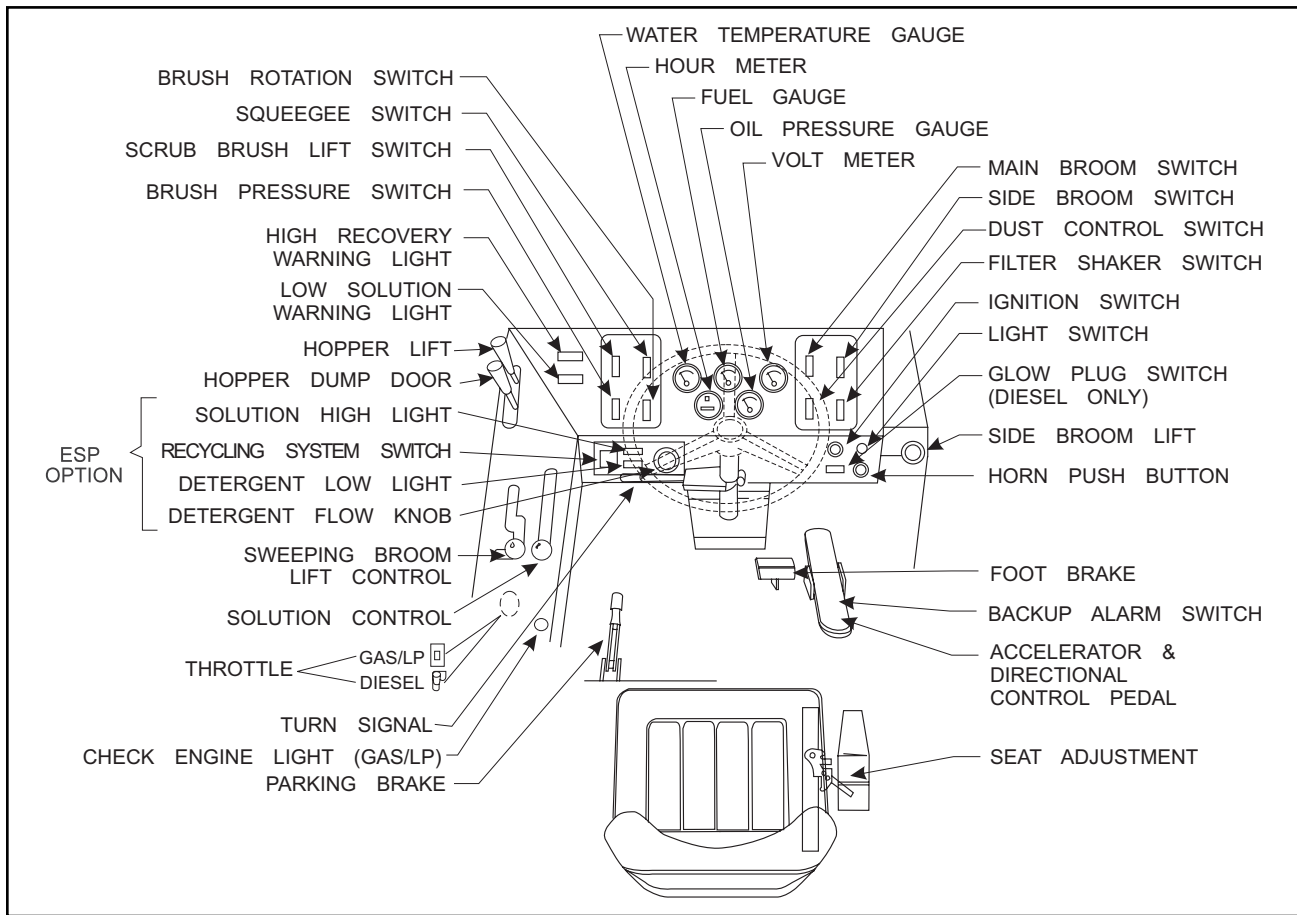

P-5101ecp

FIGURE 2

IGNITION SWITCH

The keyed ignition switch is located to the right of the steering column on the front face of the instrument console. It has four positions.

1. The key turned to the center "OFF" position will shut off the engine. The following items can be activated in the "OFF" position.
 - (A.) Horn
 - (B.) Light Options
2. The key turned to the right "IGN/ON" position will allow all the following items to be activated (but will NOT start the engine):
 - (A) Horn
 - (B) Light Options
 - (C) Turn Signals
 - (D) Instrument Panel Gauges
3. The key turned to the far right "START" position will start the engine. This position is a momentary position. The key will revert to the "IGN/ON" position when it is released.

LIGHT SWITCH

The light switch is located above the horn button to the right of the steering wheel. It will work various light options that are available for this machine, such as:

- * HEAD LIGHTS
- * TAIL LIGHTS
- * INSTRUMENT LIGHTS

All gauges, with the exception of the hour meter, can have an optional internal instrument light.

4-WAY TURN SIGNAL (Option)

The turn signal option is located on the steering column and works as automotive turn signals work, forward on the lever for right and back on the lever for left. The 4-way flasher will activate when the turn signal lever is pulled out.

GLOW PLUG SWITCH (Diesel)

Under no circumstances should any other unauthorized starting aids be used at the same time as Glow Plugs. The Glow Plug Switch is located to the right of the steering column on the front face of the instrument console. Use the following procedure to operate:

1. Before operating the starter motor, press the "GLOW PLUG" button for 20 to 30 seconds.
2. With the "GLOW PLUG" button still depressed, engage the starter motor until the engine starts.
3. Continue to press the "GLOW PLUG" button for a few seconds after the engine has started until even running has been obtained.
4. If the engine does not start, disengage the starter motor, but keep the "GLOW PLUG" button depressed for an additional 10 to 15 seconds. Keep the Glow Plugs energized while starting the engine and for a few seconds after the engine has been running smoothly.

HORN PUSH BUTTON

The horn button is located to the right of the steering column on the front face of instrument console. The horn button is always active. Push the horn button to sound the horn.

SIDE BROOM LIFT (OPTIONAL FOR MANUAL DUMP)

The Side Broom Lift Lever is located to the right of the instrument console. The handle pulled back and turned to the right will raise the side broom and lock it into position.

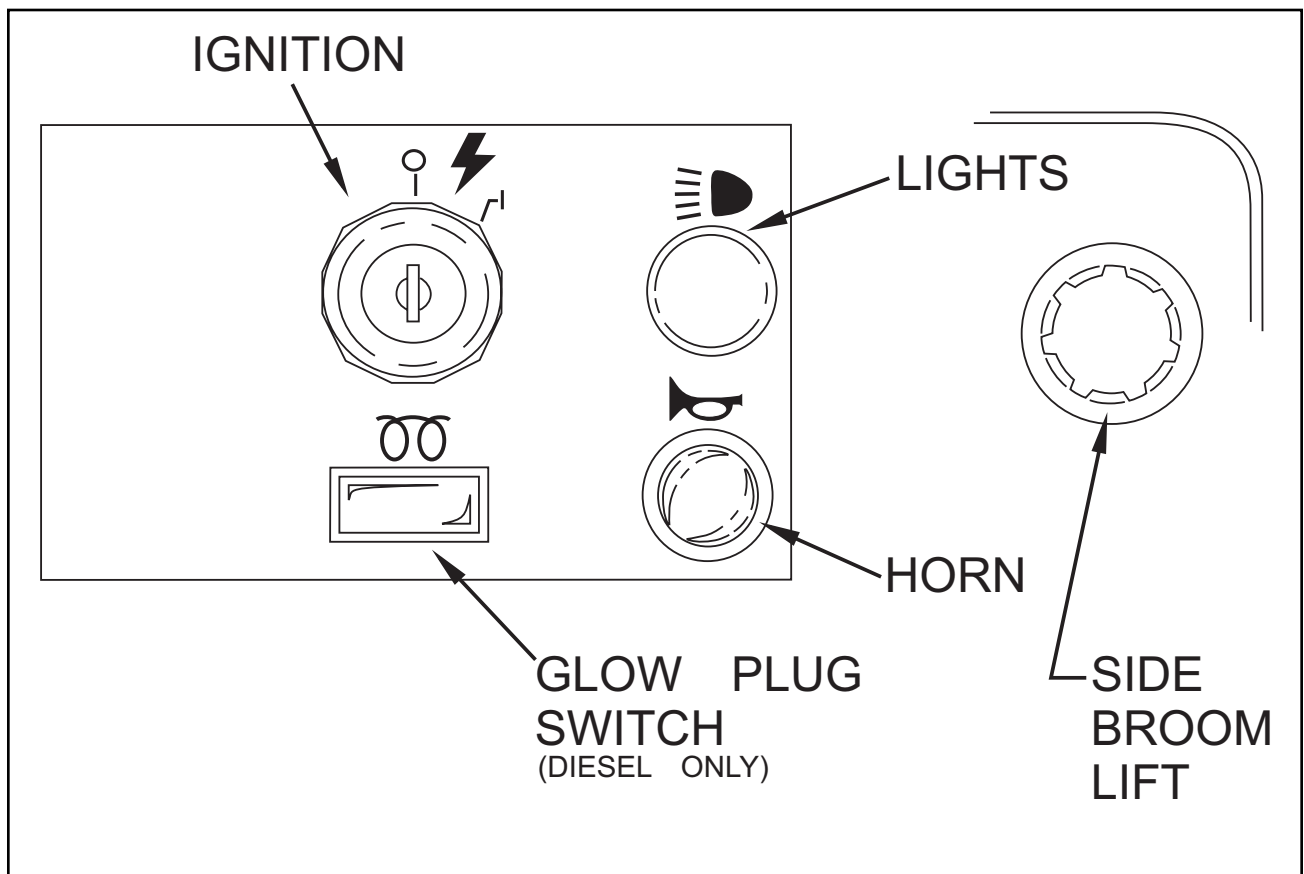

P-4853ecp

FIGURE 3

OPERATIONS OF CONTROLS AND GAUGES

MAIN BROOM SWITCH

The Main Broom Switch is located on the console to the right of the steering wheel in the SWEEPING section. This switch will activate the Main Broom. This switch has two positions "ON" and "OFF". See Sweeping Broom Lift Control.

SIDE BROOM SWITCH (Option For Manual Dump Machines)

The Side Broom Switch is located on the console to the right of the steering wheel in the SWEEPING section. This switch will activate the Side Broom. This switch has two positions "ON" and "OFF". See Side Broom Lift Control.

DUST CONTROL SWITCH (Wet Sweep Bypass Option - Option for Manual Dump Machine)

The Dust Control Switch is located on the console to the right of the steering wheel in the SWEEPING section. This switch will activate the dust control system.

FILTER SHAKER SWITCH (Variable Dump Machines Only)

The Filter Shaker Switch is located on the console to the right of the steering wheel in the SWEEPING section.

NOTE - (Variable Dump Machines Only)

THE MAIN BROOM SWITCH MUST ALWAYS BE PLACED IN THE OFF POSITION BEFORE SHAKING THE FILTER. FAILURE TO DO SO WILL RESULT IN DUST REMAINING ON THE SURFACE OF THE FILTER ENVELOPES INSTEAD OF DROPPING INTO THE HOPPER.

The button can be used when the ignition key is in the "ignition" position. The filter shaker control button is used during the sweeping cycle and the hopper unloading cycle. Use the filter shaker control switch to remove dust from the filter. Use the following procedures to operate the filter shaker control switch:

1. After the machine has made a long sweeping run, turn the broom switch to the "OFF" position.
2. Push the filter shaker control switch for 5 to 15 seconds to allow the filter to unload.

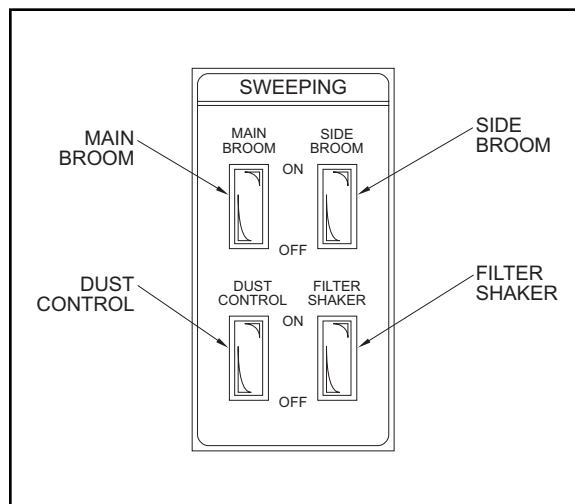

P-4862

FIGURE 4

3. Turn the broom switch to the "ON" position. Repeat this procedure after each long sweeping run.

NOTE - (Variable Dump Machines Only)

The main broom, side broom, dust control and filter shaker turn off automatically when the hopper is dumping and/or the dump door is in a closed position. SEE HOPPER LIFT and HOPPER DUMP DOOR.

WATER TEMPERATURE GAUGE

The Water Temperature Gauge is located on the console panel above the steering wheel in the gauge cluster. The gauge is mechanical and activated by a sender in the engine. It displays the engine coolant temperature in Fahrenheit.

HOUR METER

The Hour Meter is located on the console panel above the steering wheel in the gauge cluster. This meter is activated when the engine begins running. The meter indicates actual "run" time of the machine. The meter can be used to determine machine maintenance intervals.

FUEL GAUGE

The Fuel Gauge is located on the console panel above the steering wheel in the gauge cluster. This gauge indicates the level of fuel contained in the fuel tank.

OIL PRESSURE GAUGE

The Oil Pressure Gauge is located on the console panel above the steering wheel in the gauge cluster. The gauge is mechanical and activated by a sender in the engine. It displays the engine oil pressure in PSI.

VOLT METER

The Volt Meter is located on the console panel above the steering wheel in the gauge cluster. The gauge indicates the charge level of the battery.

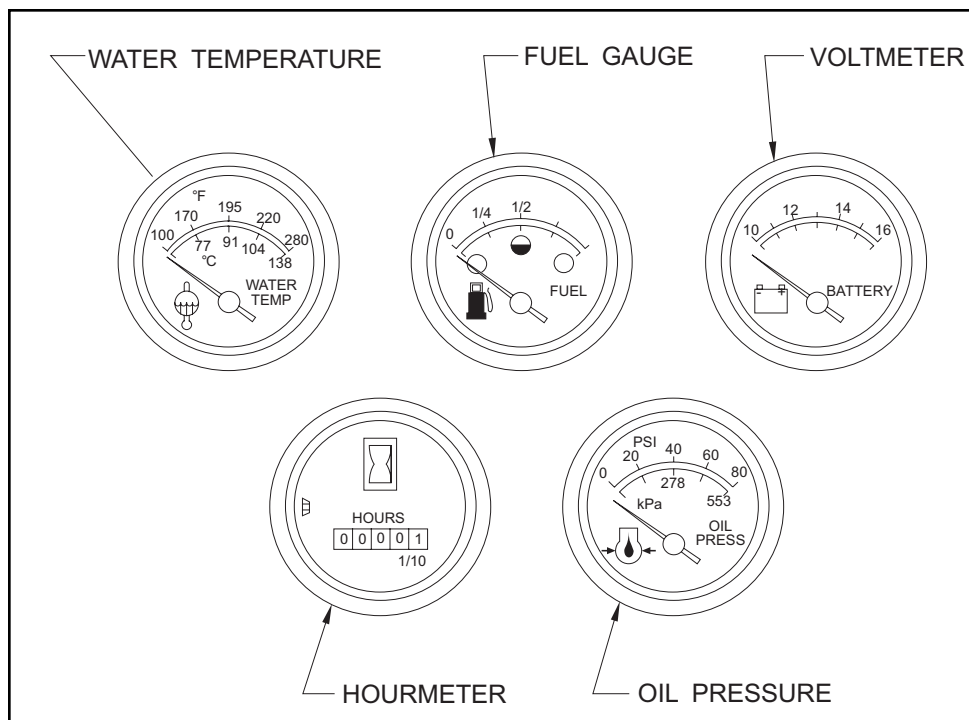

P-4865

FIGURE 5

SCRUB BRUSHES SWITCH

The Brushes Switch is located on the console to the left of the steering wheel in the "SCRUBBING" section. This switch in the position marked "LOWER" will lower the scrub brush deck and activate the three scrub brushes. The Brush Rotation Switch and the Brush Pressure Switch can not be activated unless this switch is in the "LOWER" position. This switch in the "RAISE" position will stop the brushes from rotating and raise the scrub brush deck.

OPERATIONS OF CONTROLS AND GAUGES

BRUSH ROTATION SWITCH

The Brush Rotation Switch is located on the console to the left of the steering wheel in the "SCRUBBING" section. This switch reverses the rotation of the scrub brushes. This switch has two positions, "NORMAL" and "REVERSED". This switch can not be activated unless the Scrub Brush Lift Switch is in the "LOWER" position. The switch will light when activated.

BRUSH PRESSURE SWITCH

The Brush Pressure Switch is located on the console to the left of the steering wheel in the "SCRUBBING" section. This switch applies additional downward pressure to the scrub brushes. This switch has two positions, "NORMAL" and "HEAVY". This switch can not be activated unless the Scrub Brush Lift Switch is in the "LOWER" position. The switch will light when the switch can be activated.

SQUEEGEE BLADE SWITCH

The Squeegee Blade Switch is located on the console to the left of the steering wheel in the "SCRUBBING" section. This switch in the position marked "LOWER" will lower the squeegee and activate the squeegee vacuum. This switch in the "RAISE" position will stop the squeegee vacuum and raise the squeegee. A switch activated by the forward-reverse foot pedal will automatically raise the squeegee if it is in the lowered position and the machine is in reverse.

HIGH RECOVERY WARNING LIGHT

The High Recovery Warning Light is located on the console to the left of the steering wheel beside the "SCRUBBING" section. The recovery warning light will illuminate approximately 5 minutes before the recovery tank is full, giving ample time to complete the scrubbing cycle before the mechanical float shuts off the vacuum to the recovery tank.

LOW SOLUTION WARNING LIGHT

The Low Solution Warning Light is located on the console to the left of the steering wheel beside the "SCRUBBING" section. The Solution Warning Light will illuminate when the solution tank is empty, marking the end of the scrubbing cycle.

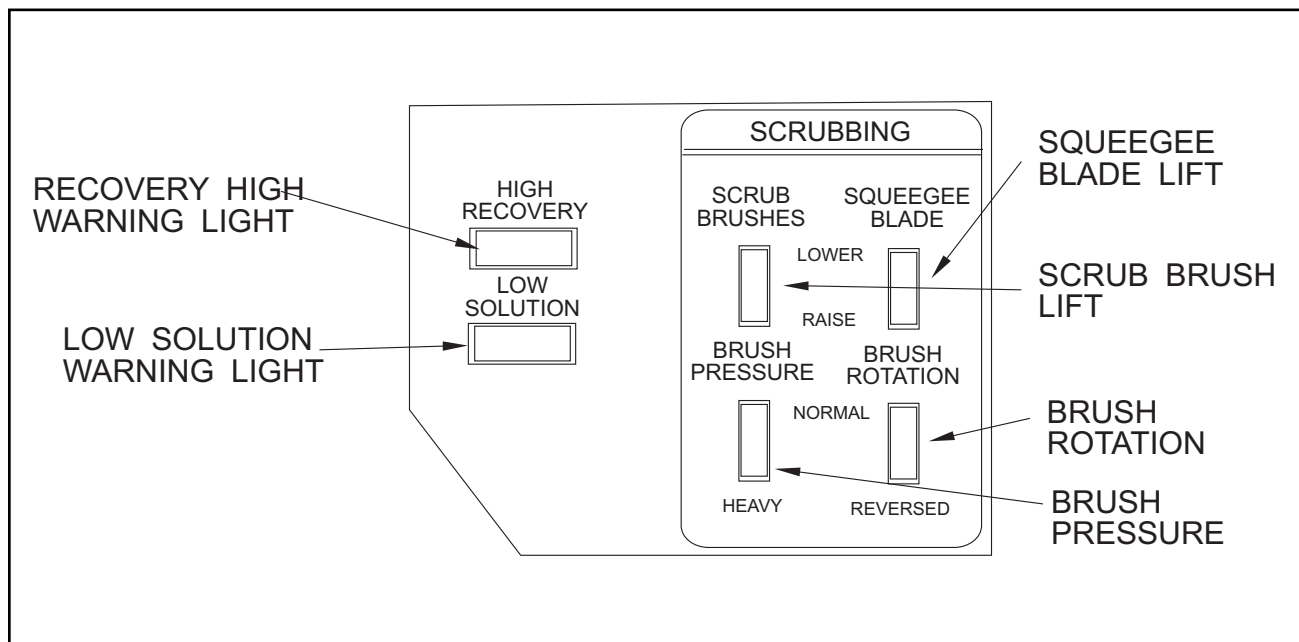

P-4854

FIGURE 6

HOPPER LIFT - (Variable Machines Only)

The Hopper Lift Lever is located to the left of the steering wheel on the left side of the driver compartment. This lever, which is marked "HOPPER", raises and lowers the debris hopper to ease unloading.

⚠ WARNING

The hopper may drop unexpectedly and cause injury, always engage the safety arm before working under the hopper.

HOPPER SAFETY LOCK ARM (Variable Dump Only)

⚠ WARNING

When the hopper is raised the safety arm must be engaged before any work is done under the hopper

The Hopper Safety Lock Arm is located under the hopper assembly. After the work is complete, the safety arm must be disengaged.

HOPPER DUMP DOOR - (Variable Dump Machines Only)

The Hopper Dump Door Lever is located to the left of the steering wheel on the left of the driver compartment. This lever opens and closes the hopper door. This lever is located below the Hopper Lift Door and is marked "DUMP DOOR".

MANUAL DUMP HOPPER - (Manual Dump Hopper Only)

The Manual Dump Hopper Lever is located under the front bumper. To dump debris, pull the manual dump lever all the way to the position marked open. Leave the handle in the dump position and back the machine off the pile of debris. When clear of the debris, pull the manual dump lever to the position marked closed.

SOLUTION CONTROL

To apply solution to the scrubbing brushes, push the solution control lever forward until the desired setting is reached. The solution rate is continuously variable from off to approximately 1-3/4 GPM at low and 3-1/2 GPM at high. To stop application of solution, pull back on the lever until it stops at the "off" position. The solution warning light will illuminate when the solution tank is empty, marking the end of the scrubbing cycle.

NOTE

For best results, discontinue application of solution 10 feet before stopping or making a 90° or 180° turn.

SWEEPING BROOM LIFT CONTROL

The main broom lift control is located to the left of the driver seat. To lower the main broom, grasp the lever and pull back to clear the locking notch. Move the lever forward to the first or second notch in the elongated slot. The first notch, "SWEEP", is for normal sweeping (2 to 3 inch [5 to 8 cm.] broom pattern). The second notch, "FLOAT", is for heavy sweeping (4 to 5 inch [10 to 13 cm.] broom pattern).

To raise the main broom, pull the lever back and slide into the locking notch. You may operate the main broom in either the "SWEEP" or "FLOAT" position. However, the "SWEEP" position should be used for normal sweeping and will result in increased broom life. The "FLOAT" position should be used only when sweeping extremely uneven areas.

NOTE - (Variable Dump Machines Only)

A switch triggered by the hopper and dump door position controls the sweeping functions, main broom, side broom, dust control, and filter shaker. The hopper must be down and the dump door open before these functions will work.

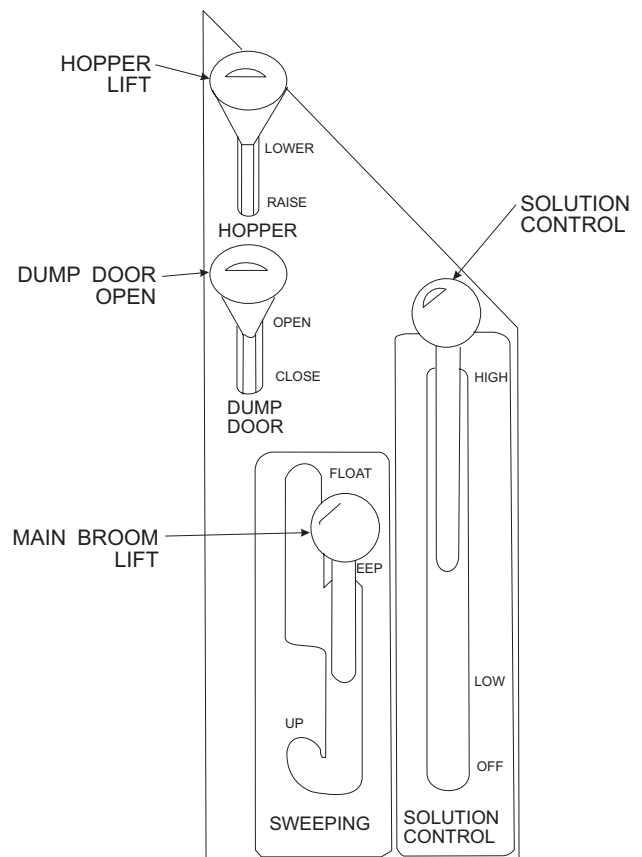

P-4851

FIGURE 7

OPERATIONS OF CONTROLS AND GAUGES

THROTTLE CONTROL

The throttle control is located on the left side console. Gas and LP equipment have a throttle switch. Diesel versions have a lever. To operate the diesel: For full throttle, grasp the lever and push up and right to the locking notch. To reduce to idle, grasp the lever and push it up and to the left (away from the locking notch). Let the lever lower until it rests at the bottom of the slot. "Load" (brooms and/or brushes and/or dust control operating) and "No Load" (brooms, brushes & dust control off) RPMs are the same for gas and LP equipment; There will be a slight drop between "Load" and "No Load" RPMs with diesels. Always return the throttle switch/lever to the idle position before turning off the key to stop the engine.

MACHINE		RPMs	
		IDLE	"NO LOAD"
SWEEPER/ SCRUBBER (1 speed)	Gas/LP	950	2050
	Diesel	950	2150
SWEEPER (2 speed levels)	Gas/LP	1st	950
		2nd	950
	Diesel	1st	950
		2nd	950
			2050
			2450
			2150
			2550

CHECK ENGINE LIGHT (MIL) - Gas, LP Only

The check engine light (MIL) is located on the left side console. If the light comes on, it indicates a problem with the engine. Go to the GM Engine Service Manual, Section 7, for directions on how to diagnose the problem.

PARKING BRAKE

The parking brake lever is located in the left side of the driver compartment floor. This lever, when raised to the upright position, will "lock" the foot brake pedal in the down position.

FOOT BRAKE

The foot brake pedal is located to the right of the steering column on the floor of the driver compartment. The foot brake on the front wheels is a mechanical system actuated by the brake pedal.

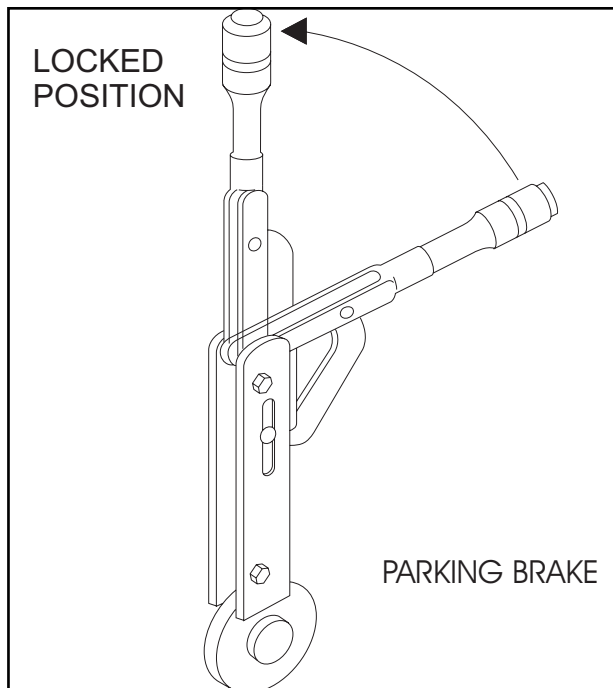

P-4888

FIGURE 8

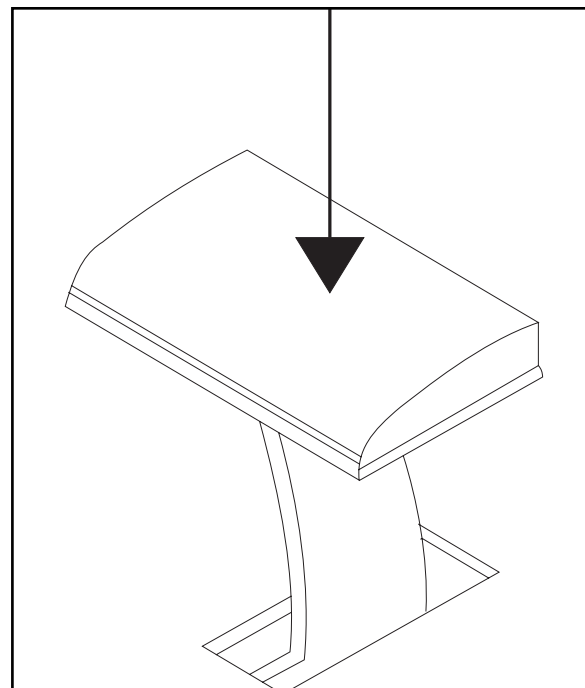

P-4887

FIGURE 9

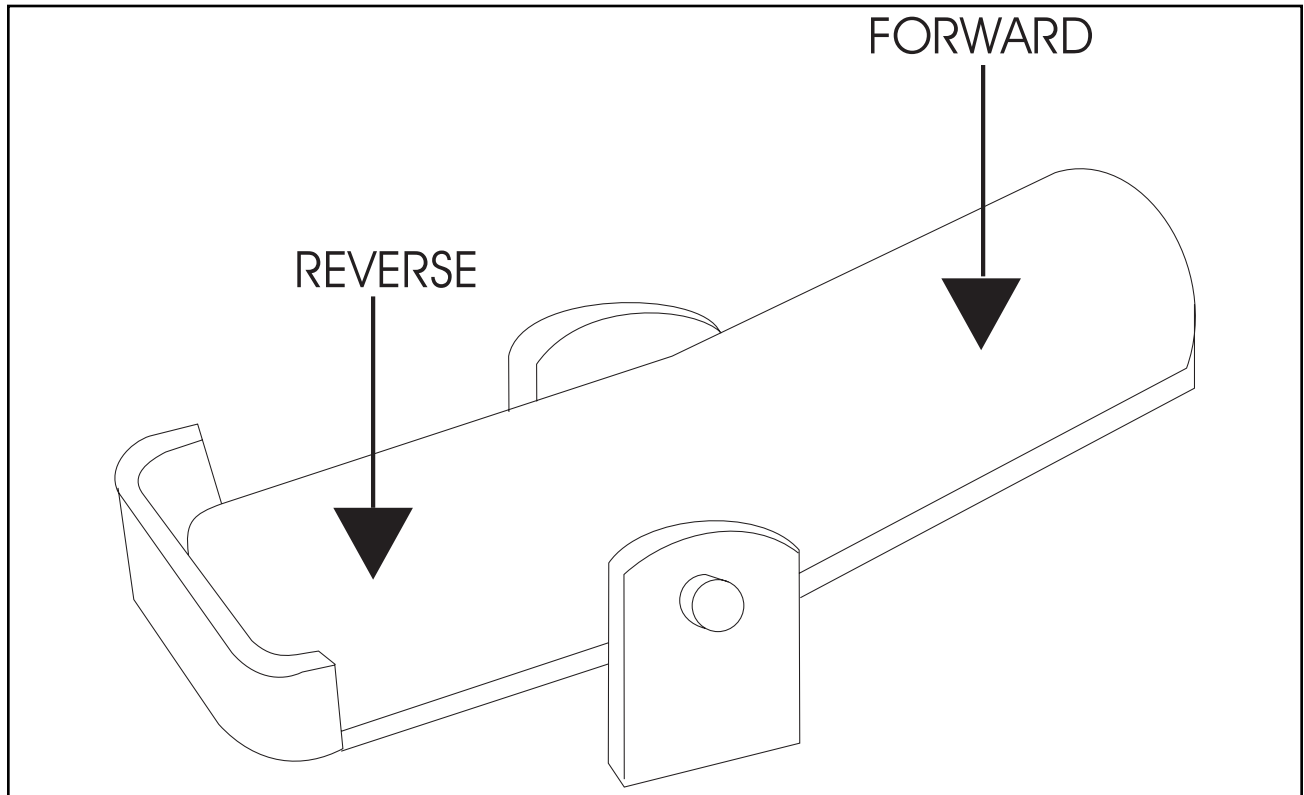

P-4690

FIGURE 10

ACCELERATOR & DIRECTIONAL CONTROL PEDAL

The accelerator and directional control pedal is located on the floor of the driver compartment, to the right of the brake pedal. The accelerator and directional control pedal controls machine direction and travel speed.

1. Put foot pressure on the upper portion of the pedal. The machine will move forward.
2. Increase the foot pressure on the upper portion of the pedal to increase the forward speed.
3. Put foot pressure on the lower portion of the pedal. The machine will move in reverse.
4. Increase the foot pressure on the lower portion of the pedal to increase the reverse speed.
5. To stop the machine, put light foot pressure on the opposite end of the accelerator and directional control pedal. If the machine is moving forward put light foot pressure on the lower portion of the pedal. If the machine is moving in reverse put light foot pressure on the upper portion of the pedal.

BACKUP ALARM SWITCH

This switch is located under the lower section of the accelerator and directional control pedal and operates the backup alarm. The alarm makes a loud audible noise when the machine is being driven in reverse.

SEAT ADJUSTMENT

This lever is located on the right of the seat. This lever allows the seat to be adjusted forward or back when the lever is moved.

SCRUBBING SYSTEM OPERATING INSTRUCTIONS

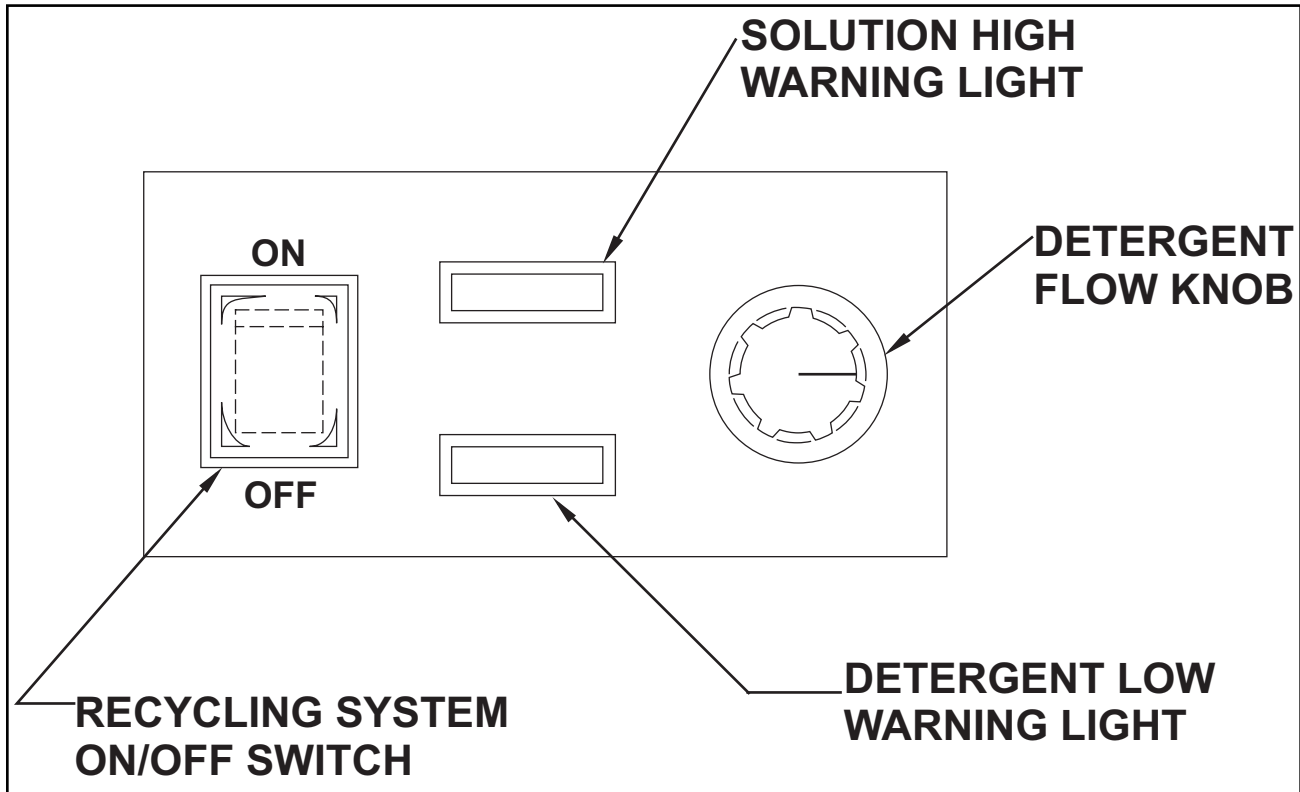

P-4895

FIGURE 11

THE ESP RECYCLING CONTROL PANEL

THE ESP RECYCLING SYSTEM ON/OFF SWITCH

This switch turns the ESP recycling system on and off.

SOLUTION HIGH WARNING LIGHT

The solution high warning light will come on if the solution tank is too full of water from the recycling system.

DETERGENT LOW WARNING LIGHT

The detergent light will illuminate when the detergent tank is low, warning the operator to add detergent.

DETERGENT FLOW KNOB

This rotary knob controls the detergent flow into the scrubbing solution. The operator may choose from any detergent setting, for light to heavy cleaning applications. The detergent light will illuminate when the detergent tank is low, warning the operator to add detergent.

SCRUBBING SYSTEM OPERATING INSTRUCTIONS

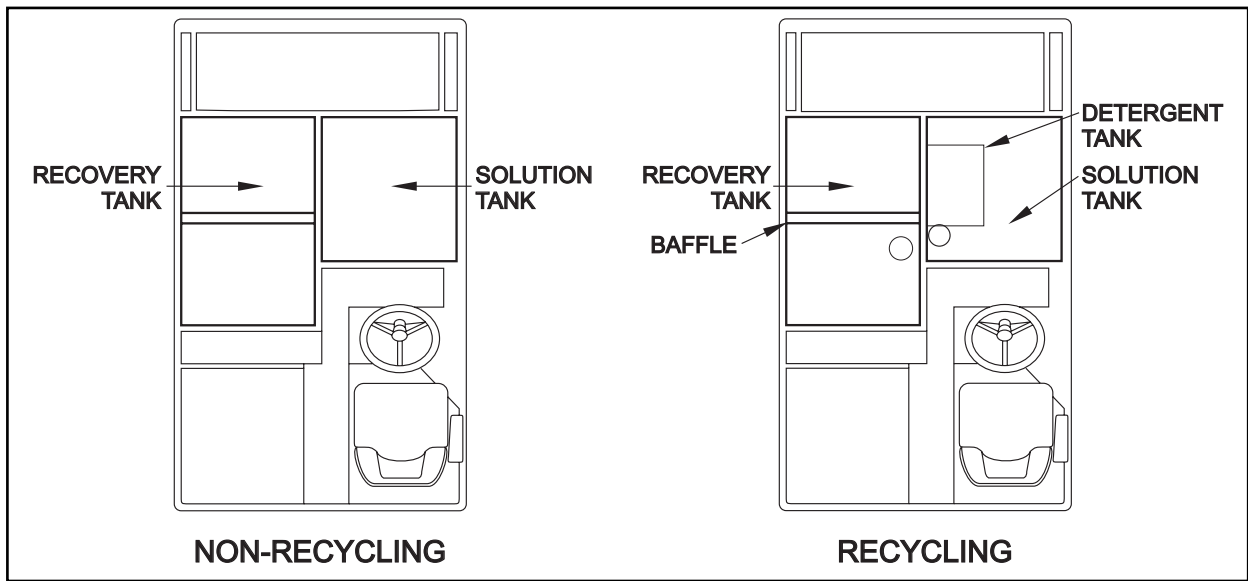

P-4795

FIGURE 13

THE SCRUBBING SYSTEM - HOW IT WORKS

There are two scrubbing systems available for the 7765/7760 machine, the non-recycling or standard scrubbing system and the recycling or ESP scrubbing system.

THE NON-RECYCLING OR STANDARD SCRUBBING SYSTEM - HOW IT WORKS

During the scrubbing process (shown in Figure 14), detergent solution water from the solution tank is fed to the solution line. There it is fed to the floor where three disc scrubbing brushes work to dislodge soil.

After scrubbing, the dirty solution is vacuumed from the floor and discharged into the containment chamber in the forward portion of the recovery tank, where a system of baffles helps to clarify the solution. Sensors in each tank will indicate by lights on the control panel when the water in the solution tank is too low or when the water in the recovery tank is too high.

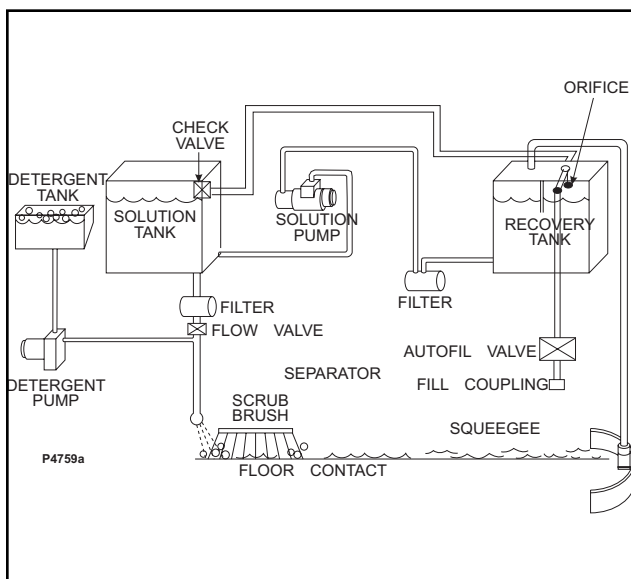

P-4759a

FIGURE 14

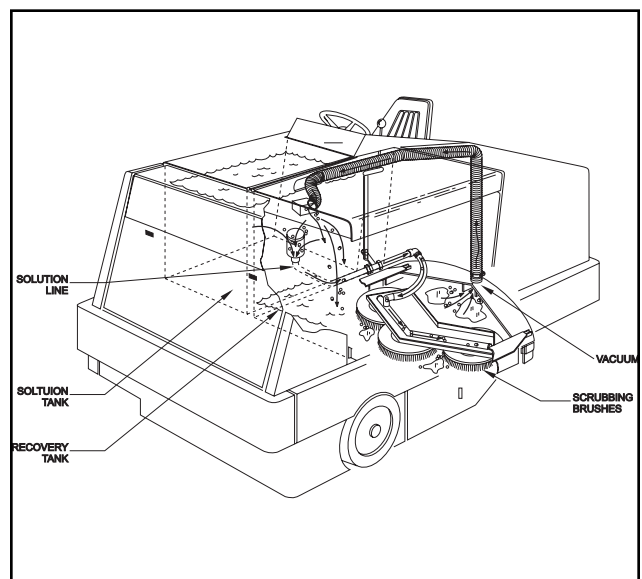

P-5103

FIGURE 15

SCRUBBING SYSTEM OPERATING INSTRUCTIONS

THE RECOVERY OR ESP SCRUBBING SYSTEM - HOW IT WORKS

During the scrubbing process (shown in Figure 16), filtered water from the solution tank is fed to the solution line, where it combines with detergent from the metering pump. This mixture is then fed to the floor where three disc scrubbing brushes work to dislodge soil.

After scrubbing, the dirty solution is vacuumed from the floor and discharged into the containment chamber in the forward portion of the recovery tank, where a system of baffles helps to clarify the solution on its way to the pumping chamber in the rear of the recovery tank. At intervals, a system of sensors activates the recycling pump, which sends filtered solution from the pumping chamber on its way to the solution tank. Here, it is ready to be mixed with fresh, metered detergent and repeat the cycle.

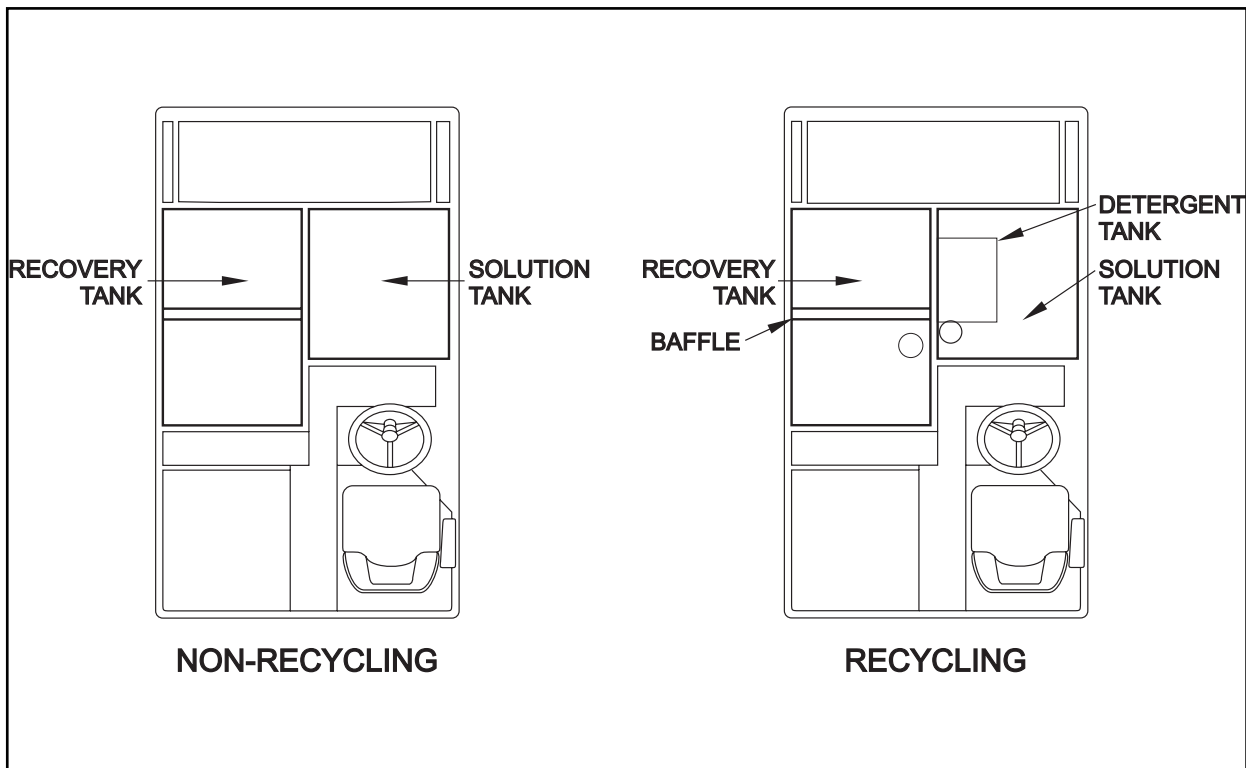

P-4795-1

FIGURE 16

DUST CONTROL OPERATING INSTRUCTIONS

THE VARIABLE DUMP SWEEPING AND DUST CONTROL SYSTEMS - HOW THEY WORK

Variable Dump 7765/7760 machines are equipped with a sweeping and dust control system. Figure 18 shows the highest position for the variable dump.

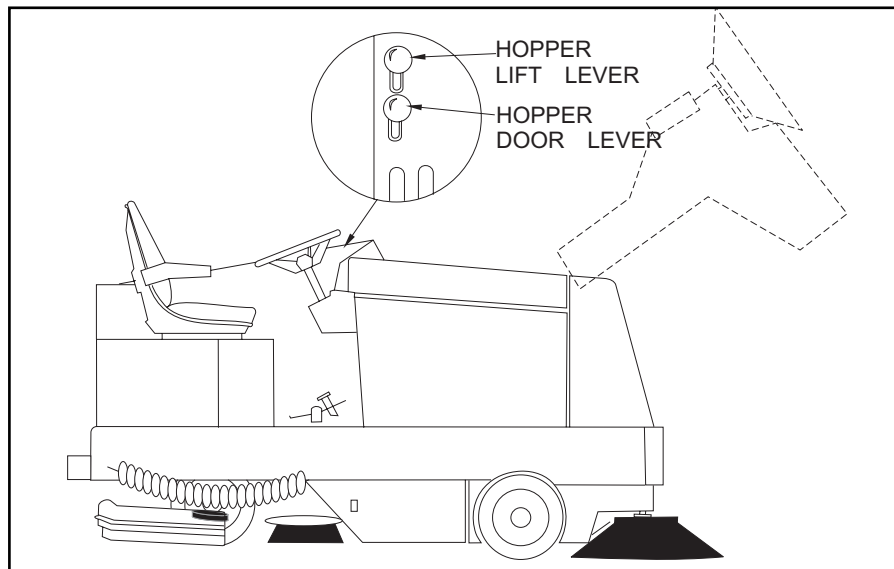

P-5104

FIGURE 18

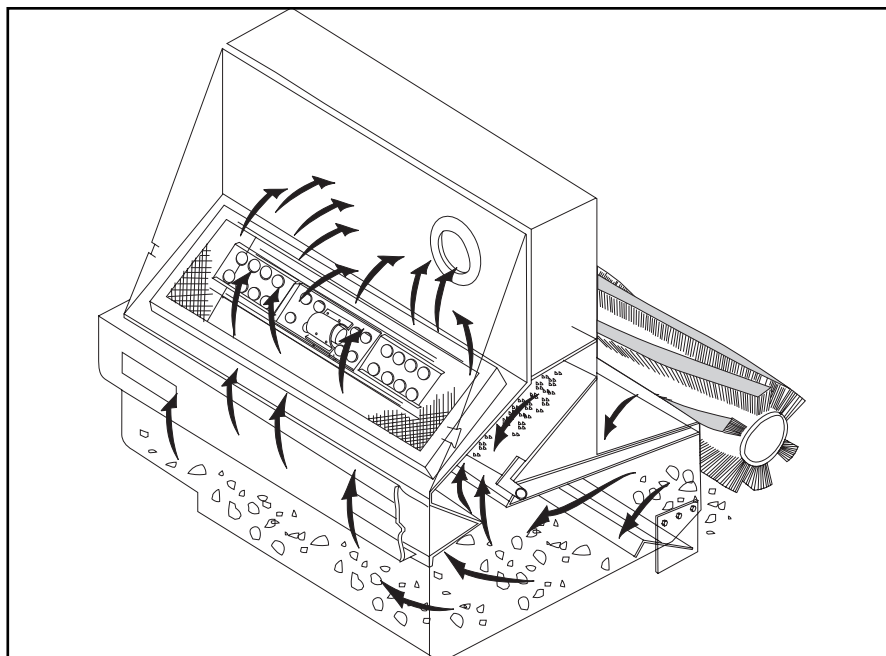

P-5105

FIGURE 19

The debris from sweeping is thrown into the hopper (Figure 19). The baffle system that is built into the variable dump debris hopper is designed to minimize dust in the air while the machine is sweeping. The impeller vacuum fan pulls the lighter dust up and through a baffle system. The Pre-Clean Flap separates the heavier dust particles to an area below the filters. The dust filters capture the lighter dust particles. This allows the dust filters to remain cleaner and need less shaking to remove dust. When the dust filters become clogged the filter shaker switch should be pushed to start the dust shaker cycle. This will extend the life of the filters.

NOTE
TURN MAIN BROOM OFF FIRST

OPERATING INSTRUCTIONS

FILLING THE SOLUTION TANK

NON-RECYCLING or Standard Scrubbing System

1. Make sure the solution control lever is in the "Off" (rear) position.
2. Open the solution tank cover (right hand side).
3. Fill the tank with 100 gallons of water and the correct mixture of American-Lincoln #100 Industrial Cleaner for the job.
4. Close the solution tank cover.

RECYCLING or ESP System

1. Make sure the solution control lever is in the "Off" (rear) position.
2. Open the solution tank cover (right hand side).
3. Fill the solution tank as outlined above with 100 gallons of pure water.
4. Fill the detergent tank with 5 gallons of American-Lincoln #100 Industrial Cleaner.
5. Close the solution tank cover.

NOTE

Fill recovery tank halfway with water for the ESP system



WARNING

To prevent over-sudsing and machine damage,
use only AMERICAN-LINCOLN Industrial Cleaning Solution #100.



WARNING

DO NOT put gasoline, combustible or other flammable material
in the solution, recovery or detergent tanks.

NOTE

Before starting the engine, perform the pre-start checklist.

PRE-START CHECKLIST

1. Clean engine air filter element if needed
2. Check engine oil level
3. Check radiator coolant level
4. Check hydraulic fluid level
5. Check fuel level
6. Check all systems for leaks
7. Check brakes and controls for proper operation

BEFORE STARTING ENGINE

1. Set parking brake
2. Make sure all controls are in the "Off" position

TO START ENGINE

1. Be sure accelerator and directional control pedal is in neutral.
2. Turn key to "On" position and hold it until the engine starts.
3. If engine fails to start after following the above procedures, refer to Engine Manual.



WARNING

The manufacturer does not advise storing the machine in below-freezing temperatures unless all fluids have been drained from the detergent, solution and recovery tanks and associated systems. When machine has been stored in below-freezing temperatures, run engine at lowest possible settings and let machine sit 5-10 minutes to warm engine and hydraulic oil.

POST-START CHECKLIST (Engine Running)

1. Check main and side brooms to make sure they are free of debris which will inhibit rotation & pick-up.
NOTE: Always wear hand protection when cleaning debris from brooms and/or brushes.
2. Check squeegees to make sure there is no damage and they meet the floor.

TO TRANSPORT MACHINE (No scrubbing or sweeping)

1. Be sure the brooms, brushes (scrub deck) and squeegee are in the "Up" position with all other controls in the "Off" position.
2. Release parking brake.
3. Push throttle control up.
4. Push forward on the directional control pedal to place the machine in motion.
5. Vary your foot pressure on the directional control pedal to obtain desired travel speed.
6. To stop, allow directional control pedal to return to neutral (centered) position. (Pedal will automatically return to neutral when foot pressure is released). FOR NORMAL OPERATION, DEPRESS DIRECTIONAL CONTROL PEDAL WITH HEEL INTO NEUTRAL.
7. Push engine throttle down. Turn key to "Off".
8. Set parking brake.

TO BEGIN THE CLEANING OPERATION

1. Choose the mode of operation (recycling ESP or non-recycling STANDARD) as dictated by the machine fill or machine type.
2. Bring engine to full RPM.
3. Lower the main broom.
4. Lower the side broom.
5. Turn on the main and side brooms.
6. Sweep for the length of the machine.
7. Move recovery switch to the "On" position.
8. Lower the scrub brushes.
9. Lower squeegee to the "Lower" position.
10. Move solution control lever to the desired setting.
11. Turn on the Recovery Switch for the ESP Recycling system, if applicable.
12. Begin scrubbing operation.

Single sweep and scrub the average floor with light to medium soil. In this operation the cleaning is accomplished in one pass with simultaneous solution feed, sweeping, scrubbing and dirty water pick-up. The rate of solution feed and the speed of travel required will vary with floor condition. This knowledge will come with operator experience.

HELPFUL HINTS FOR CLEANING OPERATION

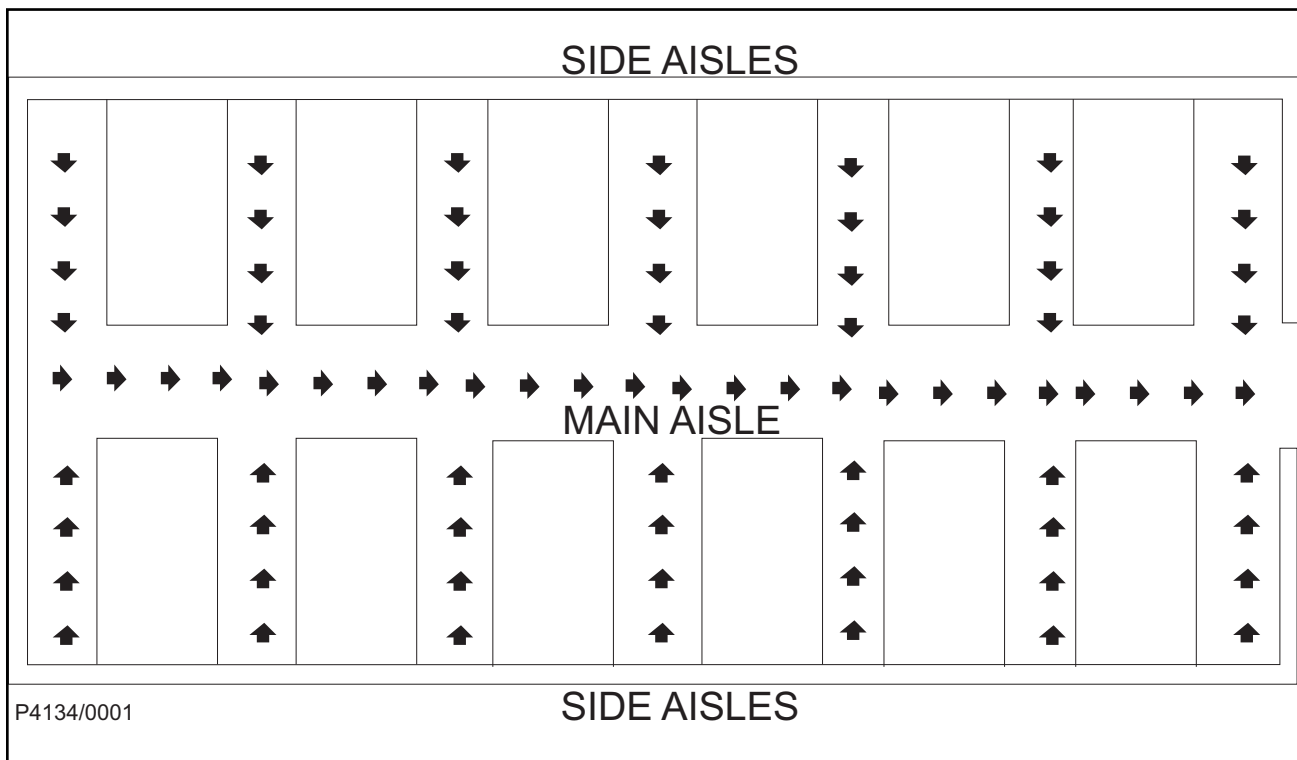

P-4134

FIGURE 23

WARNING

Do not turn the steering wheel sharply when the machine is in motion. The sweeper is very responsive to movement of the steering wheel. Do not make sudden turns.

Scrub in straight paths. Do not bump posts. Do not scrape the sides of the machine.

When the machine is in motion, do not push the directional/speed control pedal all the way forward. This is the same as starting in "High" and will put a strain on the motor and drive system.

1. Plan your sweeping and scrubbing in advance. Try to arrange long runs with minimum stopping and starting.
Sweep debris from narrow aisles out into main aisle ahead of time. Do an entire floor, or section at one time.
2. Pick up oversize debris before sweeping.
3. Allow a few inches overlap of sweep and scrub paths. This will eliminate leaving dirty patches.
4. Don't turn steering wheel too sharply when machine is in motion. The machine is very responsive to movement of the steering wheel - so avoid sudden turns.
5. Try to follow as straight a path as possible. Avoid bumping into posts or scraping the sides of the machine.
6. When placing the machine in motion, avoid slamming the directional control pedal all the way forward quickly. This is equivalent to starting out in "HIGH" and puts needless strain on the engine and drive system.
7. Always allow the machine to warm up before operating in cold temperatures.
8. Periodically turn sweeping (main) broom end for end to prevent the bristles from "setting" in one direction.

NOTE

Replace sweeping broom when bristles are worn to 3-inch (8-cm.) length. Replace disc brushes when bristles are reduced to 1/2 inch (1.3 cm) in length. Replace squeegee rubbers when all usable edges have become rounded with wear, impairing the wiping action.

POST-OPERATION & CLEAN-UP INSTRUCTIONS

TO STOP THE CLEANING OPERATION

Discontinue the cleaning operation whenever a solution or recovery warning or stop light is illuminated.

The solution light will illuminate when the solution tank is empty. At this time, discontinue the scrubbing cycle, put all controls in position for transport and drive to the drain area. See pages 30-32 for instructions on how to drain and clean the recovery and solution tanks, and empty the debris hopper.

The recovery warning light will illuminate approximately 5 minutes before loss of vacuum to the recovery tank. This warning period should give ample time to complete the scrubbing cycle and transport or scrub to the drain area.

NOTE

After stopping the engine, perform this post-operation checklist.

POST-OPERATION CHECKLIST

1. Clean debris hopper.
2. Check sweeping broom for wear or damage.
3. Check all flaps for wear, damage and adjustment.
4. Drain and clean solution tank (ESP system)
5. Clean solution filter screen (ESP system)
6. Drain and clean recovery tank.
7. Clean recovery tank screens and floats.
8. Check manifold and vacuum hoses for debris or obstructions, backflush if necessary.
9. Check scrub brushes for wear or damage.
10. Check rear and side squeegees for wear, damage and adjustment.
11. Fill fuel tank.
12. Check all systems for leaks.

TO DRAIN SOLUTION TANK (RECYCLING OPERATION) (ESP System)

Draining the solution tank is accomplished by a 4-foot (92 cm.) long drain hose located under the frame channel. To drain the tank, lower the hose, remove the plug and drain. When the draining operation is completed, clean the solution tank as outlined below.

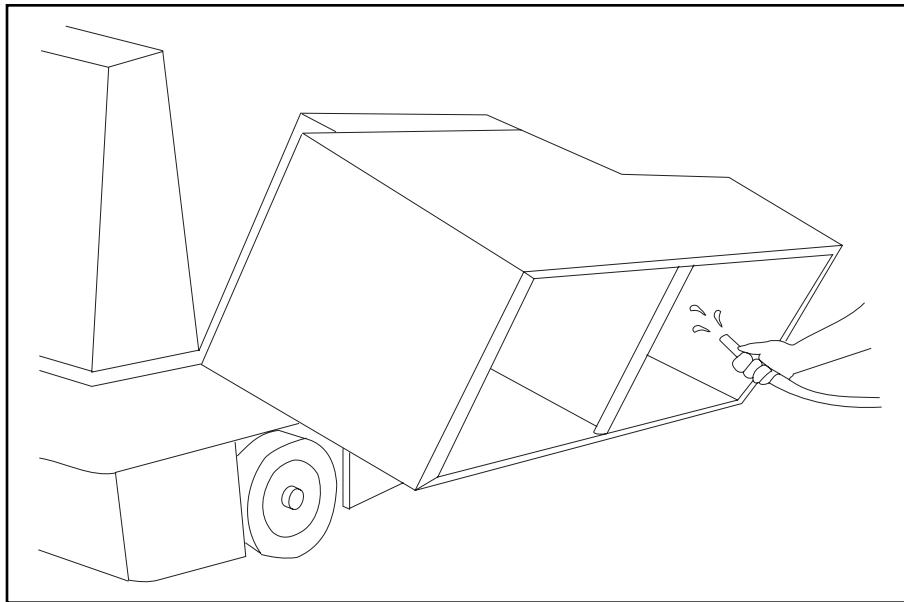

P-4766

FIGURE 20

TO CLEAN SOLUTION TANK (RECYCLING OPERATION) (ESP System)

Cleaning the solution tank is simplified by the large access cover. Flush all deposits from the tank, also flush all probes and the solution line strainer to remove any deposits - remove strainer if necessary. When the cleaning operation is completed, plug and replace the hose. Close and secure covers.

TO DRAIN RECOVERY TANK

A 4-foot long drain hose for the recovery tank is located under the frame channel. To drain the tank, lower the hose, remove the plug and drain. Open the recovery tank and remove the drain plug. When the draining operation is completed, flush and clean the recovery tank as outlined below.

POST-OPERATION & CLEAN-UP INSTRUCTIONS

TO CLEAN RECOVERY TANK

The large access cover on the recovery tank simplifies the cleaning process. Once the recovery tank lid is opened, tip out the tank. With the recovery tank in the tipped out position (figure 20), flush all sand, sludge, debris, etc. out of the tank with a water hose, then replace the tank and flush the manifold, ball float screen and level switch to remove any deposits. The tank lid should be removed and cleaned approximately every 50 running hours.

WARNING

Do not attempt to flush large amounts of tank debris through the drain hose - This will cause clogging and hamper future drainage. Always flush the recovery tank with clean water at the end of each cleaning cycle. Never let debris accumulate, settle and harden in the tank, tank lid, or on associated hardware.

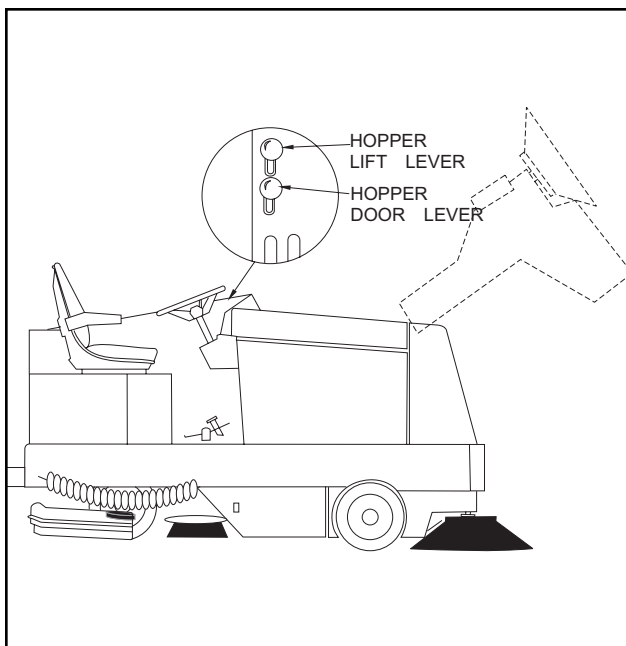

P-5104

FIGURE 21

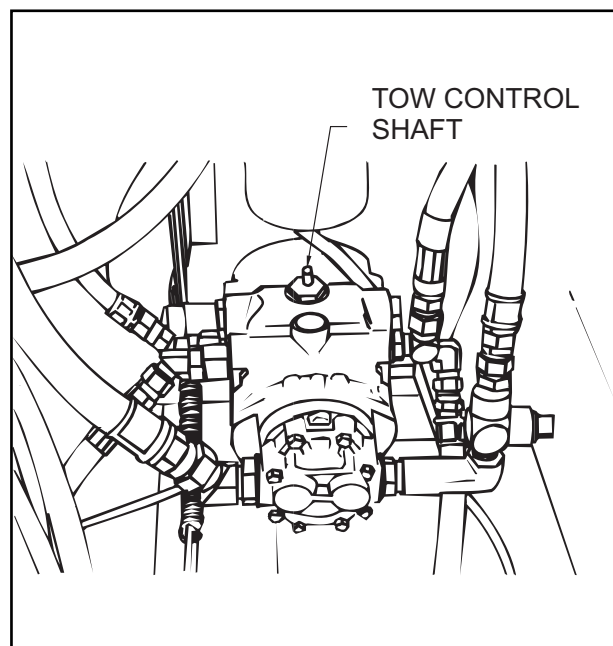

P-4183

FIGURE 22

POST-OPERATION & CLEAN-UP INSTRUCTIONS

TO EMPTY DEBRIS HOPPER

1. Transport or sweep and scrub to the dump site.
2. Close the hopper dump door with the hopper dump lever.
3. Raise the hopper with the hopper lift lever to the desired level.
4. Move the machine forward, over the dumpster, if necessary.
5. Open the hopper dump door with the hopper dump lever.
6. Lower the hopper with the hopper lift lever to the normal operation position.

NOTE (Variable Dump Only)

The sweep functions - main broom, side broom, dust fan, and filter shakers - only work when the hopper is down and the dump door is open.

TOWING INSTRUCTIONS (See Figure 22)

1. Locate tow control shaft extension as shown in Figure 22. (See arrow)
2. To open hydraulic circuit to wheel drive motor, turn shaft 90° so that the flats on the shaft are parallel to the front axle.
3. After towing, turn shaft 90° so that the flats on the shaft are parallel to the pump centerline.

SERVICE CHART

For service assistance, consult the yellow pages under power sweepers and scrubbers. For best performance, replace worn parts with genuine American-Lincoln parts.

EVERY 8 HOURS or DAILY operation check and clean/adjust if necessary:

1. Inspect panel filters for damage and clean.
2. Check engine oil level.
3. Check hydraulic fluid level.
4. Check radiator core for blockage.
5. Check all flaps for wear or damage.
6. Check brooms for wear or damage, adjust as required.
7. Check panel filters (clean side) for leakage.
8. Check brake pedal and parking brake.
9. Check for LP/Diesel odor at connections.
10. Check water separator (Diesel).
11. Check engine air cleaner.
12. Check hydraulic oil filter.
13. Check coolant level.

50 HOUR (WEEKLY) MAINTENANCE CHECKLIST

14. Solution tank (recycling or ESP system).
15. Solution filter screen (recycling or ESP system).
16. Recovery tank. (Include cleaning of tank lid.)
17. Recovery tank screens and filters.
18. Scrub brushes for wear or damage.
19. Rear and side squeegees for wear or damage.
20. Check tension on all belts.
21. Check battery electrolyte level. (Unless Maintenance-Free Battery)
22. Check all hydraulic hoses for wear or cuts.
23. Rotate main broom (end-to-end).
24. Clean or replace panel filters.

Perform recommended engine maintenance (see engine manual if applicable).

100 HOUR MAINTENANCE CHECKLIST

25. Change crankcase oil.
26. Change engine oil filter.
27. Lubricate drive wheel, I swivel wheel bearings, and steering rack guide (engine side above rear wheel).
MAKE SURE TO GREASE ZERK LOCATED ABOVE PINION RACK (See Rear Wheel Assy., Chapter 2)
28. Lubricate front wheel bearings.
29. Lubricate all moving joints.
30. Check brake pads for wear and adjust accordingly.
31. Lubricate all 6 (Diesel)/4 (Gas/LP) DANHOUSER Bushings with NAPA #765-1363 or equivalent anti-seize

lubricant. The bushings are located on the steering, scrub deck lift, squeegee lift, main broom lift, both threaded ends of the throttle cable and variable dump door cylinders. Perform recommended engine maintenance (see engine manual if applicable).

250 HOUR MAINTENANCE CHECKLIST

32. Lubricate squeegee casters.
33. Clean solution tank and filter screen.
34. Replace engine air filter element.
35. Flush radiator coolant system.
36. Remove spark plug - clean or replace (Gas/LP).
37. Check distributor and points - service or replace (Gas/LP).
38. Clean and lubricate governor linkage (Diesel).
39. Replace fuel filter.
40. Replace hydraulic filter element.

Perform recommended engine maintenance (see engine manual if applicable).

400 HOUR MAINTENANCE CHECKLIST

41. Clean hydraulic reservoir.
42. Clean hydraulic intake strainer.
43. Change hydraulic fluid.

Perform recommended engine maintenance (see engine manual if applicable).

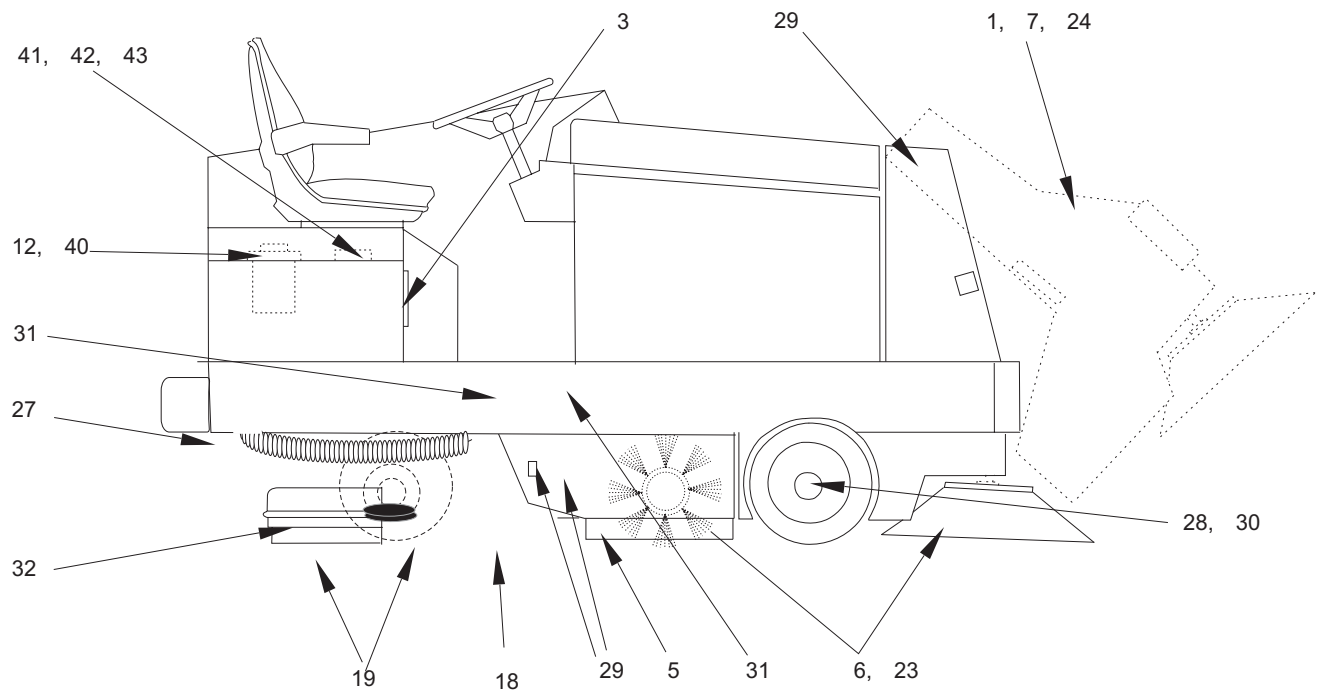
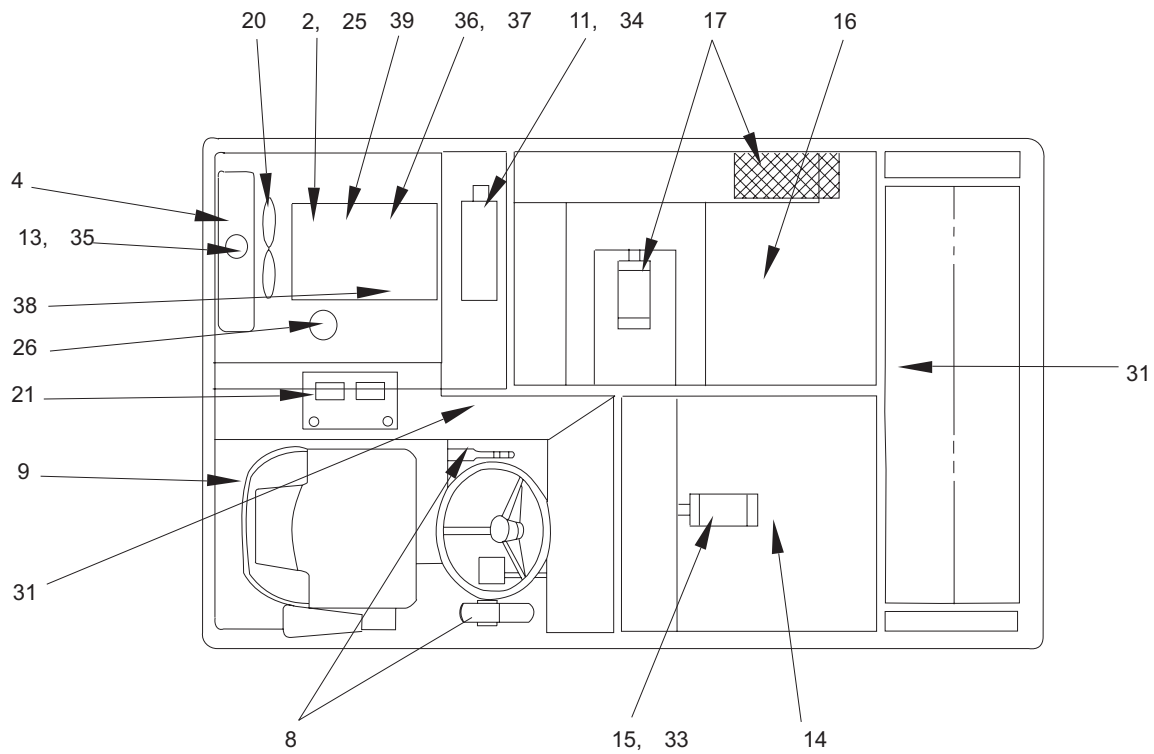

GENERAL MACHINE MAINTENANCE

LUBRICATION

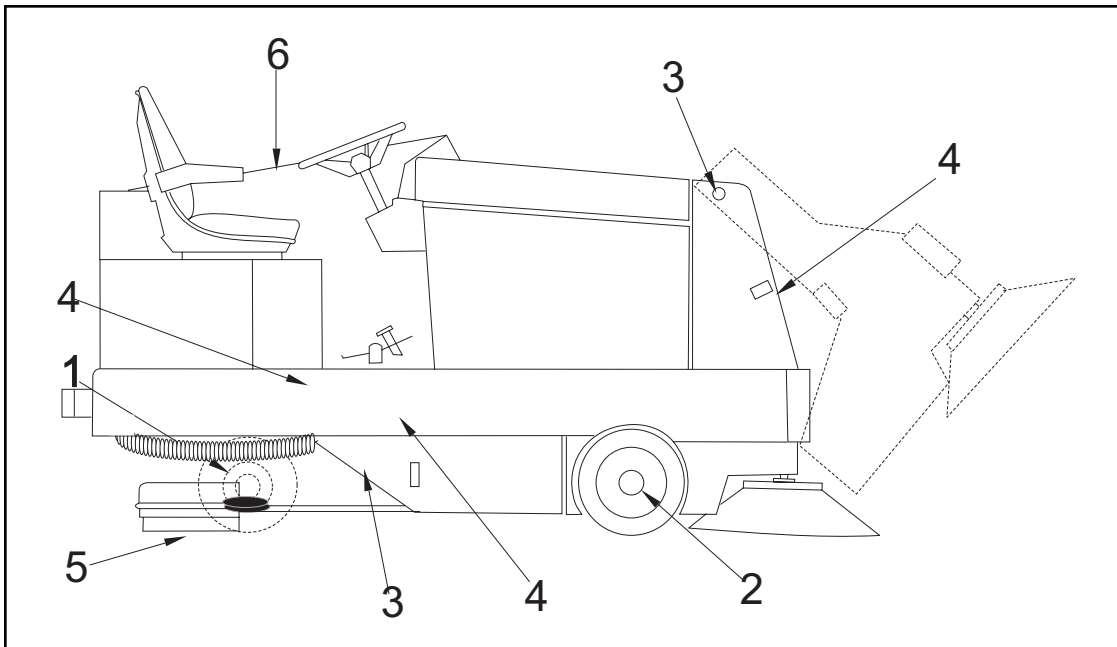

P-5114

FIGURE 24

100 Hour Lubrication

1. Lubricate drive wheel swivel, wheel bearings and steering rack guide.
2. Lubricate front wheel bearings.
3. Lubricate all moving joints.
4. Lubricate all 6 (Diesel)/4 (Gas/LP) DANHOUSER Bushings with NAPA #765-1363 or equivalent anti-seize lubricant. The bushings are located on the steering, scrub deck lift, squeegee lift, main broom lift, both threaded ends of the throttle cable and the variable dump door cylinders.

250 Hour Lubrication

5. Lubricate squeegee casters.
6. Lubricate governor linkage (Diesel).

Use good grade multipurpose grease. Avoid using too much grease.

ENGINE

Read and follow all the instructions in the Engine Manual Section. Due to the nature of work being done by the machine, extra care must be taken to protect the engine from these elements. Check the oil each day before starting operations. Be sure to check the air filter cap's dust collector and empty as necessary. Also check the air cleaner and replace as conditions demand. Do not let the engine become coated with dust and dirt.

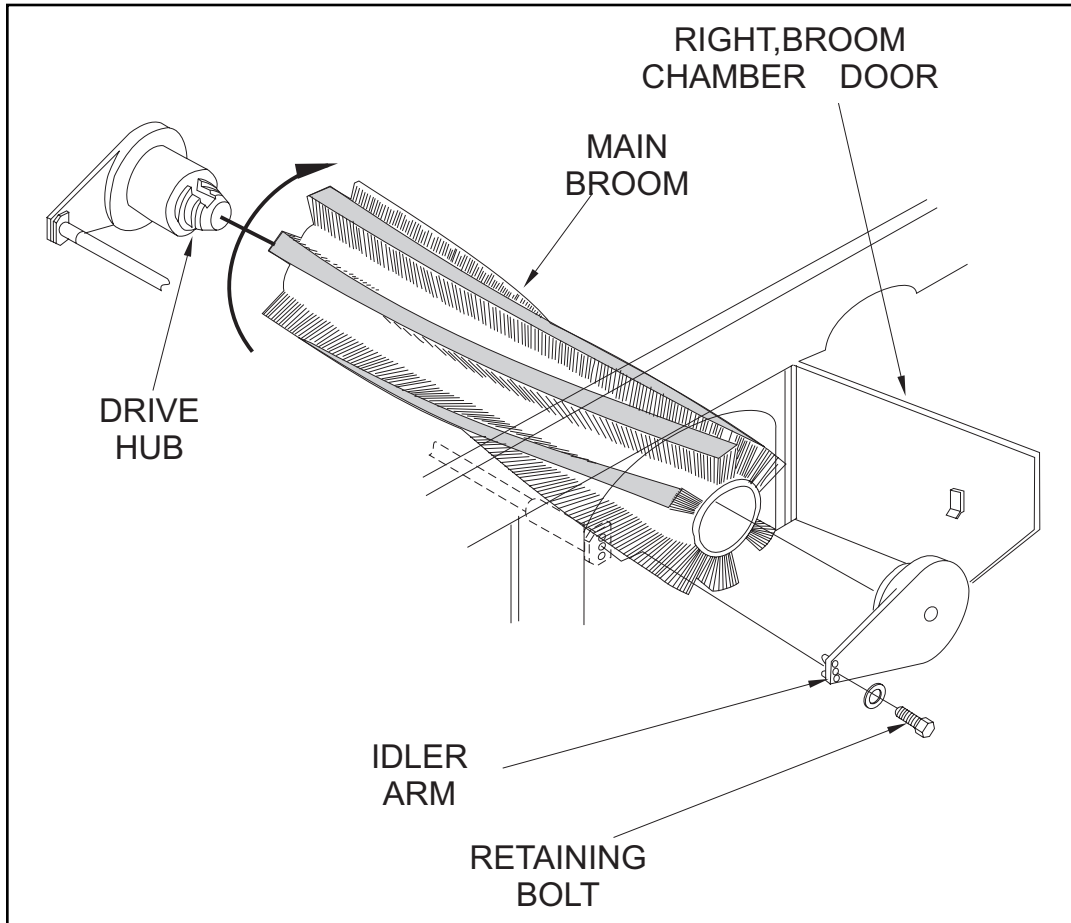

P-5116

FIGURE 28

TO REMOVE MAIN SWEEPING BROOM

1. Open the left broom chamber door.
2. Put the main broom control in the "SWEEP" position.
3. Remove the retaining bolt.
4. Remove the idler arm assembly.
5. Remove the main broom and discard.
6. Put a new main broom in the broom chamber.
7. Rotate the new broom to the right on the drive hub until it engages the drive hub broom tabs.
8. Put the idler arm assembly in place.
9. Put the retaining bolt in place and tighten.
10. Close the broom chamber door.
11. Start the engine.
12. Put the broom lever in the "SWEEP" position.
13. Let the broom sweep in place for 30 seconds.
14. Put the broom lever in the "UP" position.
15. Back the machine off the test spot.
16. Inspect the polished area where the broom swept, for broom bristle contact with the floor. The area of broom bristle contact with the floor should be 2 to 3 inches (5 to 8 cm.) wide.

GENERAL MACHINE MAINTENANCE

MAIN BROOM LEVEL ADJUSTMENT

The main broom level is factory set and shouldn't need adjustment, if the level gets out of adjustment and the broom bristle contact pattern is not an even 2" to 3" (5 to 8 cm.) wide. Adjust the broom arm lift frame. The frame is supported by two flange bearings. These bearings are located inside the broom doors. The carriage bolts on the two end flanges must be loosened. The frame can then be leveled and the bolts tightened.

HOW TO ADJUST MAIN BROOM WEAR PATTERN

When the bristles of the broom begin to wear out the following adjustments may be made to keep a 2-inch (5-cm.) broom pattern.

1. Loosen the nut located in the engine compartment.
2. Set the broom lever to the "Sweep" position and adjust the lock nut to obtain a 2-inch (5 cm) broom pattern. The lock nut will move the adjusting rod that adjusts the sweeping pattern of the broom for wear.

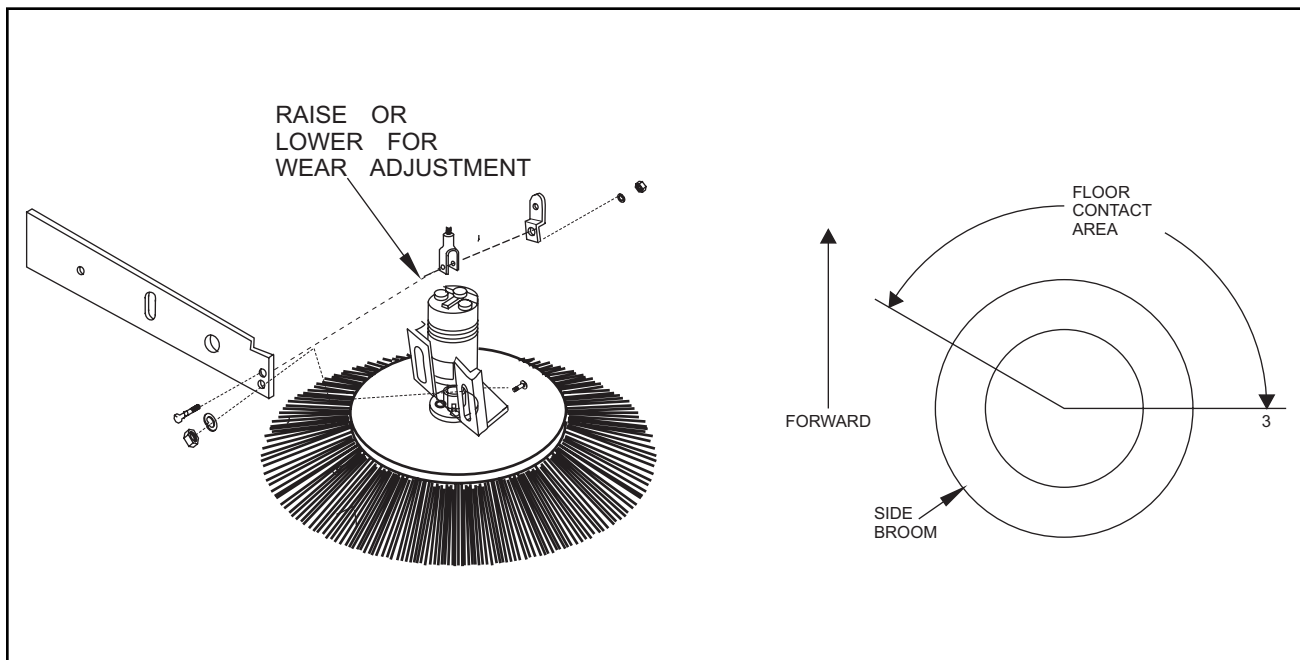

P-5117

FIGURE 29

SIDE BROOM LEVEL ADJUSTMENT

As the side broom wears, loosen the two wear adjusting bolts and slide the broom-motor assembly into a position so that the broom contacts the floor at a 3 degree angle when lowered as shown in Figure 29.

SIDE BROOM REPLACEMENT

Put the side broom lift control in the "UP" position. Remove the retaining screw in the bottom middle of the side broom. Remove the side broom. Transfer the side broom flange spacer and screws to the replacement side broom. Put the replacement side broom on the shaft. Put the retaining screw in position and tighten.

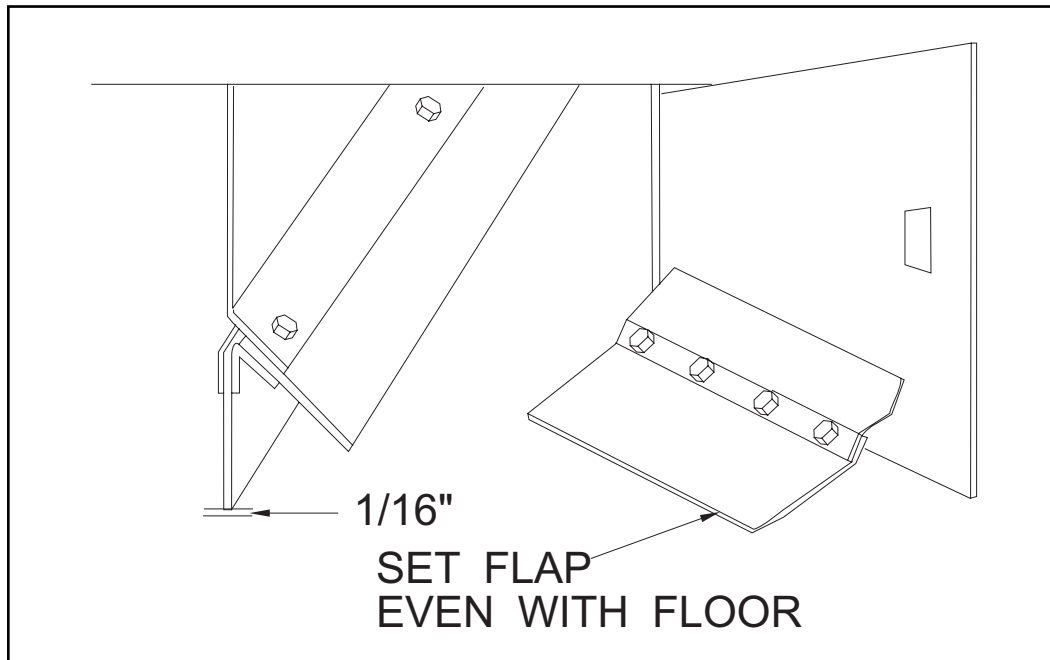

P-4793

FIGURE 30

FLAPS

The urethane and rubber flaps are susceptible to damage and should be inspected regularly and maintained in good condition. The side flaps are adjustable and should be maintained at approximately 1/16" (16 mm.) above the floor. The front and rear flaps have no provision for adjustment.

All flaps should be replaced when worn or damaged to such an extent that they couldn't perform their function.

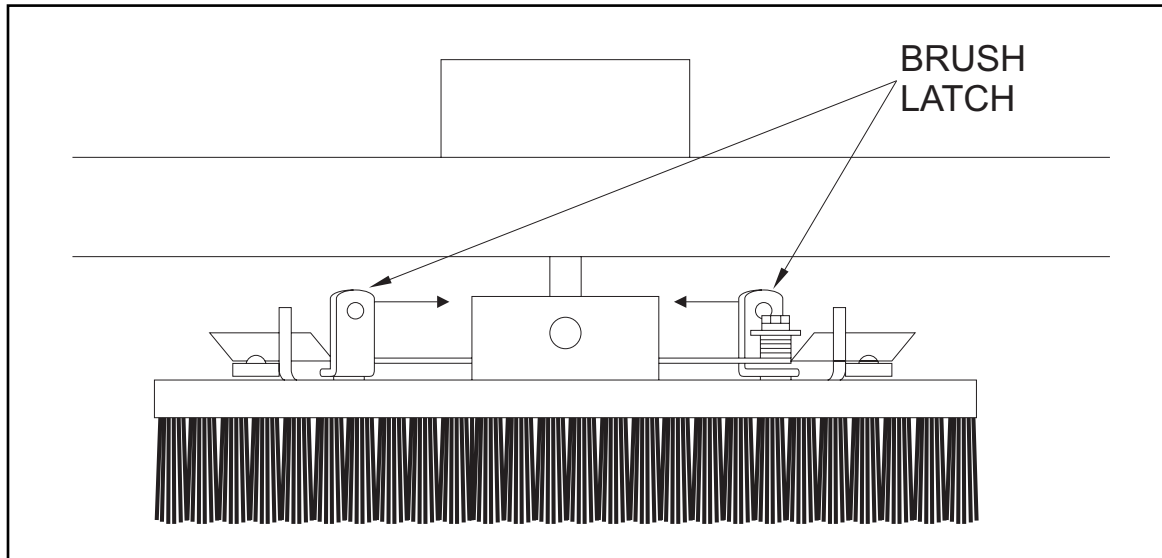

P-4762

FIGURE 31

SCRUB BRUSH REPLACEMENT

1. Raise the scrub brush deck by pressing the "Scrub Brush" Switch on the instrument panel.
2. Press the brush latches in to release the scrub brush.
3. Remove old scrub brush.
4. Snap new brush into place.

COVERS AND LATCHES

The covers have been designed to allow access, either by hinge or removal, to all areas of the machine. No maintenance is required. For lubrication of latches see Lubrication Section.

SOLUTION WARNING LIGHT

The solution warning light will illuminate when the solution tank is empty. This part of the level control system requires no maintenance. If the system fails to operate, consult the Electrical Troubleshooting Guide.

RECOVERY WARNING LIGHT

The recovery warning will illuminate approximately 5 minutes before loss of vacuum to the recovery tank. This part of the level control system requires no maintenance, except for daily cleaning of the tank level switch. If the system fails to operate, consult the Electrical Troubleshooting Guide.

SOLUTION CONTROL (Non-Recycling or Standard)

The solution control lever controls the amount of solution applied to the scrubbing brushes. Except for a few drops of oil applied to the lever pivot every 100 hours, the system should require no major maintenance.

The solution control should shut off completely with the lever in the (rear) "off" position. If complete shut off does not occur, the control cable should be adjusted.

SOLUTION CONTROL (RECYCLING or ESP System)

In the recycling mode, the solution control lever is also used to activate the detergent pump. If the detergent pump fails to operate (engine running) when the solution control lever is moved into the low to high range, first check the circuit by manually activating the switch. If the detergent pump does not operate at this time, a further electrical or mechanical check is indicated. (See Electrical Troubleshooting Guide or Detergent Pump Troubleshooting).

RECYCLING PUMP ESP System

The recycling pump is located directly behind and under the recovery tank. The pump is electric and except for daily cleaning of the pump intake screens, it requires no regular maintenance.

NOTE

Do not run pump dry. The unit depends on the liquid pumped for lubrication.

RECYCLING (ESP) PUMP STORAGE

Always drain pump for extended storage, especially when freezing temperatures may be encountered.

REAR SQUEEGEE

The squeegee will require service when the inner edges of the blades become round with wear, impairing the wiping action or water pickup. To service the rear squeegee use the following steps:

1. Loosen the four aluminum knobs (item 10, these hold the squeegee tool to the squeegee support)
2. Remove the squeegee tool and turn upside down to service the blades or caster wheels. The squeegee blades are designed to flip over and use another unworn edge (item 5 & 6).

To service the blades:

1. Loosen the clamp bolts, which clamp items 8 & 9 together.
2. Loosen far enough to slip the end clamp brackets off the squeegee tool. This will allow flipping the blades or installing new blades.
3. Install blades so that outer blade is 3/16" longer than inner blades, this is achieved by assembling the top edge of the blade against the squeegee tool weldment.
4. Reinstall squeegee clamp band and tighten clamp bolt tight.

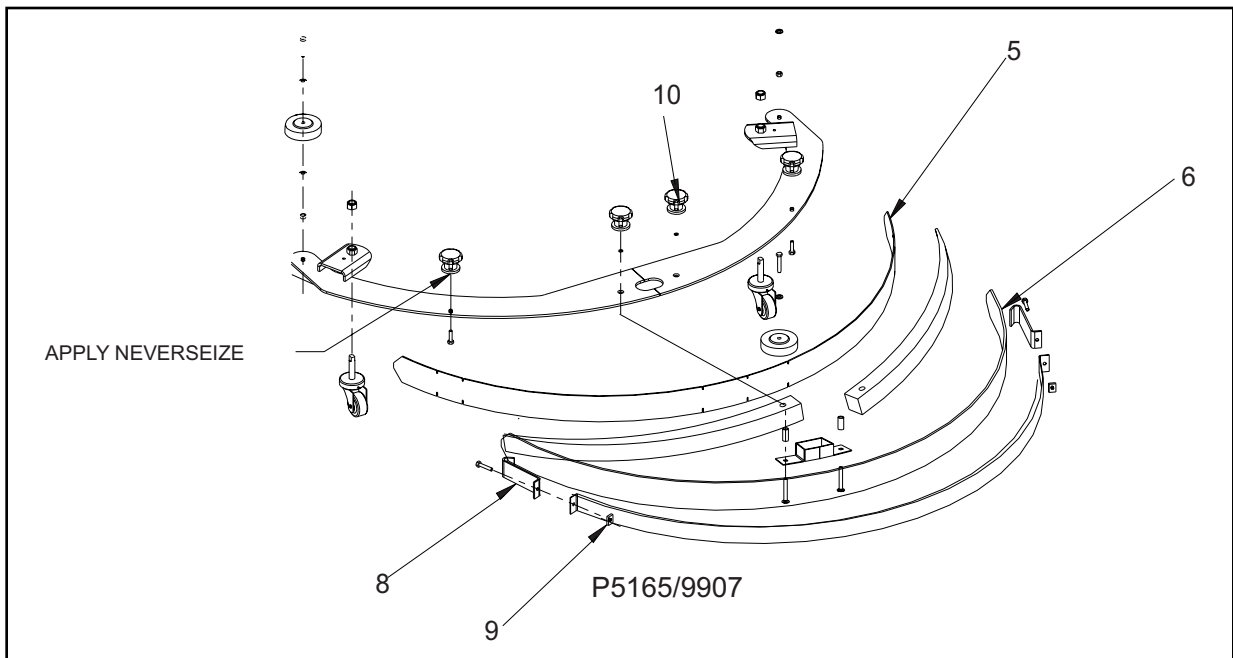

P-5165

SQUEEGEE CASTER WHEELS

Grease caster wheel zerks (2) on each caster should be greased each time the blades are serviced for a total of 3 caster wheels.

ADJUSTING CASTERS

Lower squeegee on a flat surface, making sure the rear squeegee blade is perpendicular to the surface. Adjust caster 3/16" above the flat surface, Lock jam nuts.

GENERAL TROUBLESHOOTING

<u>PROBLEM</u>	<u>PROBABLE CAUSE</u>	<u>REMEDY</u>
Sweeping does not function	<ol style="list-style-type: none"> 1. Dump door closed 2. Hopper is raised 3. Hopper switch out of adjustment 	<ol style="list-style-type: none"> 1. Open dump door 2. Lower hopper 3. Adjust hopper switch
Poor water pick up at squeegee	<ol style="list-style-type: none"> 1. Side or rear squeegee are worn or damaged 2. Clogging in water pick up 3. Air leaks in suction hose and connection 4. Air leaks at recovery tank cover and/or manifold gaskets 5. Poor vacuum 6. Drain hose or drain plug leakage or not closed properly.. 	<ol style="list-style-type: none"> 1. Examine squeegee rubber blade for cuts or worn spots. 2. Repair or replace hose and connection 3. Repair or replace gaskets 4. Check vacuum motor 5. Check seal on recovery tank 6. Close, repair or replace drain plug in recovery tank.
Water spill from squeegee	<ol style="list-style-type: none"> 1. Side squeegee blades, poor contact with floor 2. Squeegee blades worn or damages 3. Too much solution being applied before making turns 4. Brushes rotating opposite direction 	<ol style="list-style-type: none"> 1. Readjust blades for proper contact 2. Replace or adjust 3. Shut off solution flow 5' to 10' 4. Check position of switches.
Lack or suction at rear	<ol style="list-style-type: none"> 1. Clogged suction hose or pick up tool 2. Loose connections between suction hose and squeegee or between hoses or manifold inlet. 3. Vacuum motor not operating 4. Vacuum float cage clogged 5. Vacuum float shut off 	<ol style="list-style-type: none"> 1. Disconnect suction hose from squeegee; flush squeegee & hoses. 2. Check all hose connections for looseness or damage. 3. Check hydraulic motor in recovery 4. Clean perforated metal thoroughly 5. Excessive solution in recovery drain tank. Excessive foam build up, change cleaning chemical mixture. Use A-L approved materials.

GENERAL TROUBLESHOOTING

<u>PROBLEM</u>	<u>PROBABLE CAUSE</u>	<u>REMEDY</u>
Poor scrubbing	<ol style="list-style-type: none"> 1. Worn scrubbing brushes 2. Incorrect method of operation 3. Wrong cleaning agent or mixture 4. Poor solution distribution 	<ol style="list-style-type: none"> 1. Inspect brushes. If worn to ½" (1.3cm) or less, replace all 3 brushes 2. Check scrubbing procedures, brush pressure, type of brush, solution flow, & cleaning chemical used. For extreme conditions double scrubbing may be necessary. 3. Use A-L recommended materials 4. Clean out distribution tube & metering holes to brushes. Check feed hose & clean if necessary. Check valve & cable control system.
Engine runs, but machine will not move on level ground	<ol style="list-style-type: none"> 1. Foot pedal and/or linkage jammed or not adjusted 2. Front wheels jammed or brakes locked 3. Hydraulic pump trouble 4. Rear wheel hydraulic motor, broken shaft key, broken shaft, ect. 	<ol style="list-style-type: none"> 1. Check pedal linkage 2. Check wheels and brakes 3. Check & repair pump, check tow valve. See CESSNA information. 4. Check & repair. See Char-Lynn information
Machine moves slowly	<ol style="list-style-type: none"> 1. Low hydraulic oil level 2. Brake dragging 3. Hydraulic oil temp, too high 4. Worn hydraulic pump or drive wheel motor 	<ol style="list-style-type: none"> 1. Add oil to reservoir 2. Check brakes 3. Check oil level, add SAE 5 (FORD Type F) ATF, if required 4. See hydraulic CESSNA
Hydraulic pump making excessive noise	<ol style="list-style-type: none"> 1. Clogged inlet strainer or suction line 2. Air bubbles in hydraulic fluid 3. Hydraulic pump is worn or damaged 	<ol style="list-style-type: none"> 1. Clean inlet strainer. Drain & flush reservoir, if oil is dirty. Refill with clean SAE 5 (FORD Type F) ATF. 2. Check for low hydraulic fluid level, leaking fittings or hoses 3. See CESSNA Pump Section

TECHNICAL SPECIFICATIONS (as installed and tested on the unit)

Model		7765 Petrol (VD)	7765 Petrol (MD)
		7765 LPG (VD)	7765 LPG (MD)
		7765 Diesel (VD)	7765 Diesel (MD)
Model No.		505-255	505-258
		505-256	505-259
		505-257	505-260
Sound Pressure Level (ISO 11201)	dB (A)	89.4	89.4
Sound Power Level (ISO 3744)	dB (A)	Lwa 109.0	Lwa 109.0
Total Weight	lbs/kg	4,350 / 1973	3,900 / 1769
Vibrations at the Hand Controls (ISO 5349-1)	m/s ²	0.89 m/s ²	0.89 m/s ²
Vibrations at the Seat (EN 1032)	m/s ²	0.31 m/s ²	0.31 m/s ²
Gradeability			
Transport		14.1% (8°)	14.1% (8°)
Cleaning		10.5% (6°)	10.5% (6°)

Model		7760 Petrol (VD)	7760 Petrol (MD)
		7760 Diesel (VD)	7760 Diesel (MD)
Model No.		505-255CE	505-258CE
		505-257CE	505-260CE
Sound Pressure Level (ISO 11201)	dB (A)	89.4	89.4
Sound Power Level (ISO 3744)	dB (A)	Lwa 109.0	Lwa 109.0
Total Weight	lbs/kg	4,350 / 1973	3,900 / 1769
Vibrations at the Hand Controls (ISO 5349-1)	m/s ²	0.89 m/s ²	0.89 m/s ²
Vibrations at the Seat (EN 1032)	m/s ²	0.31 m/s ²	0.31 m/s ²
Gradeability			
Transport		14.1% (8°)	14.1% (8°)
Cleaning		10.5% (6°)	10.5% (6°)

American-Lincoln®

14600 21st Avenue North
Plymouth, MN 55447-3408
www.americanlincoln.com
Phone: 800-331-7692
Fax: 877-877-2586
©2007 American-Lincoln