



# Electronic Service Manuals

This electronic document is provided as a service to our customers. We do not create the contents of the information contained in this document. Should you have detailed questions pertaining to the information contained in this document, you may contact Michco, or the manufacturer which provided the original information in this electronic deliverable. Michco's only part in this electronic deliverable was the electronic assembly process.

You may contact Michco through the following methods:  
Phone (517) 484-9312 or (800) 331-3339 MI, OH, IN only  
2011 N. High St. -- Lansing, Michigan -- 48906  
Fax: (517) 484-9836  
Email: [CustServ@Michco.com](mailto:CustServ@Michco.com)  
Web site: [www.Michco.Com](http://www.Michco.Com)  
Parts Web site: [www.FloorMachineParts.Com](http://www.FloorMachineParts.Com)

Order Parts on Line at:  
**[www.FloorMachineParts.Com](http://www.FloorMachineParts.Com)**

Directly to Parts & Service:  
By Email: **[Shop@Michco.com](mailto:Shop@Michco.com)**  
By Fax: (517) 702-2041  
By Voice: Use numbers above.

**Serving the Cleaning Industry Since 1922**

Notice: All copyrighted material remains property of original owners, all trademarks are property of respective owners. Manuals are subject to Manufacturer's reproduction limitations. Originals or reproductions were provided by manufacturers through a request. We make no warranty as to the correctness of information provided in this document and you assume all risk.

# 4 INCH UPHOLSTERY TOOL

## 228852

ITEM	PART NUMBER	DESCRIPTION	QTY.
1	219401	Valve Assembly with hanger, screw & nut	1
2	S228P	Jet Tip	1
3	215006	Valve Repair Kit, includes: Stem with O-Rings & Spring	1
4	225197	Lever	1
5	224111	Solution Hose Assembly, 15'	1
6	203302	Quick Connect, 1/4" Male	1

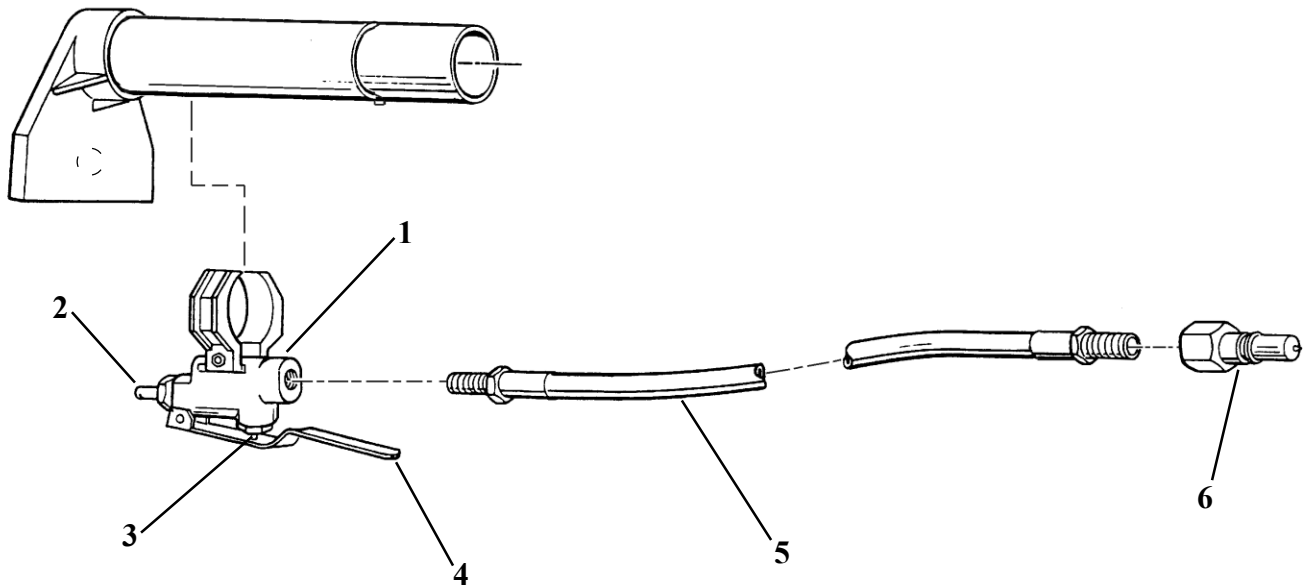

**PACIFIC STEAMEX, INC.**  
 2259 S. SHERIDAN  
 MUSKEGON, MICHIGAN 49442-6252  
 1-800-968-1332  
 FAX 1-800-863-9536