

**NOBLES®**

# Speedshine Standard

**Operator Manual  
& Parts List**

**MODELS: SPR17RB, SPR20RB, SPR17DSRB,  
SPR20DSRB, SPR17RBHD, SPR20RBHD**



PDF Version of manual by:  
Michigan Company Inc.  
2011 N. High St.  
Lansing, Mich. 48906  
(517) 484-9312  
<http://www.Michco.com>

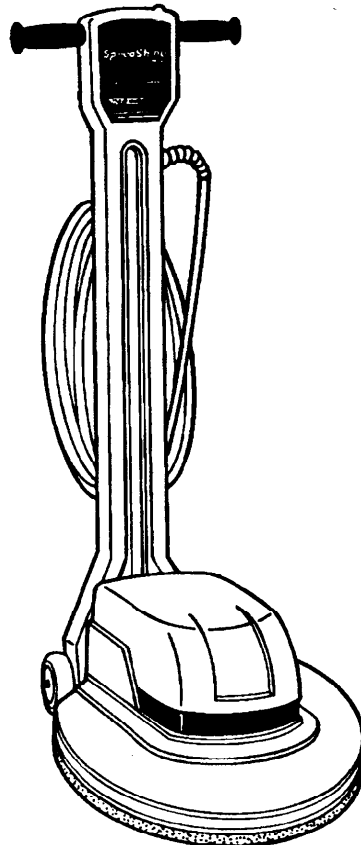

**NOBLES INDUSTRIES**  
12875 RANSOM STREET  
HOLLAND MI 49424

A **TENNANT** COMPANY

1-800-739-9359  
616-786-2330  
FAX: 1-800-678-4240  
CUSTOMER SERVICE: 1-800-365-6625

173195  
Rev. 03 (04-96)

# OPERATION

This manual is furnished with each new Nobles Speedshine Standard Model . It provides necessary operation and machine care instructions. **Read this manual completely and understand the machine before operating or servicing it.**

This machine will provide excellent service. However, the best results will be obtained at minimum costs if:

- The machine is operated with reasonable care.
- The machine is maintained regularly – per the machine care instructions provided.
- The machine is maintained with Nobles supplied or equivalent parts.

## TABLE OF CONTENTS

SAFETY PRECAUTIONS .....	2
MACHINE COMPONENTS .....	3
MACHINE SET-UP .....	3
MACHINE OPERATION .....	4
MACHINE CARE .....	4
TROUBLE SHOOTING/SPECIFICATIONS .....	5
PARTS LIST	
UPPER UNIT .....	6
LOWER UNIT .....	8
WIRING DIAGRAM .....	10

## SAFETY PRECAUTIONS

This machine is suited to scrub or burnish floors in a indoor environment and is not constructed for any other use. Use only recommended pads/brushes and cleaning solutions.

The following precautions are used throughout this manual as indicated in their description:

**⚠ WARNING: To warn of hazards or unsafe practices which could result in severe personal injury or death.**

**FOR SAFETY: To identify actions which must be followed for safe operation of equipment.**

### FOR SAFETY:

The following information signals potentially dangerous conditions to the operator or equipment:

1. **Do Not Operate Machine:**
  - Unless Trained And Authorized.
  - Unless Operator Manual Is Read And Understood.
  - If It Is Not In Proper Operating Condition.
2. **Before Operating Machine:**
  - Remove Loose Objects On Floor. Loose Objects May Become Dangerous Projectiles If Struck By Revolving Pad.
  - Check Area For Flammable Liquids Or If Gases Are Present.
  - Check Cable And Plug For Damage.

## MACHINE DATE

Please fill out at time of installation for future reference.

Machine Model No.- \_\_\_\_\_

Machine Serial No.- \_\_\_\_\_

Nobles Rep. Ph.No.- \_\_\_\_\_

Date of Installation- \_\_\_\_\_

3. **When Operating Machine:**
  - Keep Hands And Feet Away From Revolving Pad.
  - Do Not Run Over Power Supply Cord, A Hazard May Occur.
  - Do Not Wear Open-Toed shoes, Sandals Or Go Bare Feet.
  - Keep Machine Moving To Prevent Damage To Finish Or Floor.
  - Always Work Within Cable Length To Avoid Cable Stress And Damage.
  - Do Not Release Twist Grips At Any Time. When Stopping Machine Wait To Release Twist Grips Until Pad Comes To A Complete Stop.
4. **Before Leaving or Servicing Machine:**
  - Turn Off Machine And Unplug Power Cord From Outlet.

**⚠ WARNING: Hazardous Voltage. Shock Or Electrocutation Can Result. Always Unplug Power Cord Before Working On Machine.**

**⚠ WARNING: Do Not Store Outdoors And Avoid Getting Wet.**

**⚠ WARNING: The Use of Supplies Other Than Those Recommended by Manufacturer May Cause Damage.**

## MACHINE COMPONENTS

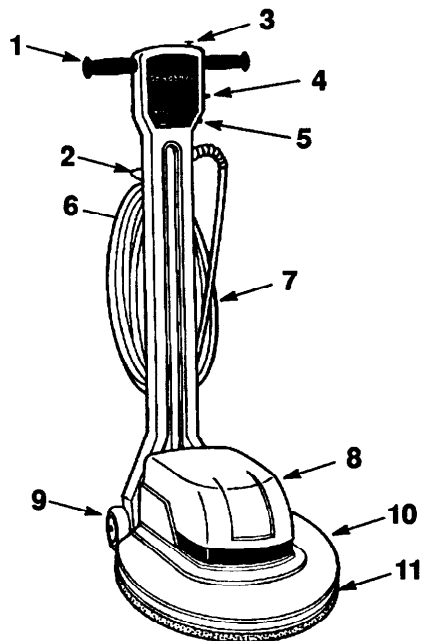

1. Twist Grips
2. Adjustable Handle Lever
3. Safety Lock Button
4. Speed Select Switch (Dual Speed Only)
5. Circuit Breaker Button
6. Power Cord Hook
7. 50ft/15m Power Cord
8. Motor Cover
9. Wheels 4"/19cm
10. Scrub Head
11. Cleaning Pad

wheels until machine is resting on handle.

4. Position brush/pad driver on driver lug and turn counter-clockwise to secure (Fig.1).

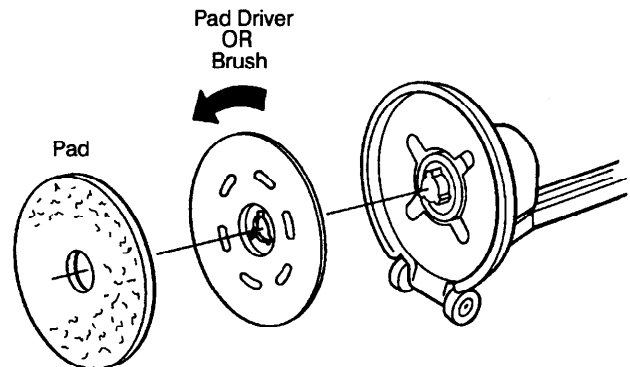

Fig. 1

5. To install pad: Position pad on pad driver and tap with hand to secure (Fig. 1).
6. After brush or pad is installed return machine to upright position.
7. Adjust handle to a comfortable height: Lift handle release lever and lower handle to desired height. Handle will lock into position when release lever is released (Fig. 2).

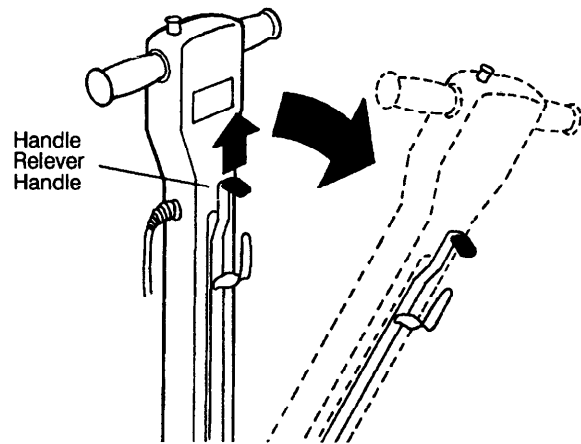

Fig. 2

8. Plug power supply cord into a grounded wall outlet.

**⚠ WARNING: Machine MUST be earthed.**

## MACHINE SET-UP

1. Carefully check carton for signs of damage. Report damages at once to carrier. Check whether cord plug installed corresponds to your wall outlet.
2. Your Scrubber is shipped fully assembled. Flexible pad driver, pads and brush are sold separately. Just select and install recommended brush or flexible pad driver with pad that meets your cleaning needs.

**IMPORTANT: Proper Pad or Brush selection is important for best results. See your authorized distributor to assist you in choosing the right pad or brush for your specific cleaning needs.**

3. To install pad or brush: Tilt machine back on

# OPERATION

## MACHINE OPERATION

1. Read and understand safety information before operating.

**⚠ WARNING:** Take extreme caution when beginning to operate machine. Machine will jolt quite aggressively if proper instructions are not followed.

2. Lift handle so scrub head is parallel to floor.
3. For Dual Speed Models select desired motor speed. Position switch downward (185rpm) for scrubbing/ stripping OR position switch upward (300rpm) for spray buffing (Fig. 3).

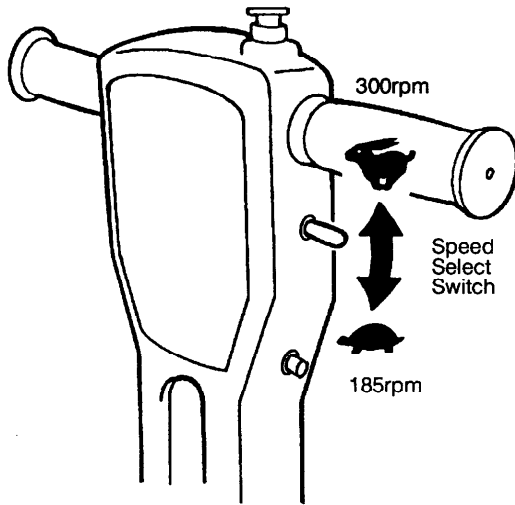

Fig. 3

4. Start machine by pressing safety lock button and turning twist grips forward. Release thumb from safety lock button once machine starts (Fig. 4).

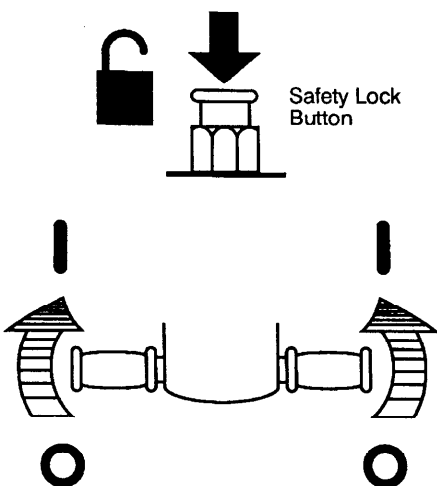

Fig. 4

5. To move left: Slightly lower handle and machine will move left (Fig. 5). To move right: Slightly raise handle and machine will move right (Fig. 6). Work machine with a side to side motion when operating.

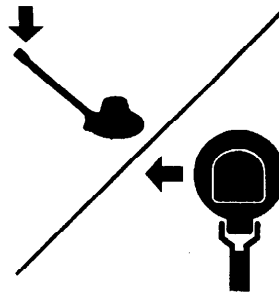

Fig. 5

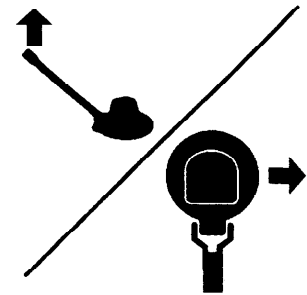

Fig. 6

6. To stop machine: Rotate twist grips backward and safety lock button will engage.

**⚠ WARNING:** To avoid serious personal injury, always wait until pad/brush comes to a complete stop before letting go of twist grips.

**NOTE:** Machine is equipped with a circuit Breaker. Circuit Breaker will trip under conditions of excessive overload. Periodically check pad for excessive soil build-up. Turn pad over, clean or replace when necessary. If Circuit Breaker should trip. Reset circuit breaker switch after 15 seconds by pushing button at side of handle. Resume to normal operating.

**⚠ WARNING:** To avoid serious personal injury, always unplug machine when removing cleaning pads.

## MACHINE CARE

**⚠ WARNING:** To avoid serious personal injury, always unplug machine before any type of machine care is performed.

1. Remove pad driver or brush after every use. This prevents damage to attachments.
2. Clean machine base assembly after every use.
3. Always wash pads after each use. Never use soiled pads or allow pads to become oversoiled before changing.
4. Always wind power cord around cord hooks rather than loosely looped over handle. Wipe cord with damp cloth after each use. Also, check power cord for damage, if worn or damaged, replace immediately.
5. Gear system and motor are factory lubricated and require no further attention.

**TROUBLE SHOOTING**

PROBLEM	CAUSE	SOLUTION
Machine does not operate.	Machine unplugged.	Plug machine in.
	Machine circuit breaker tripped.	Reset breaker on machine.
	Building circuit breaker tripped.	Reset breaker and change to different circuit.
	Faulty power cord.	Contact Nobles Service Center.
	Faulty wiring.	Contact Nobles Service Center.
	Faulty twist grip switch.	Contact Nobles Service Center.
	Capacitor burned out. (Single speed models only)	Contact Nobles Service Center.
	Rectifier burned out. (Dual speed models only)	Contact Nobles Service Center.
Machine circuit breaker trips continuously.	Soiled Pad.	Replace Pad.
	Improper pad for application	Change to proper pad.
	Defective circuit breaker.	Contact Nobles Service Center.
	Worn motor brushes.	Contact Nobles Service Center.

**SPECIFICATIONS**

MODEL NO.	SPR17RB/HD	SPR20RB/HD	SPR17DSRB	SPR20DSRB
WIDTH	17.75"/45cm	20.75"/53cm	17.75"/45cm	20.75"/53cm
HEIGHT	48"/122cm	48"/122cm	48"/122cm	48"/122cm
WEIGHT	95 lbs./43Kg	95 lbs./43Kg	95 lbs./43Kg	95 lbs./43Kg
DRIVE MOTOR	120V, 1 hp 12A, 60Hz	120V, 1 hp 12A, 60Hz	120V, 1.5 hp 12A, 60Hz	120V, 1.5 hp 12A, 60Hz
	230V, .75kW, 7A, 50Hz	230V, .75kW, 7A, 50Hz		
	(HD) 120V, 1.5 hp 12A, 60Hz	(HD) 120V, 1.5 hp 12A, 60Hz	230V, 1.1kW, 12A, 50Hz	230V, 1.1kW, 12A, 50Hz
	(HD) 230V, .1.1kW, 7A, 50Hz	(HD) 230V, 1.1kW, 7A, 50Hz		
PAD/BRUSH SPEED	175 RPM	175 RPM	185/330 RPM	185/330 RPM
POWER CORD LGH	50'/15M	50'/15M	50'/15M	50'/15M
BRUSH PAD DIA.	17"/43cm	20"/51cm	17"/43cm	20"/51cm
DECIBEL RATING AT OPERATOR'S EAR, INDOORS ON TILE FLOOR	<70dB(A)	<70dB(A)	71dB(A) At Low Speed 73dB(A) At High Speed	71dB(A) At Low Speed 73dB(A) At High Speed



## UPPER UNIT

REF.	PART #	DESCRIPTION	QTY.
1.	140831	SCREW, 10-24x.375	2
2.	140018	WASHER, 10-24x.5	2
3.	140823	SCREW, 10-24x.625	4
4.	230013.NLG	COVER, HANDLE	1
5.	140519	NUT, 10-24	8
6.	140864	SCREW, 1/4-20x.75	5
7.	140052	WASHER, LOCK .25	5
8.	230427	HOOK, CORD	2
9.	230859	CHANNEL, LATCH	1
10.	140881	SCREW, 1/4-20x1	1
11.	140402	SPRING, LATCH	1
12.	140524	NUT, 1/4-20	1
13.	140146	BUSHING, .5 OD	2
14.	140147	BUSHING, .44 OD	4
15.	230852	PLATE, BACKING	3
16.	140604	PIN, .25x.75	1
17.	230860	HANDLE, LATCH	1
18.	200821	GRIP, .25x1x2.25	1
19.	200823	GRIP, HANDLE	2
20.	130726	SWITCH, DUAL SPEED	1
21.	6010.16	SCREW, 8-32X1	1
22.	20361	BREAKER, 15 AMP 120V	1
	130670	BREAKER, 12 AMP 220V	1
23.	100383	HANDLE	1
	100384	HANDLE, DS	1
24.	28990	NUT, LOCK 8-32	2
25.	230853	TUBE, HANDLE	1
26.	130990	BOOT, SWITCH	1
	130681	PLATE, SWITCH	1
27.	230857	SOCKET, LOCK	1
28.	230856	PIN, LOCK	1
29.	100355	SLEEVE, LOCK	1
30.	230855	BUTTON, LOCK	1
31.	140401	SPRING, LOCK	1
32.	140554	SCREW, 1/4-20x.75	1
33.	600987	SPRING	1
34.	140829	SCREW, 6-32x1	2
35.	28657	SWITCH	2
36.	230854	BRACKET, SWITCH	1
37.	140539	NUT, 6-32	2
38.	140032	WASHER, FLAT	1
39.	140328	CLAMP, .375	1
40.	130167	GRIP, CORD	1
41.	130262	CORD, 14/3X50' 120V	1
	130275	CORD, 3x1.5MMx15M 220V	1
42.	140235	SCREW, .5-13x2	2
43.	140024	WASHER, LOCK .5	2
44.	3148.816	WASHER, FLAT	2
45.	140148	BUSHING	2
46.	140900	SCREW, 10-24X.75	1
<b>DECALS: NOT SHOWN</b>			
	120577	DECAL, "SPEEDSHINE 17-175"	1
	120577	DECAL "SPEEDSHINE 20-175"	1
	120578	DECAL, "SPEEDSHINE 185/300"	1
	120062	DECAL, "SPEEDSHINE HD"	1
	120676	DECAL, SPEEDSHINE OPERATION	1
	120675	DECAL, SPEEDSHINE OPERATION DUAL SPEED	1
	120619	DECAL, WARNING	1
	120582	DECAL, RECESS COVER	1

# PARTS DIAGRAM

## LOWER UNIT

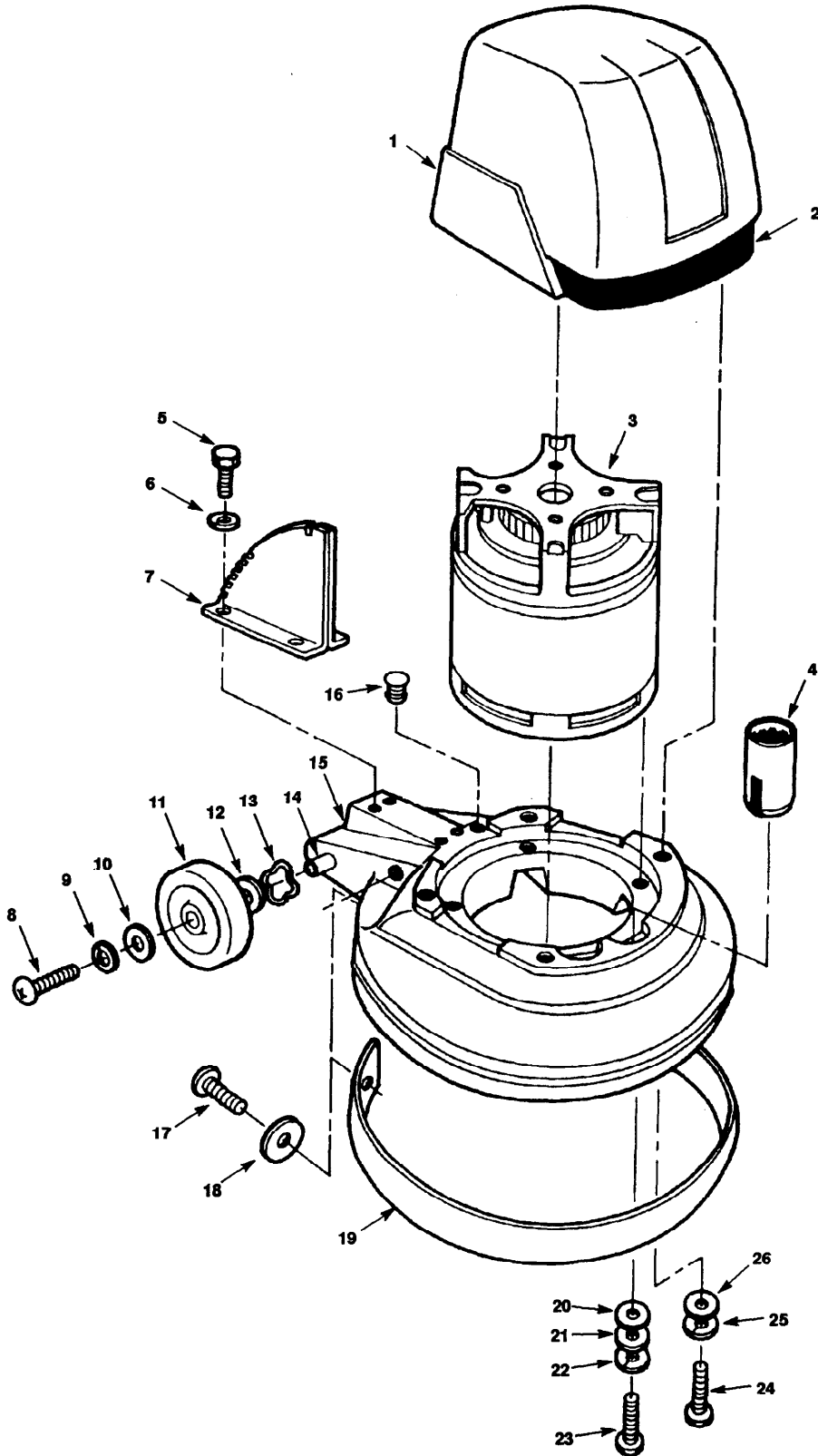

# PARTS LIST

## LOWER UNIT

REF.	PART #	DESCRIPTION	QTY.
1.	100382	COVER, MOTOR	1
2.	120582	DECAL, COVER	1
3.	130497	MOTOR, 120V SINGLE SPEED	1
	130494	MOTOR, 120V DUAL SPEED	1
	190742	BRUSH CARD ASM. (FOR 130494)	1
	190743	RECTIFIER	1
	130451	MOTOR, 120V (HD MODEL)	1
	130484	MOTOR, 220V SINGLE SPEED	1
	130488	MOTOR, 220V DUAL SPEED	1
	600281	BRUSH CARD ASM. (FOR 130488)	1
	190745	CONTROL, SPEED	1
	600807	MOTOR, 220V (HD MODEL)	1
4.	130762	CAPACITOR	1
	100058	TAPE, CAPACITOR	.17R.
	25519	CAPACITOR, RUN (SILVER) HD MODEL	1
	25518	CAPACITOR, START (BLACK) HD MODEL	1
5.	140226	SCREW, 5/16-18x.625	4
6.	140015	WASHER, LOCK	4
7.	230858	PLATE, LATCH	1
8.	140553	SCREW, 1/4-20x.5	2
9.	140016	WASHER, LOCK .25	2
10.	140003	WASHER, FENDER	2
11.	103064	WHEEL	2
12.	3148.816	WASHER, FLAT	4
13.	4252	WASHER, COMP.	4
14.	230851	AXLE	1
15.	100353	BASE, 17"	1
	100354	BASE, 20"	1
16.	130198	PLUG	1
17.	140824	SCREW, 1/4-20x.625	2
18.	140003	WASHER, FENDER	2
19.	100090	BUMPER	
		20" Model	4.25'
		17" Model	3.84'
20.	140046	WASHER, DS	4
21.	140003	WASHER, FENDER	4
	140027	WASHER, FLAT DS	4
22.	140016	WASHER, LOCK	4
	140015	WASHER, LOCK DS	4
23.	140212	SCREW, 1/4-20x1.5	4
	140216	SCREW, 5/16-18x1.5	4
24.	140255	SCREW, 1/4-20x1.75	4
25.	140016	WASHER, LOCK	4
26.	140000	WASHER, FLAT	4

# WIRING DIAGRAM

## SINGLE SPEED - 120V

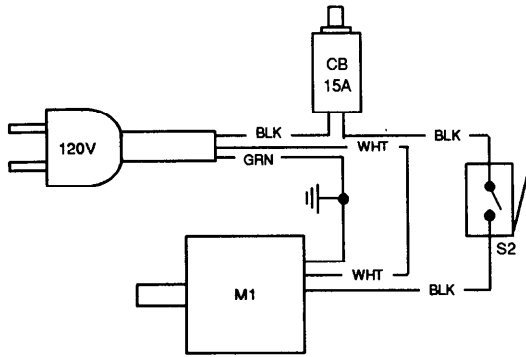

## SINGLE SPEED - 220V

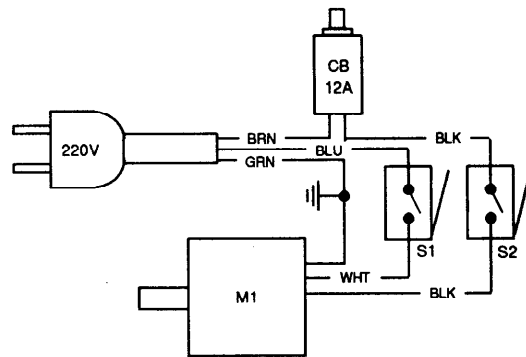

## DUAL SPEED - 120V

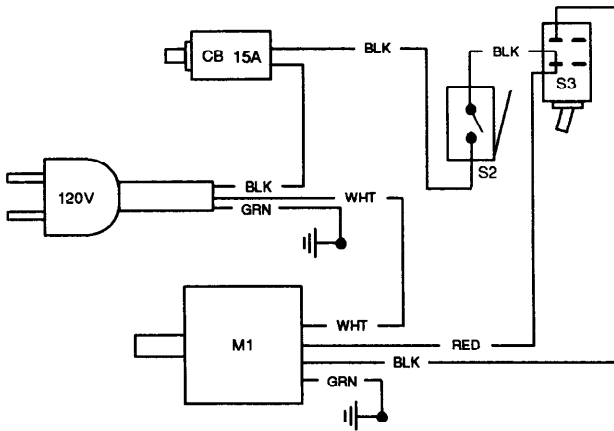

## DUAL SPEED - 220V

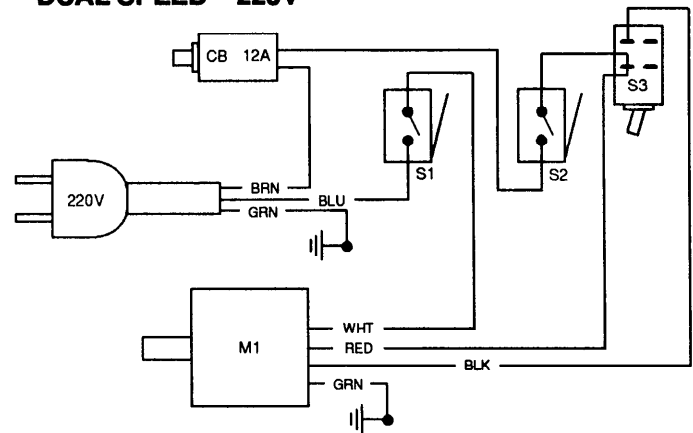

### LEGEND

- BLK = Black
- BRN = Brown
- BLU = Blue
- RED = Red
- WHT = White
- GRN = Green, Ground
- S1 = Switch, Roll
- S2 = Switch, Roll
- S3 = Switch, Dual Speed
- CB = Circuit Breaker
- M = Motor