

**Parts and Service Manuals From:**



**On Line Materials for the Jan San Industry.**

**Since 1922**

**Michigan Company Inc.  
2011 N. High St.  
Lansing, Mi 48906  
(517) 484-9312**

**[Http://www.Michco.Com](http://www.Michco.Com)**

**Email:Shop@Michco.com**

**Order parts on line or by Phone**

**Visa, MasterCard, Amex**

**Shipping to US addresses only.**

**Materials contained in this manual Copyright respective manufacturer, PDF version made exclusively by Michco for our customer's use only. Any other use of PDF version violates our PDF copyright.**



## OPERATOR'S MANUAL

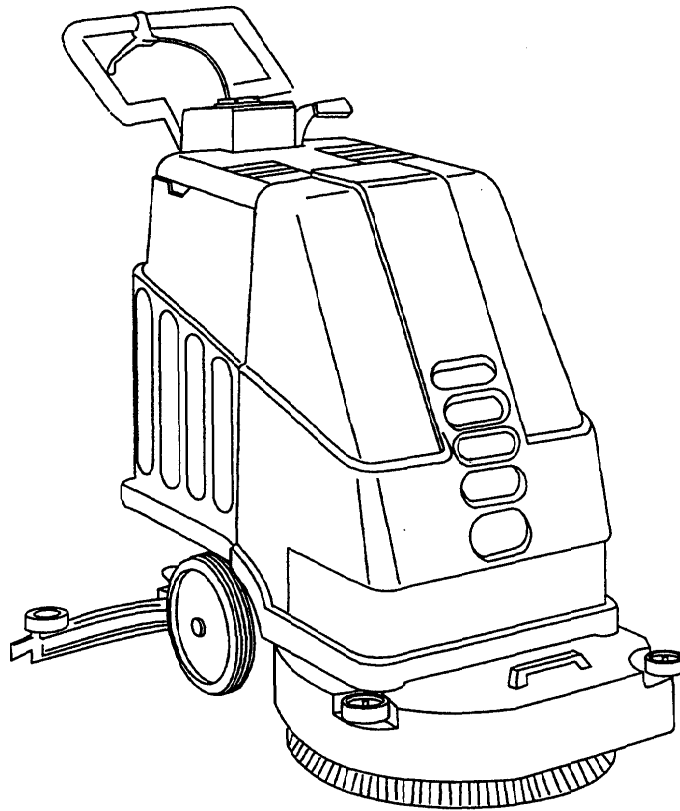

# **AS 20 AUTOMATIC**

## **AUTOMATIC SCRUBBER**

## SPECIFICATIONS

		<b>AS 20 AUTOMATIC</b>
Cleaning width	mm	455
Oscillating squeegee width	mm	740
Hourly capacity	m <sup>2</sup> /h	1590
Number of brushes	N	1
Brush diameter	mm	455
Brush rotation speed	RPM	135
Brush motor rated power	W	600
Suction motor rated power	W	450
Max suction vacuum	mm H <sub>2</sub> O	1400
Detergent solution tank capacity	l	29
Dirty water recovery tank capacity	l	34
Diameter of supporting wheels	mm	200
Noise level	dB(a)	69
Dry weight without batteries	Kg	60
Max battery weight	Kg	2 x 26
Length, height, width	mm	960x 500x 855x
Max battery dimensions (length, width, height)	mm	225x 180x 300
Max battery dimensions (length, width, height)	mm	225x 180x 300
Weight with packing and pallet	Kg	74
Packing dimensions with pallet (length, width, height)	mm	1055x 565x 1040

**We reserve the right to modify specification without notice or obligation.**

# DIMENSIONS

## AS 20 AUTOMATIC

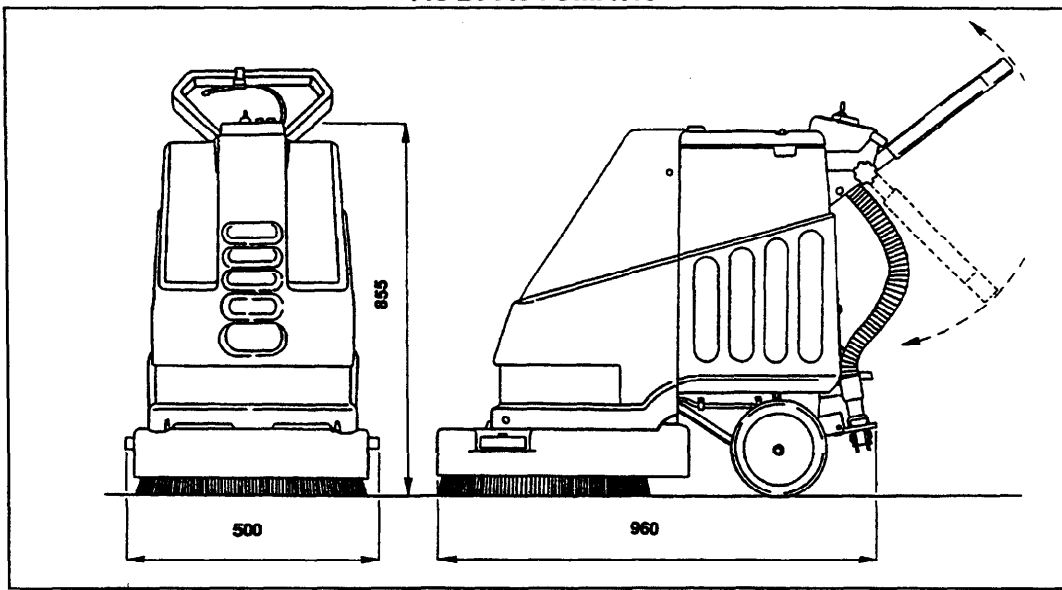

Fig. 1

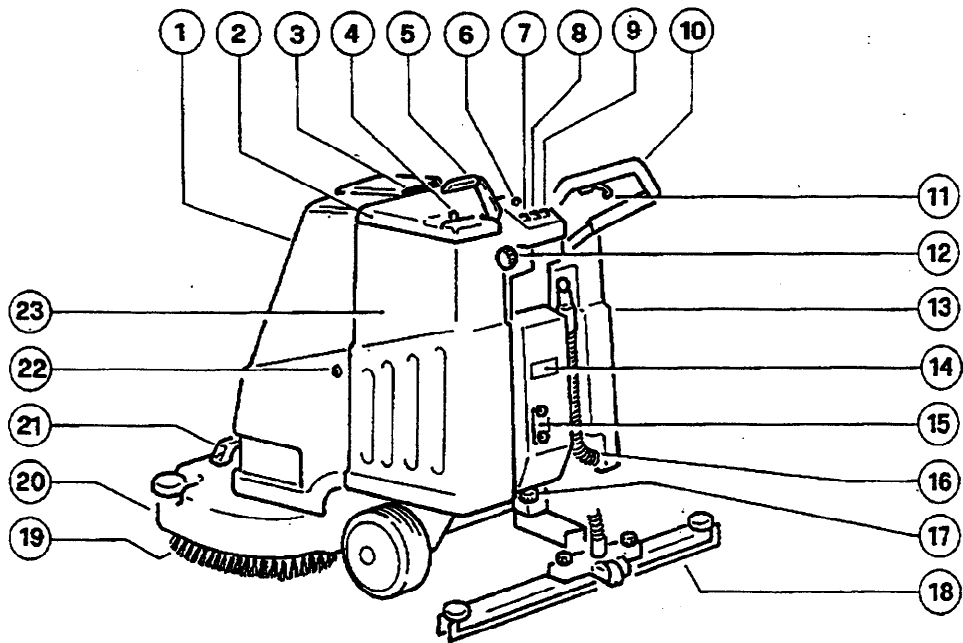

Fig. 2

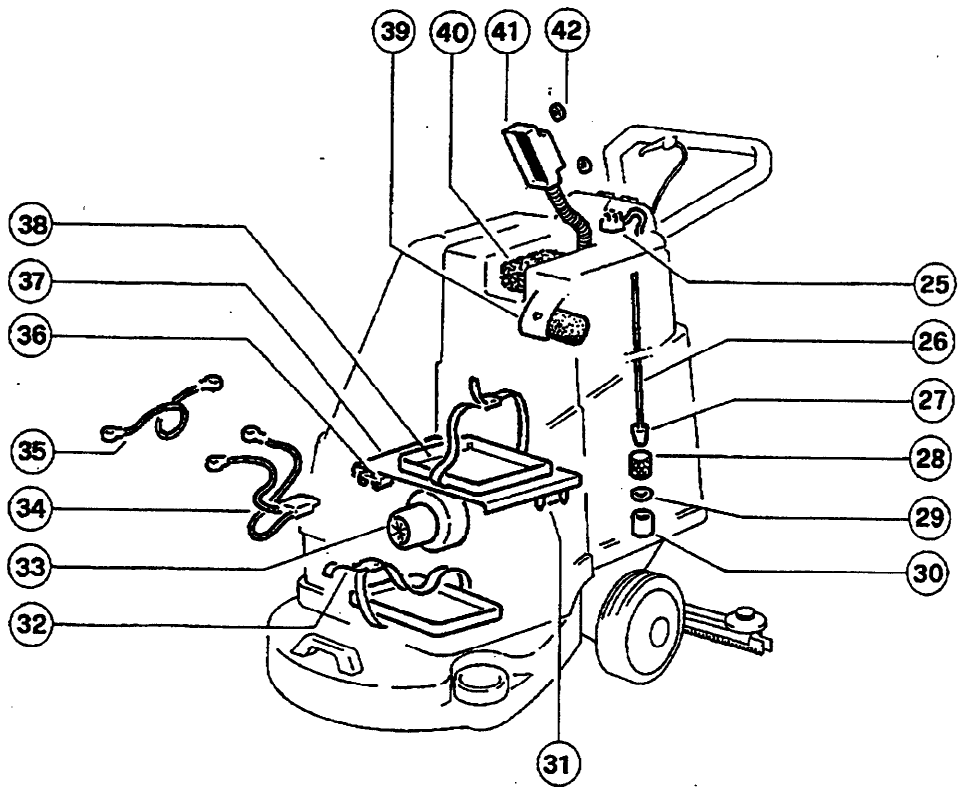

Fig. 3

**ENGLISH**

**1. INDEX**

<b>1. INDEX</b>	Page	2
<b>2. SAFETY PRECAUTIONS</b>	Page	3
<b>3. GENERAL INFORMATION</b>	Page	5
3.1 Machine identification	Page	5
3.2 General description	Page	5
3.3 Applications	Page	5
3.4 Detergents to be use	Page	5
<b>4. PREPARING THE MACHINE</b>	Page	6
4.1 Lifting and transporting the machine in its packaging	Page	6
4.2 Checks on delivery	Page	6
4.3 Unpacking	Page	6
4.4 Fitting the squeegee	Page	7
4.5 Electrical and earth connection (mains-operated model)	Page	7
4.6 Preparing the battery charger (battery-operated model)	Page	7
4.7 Installing the batteries (battery-operated model)	Page	7
<b>5. USING THE MACHINE</b>	Page	9
5.1 Description of the controls	Page	9
5.2 Adjusting the squeegee	Page	9
5.3 Adjusting the handgrip	Page	10
5.4 Discharging the dirty water	Page	10
5.5 Discharging the clean water	Page	10
5.6 Fitting and dismantling the bonnet	Page	10
5.7 Moving the machine	Page	10
5.8 Fitting and changing the brush/pad drive	Page	11
5.9 Preparing the machine for work	Page	11
5.10 Work	Page	11
5.11 End of work	Page	12
5.12 How to get the most out of your floor cleaner	Page	12
<b>6. ORDINARY MAINTENANCE</b>	Page	13
6.1 General	Page	13
6.2 Servicing and recharging the batteries (battery operated model)	Page	13
6.3 Cleaning the suction unit filter	Page	13
6.4 Cleaning the detergent solution tap	Page	14
6.5 General cleaning	Page	14
6.6 Replacing the squeegee blades	Page	14
6.7 Replacing the fuses (battery-operated model)	Page	15
6.8 Periodical lubrication	Page	15
6.9 Routine maintenance: daily operations	Page	16
6.10 Routine maintenance: weekly operations	Page	16
6.11 Routine maintenance: six-monthly operations	Page	16
6.12 Preparing for periods of prolonged inactivity	Page	16
<b>7. HOW TO ORDER SPARE PARTS</b>	Page	16
<b>8. TROUBLESHOOTING</b>	Page	17

## **2. SAFETY PRECAUTIONS**

Read this manual carefully before using the floor cleaner. The machine must not be operated by untrained or unauthorized personnel.

Ensure that the sockets used to power the mains-operated models or battery chargers are suitably earthed and that they are protected by magnetothermal and differential switches.

This automatic scrubber shall be grounded while in use to protect the operator from electric shock. The cable machine is provided with a three-conductor cable and a three-contact grounding type attachment plug to fit the proper grounding type receptacle. The green and yellow conductor in the cord is the grounding wire. Never connect this wire to the other than the grounding pin of the attachment plug.

Look at the series plate to see the voltage for which the cable machine is built: if this machine is for use on a nominal 120-Volt circuit it has a grounding plug that resembles the plug illustrated in figure A. Make sure that the machine is connected to an outlet having the same configuration as the plug. No adapter should be used with this machine.

If this machine is provided with an attachment plug as shown in figure B, it is intended for use on a nominal 240 Volt circuit. No adapter is available for this plug.

Ensure that the electrical characteristics of the machine (voltage, frequency, power absorbed), shown on the rating plate, correspond to those of the power distribution system.

Move the machine carefully on slopes and ramps. Do not reverse on slopes. Never park the machine on a slope.

This machine must be used only on slopes with a gradient of less than 2%.

The cleaner must not be used on public highways.

The machine can cause explosions if used in the vicinity of inflammable materials or vapours (fuel, solvents etc.). It must therefore not be used to suck up inflammable liquids, even if diluted.

Do not use in the presence of harmful dust.

Repairs must be carried out by specialist personnel only.

All maintenance operations must be carried out only after disconnecting the machine from the mains (always unplug). In the battery-operated version, disconnect the battery connector.

When using, be careful of other people and in particular children in the area. Do not leave the machine unattended with the plug connected.

To ensure correct operation of the machine, use non-foaming detergents.

Maintenance operations on the electric plant and all operations not mentioned in the followings must be done only by specialized persons.

## **ENGLISH**

### **Safety precautions for cable models**

During use, avoid squashing or ripping the mains cable.

Periodically check the mains cable to ensure that it has not been damaged. If damaged, the machine cannot be used.

If you have to replace the cable, plug or terminals, secure the electrical connections and cable strap (fig. 3, N°. 25) so that the cable cannot be ripped. Carefully refit the electrical boxes to ensure operator safety.

### **Safety precautions for battery models**

For battery maintenance and recharging, carefully follow the specific instructions given in this manual.

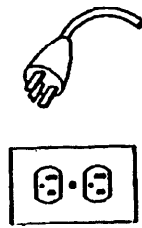

**Fig. A**

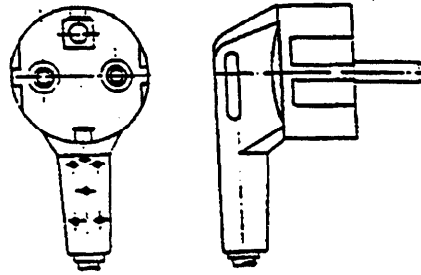

**Fig. B**

### **3. GENERAL INFORMATION**

#### **3.3 Machine identification**

This operating and service manual applies to models of single-brush floor cleaners. The machine identification plate is affixed to the electrical box in position N°. 14, fig. 2.

#### **3.2 General description**

This floor cleaner has been designed to wash and dry smooth, even floors free from obstructions. It is available in battery or mains-operated versions to satisfy all requirements.

The cleaner distributes a suitable amount of detergent over the floor and brushes it to remove the dirt. By using specific detergents or by fitting brushes made of different fibres or abrasive disks, the machine can be adapted to a wide range of floor and dirt types.

A liquid suction system incorporated in the cleaner provides for perfect floor drying.

The main parts of the machine are as follows (reference fig. 2):

- the detergent solution tank (N°. 23) which contains and transports the mixture of clean water and detergent;
- the recovery tank (N°. 13), used to collect the dirty water sucked up from the floor during washing;
- the squeegee (N°. 18), which wipes and therefore dries the floor, sucking up the dirty water;
- the brush (N°. 19).

#### **3.3 Applications**

Washing and drying of smooth and moderately rough floors.

Polishing.

#### **3.4 Detergents to be use**

This machine has been studied to work with specific detergents for scrubbers.

It is particularly recommended:

- to always dissolve detergents following the instruction given by detergent supplier;
- to employ only no-foam detergents;
- to never use sodium-hypochlorite or other oxidizers specially in high concentration;
- to never use solvents and hydrocarbons.

## **4. PREPARING THE MACHINE**

### **4.1 Lifting and transporting the machine in its packaging**

The machine is packed on a wooden pallet and can be moved by fork lift. Handle carefully, avoiding knocks, and do not overturn.

### **4.2 Checks on delivery**

When the transporter delivers the machine, carefully check the state of the packaging and ensure that the machine is intact. If it is damaged, inform the transporter but accept the delivery, reserving the right to submit a written claim for compensation for damages.

### **4.3 Unpacking**

Remove the machine from its packing as follows:

- cut and remove the plastic straps using scissors or nippers;
- lift and remove the carton;
- remove the squeegee (fig. 2, N°. 18) and brush (fig. 2, N°. 19) from their packaging;
- operate the squeegee lifting lever (fig. 2, N°. 5) and remove the tank cover (fig. 2, N°. 2), eliminating the sheet protecting the control panel;
- take out the envelope inside the dirty water tank (fig. 2, N°. 13) and the one attached to the handgrip (fig. 2, N°. 10) and check the contents:

envelope 1 (in the dirty water tank):

- testing check-list;
- warranty form;
- operating and service manual;

envelope 2 (attached to the handgrip):

- 2 knobs (fig. 2, N°. 12) for fixing the handgrip (fig. 2, N°. 10);
- 1 battery charger connector (only battery-operated model);

- take the two knobs out of the second envelope, raise the handgrip (fig. 2, N°. 10) until the two threaded holes correspond to two of the four slots in the upright and secure, tightening the knobs from the outside;
- remove the bonnet (only for the battery-operated model, fig. 2, N°. 1), holding it by means of the grip (fig. 2, N°. 3) and lifting it up;
- remove the battery wiring and jumper with terminals (only for the battery-operated model, fig. 3 - N°. 34 e N°. 35);
- according to the model cut and remove the plastic straps fixing the machine to the pallet using scissors or nippers, otherwise using spanners for unscrew the bolts on the brackets connecting the machine chassis to the pallet;
- raise the machine by means of the front handle (fig. 2, N°. 21) and handgrip (fig. 2, N°. 10) and remove it from the pallet;
- dispose of the packing cartons, pallet, steel brackets, bracket retaining bolts and plastic sheet, using differentiated waste bins if available.

#### 4.4 Fitting the squeegee

The squeegee (fig. 2, N°. 18) is the prime drying agent. To fit it on the machine, stand behind the handgrip with the squeegee blades facing down and the wheel (fig. 4, N°. 50) in the position shown in figure 4. Check that the squeegee support (fig. 4, N°. 47) is raised (if not, raise it by pulling back the squeegee lever fig. 2, N°. 5), loosen the two knobs (fig. 4, N°. 48) in the middle of the squeegee and slide it into the support. Secure the squeegee by tightening the two knobs.

#### 4.5 Electrical and earth connection (mains-operated model)

The rating plate (fig. 2, N°. 14) gives the electrical characteristics of the machine. Ensure that the frequency and power correspond to those of the power distribution system. As regards voltage, the models with rating plate indicating 230 V can be used for voltages of 220, 230 or 240 V. The same applies to the models with 115 V rating: they can be used at 110, 115 and 120 V. The frequency specified on the plate must, however, always be identical to the mains frequency.

Check that the electrical system is provided with a suitable earth line and that the sockets (and any adapters used) do not interrupt the earth leads.

**FAILURE TO OBSERVE THESE DIRECTIONS CAN RESULT IN SERIOUS DAMAGE TO PERSONS AND THINGS AND LAPSE OF THE WARRANTY.**

#### 4.6 Preparing the battery charger (battery-operated model)

If you wish to use a battery charger not supplied with the machine, it must be fitted with the connector sent with the machine in envelope 2 (see "Unpacking" paragraph).

To fit the connector:

- remove approximately 13 mm of protective sheathing from the two red and black battery charger cables;
- crimp the connector pin terminals on the cables;
- following the instructions enclosed with the connector, fit the cables with pin terminals into the semi-circular connector housings observing the polarity: red cable +, black cable -.

#### 4.7 Installing the batteries (battery-operated model)

This machine has been designed to use two 12 V batteries with a maximum weight of 2x26 kg and a capacity of 120 Ah (20h). The use of heavier batteries can seriously affect manoeuvrability and overheat the brush motor. Lighter, lower capacity batteries, on the other hand, will require recharging more often.

If the machine is delivered with **dry batteries**, they must be charged as follows before installation:

- after removing the caps, fill all the elements with the correct sulphuric acid solution for batteries with specific gravity 1,240 (28° Bé), at a temperature of 30° C, until the plates are fully covered (fill each element in two stages at least);
- leave to rest for 3-4 hours to give the plates time to absorb the electrolyte;
- check that the level of the liquid is still above the plates and if not, top up with the sulphuric acid solution;
- close the caps;
- instal the batteries in the machine (following the procedure below for tubular armoured batteries);
- recharge for at least 2-3 hours with an automatic 24V 20A battery charger before using the machine.

## **ENGLISH**

If the machine is supplied with **tubular armoured batteries**, instal them following the instructions below:

- if the bonnet (fig. 2, N°. 1) is fitted on the machine, remove it by gripping and lifting at the point shown in figure 2, N°. 3;
- on the upper battery support (fig. 3, N°. 37), at the side of the upper battery plate (fig. 3, n° 38), there is a label showing the layout of the batteries and cables: the battery on the top plate must have the + and - poles facing the tanks, whereas the ones on the lower plate must face away from the tanks;
- open the fastening of the lower battery holder belt (fig. 3, N°. 32) and adjust so that its ends face the side opposite the suction motor (fig. 3, N°. 33) (i.e. the left side of the machine) to prevent them obstructing the battery plate;
- position the battery as shown on the label for the lower plate and fit it on the lower plate;
- wrap the belt around the battery, inserting the free end into the fastening, and tighten to lock;
- repeat the procedure for the upper battery making sure that you observe the position shown by the label;
- referring to the cable layout shown on the label, connect the terminals of the battery wiring (fig. 3, N°. 34) and of the jumper with terminals (fig. 3, N°. 35) to the battery poles (be careful only to fit terminals marked with the symbol + on the positive poles). Position the cables as shown in the label, tightening the terminal fixing bolts with a 10 mm spanner and coat the terminals with vaseline. Check that all the switches on the control panel are set to 0 (off) and connect the battery wiring connector to the one on the machine on the battery support over the vacuum motor;
- use the machine according to the instructions given below until the battery flat light starts to blink, indicating that the battery needs recharging.

## 5. USING THE MACHINE

### 5.1 Description of the controls

Electrical controls and indicator lights on the control panel:

- **POWER INDICATOR LIGHT** (fig. 2, N°. 6; only mains-operated model): light indicating that the machine cable is connected to the mains;
- **BATTERY CHARGE CONTROL LIGHT** (fig. 2, N°. 6; only battery-operated model) with three different modes:  
off: the battery is disconnected or all the switches are set to 0 (off);  
blinking: the batteries are flat and must be immediately recharged - if you continue working, the batteries may be permanently damaged;  
on: battery charged;
- **BRUSH SWITCH** (fig. 2, N°. 7): enables (I) and disables (O) the brush motor;
- **SUCTION MOTOR SWITCH** (fig. 2, N°. 8): switches the suction motor on and off;

Other controls:

- **BRUSH CONTROL LEVER** (fig. 2, N°. 11): located on the handgrip, it drives the motor which rotates the brush and moves the machine forward; the cleaner is provided with a special mechanical traction device by means of which the friction between brush and floor is used to generate forward thrust;
- **SQUEEGEE LEVER** (fig. 2, N°. 5): located on the left side of the column and enables the operator to raise (if pulled back) and lower (if pushed forward) the squeegee;
- **TAP CONTROL SLIDER** (fig. 2, N°. 4): located above the tanks on the left side of the machine, it permits continuous regulation of the flow of detergent solution from 0 to approximately 3 l/min;
- **SQUEEGEE ANGLE ADJUSTMENT KNOB** (fig. 4, N°. 46): located on the squeegee arm, it permits vertical adjustment of the squeegee angle;
- **SQUEEGEE HANDLE** (fig. 4, N°. 45): located above the squeegee arm, it permits regulation of the pressure exerted by the squeegee on the floor;
- **SPEED REGULATION KNOB** (fig. 2, N°. 17): permits slight adjustments in forward speed and correction of any tendencies to deviate sideways.

### 5.2 Adjusting the squeegee

The squeegee is provided with two adjustments so that it can be adapted to all types of surface:

- angle: adjusted by rotating the appropriate knob (fig. 4, N°. 46);
- pressure: adjusted by moving the spring working point via the appropriate handle (fig. 4, N°. 45); minimum pressure corresponds to the highest working point.

Combined adjustment of angle and pressure will provide perfect drying. For effective adjustment, the rubber sheet at the rear must be bent back slightly when the machine is moved forwards.

### **5.3 Adjusting the handgrip**

To suit all heights, the handgrip can be adjusted to two positions as follows:

- unscrew the two fixing knobs (fig. 2, N° 12);
- raise (or lower) the handgrip (fig. 2, N° 10) until the slots on the upright coincide with the threaded holes on the handgrip;
- fit and tighten the knobs.

### **5.4 Discharging the dirty water**

To empty the tank:

- position the machine over a drain hole;
- remove the tank lid (fig. 2, N° 2);
- pull out the discharge pipe (fig. 2, N° 16);
- holding the end of the pipe as high as possible, remove the cap;
- gradually lower the end of the pipe, regulating the flow according to its height from the ground;
- check the amount of residual dirt in the tank and flush out if necessary;
- once the contents of the tank have been fully discharged, refit the cap and reposition the pipe;
- replace the tank lid, checking that it is perfectly closed.

### **5.5 Discharging the clean water**

To empty the tank:

- position the machine over a drain hole;
- pull out the discharge pipe (fig. 2, N° 16);
- holding the end of the pipe as high as possible, remove the cap;
- gradually lower the end of the pipe, regulating the flow according to its height from the ground;
- once the contents of the tank have been fully discharged, refit the cap and reposition the pipe.

### **5.6 Fitting and dismantling the bonnet**

To remove the bonnet (battery-operated model fig. 2, N° 1):

- grip at the point shown in fig. 2, N° 3 and lift up to remove.

To fit the bonnet (battery-operated model):

- align the bonnet with the tanks;
- lower it and press down to click into place.

To remove and refit the bonnet (mains-operated model):

- unscrew the two fixing screws (fig. 2, N° 22) using a 4 mm Allen key and remove the bonnet (fig. 2, N° 1). Refit, tightening the screws.

### **5.7 Moving the machine**

To move the machine:

- remove the brush (or pad drive) following the instructions in the paragraph below;
- raise the squeegee;
- raise the front part of the machine by pressing down on the handgrip;
- push forward.

## 5.8 Fitting and changing the brush/pad drive

To fit the brush (fig. 2, N°. 19), rest it on the floor in front of the machine, stand behind and press on the handgrip in order to raise the front part, push the machine forward (maintaining the pressure on the handgrip) and line up the brush hub (fig. 2, N°. 20) with the brush. Rest the machine on the brush. Rapidly operate the brush control lever a few times: the brush will automatically screw onto the hub.

If this operation is not successful, realign the brush and repeat the above operations.

To use an abrasive disk, fit it on the pad drive and carry out the above operations.

To **remove** the brush (or pad drive) follow one of the following procedures:

- a) raise the front part of the machine by pressing the handgrip down and repeatedly operate the brush control lever in rapid succession. This will release the brush (or pad drive) which will fall to the ground;
- b) push the machine forward, press down on the handgrip to slowly raise the front while continuing to push the cleaner forward. The brush (or pad drive) will come off as it grazes the floor.

## 5.9 Preparing the machine for work

- For the battery-operated model, recharge the batteries if necessary;
- lift and remove the tank cover (fig. 2, N°. 2);
- empty the recovery tank (fig. 2, N°. 13) if necessary, following the procedure already described;
- check that the tap control slider (fig. 2, N°. 4) is in the closed position (i.e. positioned at the extreme left of the machine);
- pour clean water and detergent in the right concentration into the solution tank (fig. 2, N°. 23) leaving a gap of at least 5 cm between the surface of the liquid and the tank inlet;
- refit the tank cover (fig. 2, N°. 2).

## 5.10 Work

Once you have prepared the machine with the mains cable connected to the power socket (or with the batteries charged and the battery wiring connector (fig. 3, N°. 34) connected to the cleaner (fig. 3, N°. 36)), with the detergent solution tank (fig. 2, N°. 23) full and with the brush fitted:

- set the brush switch (fig. 2, N°. 7) to position I;
- set the suction motor switch (fig. 2, N°. 4) to position I: the suction unit will start up;
- push the squeegee lever forward (fig. 2, N°. 8): the squeegee will touch the floor;
- move the tap control slider (fig. 2, N°. 4) to the right: the tap will open, allowing the detergent solution to flow to the brush;
- pull the brush control lever (fig. 2, N°. 11): the brush (or pad drive) will rotate, washing the floor and exerting a thrust that will move the machine forward;
- guide the machine over the floor to be washed;
- adjust the squeegee and the flow of detergent solution as required via the controls (fig. 4, N°. 45 and N°. 46; fig. 2, N°. 4);
- for the battery-operated version, monitor the battery charge control light (fig. 2, N°. 6) which must always be on during work. When the light begins to blink, the batteries are low and you must stop immediately to recharge them. Continuing to wash with the light blinking can lead to permanent battery damage;
- monitor washing performance and replace the detergent solution when it has run out;
- do not stand still with the suction unit on and the detergent solution tap (fig. 2, N°. 4) open;
- every time you fill the detergent tank (fig. 2, N°. 23), always empty the recovery tank (fig. 2, N°. 13).

**Note:** if the brush control lever (fig. 2, N°. 11) is operated intermittently for a prolonged period, the brush motor may overheat consequently damaging the motor. In addition, in the mains-operated version the motor needs 2-3 seconds' rest in order to start up again without straining.

You should therefore use the lever in this way only when necessary, for example when moving round obstacles.

### **5.11 End of work**

- Let the vacuum motor work for 2 minutes with the tank cover open to be sure the vacuum motor itself is well dry;
- check that the tap control slider (fig. 2, N°. 4) is in the closed position (i.e. positioned at the extreme left of the machine);
- remove the brush (or pad drive) to avoid permanent deformation;
- lift the squeegee from the ground (control fig. 2, N°. 5) to avoid continuous pressure deforming the drying blades and therefore affecting performance;
- empty and clean the recovery tank;
- unplug, or recharge the batteries according to the model.

### **5.12 How to get the most out of your floor cleaner**

When removing particularly stubborn dirt, washing and drying can be performed in two separate stages:

- **prewashing:** open the water tap and begin washing with the suction unit off and squeegee raised, going over the dirtiest points several times. This gives the detergent time to act and the brush time to perform efficiently;
- **drying:** lower the squeegee, start the suction unit motor and go over the same area again.

This ensures thorough washing and will considerably reduce subsequent routine cleaning.

For easy use and maximum efficiency, you are advised to work in straight lines as far as possible, going over any areas that cannot be reached with the cleaner at the end, using a mop or cloth.

## 6. ORDINARY MAINTENANCE

### 6.1 General

To avoid damage to persons and the cleaner itself, always disconnect the power supply cable (in the mains-operated model) or the battery connector before carrying out any maintenance operations. The power supply cable of the battery charger, if incorporated, must also be disconnected from the mains.

Maintenance operations on the electric plant and all operations not mentioned in the followings must be done only by specialized persons.

### 6.2 Servicing and recharging the batteries (only battery-operated model)

To charge the **lead batteries** with liquid electrolyte, proceed as follows:

- move the cleaner to a well ventilated area (the batteries release inflammable vapours: before opening the caps, always move to a well ventilated area away from fires, sparks, lit cigarettes etc.);
- remove the bonnet (fig. 2, N°. 1);
- remove the battery caps and check that the electrolyte covers the plates; if not, top up with distilled water;
- disconnect the battery wiring connector (fig. 3, N°. 34) from the one fixed to the cleaner chassis and connect it to the battery charger socket. (**Caution:** DO NOT connect the battery charger to the fixed connector on the cleaner chassis);
- recharge, regulating the battery charger according to the instructions;
- once the batteries are charged, check with a densimeter. If one or more elements are flat according to the densimeter (whereas the adjacent elements are perfectly charged) it is a sign that the battery is damaged and must therefore be replaced;
- close the caps again, reconnect the battery wiring to the machine and replace the bonnet.

If the machine requires **gelatine batteries**, follow the instructions below:

- remove the bonnet;
- disconnect the battery wiring connector from the one fixed to the cleaner chassis and connect it to the battery charger socket. (**Caution:** DO NOT connect the battery charger to the connector fixed to the cleaner chassis);
- only use a battery charger specifically designed for gelatine batteries; recharge, regulating it according to the instructions;
- reconnect the battery wiring to the machine and replace the bonnet.

### 6.3 Cleaning the suction unit filter

- Remove the tank cover (fig. 2, N°. 2);
- unscrew the knobs (fig. 3, N°. 42) and remove the filter box (fig. 3, N°. 41) and filter (fig. 3, N°. 40);
- clean the filter under running water, leave to dry and refit everything.

### 6.4 Cleaning the detergent solution tap

To eliminate any scale that may prevent perfect closure of the tap, follow the instructions below:

- remove the tank cover (fig. 2, N° 2) and completely empty the detergent solution tank (fig. 2, N° 23);
- slide your hand inside the detergent solution tank; grip the solution rod (fig. 3, N° 26) and pull up to disengage it from the tap body (fig. 3, N° 30);
- pull out the solution filter (fig. 3, N° 28) and clean it;
- clean the tap body (fig. 3, N° 30) and shutter (fig. 3, N° 27) using a cloth soaked in detergent;
- refit the filter;
- replace the shutter, pulling the solution rod up again.

### 6.5 General cleaning

When cleaning the machine, always bear the following in mind:

- avoid using hydrocleaners: water could seep into the electrical boxes or motors consequently damaging them or causing a short circuit;
- do not use steam as the heat will deform the plastic parts (casings and tanks) and make the nylon wheel bearings unserviceable;
- do not use solvents or hydrocarbons: you could damage the casings or rubber parts.

### 6.6 Replacing the squeegee blades

The job of the squeegee blades is to scrape the film of water and detergent from the floor thus permitting perfect drying. With use, continuous friction will blunt and crack the sharp edge in contact with the floor, affecting drying efficiency and thus requiring replacement of the blade.

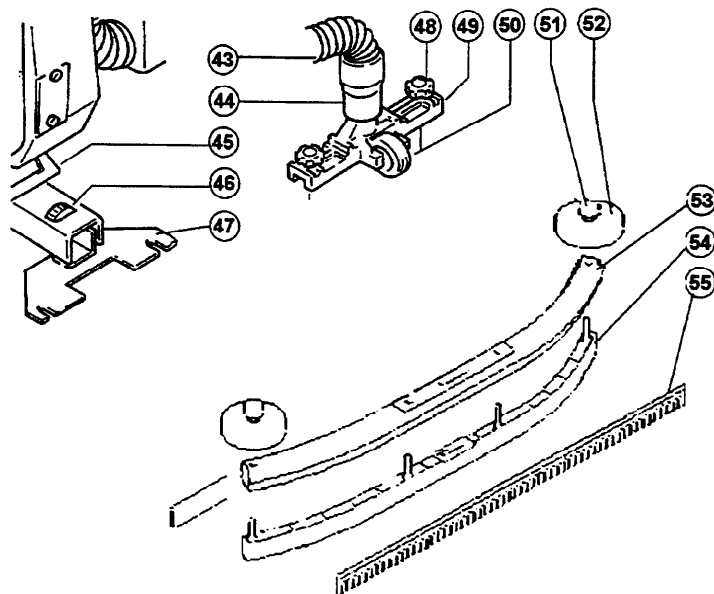

**Fig. 4**

Each squeegee is fitted with two blades, only one of which will be subject to wear. Initially therefore, when one blade is worn, simply swap them round and then when the second one is worn, replace them both.

**Swapping the blades** (for references see fig. 4):

- remove the squeegee from its support (N°. 47), sliding out the coupling (N°. 44) of the suction pipe and loosening the two knobs (N°. 48);
- completely unscrew the two knobs (N°. 48) and disconnect the squeegee inlet (N°. 49) from the squeegee profile (N°. 53); rotate the inlet by 180° with respect to the profile and refit on the profile;
- refit the squeegee on its support (N°. 47), ensuring that the wheel (N°. 50) is positioned at the back with respect to the cleaner. Tighten the two knobs (N°. 48) and connect the coupling (N°. 44).

**Replacing the blades** (for references see figure 4):

- remove the squeegee from its support (N°. 47), completely unscrewing the two knobs (N°. 48), slide out the coupling (N°. 44) of the suction pipe and disconnect the squeegee inlet (N°. 49) from the squeegee profile (N°. 53);
- unscrew the two knobs (N°. 51) and remove the wheels (N°. 52);
- turn the squeegee over and press the protruding threaded pins down to release the insert (N°. 54);
- remove the worn blades (N°. 55) and replace them with the new ones, inserting the protruding tooth into the profile housing (N°. 53); check that the teeth of both blades are perfectly positioned in the profile;
- refit the insert (N°. 54), the wheels (N°. 52), the inlet (N°. 49) and knobs (N°. 51);
- refit the squeegee on its support (N°. 47), ensuring that the wheel (N°. 50) is positioned at the back with respect to the cleaner. Tighten the two knobs (N°. 48) and connect the coupling (N°. 44).

## **6.7 Replacing the fuses (battery-operated model)**

To replace the fuses in the back of the machine:

- remove the fuse cover (fig. 2, N°. 15);
- using the tweezers provided with the machine, remove the blown fuses and replace them with new ones with the same amperage;
- close the fuse cover.

The 60 A (fig. 3, N°. 31) fuse that protects the brush motor is located at the front of the machine above the brush motor.

To remove it:

- raise the bonnet;
- remove the fuse by unscrewing the retaining screws;
- fit a new fuse and replace the bonnet.

If a fuse continues to blow, the fault in the wiring, in the electronic cards or in the motors must be identified and repaired; have the machine checked by qualified personnel.

## **6.8 Periodical lubrication**

This cleaner does not require any periodical lubrication.

### **6.9 Routine maintenance: daily operations**

Every day, at the end of work, carry out the following operations:

- check that the overflow valve (fig. 3, N°. 39) is working correctly;
- check that the recovery tank (fig. 2, N°. 13) is not encrusted with dirt; if so, clean it;
- clean the suction motor filter (fig. 3, N°. 40);
- check that the filter (fig. 3, N°. 28) of the detergent solution tanks clean;
- clean the squeegee blades (fig. 2, N°. 18) checking that they are not excessively worn and that they have not been torn;
- recharge the batteries following the procedure previously described (only battery-operated model).

### **6.10 Routine maintenance: weekly operations**

- Check that the squeegee suction hole is not clogged; remove any encrusted dirt if necessary;
- clean the suction pipe (fig. 4, N°. 43);
- check the level of electrolyte in the batteries and top up with distilled water if necessary (only battery-operated model).

### **6.11 Routine maintenance: six-monthly operations**

- Have the electrical system checked by qualified personnel.

### **6. 12 Preparing for prolonged periods of inactivity**

If the machine is not going to be used for a long period, proceed as follows:

- dismantle the squeegee (fig. 2, N°. 18), wash it and pack in a plastic envelope or sheet;
- remove the brush (or pad drive);
- empty and thoroughly clean both tanks (fig. 2, N°. 13 and N°. 23);
- completely recharge the batteries before storing them in the warehouse with the battery wiring connector (fig. 3, N°. 34) disconnected from the connector on the machine. Recharge periodically (at least once every two months).

## **7. HOW TO ORDER SPARE PARTS**

To enable our servicing department to correctly identify the spare parts required, and therefore to provide an efficient service at all times, the following information must ALWAYS be provided:

- machine model;
- serial number (see rating plate fig. 2, N°. 14);
- spare parts table showing the part and reference number;
- part code;
- quantity required.

For replacement under warranty, a brief description of the fault must also be enclosed with the order.

8. TROUBLESHOOTING

Fault	Cause	Remedy
The solution does not flow out	* The solution tank (fig. 2, N°. 23) is empty	* Fill it
	* The solution filter (fig. 3, N°. 28) or pipes are obstructed	* Clean the filter and remove the obstruction in the pipes
	* The tap is damaged	* Repair or replace the tap
The flow of solution does not stop when the tap is closed	* The tap remains open because it is damaged or very dirty	* Clean or repair the tap, checking that it closes properly
The squeegee does not suck up the dirt	* The overflow valve (fig. 3, N°. 39) is closed	* Free the overflow valve
	* The dirty water tank (fig. 2, N°. 13) is full	* Empty the tank to release the overflow valve
	* There is an obstruction in the suction pipe (fig. 4, N°. 43)	* Unclog the pipe
	* The suction pipe is not connected to the squeegee	* Connect the pipe
	* The suction motor does not work	* Check the fuse (battery-operated version) and motor connections. If necessary, replace the motor
The squeegee leaves traces of dirty liquid on the floor	* The squeegee angle and/or pressure are not correctly adjusted	* Adjust the squeegee following the instructions
	* The blade edge in contact with the floor is worn	* Replace the blade
	* The squeegee or pipe is clogged or damaged	* Unclog and repair the damage
The batteries run flat sooner than expected	* The poles and terminals of the batteries are dirty and oxidized	* Clean and grease the poles and terminals and recharge the batteries
	* The level of electrolyte is too low	* Add distilled water, topping up each element according to the instructions
	* The battery charger does not work	* See battery charger instructions
	* The densimeter test reveals significant differences between various elements in the same battery	* The battery is damaged and must be replaced

**ENGLISH**

Fault	Cause	Remedy
The machine does not clean evenly	* The brush or abrasive disk is worn	* Replace
The machine runs too fast or does not move at all and tends to pull to one side	* The brush pressure must be adjusted	* Adjust the brush pressure via the speed regulation knob (fig. 2, N°. 17)
The brush motor has trouble starting (only mains-operated model)	* You are working with a dry brush on a very rough floor	* Open the detergent solution tap
	* You are working with extension leads with inadequate section or the voltage is significantly lower than the value specified on the machine rating plate (15% less)	* Avoid using inadequate extension leads, increase the section to minimum ..... mm, use sockets with higher voltage
	* One or both of the capacitors has developed a fault	* To be controled by specialized persons
	* The centrifugal earth protection is faulty	* To be controled by specialized persons
The brush motor does not work	* The brush switch (fig. 2, N°. 7) is set to 0 (off)	* Turn the brush switch on
	* The fuse F1 (services) has blown (only battery-operated model)	* Replace the fuse
	* The motor thermal protection has cut in (only for battery-operated model)	* Leave the machine to cool down for at least 45'
	* The F7 brush motor fuse has blown (only for battery-operated model)	* Replace the 60A fuse (fig. 4, N°. 31) above the brush motor
	* Both capacitors are faulty (only mains-operated model)	* To be controled by specialized persons
	* The motor is faulty	* To be controled by specialized persons

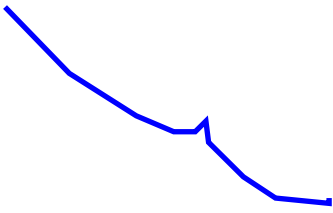

WE RESERVE THE RIGHT TO MODIFY SPECIFICATIONS WITHOUT NOTICE OR OBLIGATION



BETCO

1001 Brown Avenue - Toledo, Ohio 43607 - 1-800-777-9343