



# Electronic Service Manuals

This electronic document is provided as a service to our customers. We do not create the contents of the information contained in this document. Should you have detailed questions pertaining to the information contained in this document, you may contact Michco, or the manufacturer which provided the original information in this electronic deliverable. Michco's only part in this electronic deliverable was the electronic assembly process.

You may contact Michco through the following methods:  
Phone (517) 484-9312 or (800) 331-3339 MI, OH, IN only  
2011 N. High St. -- Lansing, Michigan -- 48906  
Fax: (517) 484-9836  
Email: [CustServ@Michco.com](mailto:CustServ@Michco.com)  
Web site: [www.Michco.Com](http://www.Michco.Com)  
Parts Web site: [www.FloorMachineParts.Com](http://www.FloorMachineParts.Com)

Order Parts on Line at:  
**[www.FloorMachineParts.Com](http://www.FloorMachineParts.Com)**

Directly to Parts & Service:  
By Email: **[Shop@Michco.com](mailto:Shop@Michco.com)**  
By Fax: (517) 702-2041  
By Voice: Use numbers above.

**Serving the Cleaning Industry Since 1922**

Notice: All copyrighted material remains property of original owners, all trademarks are property of respective owners. Manuals are subject to Manufacturer's reproduction limitations. Originals or reproductions were provided by manufacturers through a request. We make no warranty as to the correctness of information provided in this document and you assume all risk.

# BackVacuum XP

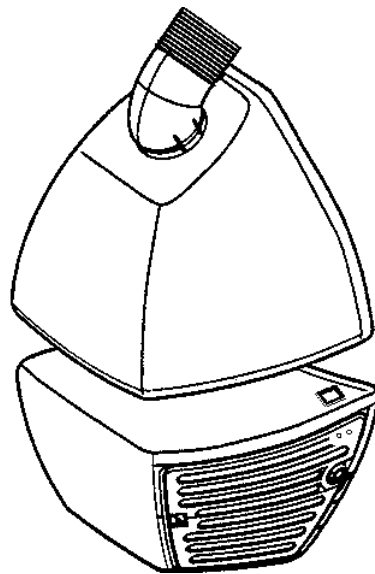

## PARTS LIST

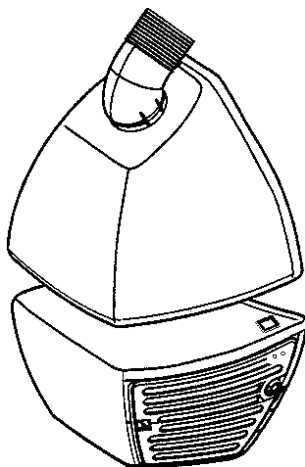

**TABLE OF CONTENTS SERVICE KIT****01/06****BACKVACUUM XP - BACK-PACK CLEANER****1**

<b>DESCRIPTION</b>	<b>PLAN</b>
Motors, internal wires and cords	2
Container upper parts	4
Container lower parts	6
Electric items	8
Motorfilter and exhaust filter (Standard and HEPA)	10
Nozzles	12
Tubes, hose and dust bag	14
Electrical Diagram	16

**MOTOR SERVICE KIT**

**2**

**MOTOR AND CORD TYPES**

**01/06**

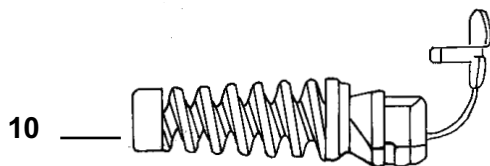
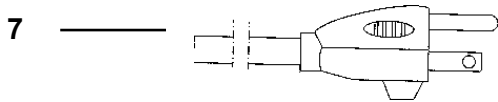
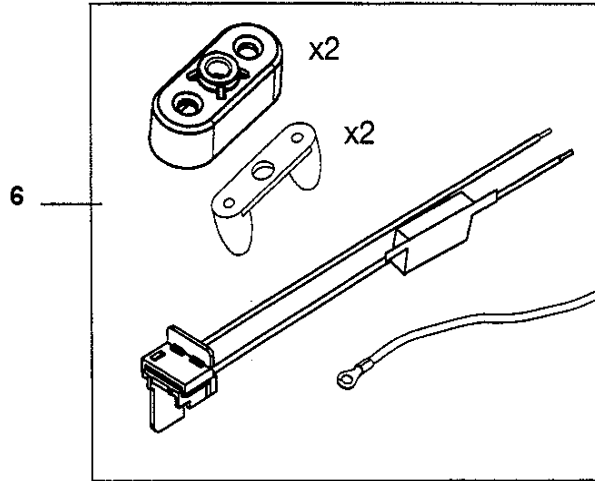
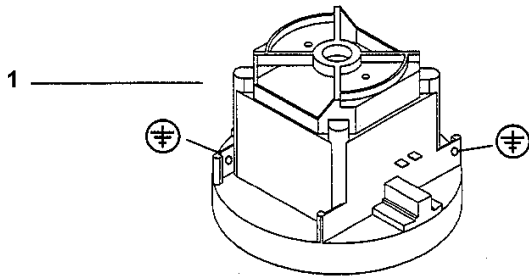

**MOTOR SERVICE KIT****01/06****MOTOR AND CORD TYPES****3**

<b>Item</b>	<b>Ref.No.</b>	<b>Qty.</b>	<b>Description</b>	<b>Note</b>	<b>EAN code 5715492+</b>
1			Motor/fan unit for:	Mat.: plast and steel	
	56100947	1	110-120V, 50-60Hz, 1000W	grounded +008420	
6	56100948	1	Internal wire kit for for grounded version, with thermo switch and cable relief	Mat.: PVC and copper, PP	+008308
7	140 8037 000	1	Extension cord with plug and socket. Grounded	Mat.: PVC and copper Length=15m (49 ft.) Colour=orange	7319519512984
	140 3859 090	1	Cord, from the machine with plug. 18 AWG.	Length 0,4m (1.31 ft)	7319519512991
10	140 7688 000	1	Strain relief		7319519511741

**CONTAINER SERVICE KIT**

**4**

**UPPER PART BACK-PACK VACUUM CLEANER**

**01/06**

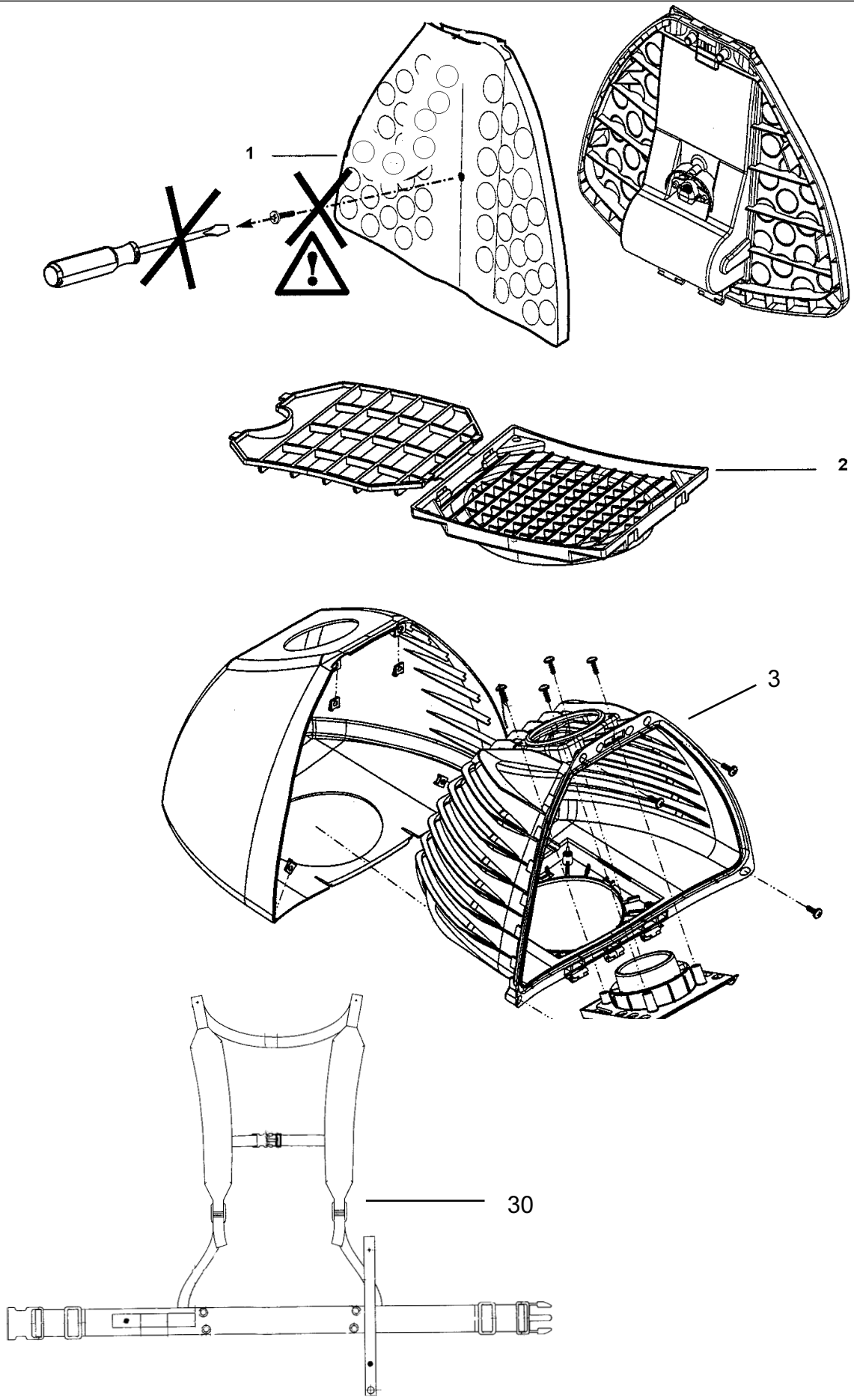

**CONTAINER SERVICE KIT**

02/04

**UPPER PART BACK-PACK VACUUM CLEANER****5**

<b>Item</b>	<b>Ref.No.</b>	<b>Qty.</b>	<b>Description</b>	<b>Note</b>	<b>EAN code 5715492+</b>
1	56100907	1	Dust chamber lid complete	Mat.: ABS grey RAL 7001	+006694
	82153800	1	Cover for Lid		
2	56100908	1	Frame for main filter complete		+006755
3	56100944	1	Dust chamber complete	Mat.: ABS	+007806
	62152700	1	Gasket for Dust Chamber		
30 >>	140 7863 010	1	Fixed straps cpl.	Mat.:Polyprop.	7319519611595
	1407863510	1	Fixed Strap Kit (for machines before SN013500001)		

**CONTAINER SERVICE KIT**

**6**

**LOWER PART BACK-PACK VACUUM CLEANER**

**01/06**

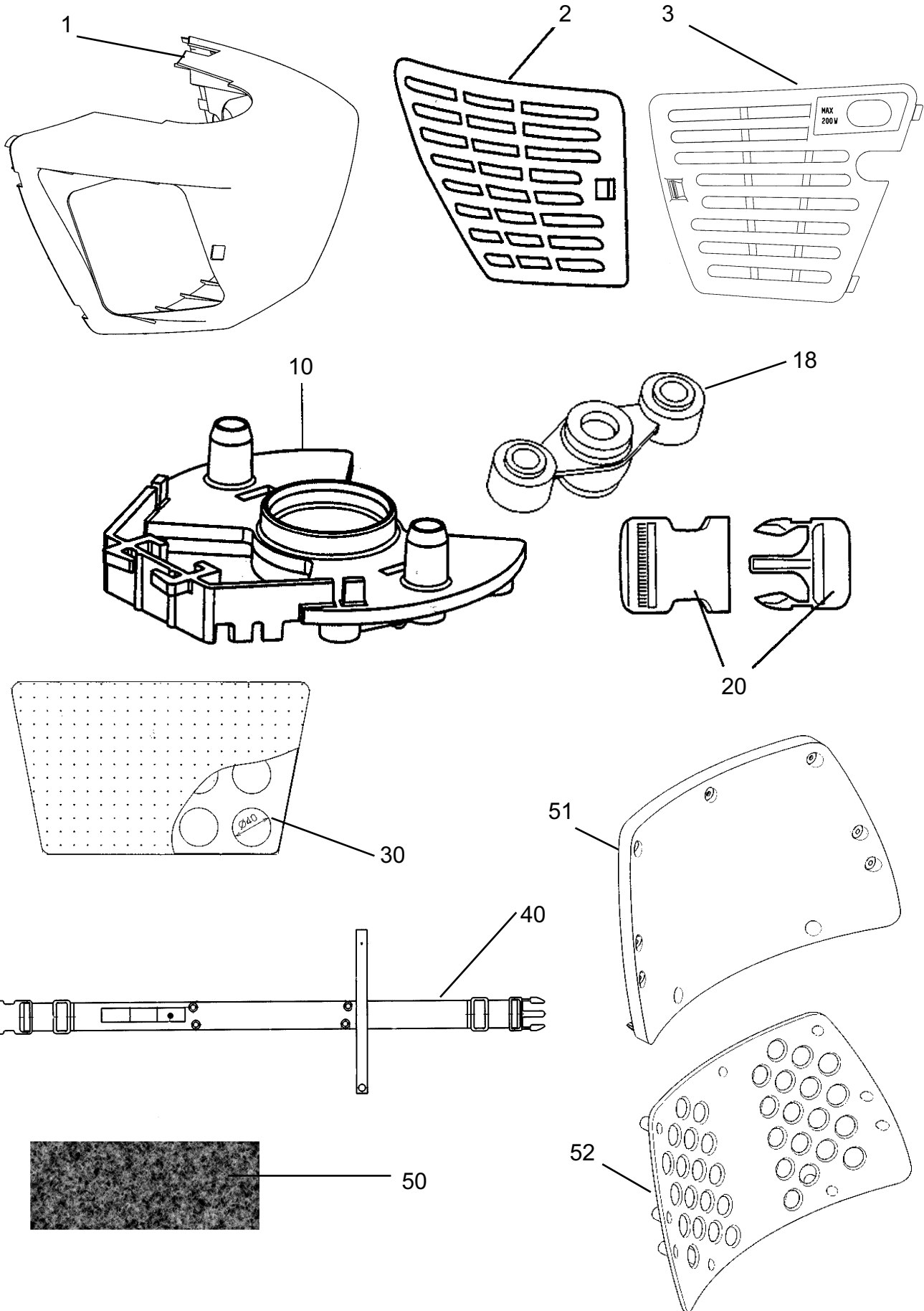

**CONTAINER SERVICE KIT****01/06****LOWER PART BACK-PACK VACUUM CLEANER****7**

<b>Item</b>	<b>Ref.No.</b>	<b>Qty.</b>	<b>Description</b>	<b>Note</b>	<b>EAN code 5715492+</b>
1	140 8031 000	1	Motor housing cover	Mat.: ABS colour: grey, RAL 7001	7319519513028
2	56100910	1	Grid,one left and one right	Mat.: ABS colour:grey RAL 7001	+006700
3	140 8030 000	1	Grid, right w.hole f. outlet	Mat.: ABS colour:grey RAL 7001	7319519513059
10	56100911	1	Motor suspension		+006748
18	82157400	1	Rubber suspension	Mat.: Rubber type S8R	7319519492941
20	56100912	1	Buckles male/female complete	Mat.: PP colour:black	+006786
30	140 7934 000	1	Mesh cushion cpl. With velcro tape	Mat.: Polyester Airmesh and hard foam. colour:black	7319519509205
40	82152500	1	Belt cpl.	Mat.; Polypr. web. Eylet; bronze + nickel coated	7319519492781
50	140 7975 000	1	Heat reflector, for the back cover	Mat.;Recfoam polyester, LBR Tape Standard from serial number 002200001	7319519510874
51	140 8032 000	1	Back Plate	Mat.; ABS Cycolac S701 colour: grey RAL 7001	7319519513035
52	140 7949 000	1	Distance Plate	Mat.; ABS Cycolac S701 colour: grey RAL 7001	7319519511765

**ELECTRICAL SWITCH SERVICE KIT**

**8**

**ELECTRICAL ITEMS**

**01/06**

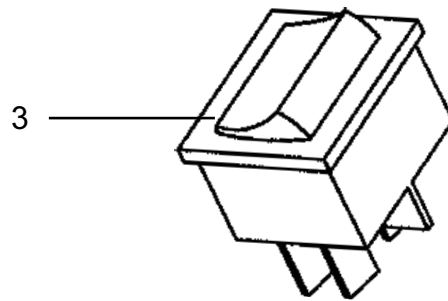
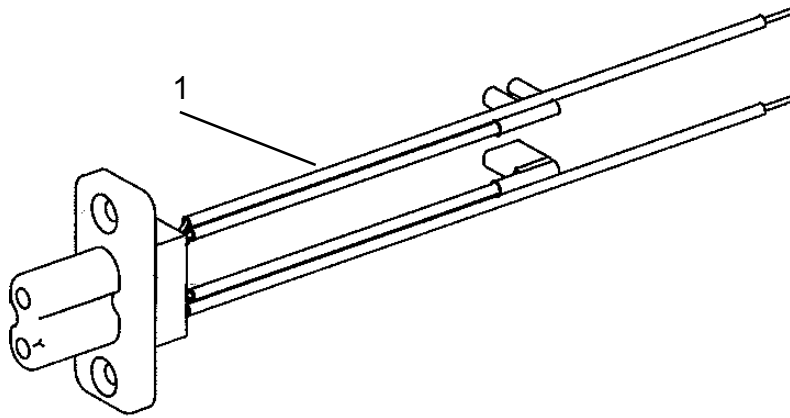

**ELECTRICAL SWITCH SERVICE KIT**

02/04

**ELECTRICAL ITEMS****9**

<b>Item</b>	<b>Ref.No.</b>	<b>Qty.</b>	<b>Description</b>	<b>Note</b>	<b>EAN code</b>
1	140 8036 000	1	Connector	Electrical outlet for electro nozzle	7319519513011
3	140 5496 000		Switch		7319519387117

**FILTER SERVICE KIT PACK VACUUM CLEANER**

**10**

**EXHAUST FILTERS STANDARD/HEPA**

**01/06**

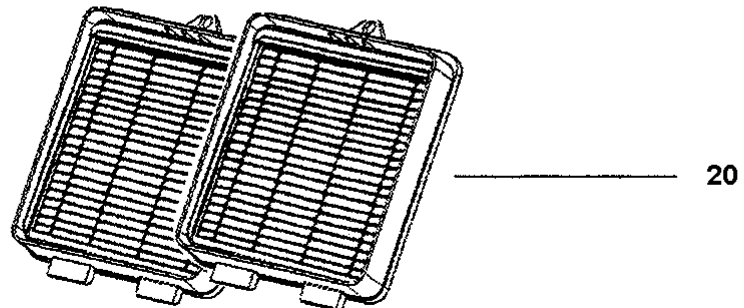
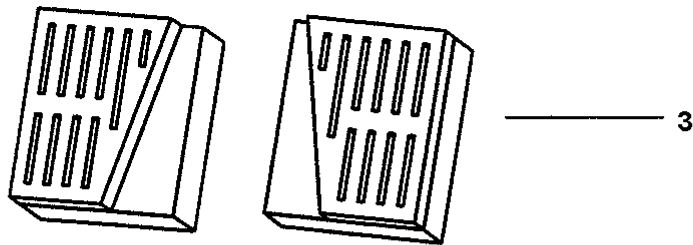
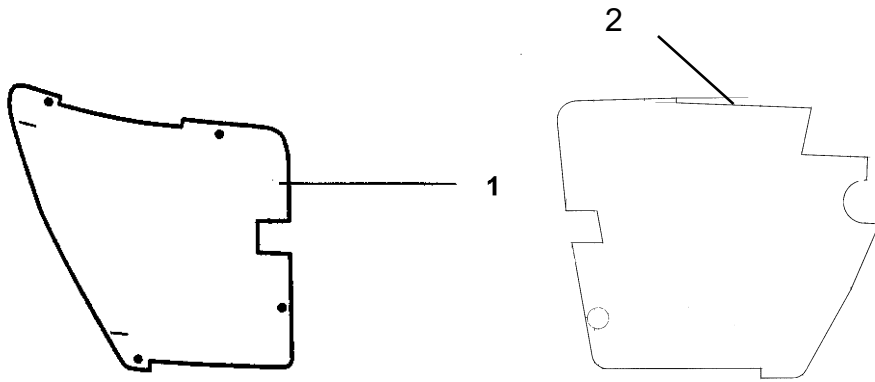

**FILTER SERVICE KIT PACK VACUUM CLEANER****01/06****EXHAUST FILTERS STANDARD/HEPA****11**

<b>Item</b>	<b>Ref.No.</b>	<b>Qty.</b>	<b>Description</b>	<b>Note</b>	<b>EAN code 5715492+</b>
1	56100952	2	Exhaust diffuser filter For the left side	Standard type	+008650
2	140 8038 000	1	Exhaust diffuser filter For the right side	F. models w. p.outlet at the machine	7319519513042
3	22244400	1	Sound suppressors Left and right		+008674
20	56100915	1	Exhaust HEPA filter (two filters)	Area:1300 cm <sup>2</sup> Filtration: H13	+006717

**ACCESSORIES Ø32MM**

**12**

**NOZZLES, BACK-PACK VACUUM CLEANER**

**01/06**

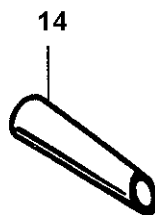
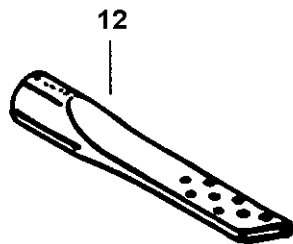
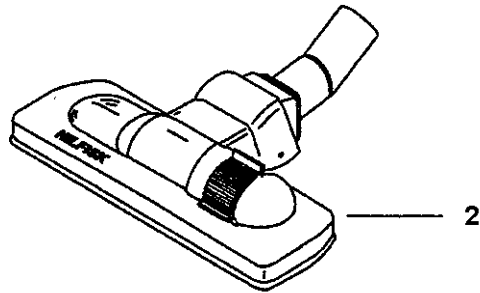

**ACCESSORIES Ø32MM**

02/04

**NOZZLES, BACK-PACK VACUUM CLEANER****13**

<u>Item</u>	<u>Ref.No.</u>	<u>Qty.</u>	<u>Description</u>	<u>Note</u>	<u>EAN code 5715492+</u>
2	56208625	1	Roller combi nozzle 3032	Plastic	+002573
10	56208637	1	Upholstery nozzle with insertion width 130 mm	Plastic	+002658
11	56208636	1	Round brush, turnable with black natural britles width 70 mm packed in a plastic bag		+005451
12	81530400	1	Crevice nozzle, width 245 mm	Plastic	
14	56208635	1	Flexible nozzle, length 150 mm	Plastic	

**ACCESSORIES Ø32MM**

**14**

**TUBES, HOSE AND DUST BAG**

**01/06**

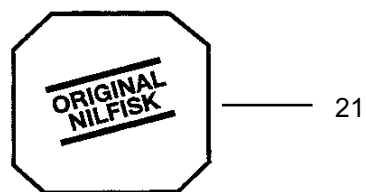
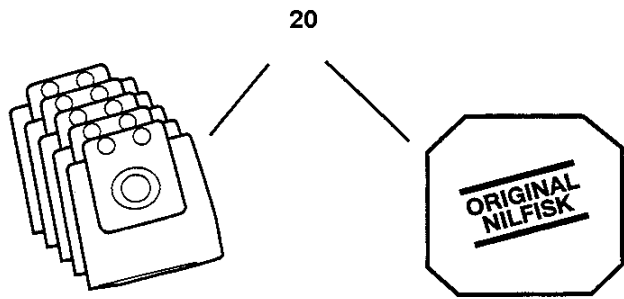
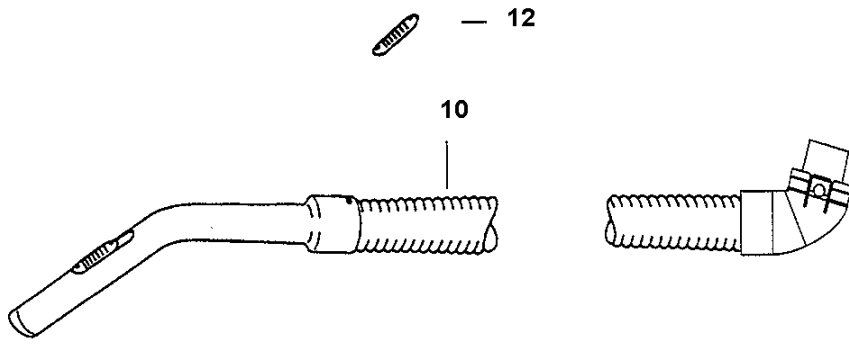
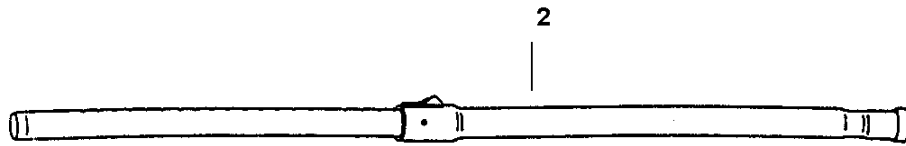

**ACCESSORIES Ø32MM**

02/04

**TUBES, HOSE AND DUST BAG****15**

<u>Item</u>	<u>Ref.No.</u>	<u>Qty.</u>	<u>Description</u>	<u>Note</u>	<u>EAN code 5715492+</u>
2	56100916	1	Tube, telescopic. Length max 1130 mm	Steel	
	81948300	1	Friction Ring		
10	56100917	1	Hose plastic with coupling and curved tube. Length 1150 mm	Plastic	+006762
12	56100951	1	Atmos, valve	Plastic	
20	56100919	1	Dust bag, 5 pcs. packed with one prefilter in a plastic bag.		+006724
21	82154600	1	Prefilter		7319519493443
	56100957	1	Prefilter, package of 10.		

**ELECTRICAL DIAGRAM**



**16**

**BACKVACUUM, GROUNDED VERSION**

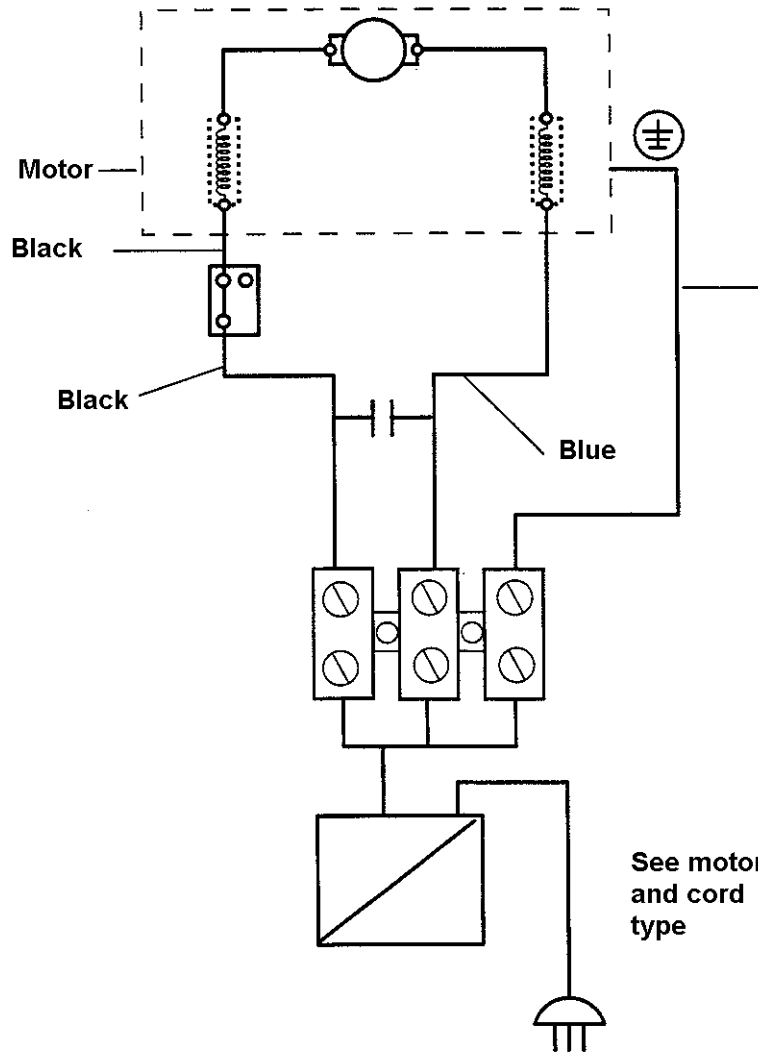
**01/06**

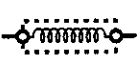
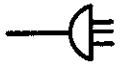
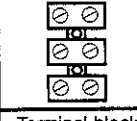
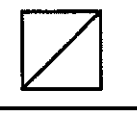

**Symbol explanation**

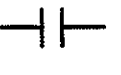
						
Armature	Field coil	Cord grounded	Terminal block	on/off switch and socket for el-outlet	Thermo switch	Capacitor



Nilfisk-Advance, Inc.  
14600 21st Avenue North  
Plymouth, MN, 55447-3408  
[www.nilfisk-advance.com](http://www.nilfisk-advance.com)  
Phone: 800-989-2235  
Fax: 800-989-6566  
©2002 Nilfisk-Advance, Inc.,  
Plymouth, MN 55447-3408  
Printed in the U.S.A.