



# Electronic Service Manuals

This electronic document is provided as a service to our customers. We do not create the contents of the information contained in this document. Should you have detailed questions pertaining to the information contained in this document, you may contact Michco, or the manufacturer which provided the original information in this electronic deliverable. Michco's only part in this electronic deliverable was the electronic assembly process.

You may contact Michco through the following methods:  
Phone (517) 484-9312 or (800) 331-3339 MI, OH, IN only  
2011 N. High St. -- Lansing, Michigan -- 48906  
Fax: (517) 484-9836  
Email: [CustServ@Michco.com](mailto:CustServ@Michco.com)  
Web site: [www.Michco.Com](http://www.Michco.Com)  
Parts Web site: [www.FloorMachineParts.Com](http://www.FloorMachineParts.Com)

Order Parts on Line at:  
**[www.FloorMachineParts.Com](http://www.FloorMachineParts.Com)**

Directly to Parts & Service:  
By Email: **[Shop@Michco.com](mailto:Shop@Michco.com)**  
By Fax: (517) 702-2041  
By Voice: Use numbers above.

**Serving the Cleaning Industry Since 1922**

Notice: All copyrighted material remains property of original owners, all trademarks are property of respective owners. Manuals are subject to Manufacturer's reproduction limitations. Originals or reproductions were provided by manufacturers through a request. We make no warranty as to the correctness of information provided in this document and you assume all risk.

# BackVacuum

---

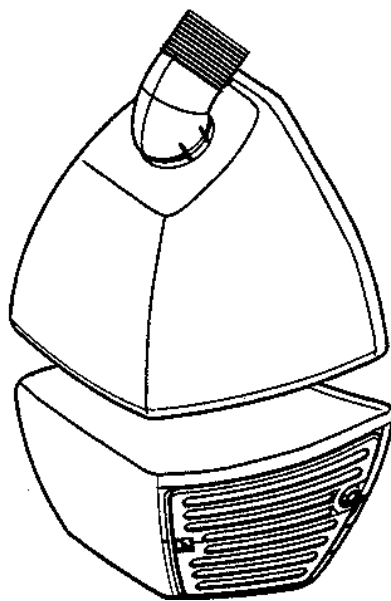

## PARTS LIST

Advance MODELS 56100901, 56100902, 17900013



**Nilfisk  
Advance**  
*setting standards*

05/00  
FORM NUMBER 56042353  
82239900

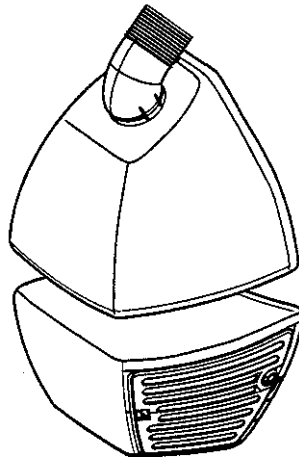

**TABLE OF CONTENTS SERVICE KIT****05/00****BACKVACUUM****3**

<b>DESCRIPTION</b>	<b>PLAN</b>
Motors, internal wires and cords	4
Container upper parts	6
Container lower parts	8
Electric units	10
Motor filter and exhaust filter (Standard/HEPA)	12
Nozzles	14
Tubes, hose and dust bag	16
NilfiskMop	18
Electrical Diagram, double insulated versions	20
Electrical Diagram, grounded versions	21

**MOTOR SERVICE KIT**

**4**

**MOTOR AND CORD TYPES, BACKVACUUM**

**05/00**

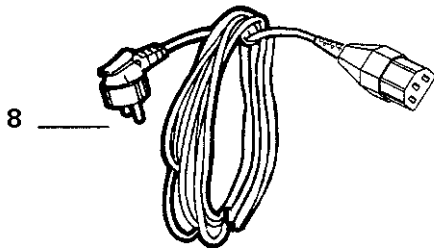
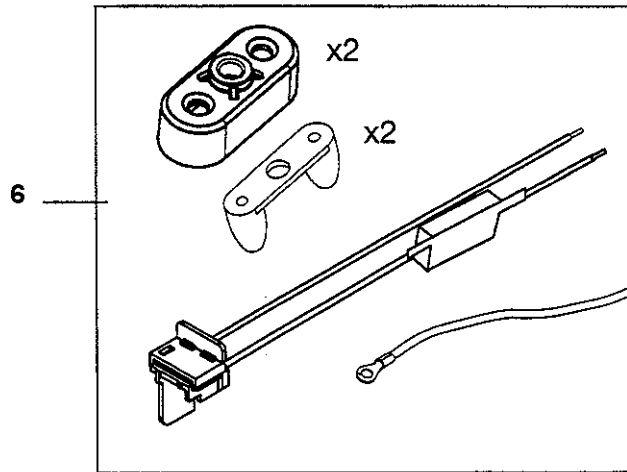
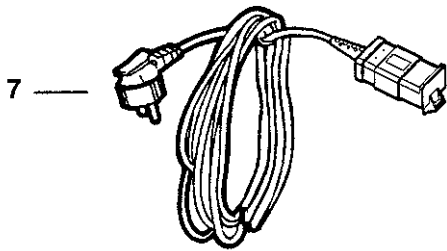
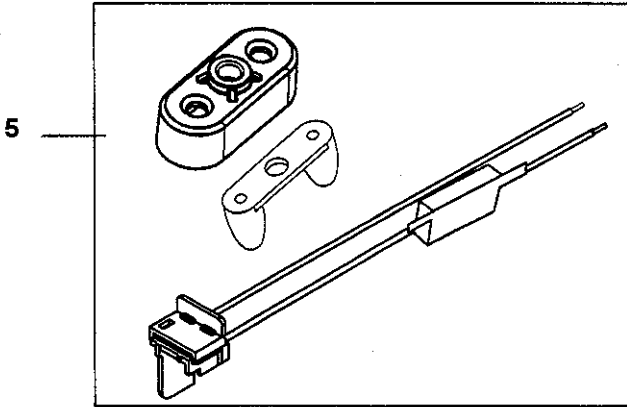
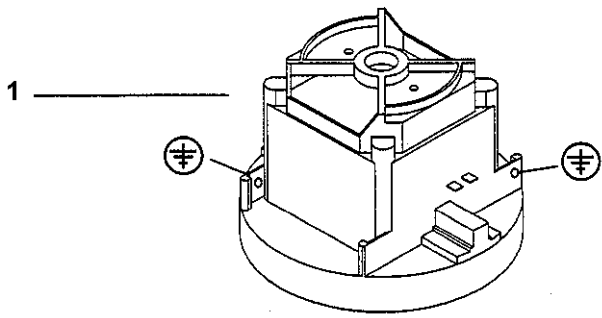

Cord			
	Voltage	Plug type	
US Grounded	120		
US/Japan D.insulated	120		

**MOTOR SERVICE KIT****05/00****MOTOR AND CORD TYPES****5**

<b>Item</b>	<b>Ref.No.</b>	<b>Qty.</b>	<b>Description</b>	<b>Note</b>	<b>EAN code 5715492+</b>
1			Motor/fan unit for:	Mat.: plast and steel	
	56100947	1	110-120V, 50-60Hz, 1000W , grounded		+008420
	12125003	1	110-120V, 50-60Hz, 1000W, d.insulated		+003020
5	56100904	1	Internal wire kit for for d.insulated version, with thermo switch and cable relief	Mat.: PVC and copper, PP	+006793
6	56100948	1	Internal wire kit for for grounded version, with thermo switch and cable relief	Mat.: PVC and copper, PP	+008308
7,8			Cord with plug and socket. Length=15m	Mat.: PVC and copper	
	56100949	1	US, grounded version		+008285
	140 7679 000	1	US, grounded 16 AWG for model 17900013		7319519509762
	56100905	1	US, Japan, Canada		+006861
10	56100906	1	Strain relief bush		+008285

**CONTAINER SERVICE KIT**

**6**

**UPPER PART BACKVACUUM**

**05/00**

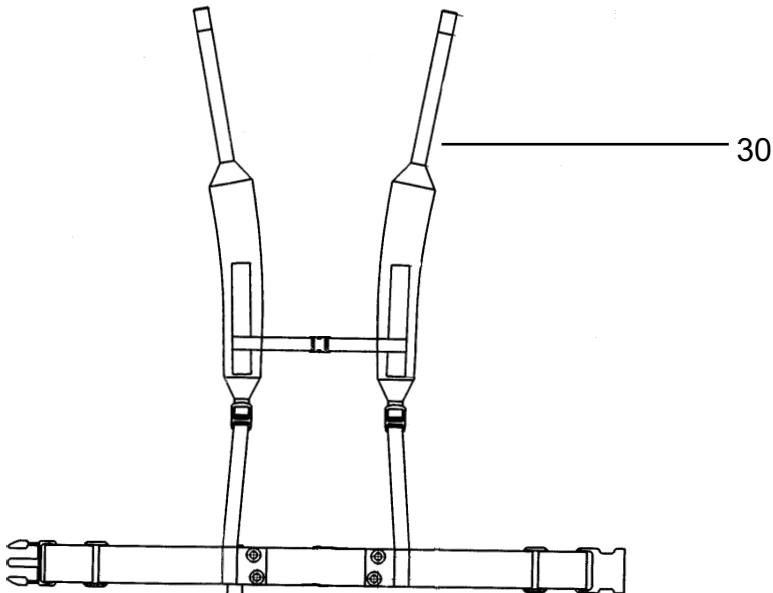
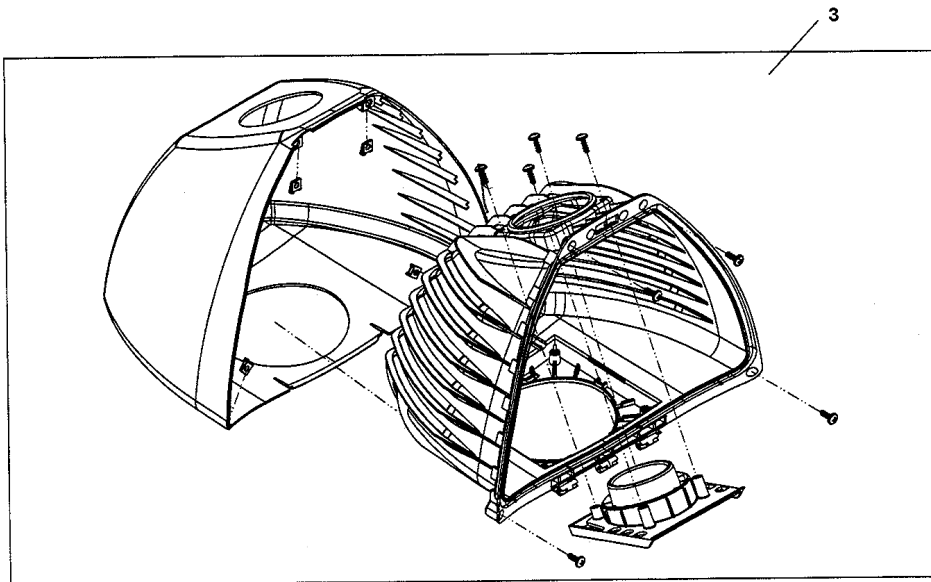
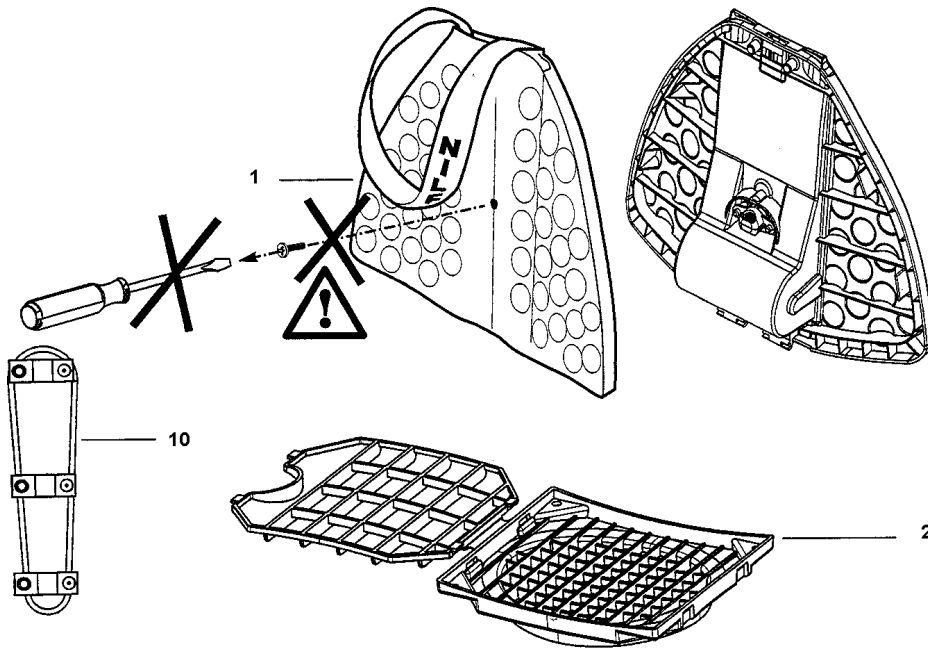

**CONTAINER SERVICE KIT****05/00****UPPER PART BACKVACUUM****7**

<u>Item</u>	<u>Ref.No.</u>	<u>Qty.</u>	<u>Description</u>	<u>Note</u>	<u>EAN code 5715492+</u>
1	56100907	1	Dust chamber lid complete	Mat.: ABS grey RAL 7001	+006694
2	56100908	1	Frame for main filter complete		+006755
3	56100944	1	Dust chamber complete	Mat.: ABS	+007806
10	56100939	1	Shoulder pad, 2 pcs.		+007400
30	140 7935 000		Fixed straps, kit  Mounted on a dust chamber lid. Mounting instruction is included. <b>Note!</b> The replacement to fixed straps must be performed by a skilled or instructed person only.	Mat.:Polyprop.	7319519508574

**CONTAINER SERVICE KIT**

**8**

**LOWER PART BACKVACUUM**

**05/00**

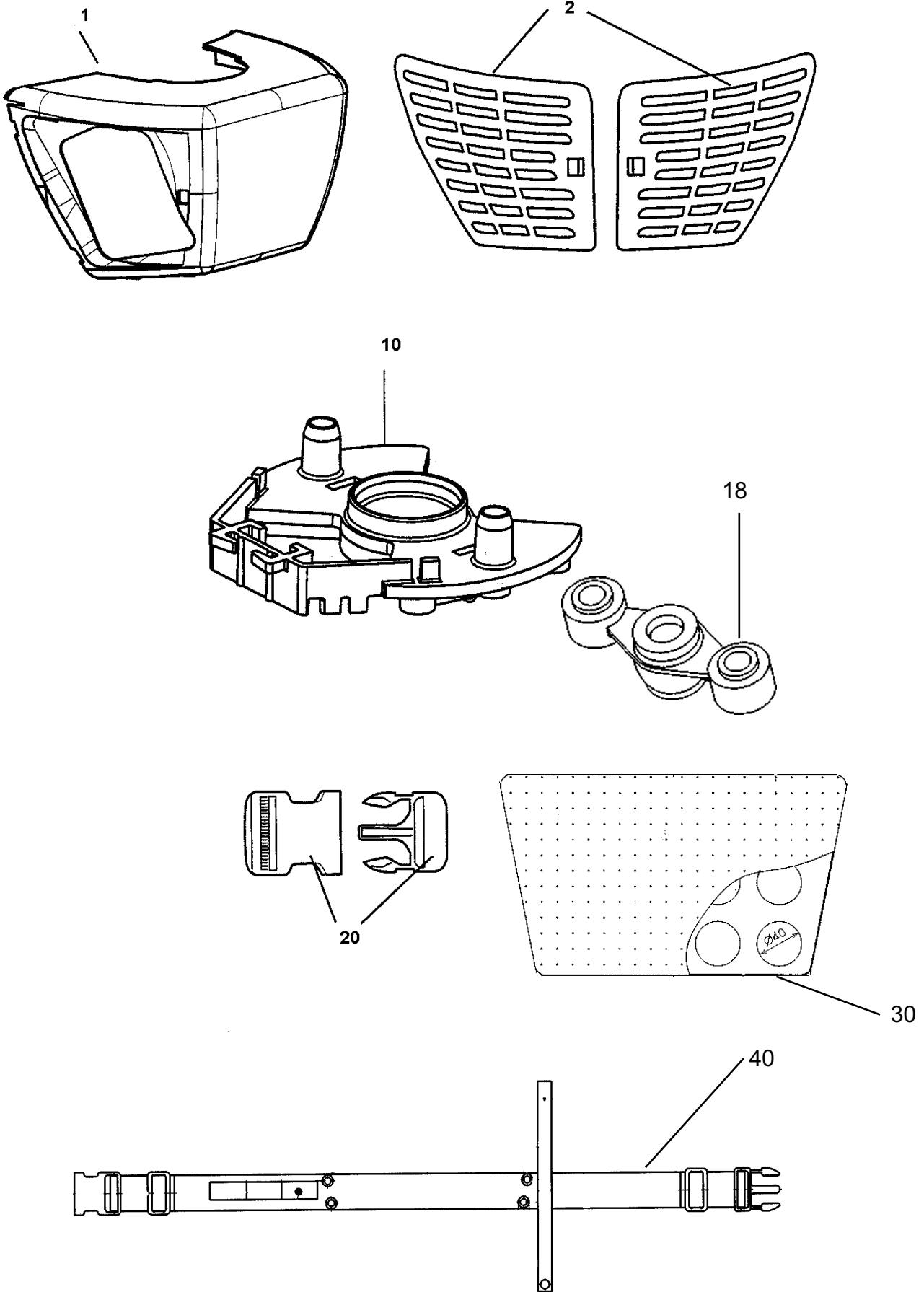

**CONTAINER SERVICE KIT****05/00****LOWER PART BACKVACUUM****9**

<b>Item</b>	<b>Ref.No.</b>	<b>Qty.</b>	<b>Description</b>	<b>Note</b>	<b>EAN code 5715492+</b>
1	56100909	1	Motor housing cover	Mat.: ABS colour: grey, RAL 7001	+006809
2	56100910	1	Grid,one left and one right	Mat.: ABS colour:grey RAL 7001	+006700
10	56100911	1	Motor suspension		+006748
18	82157400	1	Rubber suspension	Mat.: Rubber type S8R	7319519492941
20	56100912	1	Buckles male/female complete	Mat.: PP colour:black	+006786
30	140 7934 000		Mesh cushion cpl. With velcro tape	Mat.: Polyester Airmesh and hard foam. colour:black	7319519509205
40	82152500		Belt cpl.	Mat.; Polypr. web. Eylet; bronze + nickel coated	7319519492781

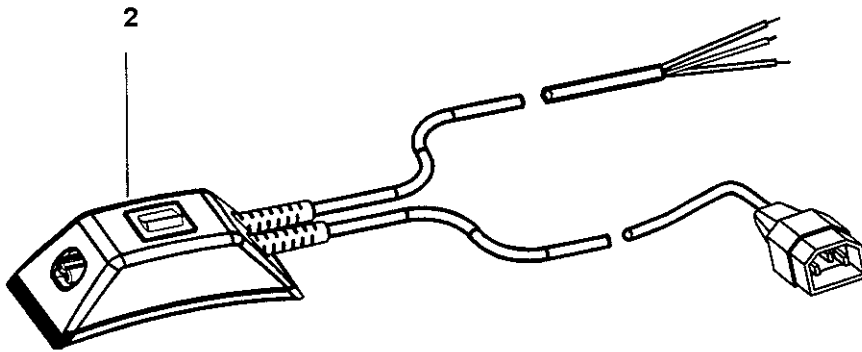
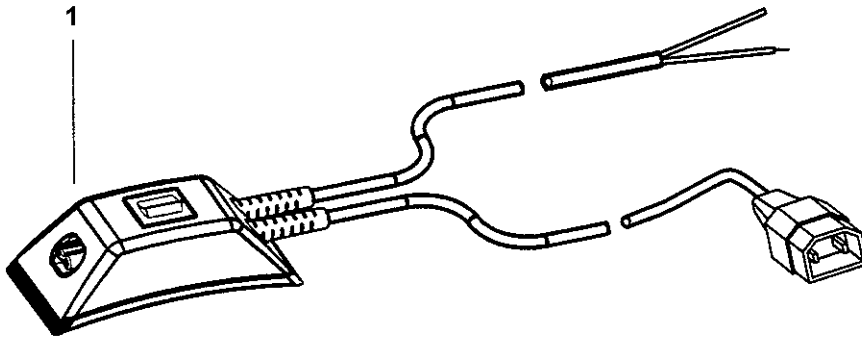

**ELECTRICAL SWITCH SERVICE KIT****05/00****ELECTRICAL UNIT BACKVACUUM****11**

<u>Item</u>	<u>Ref.No.</u>	<u>Qty.</u>	<u>Description</u>	<u>Note</u>	<u>EAN code 5715492+</u>
			Electrical unit, complete	With electrical outlet for electro nozzle colour: grey cord: black	
1	56100913	1	US, double insulated		+007134
2	56100950	1	US, grounded version		+008292

**FILTER SERVICE KIT BACKVACUUM**

**12**

**EXHAUST FILTERS (STANDARD/HEPA)**

**05/00**

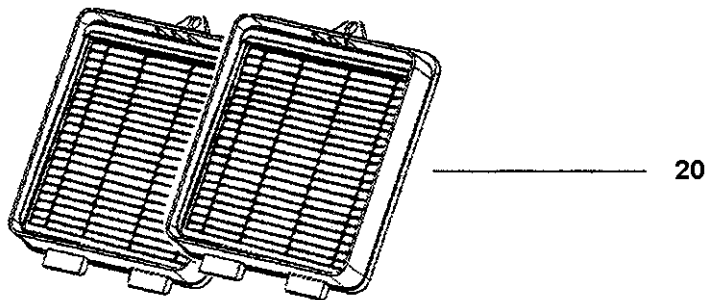
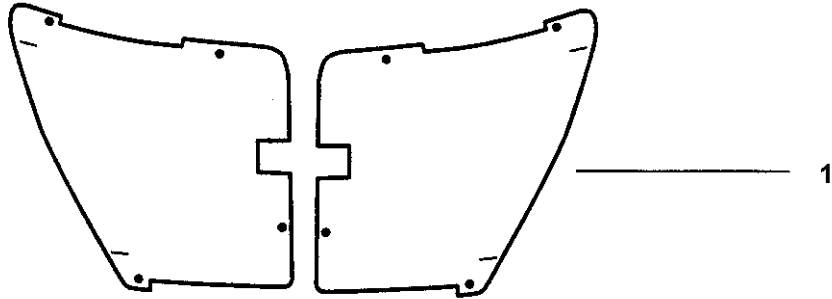

**FILTER SERVICE KIT BACKVACUUM****05/00****EXHAUST FILTERS (STANDARD/HEPA)****13**

<b>Item</b>	<b>Ref.No.</b>	<b>Qty.</b>	<b>Description</b>	<b>Note</b>	<b>EAN code 5715492+</b>
1	56100952	1	Exhaust diffuser filter	Two pieces	+008650
20	56100915	1	Exhaust HEPA filter (two filters)	Area:1300 cm <sup>2</sup> Filtration: H13	+006717

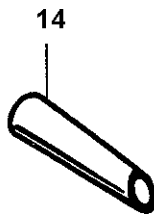
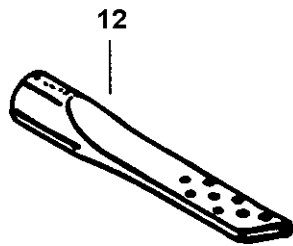
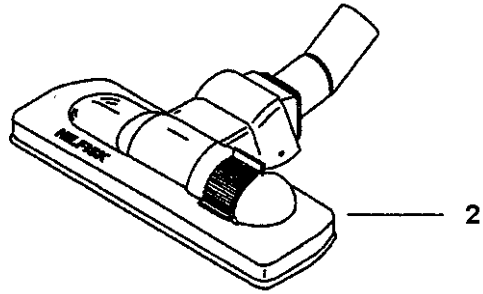

**NOZZLES Ø32MM****05/00****BACKVACUUM****15**

<u>Item</u>	<u>Ref.No.</u>	<u>Qty.</u>	<u>Description</u>	<u>Note</u>	<u>EAN code 5715492+</u>
2	56208625	1	Roller combi nozzle 3032	Plastic	+002573
10	56100921	1	Upholstery nozzle with insertion	Plastic width 130 mm	+002658
11	56100922	1	Round brush, turnable with black natural bristles width 70 mm packed in a plastic bag		+005451
12	81530400	1	Crevice nozzle, width 245 mm	Plastic	
14	56100923	1	Flexible nozzle, length 150 mm	Plastic	

**ACCESSORIES Ø32MM**

**16**

**TUBES, HOSE AND DUST BAG. BACKVACUUM**

**05/00**

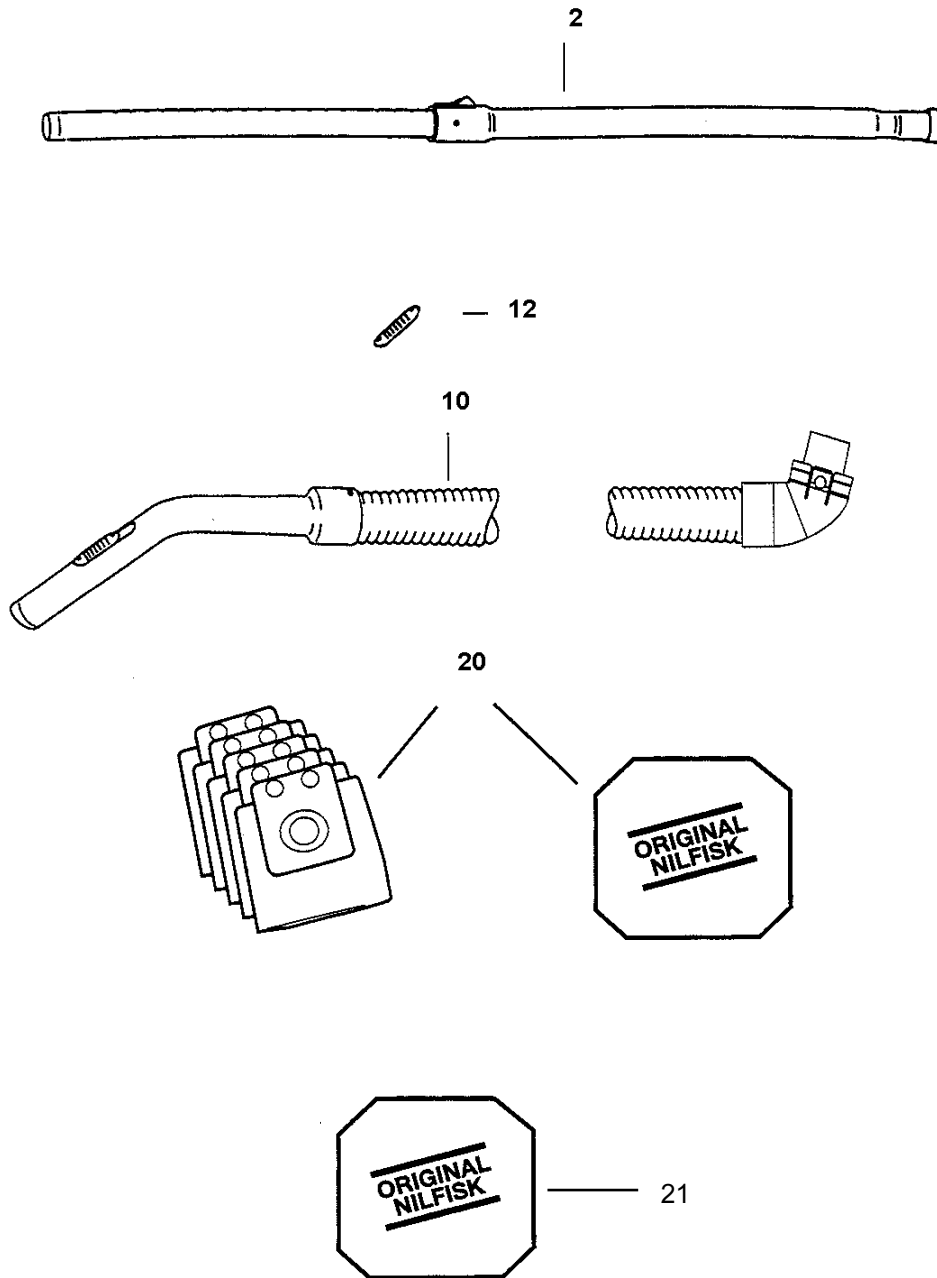

**ACCESSORIES Ø32MM****05/00****TUBES, HOSE AND DUST BAG. BACKVACUUM****17**

<u>Item</u>	<u>Ref.No.</u>	<u>Qty.</u>	<u>Description</u>	<u>Note</u>	<u>EAN code 5715492+</u>
2	56100916	1	Tube, telescopic. Length max 1130 mm	Steel	
10	56100917	1	Hose plastic with coupling and curved tube. Length 1150 mm	Plastic	+006762
12	56100951	1	Atmos, valve	Plastic	
20	56100919	1	Dust bag, 5 pcs. packed with one prefilter in a plastic bag		+006724
21	82154600	1	Prefilter, quantity one		7319519493443
	56100957	1	Prefilter, package of 10		

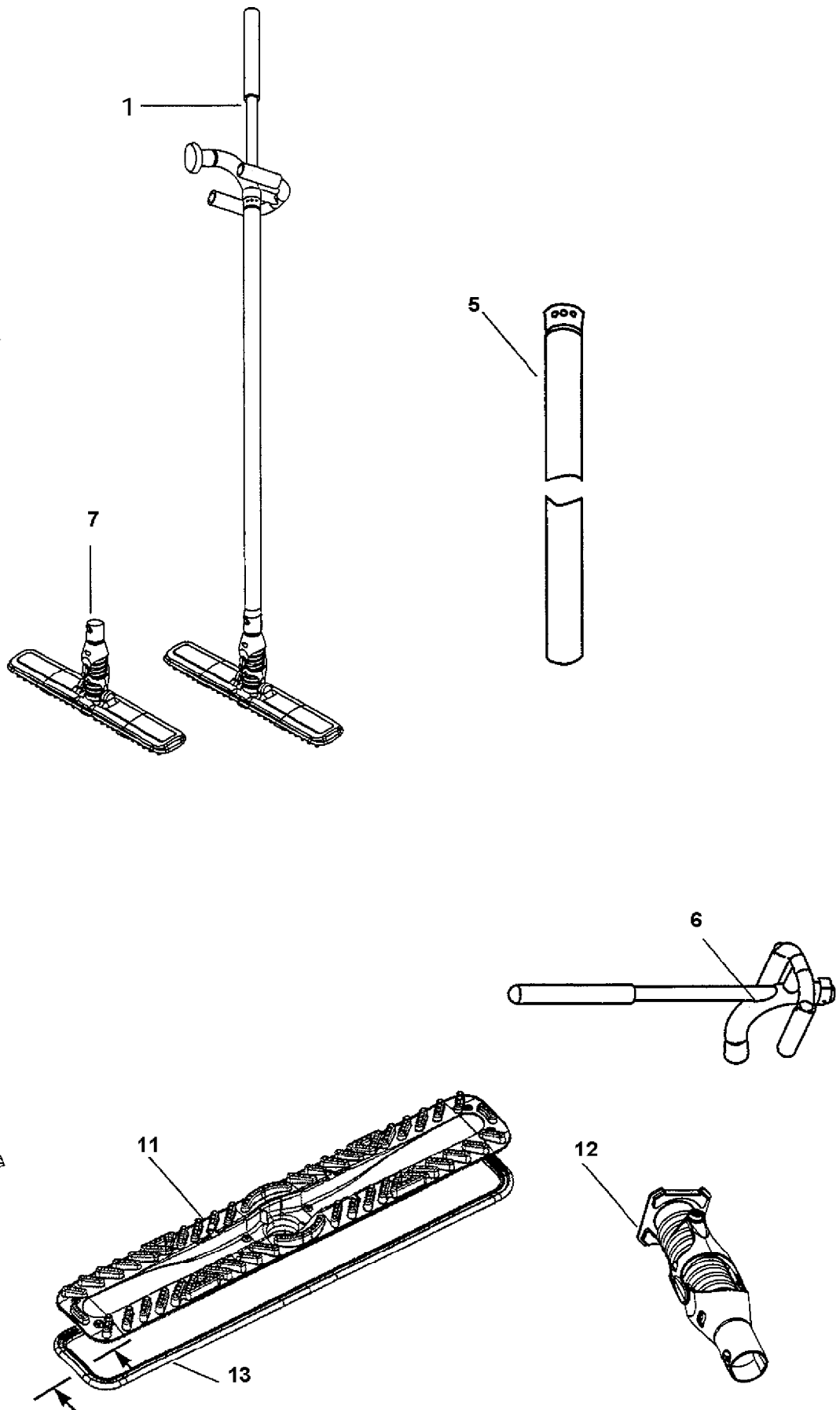

**ACCESSORIES****05/00****NILFISKMOP™****19**

<b>Item</b>	<b>Ref.No.</b>	<b>Qty.</b>	<b>Description</b>	<b>Note</b>	<b>EAN code 5715492+</b>
1	56100388	1	Mop without hose Tube length = 1000 mm (medium) Height of person = 165-180 cm		+005536
5	56100440	1	Tube length 1000 mm		+005901
6	56100441	1	Handle		+005925
7	56100442	1	Mop nozzle		+006892
11	56100444	1	Foot plate with fender		+005628
12	56100445	1	Flexible neck		+005635
13	56100446	1	Fender list		+007462

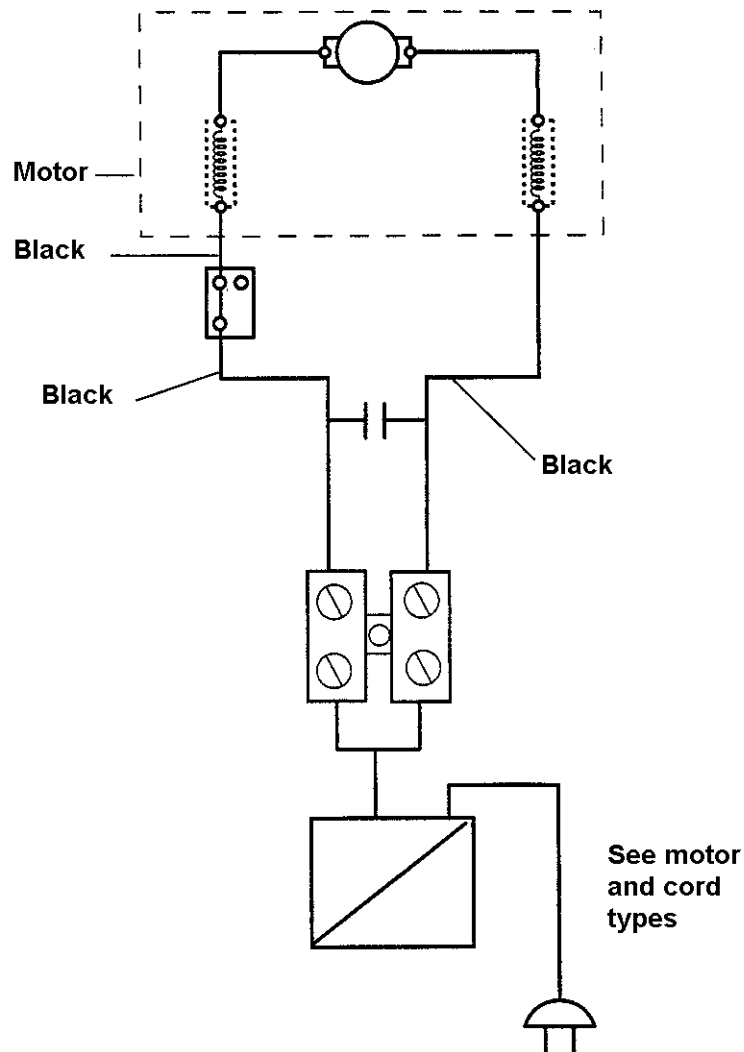



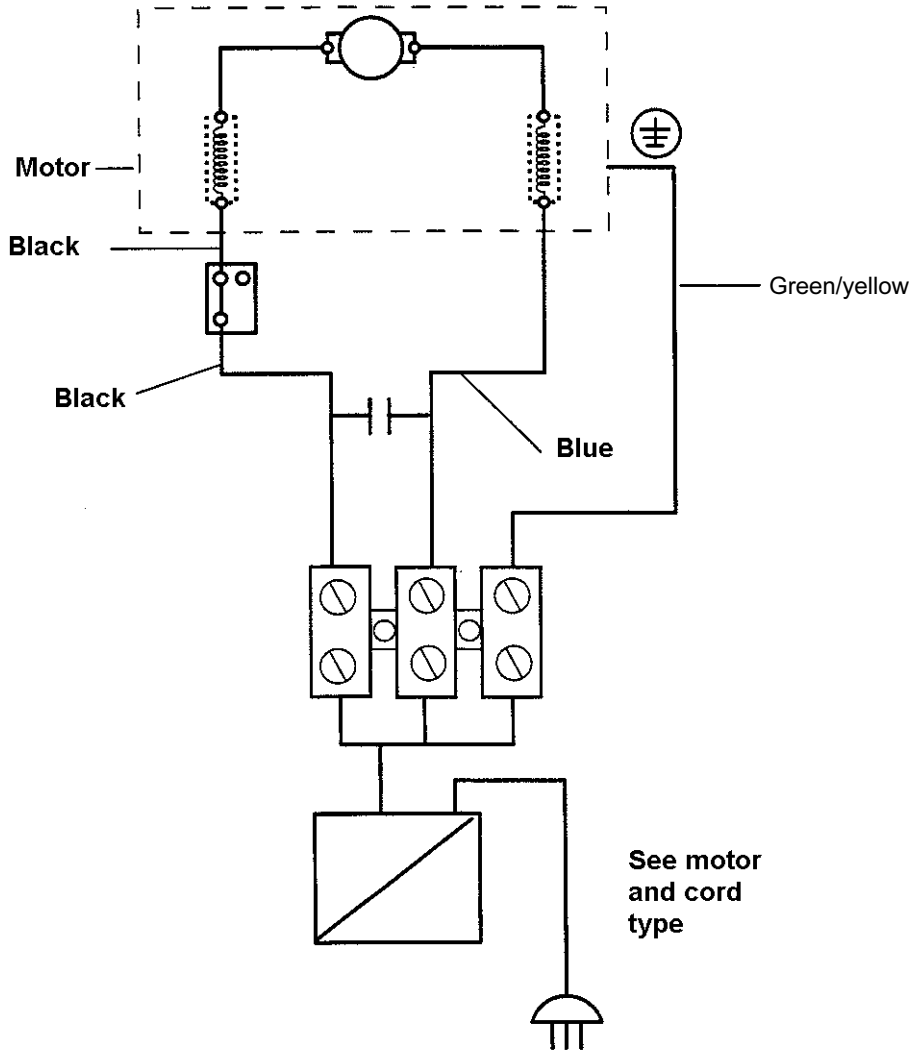

**Symbol explanation**

Armature	Field coil	Cord with plug	Terminal block	EI-unit with on/off switch and socket for ei-outlet	Thermo switch	Capacitor

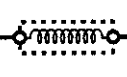
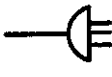

**Symbol explanation**

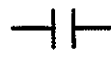
						
Armature	Field coil	Cord grounded	Terminal block	EI-unit with on/off switch and socket for ei-outlet	Thermo switch	Capacitor

Man.:Nilfisk-Advance A/S Åmål Branch, P.O. Box 127, S-662 23 Åmål, Sweden